

# SINGAPORE ACCIDENT STATEMENT

## IMPORTANT NOTICE

1. Please report correctly the details of the accident to speed up the claims process.
2. This Form must be completed by the Policyholder and/or the Actual Driver
3. Information provided must be as truthful and accurate as possible. Any wilful misrepresentation or withholding of material facts may allow insurance companies to repudiate policy liability.
4. The issue and acceptance of this Form by insurance companies is not an admission of policy liability on the part of the insurance companies.
5. **Any false reporting may be referred to the Police for investigation.**
6. This report will be forwarded by the insurers of the GIA Records Management Centre established by the General Insurance Association of Singapore (GIA) for archiving and that copies of this report will, for a fee, be made available upon application by interested parties.
7. By the lodgement of this report to the insurers, you hereby consent to the archiving of this report at the centre and to copies of the report being made available aforesaid.

## ACCIDENT STATEMENT

Date of Submission .....	05/06/2023 16:11 (SGT)
Reported by .....	Actual Driver
Date of Accident .....	04/06/2023 18:20 (SGT)
Exact Location of Accident .....	Singapore
Additional Location Information .....	BEFORE MALAYSIA IMMIGRATION CHECKPOINT COQ
Country/State of Loss .....	Singapore

## DETAILS OF OWN VEHICLE

Vehicle Registration Number .....	SKM186Z
-----------------------------------	---------

### INSURED/POLICYHOLDER

Is company? .....	No
Name Of Registered Owner .....	GOH KIM HANN
NRIC No .....	SXXXX465J
Email Address .....	GIGGSY_GOALS@HOTMAIL.COM
Mobile Phone No .....	(Phone) +65-98370090
Alternative Phone No .....	-

### VEHICLE PARTICULARS

Manufacturer .....	Toyota
Model .....	Vellfire
Variant .....	-
Exact purpose for which vehicle was being used at time of accident .....	-
Are you claiming under your own insurance policy for repair to your vehicle? .....	No - Claiming third party
Vehicle Category .....	Private car
Transmission .....	Auto
CC .....	2500

### INSURANCE COMPANY

Name of Insurance Company .....	Income Insurance Limited
Policy Number / Cover Note Number .....	5118619823-02

### DRIVER

Name of Driver .....	CHAN YEN LENG
NRIC No .....	SXXXX519F
Date Of Birth .....	23/12/1975
Occupation .....	Indoor

Date Of Driving Pass .....	01/06/1998
Driving experience .....	25 YEARS
Gender .....	Female
Mobile Number .....	(Phone) +65-98370090
Alt. Phone Number .....	-
Email Address .....	giggysy_goals@hotmail.com
Address .....	27 OXLEY ROAD #05-06
Address complement .....	-
Postcode .....	238621
Is the driver the policyholder? .....	No
If No, Relationship of the Driver with the Insured .....	Spouse
Does Driver Own Other Vehicles? .....	No
Vehicle Registration Number of Other Vehicle Owned by Driver .....	-
Insurance Company of Other Vehicle Owned by Driver .....	-

#### GENERAL INFORMATION OF THE ACCIDENT

Type of Accident .....	Collision - Head to Rear
Weather Conditions .....	Clear
Road Surface .....	Dry

#### OTHER INFORMATION

Was any foreign vehicle involved in the accident? .....	No
Number of vehicles involved in the accident .....	2
Was anybody injured in the Accident? .....	No
Was any injured conveyed to hospital by ambulance? .....	-
Was any other vehicle or property damaged? .....	Yes
Number of Passengers (Including Driver) .....	5
Has the driver been approached by unknown person(s) soliciting/offering accident claims assistance? .....	No
Translator's name .....	-
Translator's ID .....	-
Translator's phone number .....	-
Translator's email .....	-
Original language used in the statement .....	-

#### PASSENGER 1

Name .....	PASSENGER
Gender .....	Male

#### PASSENGER 2

Name .....	PASSENGER
Gender .....	Female

#### PASSENGER 3

Name .....	PASSENGER
Gender .....	Female

#### PASSENGER 4

Name .....	PASSENGER
Gender .....	Female

#### DETAILS OF POLICE ACTION

Was the accident reported to the police? .....	No
Was notice of intended Prosecution given? .....	No
If yes, against whom? .....	-

#### CIRCUMSTANCES OF ACCIDENT

#### REFER TO SKETCH PLAN

Are accident photos available for attachment? ..... Yes  
Was there any video captured by Car Camera? ..... No

**DETAILS OF OTHER VEHICLE PROPERTY 1**

Vehicle Registration Number ..... SMH8377P  
Vehicle Manufacturer ..... -  
Vehicle Model ..... -  
Vehicle Variant ..... -  
Vehicle Colour ..... -  
Vehicle Category ..... Private car  
Name of Driver ..... -  
Contact Number ..... -  
Address ..... -  
Address complement ..... -  
Postcode ..... -  
Insurance Company Name ..... -  
Nature Of Damage ..... -  
Details of property damaged in accident ..... -  
No. Of Passenger (Including Driver) ..... -

## PASSENGER 1

Name ..... -  
Gender ..... -

## SKETCH PLAN

### IMPORTANT NOTICE

1. Please report **correctly** the details of the accident to speed up the claims process.
2. This Form must be **completed by the Policyholder and/or the Authorised Driver**.
3. Information provided must be as **truthful and accurate as possible**. Any willful misrepresentation or withholding of material facts may allow insurance companies to **repudiate policy liability**.
4. The issue and acceptance of this Form by insurance companies is not an admission of policy liability on the part of the insurance companies.
5. **Any false reporting may be referred to the Police for investigation.**
6. The report will be forwarded by the insurers of the GIA Records Management Centre established by the General Insurance Association of Singapore (GIA) for archiving and that copies of this report will for a fee be made available upon application by interested parties.
7. By the lodgement of this report to the insurers, you hereby consent to the archiving of this report at the centre and to copies of the report being made available aforesaid.
8. **Consent under the Personal Data Protection Act (PDPA)**

I understand, acknowledge, agree and consent that:

(a) My insurer, my workshop and the General Insurance Association of Singapore ("GIA") may/are permitted to collect, use, disclose and/or process my personal data/personal information set out in this [form] and any other personal information provided by me or possessed by my insurer (collectively the "Personal Information") and disclose and transfer such Personal Information to all insurer(s) who have insured vehicle(s) involved in this accident (all insurer(s) who have insured vehicle(s) involved in this accident shall be collectively referred to as the "Insurers"), the Insurers' lawyers/law firms, the Monetary Authority of Singapore and any relevant government agency/authority (such as the police), for the purpose(s) of:

- (i) processing, handling and/or dealing with my claims including the settlement of the claims and any necessary investigations relating to the claims;
- (ii) investigating the accident and/or my claims;
- (iii) carrying out and/or dealing with my instructions or responding to any enquiries by me;
- (iv) administering my claims (including the mailing of correspondence, statements, invoices, reports or notices to me, which could involve disclosure of certain personal data about me to bring about delivery of the same as well as on the external cover of envelopes/mail packages); and/or
- (v) complying with applicable law in administering, processing, handling and/or dealing with my claims.

(collectively the "Purposes")

(b) all insurer(s) who have insured vehicle(s) involved in this accident and the Insurers' lawyers/law firms, may/are permitted to collect, use, disclose and/or process my Personal Information for one or more of the above Purposes; and

(c) my Personal Information may/can be disclosed by any of the Insurers and/or GIA to their third party service providers or agents (including their lawyers/law firms), which may be sited outside of Singapore, for one or more of the above Purposes.

**CITY AUTO PTE LTD**

Blk 8 Sin Ming Road  
#01-58/60/62 Sin Ming Ind Est  
Singapore 575643  
Tel: 6453 1235 Fax: 6453 7944  
(Claims Section)

Policyholder's Signature / Date & Time

Driver's Signature (If driver is not the policyholder) / Date & Time

Witnessed by Reporting Centre Personnel

### Sketch Plan

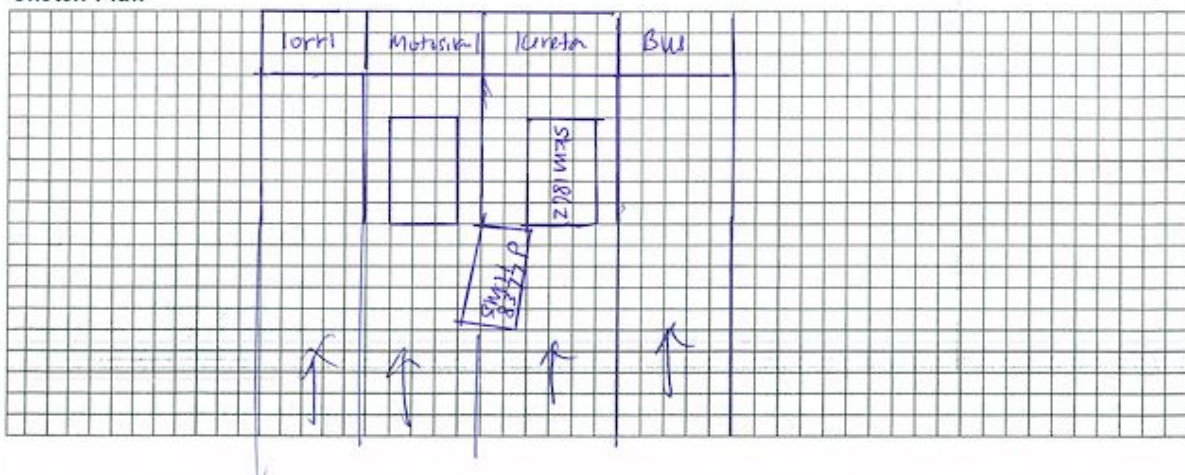

location: Before Malaysia Immigration checkpoint, COG

My car was queuing in line for Malaysian Immigration when SMH 8377 P wanted to cut into my lane. After he failed, he tried to overtake the car behind me and bumped into my car on the left rear and side.

We declare the foregoing particulars are true in every respect.

**CITY AUTO PTE LTD**  
Blk 8 Sin Ming Road  
#01-58/60/62 Sin Ming Ind Est  
Singapore 575643  
Tel: 6453 1235 Fax: 6453 7944  
(Claims Section)

Driver's Signature (If driver is not the policyholder) / Date & Time

Witnessed by Reporting Centre  
Personnel



















































