

SINGAPORE ACCIDENT STATEMENT

IMPORTANT NOTICE

1. Please report correctly the details of the accident to speed up the claims process.
2. This Form must be completed by the Policyholder and/or the Actual Driver
3. Information provided must be as truthful and accurate as possible. Any wilful misrepresentation or withholding of material facts may allow insurance companies to repudiate policy liability.
4. The issue and acceptance of this Form by insurance companies is not an admission of policy liability on the part of the insurance companies.
5. Any false reporting may be referred to the Police for investigation.
6. This report will be forwarded by the insurers of the GIA Records Management Centre established by the General Insurance Association of Singapore (GIA) for archiving and that copies of this report will, for a fee, be made available upon application by interested parties.
7. By the lodgement of this report to the insurers, you hereby consent to the archiving of this report at the centre and to copies of the report being made available aforesaid.

ACCIDENT STATEMENT

Date of Submission	23/03/2023 18:51 (SGT)
Reported by	Actual Driver
Date of Accident	23/03/2023 14:25 (SGT)
Exact Location of Accident	Singapore
Additional Location Information	OPEN CARPARK OF BLK 342, WOODLANDS AVE 1
Country/State of Loss	Singapore

DETAILS OF OWN VEHICLE

Vehicle Registration Number	SHF564M
-----------------------------	---------

INSURED/POLICYHOLDER

Is company?	Yes
Name Of Registered Owner	TRANS-CAB SERVICES PTE LTD
Company Reg No	2XXXXX878K
Email Address	claims@transcab.com.sg
Mobile Phone No	(Phone) +65-62876666
Alternative Phone No	-

VEHICLE PARTICULARS

Manufacturer	Toyota
Model	Prius
Variant	-
Exact purpose for which vehicle was being used at time of accident	Private hire
Are you claiming under your own insurance policy for repair to your vehicle?	No - Reporting only
Vehicle Category	Taxi
Transmission	Auto
CC	1798

INSURANCE COMPANY

Name of Insurance Company	HSBC Life (Singapore) Pte. Ltd
Policy Number / Cover Note Number	VFX/P2413997

DRIVER

Name of Driver	CHANG KENG YONG
NRIC No	SXXXX220E
Date Of Birth	25/12/1962
Occupation	Outdoor

Date Of Driving Pass	11/07/1980
Driving experience	42 YEARS AND 8 MONTHS
Gender	Male
Mobile Number	(Phone) +65-98583734
Alt. Phone Number	-
Email Address	changthomas321@gmail.com
Address	437, WOODLANDS STREET 41
Address complement	#07-360
Postcode	S730437
Is the driver the policyholder?	No
If No, Relationship of the Driver with the Insured	Hirer
Does Driver Own Other Vehicles?	No
Vehicle Registration Number of Other Vehicle Owned by Driver	-
Insurance Company of Other Vehicle Owned by Driver	-

GENERAL INFORMATION OF THE ACCIDENT

Type of Accident	Chain Collision
Weather Conditions	Clear
Road Surface	Dry

OTHER INFORMATION

Was any foreign vehicle involved in the accident?	No
Number of vehicles involved in the accident	3
Was anybody injured in the Accident?	No
Was any injured conveyed to hospital by ambulance?	-
Was any other vehicle or property damaged?	Yes
Number of Passengers (Including Driver)	1
Has the driver been approached by unknown person(s) soliciting/offering accident claims assistance?	No
Translator's name	-
Translator's ID	-
Translator's phone number	-
Translator's email	-
Original language used in the statement	-

DETAILS OF POLICE ACTION

Was the accident reported to the police?	No
Was notice of intended Prosecution given?	No
If yes, against whom?	-

CIRCUMSTANCES OF ACCIDENT

ON THE DATE AND TIME MENTIONED I WAS DRIVING ALONG THE SAID MENTIONED CARPARK WHEN VEHICLE B, SUDDENLY MOVED OFF FROM A PARKING LOT WITHOUT CHECKING ON HIS RIGHT, AND AS MY VEHICLE WAS ALREADY TOO CLOSE, I HAD NO CHANCE TO APPLY MY BRAKE AND COLLIDED INTO VEHICLE B. THE IMPACT PUSHED VEHICLE B TO ITS LEFT AND HIT A PARKED VEHICLE C. NO ONE WAS INJURED. STATEMENT WAS READ TO ME AND I ACKNOWLEDGED IT.

ATTACHMENT(S)

Are accident photos available for attachment?	Yes
Was there any video captured by Car Camera?	No

DETAILS OF OTHER VEHICLE PROPERTY 1

Vehicle Registration Number	SMV3883D
Vehicle Manufacturer	Kia
Vehicle Model	Forte
Vehicle Variant	-
Vehicle Colour	Red
Vehicle Category	Private car

Name of Driver	GAN
Contact Number	(Phone) +65-96222803
Address	-
Address complement	-
Postcode	-
Insurance Company Name	-
Nature Of Damage	-
Details of property damaged in accident	-
No. Of Passenger (Including Driver)	1

DETAILS OF OTHER VEHICLE PROPERTY 2

Vehicle Registration Number	EU3883D
Vehicle Manufacturer	Mercedes
Vehicle Model	Glc250
Vehicle Variant	-
Vehicle Colour	White
Vehicle Category	Private car
Name of Driver	NO DETAIL
Contact Number	-
Address	-
Address complement	-
Postcode	-
Insurance Company Name	-
Nature Of Damage	-
Details of property damaged in accident	-
No. Of Passenger (Including Driver)	0

SKETCH PLAN**IMPORTANT NOTICE**

1. Please report correctly the details of the accident to speed up the claims process.
2. This Form must be completed by the Policyholder and/or the Authorised Driver.
3. Information provided must be as truthful and accurate as possible. Any wilful misrepresentation or withholding of material facts may allow insurance companies to repudiate policy liability.
4. The issue and acceptance of this Form by insurance companies is not an admission of policy liability on the part of the insurance companies.
5. Any false reporting may be referred to the Police for investigation.
6. The report will be forwarded by the insurers of the GIA Records Management Centre established by the General Insurance Association of Singapore (GIA) for archiving and that copies of this report will for a fee be made available upon application by interested parties.
7. By the lodgement of this report to the insurers, you hereby consent to the archiving of this report at the centre and to copies of the report being made available aforesaid.
8. **Consent under the Personal Data Protection Act (PDPA)**

I understand, acknowledge, agree and consent that:

- (a) My insurer, my workshop and the General Insurance Association of Singapore ("GIA") may/are permitted to collect, use, disclose and/or process my personal data/personal information set out in this [form] and any other personal information provided by me or possessed by my insurer (collectively the "Personal Information") and disclose and transfer such Personal Information to all insurer(s) who have insured vehicle(s) involved in this accident (all insurer(s) who have insured vehicle(s) involved in this accident shall be collectively referred to as the "Insurers"), the Insurers' lawyers/law firms, the Monetary Authority of Singapore and any relevant government agency/authority (such as the police), for the purpose(s) of:
 - (i) processing, handling and/or dealing with my claims including the settlement of the claims and any necessary investigations relating to the claims;
 - (ii) investigating the accident and/or my claims;
 - (iii) carrying out and/or dealing with my instructions or responding to any enquiries by me;
 - (iv) administering my claims (including the mailing of correspondence, statements, invoices, reports or notices to me, which could involve disclosure of certain personal data about me to bring about delivery of the same as well as on the external cover of envelopes/mail packages); and/or
 - (v) complying with applicable law in administering, processing, handling and/or dealing with my claims.
 (collectively the "Purposes")
- (b) all insurer(s) who have insured vehicle(s) involved in this accident and the Insurers' lawyers/law firms, may/are permitted to collect, use, disclose and/or process my Personal Information for one or more of the above Purposes; and
- (c) my Personal Information may/can be disclosed by any of the Insurers and/or GIA to their third party service providers or agents (including their lawyers/law firms), which may be sited outside of Singapore, for one or more of the above Purposes.



Witnessed By Reporting Officer
Hashim Bin Kamari

Policyholder's Signature / Date &
Time

Driver's Signature (If driver is not the policyholder) / Date
& Time

Witnessed by Reporting Centre
Personnel

Sketch Plan

REFER TO ATTACHED ACCIDENT DIAGRAM

Describe Circumstances of the Accident

ON THE DATE AND TIME MENTIONED I WAS DRIVING ALONG THE SAID MENTIONED CARPARK WHEN VEHICLE B, SUDDENLY MOVED OFF FROM A PARKING LOT WITHOUT CHECKING ON HIS RIGHT, AND AS MY VEHICLE WAS ALREADY TOO CLOSE, I HAD NO CHANCE TO APPLY MY BRAKE AND COLLIDED INTO VEHICLE B. THE IMPACT PUSHED VEHICLE B TO ITS LEFT AND HIT A PARKED VEHICLE C. NO ONE WAS INJURED. STATEMENT WAS READ TO ME AND I ACKNOWLEDGED IT.

Declaration

We declare the foregoing particulars are true in every respect.

Policyholder's Signature / Date &
Time

Driver's Signature (If driver is not the policyholder) / Date
& Time

Witnessed By Reporting Officer
Hashim Bin Kamari

Witnessed by Reporting Centre
Personnel

ACCIDENT DIAGRAM

Ver. 30042021

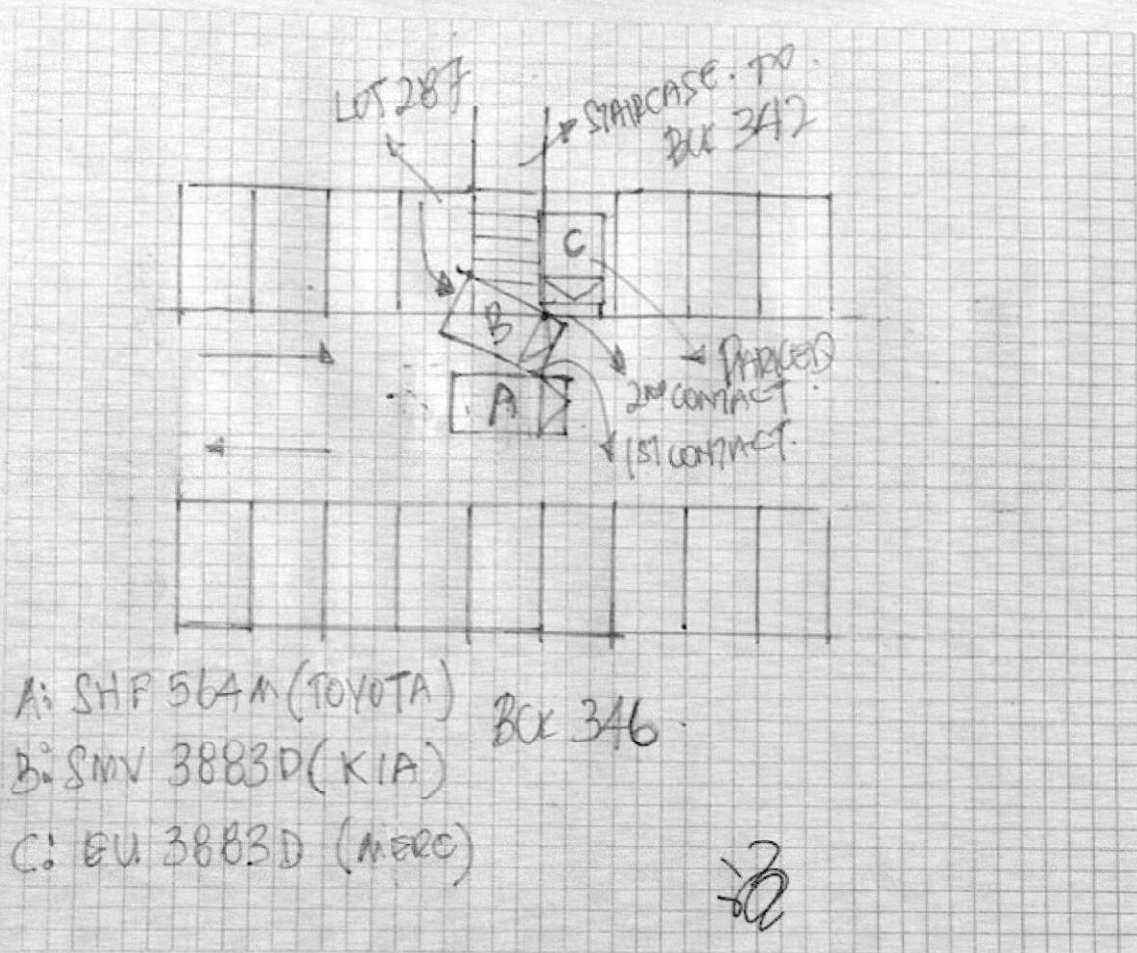

Policyholder's Signature
Date & Time:

Driver's Signature
(If driver is not the policyholder)
Date & Time:

VERIFIED BY AJAX MARS (ARC)
REPORTING OFFICER
HASHIM BIN KAMARI

Reporting Centre Personnel's Signature
Name:
NRIC/FIN No.: