

BIFROST AUTO PTE LTD

8 KAKI BUKIT AVE 4, PREMIER @ KAKI BUKIT

#01-49 SINGAPORE 415875

Tel: +65 64524457

Fax: +65 64524584

Company Reg No: 201929175W

Repair Estimate

Vehicle number: SJX6875H

Make & Model: Nissan Sylphy

Chassis number: JN1BAAG11Z0111310

Date of survey:

Name of surveyor:

Contacts:

No.	Description of spare parts	Qty	Amount S\$
1	Rear bumper	1	\$ 686.90
2	Rear bumper clips	1set	\$ 80.00
3	Rear bumper RH reflector	1	\$ 66.60
4	Rear bumper RH reflector cover	1	\$ 58.90
5	Rear bumper chrome moulding	1	\$ 231.20
6	Rear bumper RH side retainer	1	\$ 51.30
7	Rear bumper LH side retainer	1	\$ 51.30
8	RH taillamp assy	1	\$ 453.60
9	RH taillamp panel	1	\$ 178.40
10	RH taillamp lock clips	1set	\$ 28.00
11	RH taillamp gasket	1	\$ 28.00
12	Rear windscreen glass rubber moulding	1	\$ 198.70
13	Rear RH fender	1	\$ 1,489.90
14	Rear RH fender glass with rubber	1	\$ 378.10
15	Rear RH fender inner trim board	1	\$ 418.90
16	Rear RH fender inner trim board clips	1set	\$ 80.00
17	Rear RH fender splash shield	1	\$ 93.20
18	Rear RH fender splash shield clips	1set	\$ 50.00
19	Rear RH fender petrol cover	1	\$ 78.30
20	Rear RH sport rim	1	\$ 873.20
21	Rear RH wheel bearing	1	\$ 428.60
22	Rear RH shock absorber	1	\$ 231.80
23	Rear axle beam	1	\$ 1,242.80
24	Rear RH door	1	\$ 1,015.60
25	Rear RH door chrome handle	1	\$ 211.40
26	Rear RH door frame black sticker no:1	1	\$ 19.20
27	Rear RH door frame black sticker no:2	1	\$ 19.50
28	Rear RH door frame black sticker no:3	1	\$ 31.60
29	Rear RH door chrome moulding	1	\$ 93.80
30	Rear RH door weatherstrip	1	\$ 118.20
31	Rear RH door inner trim board	1	\$ 539.10
32	Rear RH door inner trim board clips	1set	\$ 80.00
33	Rear RH door lock	1	\$ 268.90
34	RH side rocker panel garnish	1	\$ 639.10
35	RH side rocker panel garnish clips	1set	\$ 80.00

\$ 10,594.10
 Parts less 10% \$ 1,059.41
 Total \$ 9,534.69

No.	Special Nett Items	Qty	Amount S\$

1	Rear windscreen glass sealant	1	\$ 400 80.00
2	Rear windscreen glass inner seal	1	\$ 300 60.00
3	Rear RH tyre	1	\$ und 200 500.00 80%
4	Rear RH fender glass sealant	1	\$ nd 50.00
5	Rear RH fender glass inner seal	1	\$ nd 30.00
6	Rear RH fender joint sealant	1	\$ nd 40 80.00
Total:			\$ 800.00

No.	Labour and painting	Amount S\$
1	Labour charges to remove, check, replace and reinstall damages bodyparts. To panel beating, cut/weld and realign all affected panels and areas	\$ 800 1,600.00
2	Spray painting on affected areas and panels	\$ 700 1,400.00
3	Check wiring and lighting system on affected areas	\$ 30 80.00
4	Apply rust coating chemical on affected areas and panels	\$ 30 100.00
5	Remove and reinstall roof lining, seats and carpet to assist repair	\$ 60 320.00
6	Remove and reinstall rear windscreen glass to assist repair	\$ 120 220.00
7	Remove and reinstall fuel tank pipes, sensors and sensors to assist repair	\$ 60 180.00
8	Remove and reinstall rear bumper reverse sensors to assist repair	\$ 80 100.00
9	Remove and reinstall rear inner garnish and trims to assist repair	\$ 60 280.00
10	Test drive and adjust wheel alignment system	\$ 80 180.00
11	Remove and replace rear undecarriage parts to assist repair	\$ 750? 480.00
12	Remove and replace rear RH door inner mechansim to new door	\$ 60 120.00

Agreed Amount: _____ (Part by Part / Lump sum)

Working days: _____

Spare Parts: \$ 9,534.69
Special Nett: \$ 800.00
Labour: \$ 5,060.00

Total Amount: \$ 15,394.69

Tanpin 97495779
WP 28/3/23 @1045
tanpin @ lkharts.com
06 days

LKK Auto Consultants hence notify the Repairer of the following:

- To resurvey before/after spray painting
- To display damaged part(s) during resurvey
- Parts prices are subject to confirmation
- Third party survey is on a "Without Prejudice" basis
- No illegal modification(s) is allowed
- Supplementary item(s) must be resurveyed and is subject to final approval from Insurance Company

Acknowledged by Repairer

Signature:

Date:

L/S Resurvey after repair
To check consistency of accident
To check ~~the~~ part prices

> **Back to OneMotoring**

Enquire PARF/COE Rebate for Registered Vehicle

Vehicle Owner Particulars

Owner ID Type: Singapore NRIC
Owner ID: 885H

Vehicle Details

Vehicle No.: SJX6875H
Vehicle to be Exported: Yes
Intended Deregistration Date: 24 Mar 2023
Vehicle Make: NISSAN
Vehicle Model: SYLPHY 1.5L 4AT ABS D/AB 2WD 4DR
Primary Colour: Blue
Manufacturing Year: 2010
Engine No.: HR15395470B
Chassis No.: JN1BAAG11Z0111310
Maximum Power Output: 80.0 kW (107 bhp)
Open Market Value: \$17,195.00
Original Registration Date: 01 Jul 2010
First Registration Date: 01 Jul 2010
Transfer Count: 0
Actual ARF Paid: \$17,195.00

Intended PARF Rebate Details

PARF Eligibility: Forfeited
PARF Eligibility Expiry Date: -
PARF Rebate Amount: \$0.00

Intended COE Rebate Details

COE Expiry Date: 30 Jun 2025
COE Category: A - Car (1600cc & below)
COE Period(Years): 5
PQP Paid: \$16,438.00
COE Rebate Amount: \$7,451.00
Total Rebate Amount: \$7,451.00

Message

Please note that the 5-year COE for this vehicle cannot be further renewed. The vehicle must be de-registered upon COE expiry or when the vehicle reaches its statutory lifespan (if applicable), whichever is earlier.

The information contained herein is correct as at 24 Mar 2023

OK

SINGAPORE ACCIDENT STATEMENT

IMPORTANT NOTICE

1. Please report correctly the details of the accident to speed up the claims process.
2. This Form must be completed by the Policyholder and/or the Actual Driver.
3. Information provided must be as truthful and accurate as possible. Any wilful misrepresentation or withholding of material facts may allow insurance companies to repudiate policy liability.
4. The issue and acceptance of this Form by insurance companies is not an admission of policy liability on the part of the insurance companies.
5. Any false reporting may be referred to the Police for investigation.
6. This report will be forwarded by the insurers of the GIA Records Management Centre established by the General Insurance Association of Singapore (GIA) for archiving and that copies of this report will, for a fee, be made available upon application by interested parties.
7. By the lodgement of this report to the insurers, you hereby consent to the archiving of this report at the centre and to copies of the report being made available aforesaid.

ACCIDENT STATEMENT

Date of Submission	23/03/2023 17:35 (SGT)
Reported by	Actual Driver
Date of Accident	23/03/2023 13:43 (SGT)
Exact Location of Accident	Upper Serangoon Rd, Singapore
Additional Location Information	-
Country/State of Loss	Singapore

DETAILS OF OWN VEHICLE

Vehicle Registration Number	SJX6875H
-----------------------------	----------

INSURED/POLICYHOLDER

Is company?	No
Name Of Registered Owner	LOO POH YEAT
NRIC No	S2594885H
Email Address	OLIVER.LAI@GMAIL.COM
Mobile Phone No	(Phone) +65-98431870
Alternative Phone No	-

VEHICLE PARTICULARS

Manufacturer	Nissan
Model	Sylphy
Variant	SYLPHY 1.5L 4AT ABS D/AB 2WD 4DR
Exact purpose for which vehicle was being used at time of accident	Private use
Are you claiming under your own insurance policy for repair to your vehicle?	No - Claiming third party
Vehicle Category	Private car
Transmission	Auto
CC	1498

INSURANCE COMPANY

Name of Insurance Company	Direct Asia Insurance (Singapore) Pte Ltd
Policy Number / Cover Note Number	MT/00991926

DRIVER

Name of Driver	LAI WO HING ALBERT
NRIC No	S2594884Z
Date Of Birth	24/02/1947
Occupation	Indoor

Date Of Driving Pass	30/07/1991
Driving experience	31 YEARS AND 8 MONTHS
Gender	Male
Mobile Number	(Phone) +65-90051723
Alt. Phone Number	-
Email Address	OLIVER.LAI@GMAIL.COM
Address	231 HOUGANG ST 21
Address complement	#13-322
Postcode	530231
Is the driver the policyholder?	No
If No, Relationship of the Driver with the Insured	Spouse
Does Driver Own Other Vehicles?	No
Vehicle Registration Number of Other Vehicle Owned by Driver	-
Insurance Company of Other Vehicle Owned by Driver	-

GENERAL INFORMATION OF THE ACCIDENT

Type of Accident	Collision - Cross Junction
Weather Conditions	Clear
Road Surface	Dry

OTHER INFORMATION

Was any foreign vehicle involved in the accident?	No
Number of vehicles involved in the accident	2
Was anybody injured in the Accident?	No
Was any injured conveyed to hospital by ambulance?	-
Was any other vehicle or property damaged?	Yes
Number of Passengers (Including Driver)	3
Has the driver been approached by unknown person(s) soliciting/offering accident claims assistance?	No
Translator's name	-
Translator's ID	-
Translator's phone number	-
Translator's email	-
Original language used in the statement	-

PASSENGER 1

Name	LOO POH YEAT
Gender	Female

PASSENGER 2

Name	ISAAC LAI
Gender	Male

DETAILS OF POLICE ACTION

Was the accident reported to the police?	No
Was notice of intended Prosecution given?	No
If yes, against whom?	-

CIRCUMSTANCES OF ACCIDENT

PLS REFER TO THE SKETCH PLAN BY DRIVER

ATTACHMENT(S)

Are accident photos available for attachment?	Yes
Was there any video captured by Car Camera?	Yes

DETAILS OF OTHER VEHICLE PROPERTY 1

Vehicle Registration Number	XE6603K
Vehicle Manufacturer	-
Vehicle Model	-
Vehicle Variant	-
Vehicle Colour	-
Vehicle Category	Commercial vehicle
Name of Driver	YANG XIAOHONG
Passport No/FIN	G8184809U
Contact Number	(Phone) +65-91596398
Address	-
Address complement	-
Postcode	-
Insurance Company Name	-
Nature Of Damage	-
Details of property damaged in accident	-
No. Of Passenger (Including Driver)	-

SKETCH PLANIMPORTANT NOTICE

1. Please report correctly the details of the accident to speed up the claims process.
2. This Form must be completed by the Policyholder and/or the Authorised Driver.
3. Information provided must be as truthful and accurate as possible. Any wilful misrepresentation or withholding of material facts may allow insurance companies to repudiate policy liability.
4. The issue and acceptance of this Form by insurance companies is not an admission of policy liability on the part of the insurance companies.
5. Any false reporting may be referred to the Police for investigation.
6. The report will be forwarded by the insurers of the GIA Records Management Centre established by the General Insurance Association of Singapore (GIA) for archiving and that copies of this report will for a fee be made available upon application by interested parties.
7. By the lodgment of this report to the insurers, you hereby consent to the archiving of this report at the centre and to copies of the report being made available aforesaid.
8. **Consent under the Personal Data Protection Act (PDPA)**

I understand, acknowledge, agree and consent that:

- (a) My insurer, my workshop and the General Insurance Association of Singapore ("GIA") may/are permitted to collect, use, disclose and/or process my personal data/personal information set out in this [form] and any other personal information provided by me or possessed by my insurer (collectively the "Personal Information") and disclose and transfer such Personal Information to all insurer(s) who have insured vehicle(s) involved in this accident (all insurer(s) who have insured vehicle(s) involved in this accident shall be collectively referred to as the "Insurers"), the Insurers' lawyers/law firms, the Monetary Authority of Singapore and any relevant government agency/authority (such as the police), for the purpose(s) of:
 - (i) processing, handling and/or dealing with my claims including the settlement of the claims and any necessary investigations relating to the claims;
 - (ii) investigating the accident and/or my claims;
 - (iii) carrying out and/or dealing with my instructions or responding to any enquiries by me;
 - (iv) administering my claims (including the mailing of correspondence, statements, invoices, reports or notices to me, which could involve disclosure of certain personal data about me to bring about delivery of the same as well as on the external cover of envelopes/mail packages); and/or
 - (v) complying with applicable law in administering, processing, handling and/or dealing with my claims (collectively the "Purposes")
- (b) all insurer(s) who have insured vehicle(s) involved in this accident and the Insurers' lawyers/law firms, may/are permitted to collect, use, disclose and/or process my Personal Information for one or more of the above Purposes; and
- (c) my Personal Information may/can be disclosed by any of the Insurers and/or GIA to their third party service providers or agents (including their lawyers/law firms), which may be sited outside of Singapore, for one or more of the above Purposes.
- (d) my Personal Information will also be collected and used to compile claims history for the purpose of fraud detection, investigation and management in present and all future claims.
- (e) the information so collected under (d) above may be shared / disclosed:
 - (i) to all insurers and/or any other third parties that assist in evaluating, investigating, controlling or managing fraud, regulators, law enforcement and government agencies as reasonably required for the purposes stated, or
 - (ii) for complying with requirements under any regulations, laws or court orders.

Policyholder's Signature
Date & Time:

Driver's Signature
(If driver is not the policyholder)
Date & Time:

Reporting Centre Personnel's Signature
Name:
NRIC/FIN No.:

Date of accident: 12/2/23 Time: 1:43pm Location: Upper Serangoon Rd.
 My Vehicle A: SJX 6895H Vehicle B: XE6603K Vehicle C: —

SKETCH PLAN

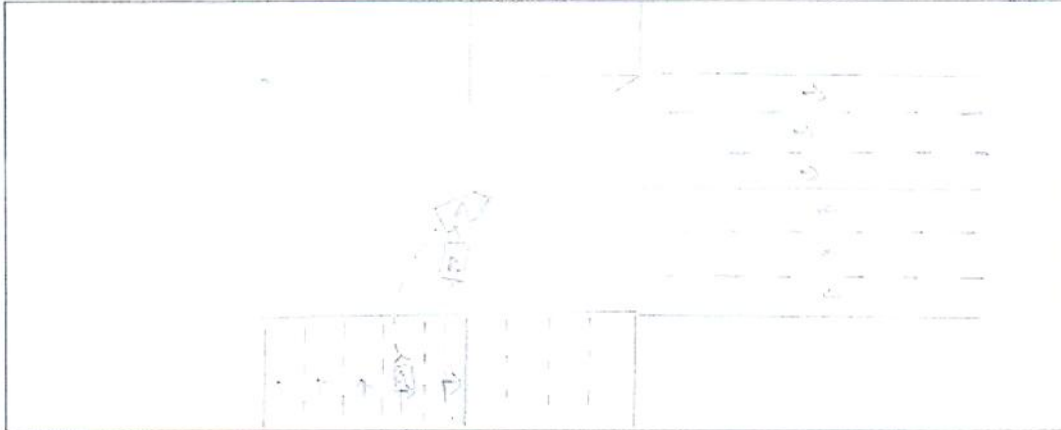

DESCRIBE CIRCUMSTANCES OF THE ACCIDENT

The traffic light has turn green, I start to turn right. In the middle of turning, this heavy vehicle ram onto the right hind side of my car, I think the heavy vehicle is going at a fast speed while turning, because after the impact, it keeps on pushing my car for a short time before managing to stop. My car is on the lane 2, the heavy vehicle is on lane 1 when trying to turn. The accident occurred on the Junction of upper serangoon road and Tampines road, at 1:43pm, 23/03/2023.

* Claim Third Party.

☐ Claim OD/TP at Ah Lim Motor ☐ Claim OD/TP at other workshop ☐ Reporting Only

Remarks: Please forward a copy of my efile accident report to:

My workshop:

Email address:

& myself:

Email address:

Note: Please take note that your insurer have 14 days timeframe for you to submit own damage claim under your own policy. Kindly check with your own insurer for more information.

DECLARATION

I/We declare the foregoing particulars are true in every respect.

Policyholder's Signature
Date & Time:

Driver's Signature
(If driver is not the policyholder)
Date & Time:

Reporting Centre Personnel's Signature
Name:
NRIC/FIN No.: