

SINGAPORE ACCIDENT STATEMENT

IMPORTANT NOTICE

1. Please report correctly the details of the accident to speed up the claims process.
2. This Form must be completed by the Policyholder and/or the Actual Driver
3. Information provided must be as truthful and accurate as possible. Any wilful misrepresentation or withholding of material facts may allow insurance companies to repudiate policy liability.
4. The issue and acceptance of this Form by insurance companies is not an admission of policy liability on the part of the insurance companies.
5. **Any false reporting may be referred to the Police for investigation.**
6. This report will be forwarded by the insurers of the GIA Records Management Centre established by the General Insurance Association of Singapore (GIA) for archiving and that copies of this report will, for a fee, be made available upon application by interested parties.
7. By the lodgement of this report to the insurers, you hereby consent to the archiving of this report at the centre and to copies of the report being made available aforesaid.

ACCIDENT STATEMENT

Date of Submission	22/02/2023 16:14 (SGT)
Reported by	Owner
Date of Accident	22/02/2023 08:45 (SGT)
Exact Location of Accident	Singapore
Additional Location Information	HAVELOCK ROAD
Country/State of Loss	Singapore

DETAILS OF OWN VEHICLE

Vehicle Registration Number	SKV636U
-----------------------------------	---------

INSURED/POLICYHOLDER

Is company?	No
Name Of Registered Owner	SHANTI BHATTACHARYA MRS TAUUVY JEAN-LOUIS
NRIC No	S1563334D
Email Address	SHANTITAUUVY@HOTMAIL.COM
Mobile Phone No	(Phone) +65-97779549
Alternative Phone No	-

VEHICLE PARTICULARS

Manufacturer	Mercedes
Model	C180
Variant	-
Exact purpose for which vehicle was being used at time of accident	-
Are you claiming under your own insurance policy for repair to your vehicle?	No - Claiming third party
Vehicle Category	Private car
Transmission	Auto
CC	1595

INSURANCE COMPANY

Name of Insurance Company	AIG Asia Pacific Insurance Pte. Ltd.
Policy Number / Cover Note Number	2100426537-07

DRIVER

Name of Driver	TAUVY NICOLAS SANJAY
NRIC No	S9639646E
Date Of Birth	05/11/1996
Occupation	Indoor

Date Of Driving Pass	08/10/2016
Driving experience	6 YEARS AND 4 MONTHS
Gender	Male
Mobile Number	(Phone) +65-97779549
Alt. Phone Number	-
Email Address	NO@EMAIL.COM
Address	42 KIM YAM ROAD #25-01
Address complement	-
Postcode	239347
Is the driver the policyholder?	No
If No, Relationship of the Driver with the Insured	Child
Does Driver Own Other Vehicles?	No
Vehicle Registration Number of Other Vehicle Owned by Driver	-
Insurance Company of Other Vehicle Owned by Driver	-

GENERAL INFORMATION OF THE ACCIDENT

Type of Accident	Collision - Head to Rear
Weather Conditions	Clear
Road Surface	Dry

OTHER INFORMATION

Was any foreign vehicle involved in the accident?	No
Number of vehicles involved in the accident	2
Was anybody injured in the Accident?	No
Was any injured conveyed to hospital by ambulance?	-
Was any other vehicle or property damaged?	Yes
Number of Passengers (Including Driver)	1
Has the driver been approached by unknown person(s) soliciting/offering accident claims assistance?	No
Translator's name	-
Translator's ID	-
Translator's phone number	-
Translator's email	-
Original language used in the statement	-

DETAILS OF POLICE ACTION

Was the accident reported to the police?	No
Was notice of intended Prosecution given?	No
If yes, against whom?	-

CIRCUMSTANCES OF ACCIDENT

COMING FROM SAIBO STREET TURNING LEFT INTO HAVELOCK ROAD AT GREEN LIGHT I ENGAGED AND STOPPED FOR PEDESTRIANS TO CROSS. WHILE I WAS STOPPED, THE WHITE HONDA BEHIND ME BUMPED INTO MY REAR END.

ATTACHMENT(S)

Are accident photos available for attachment?	Yes
Was there any video captured by Car Camera?	No

DETAILS OF OTHER VEHICLE PROPERTY 1

Vehicle Registration Number	S1815CD
Vehicle Manufacturer	Honda
Vehicle Model	-
Vehicle Variant	-
Vehicle Colour	White
Vehicle Category	Private car
Name of Driver	-

Contact Number	-
Address	-
Address complement	-
Postcode	-
Insurance Company Name	Allianz Insurance Singapore Pte. Ltd.
Nature Of Damage	-
Details of property damaged in accident	-
No. Of Passenger (Including Driver)	1

SKETCH PLAN

IMPORTANT NOTICE

1. Please report correctly the details of the accident to speed up the claims process.
2. This Form must be completed by the Policyholder and/or the Authorised Driver.
3. Information provided must be as truthful and accurate as possible. Any willful misrepresentation or withholding of material facts may allow insurance companies to repudiate policy liability.
4. The issue and acceptance of this Form by insurance companies is not an admission of policy liability on the part of the insurance companies.
5. Any false reporting may be referred to the Police for investigation.
6. The report will be forwarded by the Insurers of the GIA Records Management Centre established by the General Insurance Association of Singapore (GIA) for archiving and that copies of this report will for a fee be made available upon application by interested parties.
7. By the lodgement of this report to the Insurers, you hereby consent to the archiving of this report at the centre and to copies of the report being made available aforesaid.
8. Consent under the Personal Data Protection Act (PDPA)
I understand, acknowledge, agree and consent that:
(a) My insurer, my workshop and the General Insurance Association of Singapore ("GIA") may/are permitted to collect, use, disclose and/or process my personal data/personal information set out in this [form] and any other personal information provided by me or possessed by my insurer (collectively the "Personal Information") and disclose and transfer such Personal Information to all insurer(s) who have insured vehicle(s) involved in this accident (all insurer(s) who have insured vehicle(s) involved in this accident shall be collectively referred to as the "Insurers"); the Insurers' law yers/law firms, the Monetary Authority of Singapore and any relevant government agency/authority (such as the police), for the purpose(s) of :
(i) processing, handling and/or dealing with my claims including the settlement of the claims and any necessary investigations relating to the claims;
(ii) investigating the accident and/or my claims;
(iii) carrying out and/or dealing with my instructions or responding to any enquiries by me;
(iv) administering my claims (including the mailing of correspondence, statements, invoices, reports or notices to me, which could involve disclosure of certain personal data about me to bring about delivery of the same as well as on the external cover of envelopes/mail packages); and/or
(v) complying with applicable law. In administering, processing, handling and/or dealing with my claims:
(collectively the "Purposes")
(b) all insurer(s) who have insured vehicle(s) involved in this accident and the Insurers' law yers/law firms, may/are permitted to collect, use, disclose and/or process my Personal Information for one or more of the above Purposes; and
(c) my Personal Information may/can be disclosed by any of the Insurers and/or GIA to their third party service providers or agents (including their law yers/law firms), which may be sited outside of Singapore, for one or more of the above Purposes.

8/8 Not 22/02/2023
3.00pm

Policyholder's Signature / Date & Time:

Driver's Signature (if driver is not the policyholder) / Date & Time

Go Chee Han
DID : 6771 4336 HP : 9181 7717
Email : cheehan.go@cyclearrangement.com.sg
Cycle & Carriage Industries Pte Ltd
Customer Service Centre - Pandan Loop
Witnessed by Reporting Centre Personnel

Sketch Plan

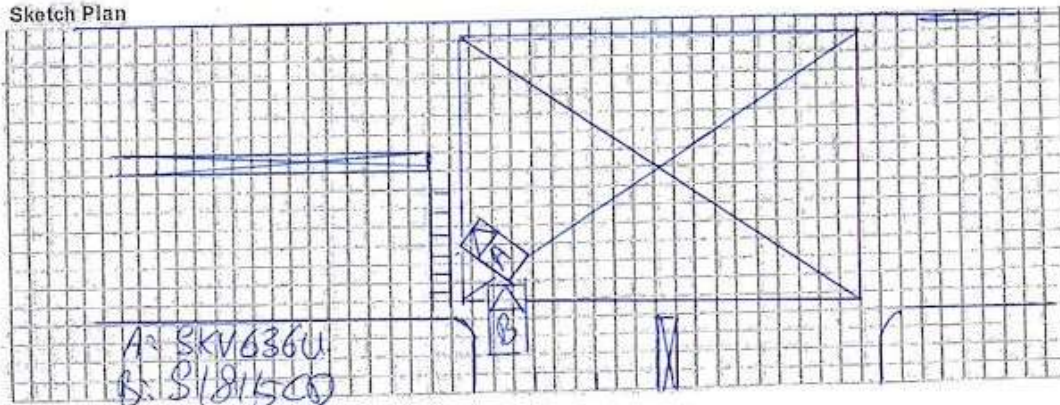

Describe Circumstances of the Accident

Coming from Seabo St turning left into Hawdock Rd
at green light I engaged and stopped for pedestrians to
cross. While I was stopped, the white Honda behind me
bumped into my rear end.

Declaration

We declare the foregoing particulars are true in every respect.

Go Chee Han
DID: 6771 4336 HP: 9181 7717
Email: cheehan.go@cyclecarnage.com.sg
Cycle & Carriage Industries Pte Ltd
Customer Service Centre - Pandan Loop

SB Red 22/02/2023
Policyholder's Signature / Date &
Time

Driver's Signature (If driver is not the policyholder) / Date
& Time

Witnessed by Reporting Centre
Personnel



CERTIFICATE OF INSURANCE

MERCEDES-BENZ MOTOR INSURANCE PRIVATE VEHICLE

Name of Policyholder	: Shanti Bhattacharya Mrs Tauvy Jean-Louis	Vehicle No.	: SKV636U
Period of Insurance	: 28 Aug 2022 To 27 Aug 2023	Policy No.	: 2100426537-07
Engine No.	: 27491030409180	Endorsement No.	:
Chassis No.	: WDD2050402R083891	Issued Date	: 29 Jun 2022 10:46

ABOUT THE COVER

Make/Model	: MERCEDES BENZ C180 SEDAN AVANTGARDE / EXCLUSIVE		
Engine Capacity/Tonnage	: 1,595.00 CC	Sum Insured	: Market Value
Driver Restriction	: NA	Off Peak Car	: No
First Year of Registration	: 2015		
Insuring with COE/PARF	: Yes		

Person or Classes of Persons Entitled to Drive*

a) The Policyholder
 b) Any other person who is driving on the Policyholder's order or with his/her permission.
 This Policy will indemnify the Policyholder or any authorised driver only if he/she meets the specified age condition.

You have to pay an additional sum of S\$33,000 as "Young and/or Inexperienced Driver Excess" ("YIDR") if You are or Your Authorised Driver (named or unnamed) is under the age of 23 and/or has less than 2 years' driving experience.

Age Condition : All Age Condition

Mileage Condition : Unlimited Mileage

Limitation as to use*

Use only for social, domestic and pleasure purposes and for the Policyholder's business.
 This Policy does not cover use for hire or reward, driving tuition, driving test, racing, pace-making, reliability trial or speed-testing, the carriage of goods other than samples in connection with any trade or business or use for any purpose in connection with Motor Trade.

Loss of Use 2000cc

* Limitations rendered inoperative by Section 8 of the Motor Vehicles (Third-Party Risks and Compensation) Act (Cap. 189), Section 95 of the Road Transport Act, 1987 (Malaysia) and Road Transport (Amendment) Act 2019, are not to be included under these headings.

EXCESS

Section 1

Fire - \$0 Own Damage - \$800 Theft - \$0 Flood Cover - \$800

Section 2

Property Damage - \$0

Windscreen : \$100

Named Driver and Excess (where applicable)

Shanti Bhattacharya Mrs Tauvy Jean-Louis - \$800 (Own Damage), \$800 (Flood Cover)

APPROVED REPORTING CENTRES/AUTHORISED REPAIRERS (FOR CLAIMS RELATED REPAIRS)

1.Cycle & Carriage Eunus Service Center (For accident reporting only) Add: 330 Ubi Road 3 Singapore 408650 62061818
 2.Cycle & Carriage Pandan Loop Service Center - Body Care & Repair Add: 188 Pandan Loop Singapore 128378 62061818

For other Approved Reporting Centres/AIG Authorised Repairers, please contact our 24-hour accident emergency hotline at +65 6338 6200. Alternatively, you may refer to AIG website www.aig.sg or AIG SG Mobile App. Simply search and download "AIG SG" from iTunes or Google Play.

IMPORTANT NOTES

Hire Purchase Company/Employer's Loan: NA

I/We hereby certify that the policy to which this Certificate of Insurance relates is issued in accordance with the provisions of the Motor Vehicles(Third Party Risks and Compensation) Act (Cap. 189), Part IV of the Road Transport Act, 1987 (Malaysia), Road Transport (Amendment) Act 2019 and Motor Vehicles (Third Party Risks) Rules, 1959 (Malaysia).

0500660346

CYCLE & CARRIAGE - EUGENE

239 ALEXANDRA ROAD

SINGAPORE 159930 ANSP-MOTOR

Underwritten by AIG Asia Pacific Insurance Pte. Ltd.

AIG Asia Pacific Insurance Pte. Ltd.

This computer generated document does not require a signature.

85P00C





















