

SINGAPORE ACCIDENT STATEMENT

IMPORTANT NOTICE

1. Please report correctly the details of the accident to speed up the claims process.
2. This Form must be completed by the Policyholder and/or the Actual Driver
3. Information provided must be as truthful and accurate as possible. Any wilful misrepresentation or withholding of material facts may allow insurance companies to repudiate policy liability.
4. The issue and acceptance of this Form by insurance companies is not an admission of policy liability on the part of the insurance companies.
5. **Any false reporting may be referred to the Police for investigation.**
6. This report will be forwarded by the insurers of the GIA Records Management Centre established by the General Insurance Association of Singapore (GIA) for archiving and that copies of this report will, for a fee, be made available upon application by interested parties.
7. By the lodgement of this report to the insurers, you hereby consent to the archiving of this report at the centre and to copies of the report being made available aforesaid.

ACCIDENT STATEMENT

Date of Submission	14/11/2022 14:04 (SGT)
Reported by	Driver
Date of Accident	12/11/2022 15:23 (SGT)
Exact Location of Accident	Jln Sultan, Singapore
Additional Location Information	JALAN SULTAN ROAD, BEFORE MINTO ROAD LEFT-MOST LANE TOWARDS BEACH ROAD
Country/State of Loss	Singapore

DETAILS OF OWN VEHICLE

Vehicle Registration Number	SFS1889A
-----------------------------------	----------

INSURED/POLICYHOLDER

Is company?	No
Name Of Registered Owner	CHUA SWEE TECK
NRIC No	SXXXX107E
Email Address	ST.CHUA@MEGASTAR.COM.SG
Mobile Phone No	(Phone) +65-96420106
Alternative Phone No	-

VEHICLE PARTICULARS

Manufacturer	Audi
Model	A3
Variant	SEDAN 1.0 TFSI 8V
Exact purpose for which vehicle was being used at time of accident	Private use
Are you claiming under your own insurance policy for repair to your vehicle?	No - Claiming third party
Vehicle Category	Private car
Transmission	Auto
CC	999

INSURANCE COMPANY

Name of Insurance Company	AIG Asia Pacific Insurance Pte. Ltd.
Policy Number / Cover Note Number	1800071455-04

DRIVER

Name of Driver	CHERYL CHUA JIA YUN
NRIC No	SXXXX107Z
Date Of Birth	17/02/1995

Occupation	Indoor
Date Of Driving Pass	17/07/2014
Driving experience	8 YEARS AND 4 MONTHS
Gender	Female
Mobile Number	(Phone) +65-96203649
Alt. Phone Number	-
Email Address	CHERYLCHUAJY@HOTMAIL.COM
Address	124 JALAN SIMPANG BEDOK
Address complement	-
Postcode	488232
Is the driver the policyholder?	No
If No, Relationship of the Driver with the Insured	Child
Does Driver Own Other Vehicles?	No
Vehicle Registration Number of Other Vehicle Owned by Driver	-
Insurance Company of Other Vehicle Owned by Driver	-

GENERAL INFORMATION OF THE ACCIDENT

Type of Accident	Collision - Major/Minor Rd
Weather Conditions	Raining
Road Surface	Wet

OTHER INFORMATION

Was any foreign vehicle involved in the accident?	No
Number of vehicles involved in the accident	2
Was anybody injured in the Accident?	No
Was any injured conveyed to hospital by ambulance?	-
Was any other vehicle or property damaged?	Yes
Number of Passengers (Including Driver)	1
Has the driver been approached by unknown person(s) soliciting/offering accident claims assistance?	No
Translator's name	-
Translator's ID	-
Translator's phone number	-
Translator's email	-
Original language used in the statement	-

DETAILS OF POLICE ACTION

Was the accident reported to the police?	No
Was notice of intended Prosecution given?	No
If yes, against whom?	-

CIRCUMSTANCES OF ACCIDENT

MY CAR (SFS 1889 A) WAS TRAVELLING ON THE LEFT-MOST LANE OF JALAN SULTAN ROAD TOWARDS BEACH ROAD ON 12 NOV 2022, AT 3.23 PM. THE TRAFFIC CONDITION IN MY LANE WAS SMOOTH, NO CAR STOPPED IN FRONT OF ME UNTIL ABOUT 500M AHEAD. AN ACCIDENT OCCURRED JUST BEFORE SLIP ROAD OF MINTO ROAD. I WAS APPROACHING THE YELLOW BOX AND TRAVELLING AT ABOUT 50KM/H. AT ABOUT 3.23 PM, BLUE MERCEDES SMY 9238 L CAME INTO MY RIGHT PERIPHERAL VISION. SMY 9238 L WAS MAKING A RIGHT TURN INTO MINTO ROAD, CUTTING ACROSS 3 LANES OF JALAN SULTAN. SMY 9238 L MANAGED TO CROSS THE FIRST 2 LANES AND MAINTAINED ACCELERATION TO CROSS MY LANE WITHOUT STOPPING TO CHECK IF THE LANE WAS CLEAR. UPON SMY 9238 L COMING INTO MY VISION FIELD, I HIT THE BRAKES HARD, SMY 9238 L DID NOT BRAKE, AND THE CARS COLLIDED. A DAMAGE TO MY CAR ON THE BUMPER, GRILLE, AND NUMBER PLATE. SMY 9238 L INSISTED THAT HE WAS COMING FROM MY RIGHT SIDE AND THERE WAS A YELLOW BOX BUT I WAS NOT OBLIGED TO BE IN THE BOX AS THERE WAS CLEAR TRAFFIC.

ATTACHMENT(S)

Are accident photos available for attachment?	Yes
Was there any video captured by Car Camera?	Yes

DETAILS OF OTHER VEHICLE PROPERTY 1

Vehicle Registration Number	SMY9238L
Vehicle Manufacturer	Mercedes
Vehicle Model	GLB200
Vehicle Variant	-
Vehicle Colour	Blue
Vehicle Category	Private car
Name of Driver	AVEN CHOO
Contact Number	(Phone) +65-97398578
Address	-
Address complement	-
Postcode	-
Insurance Company Name	-
Nature Of Damage	-
Details of property damaged in accident	-
No. Of Passenger (Including Driver)	-

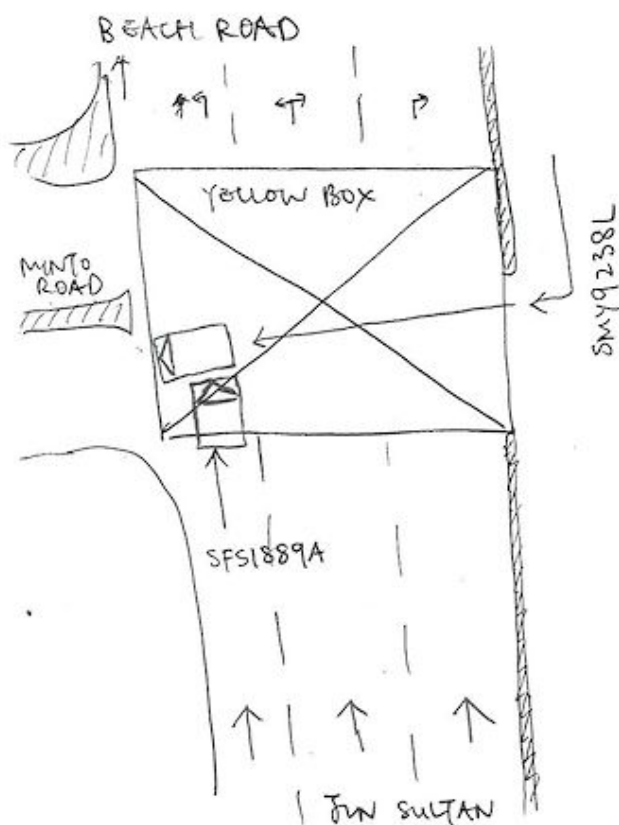

14/11/22
9.19 AM

Describe Circumstances of the Accident

- MY CAR (SFS 1889A) WAS TRAVELLING ON LEFT MOST LANE OF JLN SULTAN RD TOWARDS BEACH RD ON 12 NOV 2022, 3-23PM
- TRAFFIC CONDITION ON MY LANE WAS SMOOTH, NO CAR STOPPED IN FRONT OF ME UNTIL ABOUT 500M AHEAD
- ACCIDENT OCCURED JUST BEFORE SLP ROAD OF MINTO ROAD, I WAS APPROACHING YELLOW BOX AND TRAVELLING AT ABOUT 50 KM/H
- AT ABOUT 3-23PM, BLUE MERCEDES SMY9238L CAME INTO MY RIGHT PERIPHERAL VISION. SMY9238L WAS MAKING A RIGHT TURN INTO MINTO ROAD, CUTTING ACROSS 3 LANES OF JLN SULTAN
- SMY9238L MANAGED TO CROSS FIRST 2 LANES AND MAINTAINED ACCELERATION TO CROSS MY LANE WITHOUT STOPPING TO CHECK IF THE LANE IS CLEAR
- UPON SMY9238L COMING INTO MY VISION FIELD, I HIT THE BRAKES HARD, SMY9238L DID NOT BRAKE AND CARS COLLIDED
- A DAMAGES TO MY CAR ON THE BUMPER, GRILL AND NUMBER PLATE
- SMY9238L INSISTS THAT HE WAS COMING FROM MY RIGHT SIDE AND THERE IS A YELLOW BOX BUT I WAS NOT OBLIGED TO BE IN THE BOX AS THERE WAS CLEAR TRAFFIC.

Declaration

We declare the foregoing particulars are true in every respect.

Policyholder's Signature / Date & Time

Driver's Signature (If driver is not the policyholder) / Date & Time

Witnessed by Reporting Centre Personnel



Tony Foong

































