

ASS. REC. BY:

REP:

ASSIGNMENT

From: _____ Date: _____

Estimated Cost: _____

OD / TP / WS / TP RES / OD RES / EVA / INV / MV

To Inspect Vehicle No: _____

at Workshop m/s _____

of _____

Insured: _____

Policy No. _____

Claims No. _____

Sum Insured: _____ Excess: _____

(Client's Record)

Make of Veh: _____

(Policy Condition)

Remark: The veh had commenced its
repair at the time of inspection.

N/S	O/S

Bal. or Market Value: _____

IDAC Accident Rpt: _____ Consistent?: Yes or No

GIA / PR Seen: _____ Consistent?: Yes or No

Est. Repairs: _____ days Res.: Yes or No

Lum Sum: _____ % 3 Val.: Yes or No

CA / REV / REP. / 24 HRS

Date: _____ Person Contacted: _____

Vehicle: IN / OUT

Veh No: SFS1889A Yr Regn: 2018, June

Type: M.Car / M.Cycle / Bus / Van / Lorry / Taxi / Prime Mover /

Truck / Trailer or

Make: Andi A3 c.c. 999

Colour: White A/C: Insured / Std / NI / NA

Sp. Reading: 107399 T/Radio: Insured / Std / NI / NA

Eng/No: _____

C/No: WAUZZ28V8J1057881

Gen. Cond: Good / Fair / Poor / Burnt

Steering: Inorder / Jammed / Leaked / Burnt or

Brake: Inorder / Jammed / Leaked / Burnt or

Modi: Nil / S/Rim / STD A/Rim or

Tyre Size: F: 205/55R16

R: 205/55R16

BS / DUN / EXNOVA / GY / FS / LIZA / MIC / OHTSU / PIR / SUMI /

TOYO / YOKO or

Front R/Bal. 06 mm

L/Bal. 06 mm

D.O.A. _____ D.O.I. 17/11/22

Survey held at Premium

Des. of Damages: Frt / Rear / O/S / N/S / U/C / Rooftop or

The U/C / Chassis frame / Body Structure affected due to collision.

Date / Time	Action / Instruction
	<u>TP ALG</u>
	<u>MV:</u>
	<u>PV:</u>
	<u>Nett:</u>

Date/Time, File Pass to?

☐ : Preli. Report

1) _____
Date/Time, File Return to?

☐ : Final Report

2) _____

Days Of Repair: _____

Resurvey No. of Trip: _____

Survey Fee: _____

Transportation: _____

Add Fee: ☐ : Site Insp (\$ _____)

☐ : Interview (\$ _____)

☐ : Tech. Invs (\$ _____)

Photos

Others

Report Format: _____

SINGAPORE ACCIDENT STATEMENT

IMPORTANT NOTICE

1. Please report correctly the details of the accident to speed up the claims process.
2. This Form must be completed by the Policyholder and/or the Actual Driver
3. Information provided must be as truthful and accurate as possible. Any wilful misrepresentation or withholding of material facts may allow insurance companies to repudiate policy liability.
4. The issue and acceptance of this Form by insurance companies is not an admission of policy liability on the part of the insurance companies.
5. Any false reporting may be referred to the Police for investigation.
6. This report will be forwarded by the insurers of the GIA Records Management Centre established by the General Insurance Association of Singapore (GIA) for archiving and that copies of this report will, for a fee, be made available upon application by interested parties.
7. By the lodgement of this report to the insurers, you hereby consent to the archiving of this report at the centre and to copies of the report being made available aforesaid.

ACCIDENT STATEMENT

Date of Submission	14/11/2022 14:04 (SGT)
Reported by	Driver
Date of Accident	12/11/2022 15:23 (SGT)
Exact Location of Accident	Jln Sultan, Singapore
Additional Location Information	JALAN SULTAN ROAD, BEFORE MINTO ROAD LEFT-MOST LANE TOWARDS BEACH ROAD
Country/State of Loss	Singapore

DETAILS OF OWN VEHICLE

Vehicle Registration Number	SFS1889A
INSURED/POLICYHOLDER	
Is company?	No
Name Of Registered Owner	CHUA SWEE TECK
NRIC No	SXXXX107E
Email Address	ST.CHUA@MEGASTAR.COM.SG
Mobile Phone No	(Phone) +65-96420106
Alternative Phone No	-

VEHICLE PARTICULARS

Manufacturer	Audi
Model	A3
Variant	SEDAN 1.0 TFSI 8V
Exact purpose for which vehicle was being used at time of accident	Private use
Are you claiming under your own insurance policy for repair to your vehicle?	No - Claiming third party
Vehicle Category	Private car
Transmission	Auto
CC	999

INSURANCE COMPANY

Name of Insurance Company	AIG Asia Pacific Insurance Pte. Ltd.
Policy Number / Cover Note Number	1800071455-04

DRIVER

Name of Driver	CHERYL CHUA JIA YUN
NRIC No	SXXXX107Z
Date Of Birth	17/02/1995

Occupation	Indoor
Date Of Driving Pass	17/07/2014
Driving experience	8 YEARS AND 4 MONTHS
Gender	Female
Mobile Number	(Phone) +65-96203649
Alt. Phone Number	-
Email Address	CHERYLCHUAJY@HOTMAIL.COM
Address	124 JALAN SIMPANG BEDOK
Address complement	-
Postcode	488232
Is the driver the policyholder?	No
If No, Relationship of the Driver with the Insured	Child
Does Driver Own Other Vehicles?	No
Vehicle Registration Number of Other Vehicle Owned by Driver	-
Insurance Company of Other Vehicle Owned by Driver	-

GENERAL INFORMATION OF THE ACCIDENT

Type of Accident	Collision - Major/Minor Rd
Weather Conditions	Raining
Road Surface	Wet

OTHER INFORMATION

Was any foreign vehicle involved in the accident?	No
Number of vehicles involved in the accident	2
Was anybody injured in the Accident?	No
Was any injured conveyed to hospital by ambulance?	-
Was any other vehicle or property damaged?	Yes
Number of Passengers (Including Driver)	1
Has the driver been approached by unknown person(s) soliciting/offering accident claims assistance?	No
Translator's name	-
Translator's ID	-
Translator's phone number	-
Translator's email	-
Original language used in the statement	-

DETAILS OF POLICE ACTION

Was the accident reported to the police?	No
Was notice of intended Prosecution given?	No
If yes, against whom?	-

CIRCUMSTANCES OF ACCIDENT

MY CAR (SFS 1889 A) WAS TRAVELLING ON THE LEFT-MOST LANE OF JALAN SULTAN ROAD TOWARDS BEACH ROAD ON 12 NOV 2022, AT 3.23 PM. THE TRAFFIC CONDITION IN MY LANE WAS SMOOTH, NO CAR STOPPED IN FRONT OF ME UNTIL ABOUT 500M AHEAD. AN ACCIDENT OCCURRED JUST BEFORE SLIP ROAD OF MINTO ROAD. I WAS APPROACHING THE YELLOW BOX AND TRAVELLING AT ABOUT 50KM/H. AT ABOUT 3.23 PM, BLUE MERCEDES SMY 9238 L CAME INTO MY RIGHT PERIPHERAL VISION. SMY 9238 L WAS MAKING A RIGHT TURN INTO MINTO ROAD, CUTTING ACROSS 3 LANES OF JALAN SULTAN. SMY 9238 L MANAGED TO CROSS THE FIRST 2 LANES AND MAINTAINED ACCELERATION TO CROSS MY LANE WITHOUT STOPPING TO CHECK IF THE LANE WAS CLEAR. UPON SMY 9238 L COMING INTO MY VISION FIELD, I HIT THE BRAKES HARD, SMY 9238 L DID NOT BRAKE, AND THE CARS COLLIDED. A DAMAGE TO MY CAR ON THE BUMPER, GRILLE, AND NUMBER PLATE. SMY 9238 L INSISTED THAT HE WAS COMING FROM MY RIGHT SIDE AND THERE WAS A YELLOW BOX BUT I WAS NOT OBLIGED TO BE IN THE BOX AS THERE WAS CLEAR TRAFFIC.

ATTACHMENT(S)

Are accident photos available for attachment?	Yes
Was there any video captured by Car Camera?	Yes

DETAILS OF OTHER VEHICLE PROPERTY 1

Vehicle Registration Number	SMY9238L
Vehicle Manufacturer	Mercedes
Vehicle Model	GLB200
Vehicle Variant	-
Vehicle Colour	Blue
Vehicle Category	Private car
Name of Driver	AVEN CHOO
Contact Number	(Phone) +65-97398578
Address	-
Address complement	-
Postcode	-
Insurance Company Name	-
Nature Of Damage	-
Details of property damaged in accident	-
No. Of Passenger (Including Driver)	-

SKETCH PLAN

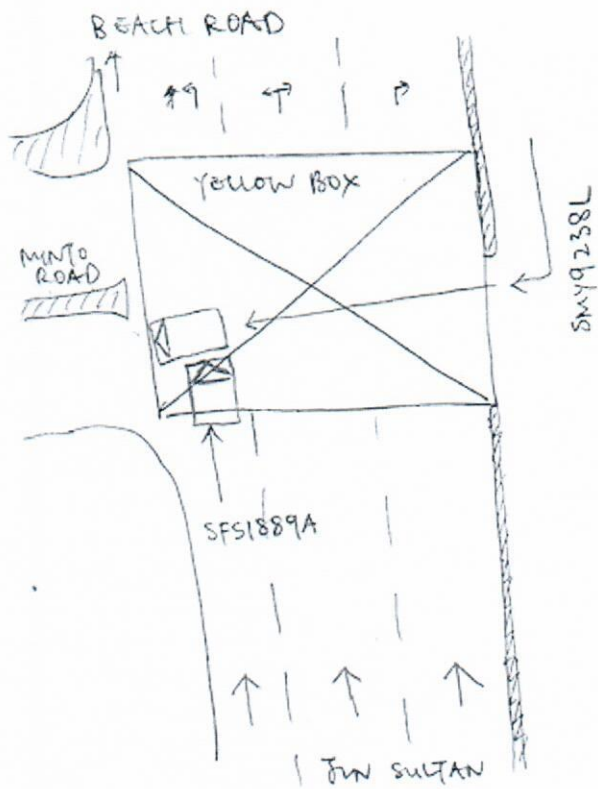

14/11/22
9:19 AM

Describe Circumstances of the Accident

- MY CAR (SFS1889A) WAS TRAVELLING ON LEFT MOST LANE OF JLN SULTAN RD TOWARDS BEACH RD ON 12 NOV 2022, 3:23PM
- TRAFFIC CONDITION ON MY LANE WAS SMOOTH, NO CAR STOPPED IN FRONT OF ME UNTIL ABOUT 500M AHEAD
- ACCIDENT OCCURED JUST BEFORE SHIP ROAD OF MINTO ROAD, I WAS APPROACHING YELLOW BOX AND TRAVELLING AT ABOUT 50 KM/H
- AT ABOUT 3:23PM, BLUE MERCEDES SMY9238L CAME INTO MY RIGHT PERIPHERAL VISION. SMY9238L WAS MAKING A RIGHT TURN INTO MINTO ROAD, CUTTING ACROSS 3 LANES OF JLN SULTAN
- SMY9238L MANAGED TO CROSS FIRST 2 LANES AND MAINTAINED ACCELERATION TO CROSS MY LANE WITHOUT STOPPING TO CHECK IF THE LANE IS CLEAR
- UPON SMY9238L COMING INTO MY VISION FIELD, I HIT THE BRAKES HARD, SMY9238L DID NOT BRAKE AND CARS COLLIDED
- A DAMAGES TO MY CAR ON THE BUMPER, GRILL AND NUMBER PLATE
- SMY9238L INSISTS THAT HE WAS COMING FROM MY RIGHT SIDE AND THERE IS A YELLOW BOX BUT I WAS NOT OBLIGED TO BE IN THE BOX AS THERE WAS CLEAR TRAFFIC.

Declaration

I/We declare the foregoing particulars are true in every respect.

Policyholder's Signature / Date &
Time

Driver's Signature (If driver is not the policyholder) / Date & Time

Witnessed by Reporting Centre
Personnel 7

Personnel Tony Foong

55 UBI ROAD 1, SINGAPORE 408699
TEL : 6366 2323 FAX : 6841 1183
EMAIL: NORA.KHAI@PREMIUMAUTO.COM.SG / CLAIMS@PREMIUMAUTO.COM.SG

ESTIMATE : ACCIDENT REPAIRS
WORKSHOP : UBI ROAD 1
CONTACT NO : 6366 2323
FAX NO : 6841 1183
REFERENCE : PA/TP/01015/2022/EQ
DATE : 16-Nov-22
WIP : 50513

VEHICLE NOT IN WORKSHOP. KINDLY ARRANGE FOR SURVEY ON 17/11/2022
YOUR INSURED VEH NO : SMY 9238 L

AIG Asia Pacific Insurance Pte Ltd
78 Shenton Way
#07-16 AIG Building
Singapore 079120
Attn: Motor Claims Dept

OWNER'S NAME : MR CHUA SWEE TECK
ADDRESS : 124 JALAN SIMPANG BEDOK
SINGAPORE 488232

TELEPHONE : HP +65 96420106
TYPE OF CLAIM : THIRD PARTY CLAIM
POLICY NO : 1800071455-04
VEHICLE NO : **SFS 1889 A**
MODEL CODE : AUDI A3 SEDAN 1.0 TFSI 8V
MODEL YEAR : 20/6/2018
ENGINE NO : CHZ 439381
CHASSIS NO : WAUZZZ8V8J1057881
MILEAGE : -
DATE IN : -
ESTIMATED BY : JOHNNY BOO / ALLAN WU
ACCIDENT DATE : 12-Nov-22
PLACE OF ACCIDENT : JALAN SULTAN ROAD, BEFORE MINTO ROAD
LEFT-MOST LANE TOWARDS BEACH ROAD

55 UBI ROAD 1, SINGAPORE 408699

TEL : 6366 2323 FAX : 6841 1183

EMAIL: NORA.KHAI@PREMIUMAUTO.COM.SG / CLAIMS@PREMIUMAUTO.COM.SG

ESTIMATED LABOUR CHARGES FOR ACCIDENT VEHICLE SFS 1889 A

S/N	NATURE OF JOBS	ESTIMATED CHARGES	SURVEYOR'S RECOMMENDATIONS
1	TO REMOVE, CHECK AND TRANSFER FRONT WIRE HARNESS FOR HEADLIGHTS, HORNS, OUTSIDE TEMPERATURE SENSOR AND HEADLIGHT WASHER ASSY.	S/N \$ 360.00	✓
2	TO DISMANTLE AND RENEW FRONT BUMPER. RE- ORGANIZE CRASH MANAGEMENT COMPONENTS. REINSTALL ALL PARTS REMOVED.	\$ 1,050.00	500
3	TO RESPRAY FRONT BUMPER.	\$ 900.00	550
4	TO CARRY OUT DIAGNOSTIC CHECK.	S/N \$ 192.00	✓
TOTAL LABOUR CHARGES		: \$ 2,502.00	

55 UBI ROAD 1, SINGAPORE 408699
 TEL : 6366 2323 FAX : 6841 1183
 EMAIL: NORA.KHAI@PREMIUMAUTO.COM.SG / CLAIMS@PREMIUMAUTO.COM.SG

MATERIAL LIST FOR ACCIDENT VEHICLE REGN NO. SFS 1889 A

			DAMAGED PARTS & PRICES		
S/N	PARTS DESCRIPTION	QTY	S/NETT		REMARKS
1	FRONT BUMPER <i>Repair</i>	1	\$	2,432.00	<i>X</i>
2	FRONT BUMPER FIXING PARTS <i>new</i>	1	\$	195.00	<i>+</i>
3	FRONT BUMPER GRILLE - CENTER	1	\$	179.00	<i>+</i>
4	FRONT BUMPER CLOSING ELEMENT - LOWER CENTRE <i>new</i>	1	\$	571.00	<i>+</i>
5	FRONT BUMPER CLOSING ELEMENT - RH <i>new</i>	1	\$	318.00	<i>+</i>
6	FRONT BUMPER TRIM COVER - RH	1	\$	182.00	<i>+</i>
7	FRONT WHEEL HOUSING LINER ADAPTER - RH <i>new</i>	1	\$	42.00	<i>+</i>
8	RADIATOR GRILLE <i>cut</i>	1	\$	1,578.00	<i>✓</i>
9	RADIATOR GRILLE CLOSING ELEMENT <i>new</i>	1	\$	210.00	<i>+</i>
10	AIR CONDITIONER STICKER <i>new</i>	1	\$	9.00	<i>✓</i>
11	CAUTION SIGN STICKER	1	\$	16.00	<i>✓</i>
12	RADIATOR AIR GUIDE GRILLE - RH <i>new</i>	1	\$	210.00	<i>+</i>
13	FRONT BUMPER REINFORCEMENT BEAM <i>new</i>	1	\$	847.00	<i>+</i>
14	FRONT BUMPER FOAM FILLER PIECE <i>new</i>	1	\$	211.00	<i>+</i>
15	FRONT BUMPER REINFORCEMENT BEAM COVER <i>new</i>	1	\$	136.00	<i>+</i>
16	HORN LOW TONE - RH	1	\$	213.00	<i>+</i>
17	RADIATOR AIR GUIDE - RH <i>new</i>	1	\$	28.00	<i>+</i>
18	RADIATOR AIR GUIDE OUTER SEAL - RH <i>new</i>	1	\$	9.00	<i>+</i>
19	RADIATOR AIR GUIDE - UPPER CENTRE <i>new</i>	1	\$	14.00	<i>+</i>
20	OUTSIDE TEMPERATURE SENSOR BRACKET	1	\$	21.00	<i>+</i>
SUB TOTAL SPARE PARTS		:	\$	7,421.00	

ALL CHARGES ARE NOT INCLUSIVE OF GST

LEGEND: REMARKS (OK) = APPROVED, REMARKS (X) = NOT APPROVED
 SPARE PARTS ARE SPECIAL NETT.

55 UBI ROAD 1, SINGAPORE 408699
 TEL : 6366 2323 FAX : 6841 1183
 EMAIL: NORA.KHAI@PREMIUMAUTO.COM.SG / CLAIMS@PREMIUMAUTO.COM.SG

MATERIAL LIST FOR ACCIDENT VEHICLE REGN NO. SFS 1889 A

			DAMAGED PARTS & PRICES	
S/N	PARTS DESCRIPTION	QTY	S/NETT	REMARKS
21	FRONT NO PLATE <i>Dented</i>	S/N	\$ 60.00	✓
22	SUNDRIES <i>?</i>		\$ 400.00	?
TOTAL SPARE PARTS		:	\$ 7,881.00	
TOTAL LABOUR CHARGES		:	\$ 2,502.00	
GRAND TOTAL		:	\$ 10,383.00	

ALL CHARGES ARE NOT INCLUSIVE OF GST

LEGEND: REMARKS (OK) = APPROVED, REMARKS (X) = NOT APPROVED
 SPARE PARTS ARE SPECIAL NETT.

55 UBI ROAD 1, SINGAPORE 408699

TEL : 6366 2323 FAX : 6841 1183

EMAIL: NORA.KHAI@PREMIUMAUTO.COM.SG / CLAIMS@PREMIUMAUTO.COM.SG

NAME : *Adrian Ly*
SURVEYED DATE : *17/11/22*
AUTHORISED DATE :
EXCESS COST :
LIABILITY :
REMARKS : *we Authorised, 03 Days*

PLEASE NOTE : THIS ESTIMATE IS BASED ON VISUAL INSPECTION OF THE AFFECTED VEHICLE. SHOULD WE REQUIRE FURTHER LABOUR CHARGES AND SPARE PARTS IN THE PROGRESS OF REPAIR, WE SHALL INFORM YOU ACCORDINGLY. FOR INSPECTION OF VEHICLE, PLEASE REFER TO MS. NORAH KHAI AT TEL: 6768 9828 / 6768 9911 FOR APPOINTMENT.

YOURS FAITHFULLY,
PREMIUM AUTOMOBILES PTE LTD

LKK Auto Consultants hence notify the Repairer of the following:

- To resurvey before/after spray painting
- To display damaged part(s) during resurvey
- Parts prices are subject to confirmation
- Third party survey is on a "Without Prejudice" basis
- No illegal modification(s) is allowed
- Supplementary item(s) must be resurveyed and is subject to final approval from Insurance Company

Acknowledged by Repairer

Signature:

Date:

JOHNNY BOO
BODY REPAIR MANAGER

ALLAN WU
CLAIMS CONSULTANT