

## SINGAPORE ACCIDENT STATEMENT

### IMPORTANT NOTICE

1. Please report correctly the details of the accident to speed up the claims process.
2. This Form must be completed by the Policyholder and/or the Actual Driver
3. Information provided must be as truthful and accurate as possible. Any wilful misrepresentation or withholding of material facts may allow insurance companies to repudiate policy liability.
4. The issue and acceptance of this Form by insurance companies is not an admission of policy liability on the part of the insurance companies.
5. Any false reporting may be referred to the Police for investigation.
6. This report will be forwarded by the insurers of the GIA Records Management Centre established by the General Insurance Association of Singapore (GIA) for archiving and that copies of this report will, for a fee, be made available upon application by interested parties.
7. By the lodgement of this report to the insurers, you hereby consent to the archiving of this report at the centre and to copies of the report being made available aforesaid.

### ACCIDENT STATEMENT

Date of Submission	13/10/2022 17:37 (SGT)
Reported by	Both
Date of Accident	12/10/2022 19:20 (SGT)
Exact Location of Accident	Alexandra Rd, Singapore
Additional Location Information	SLIP ROAD OF ALEXANDRA ROAD TOWARDS JALAN BUKIT MERAH
Country/State of Loss	Singapore

### DETAILS OF OWN VEHICLE

Vehicle Registration Number	SLS3512C
-----------------------------	----------

#### INSURED/POLICYHOLDER

Is company?	No
Name Of Registered Owner	WOON PENG KEE
NRIC No	SXXXX966H 865D
Email Address	NAUTOMARINE@GMAIL.COM
Mobile Phone No	(Phone) +65-91790933
Alternative Phone No	-

#### VEHICLE PARTICULARS

Manufacturer	Honda
Model	Odyssey
Variant	-
Exact purpose for which vehicle was being used at time of accident	Private use
Are you claiming under your own insurance policy for repair to your vehicle?	No - Claiming third party
Vehicle Category	Private car
Transmission	Auto
CC	2400

#### INSURANCE COMPANY

Name of Insurance Company	Income Insurance Limited
Policy Number / Cover Note Number	5112717277-03

#### DRIVER

Name of Driver	WOON PENG KEE
NRIC No	SXXXX966H
Date Of Birth	18/04/1964

Occupation	Outdoor
Date Of Driving Pass	15/06/1984
Driving experience	38 YEARS AND 4 MONTHS
Gender	Male
Mobile Number	(Phone) +65-91790933
Alt. Phone Number	-
Email Address	NAUTOMARINE@GMAIL.COM
Address	453 JURONG WEST STREET 42
Address complement	03-100
Postcode	640453
Is the driver the policyholder?	Yes
If No, Relationship of the Driver with the Insured	-
Does Driver Own Other Vehicles?	No
Vehicle Registration Number of Other Vehicle Owned by Driver	-
Insurance Company of Other Vehicle Owned by Driver	-

#### GENERAL INFORMATION OF THE ACCIDENT

Type of Accident	Collision - Head to Rear
Weather Conditions	Clear
Road Surface	Dry

#### OTHER INFORMATION

Was any foreign vehicle involved in the accident?	No
Number of vehicles involved in the accident	2
Was anybody injured in the Accident?	No
Was any injured conveyed to hospital by ambulance?	-
Was any other vehicle or property damaged?	Yes
Number of Passengers (Including Driver)	2
Has the driver been approached by unknown person(s) soliciting/offering accident claims assistance?	No
Translator's name	-
Translator's ID	-
Translator's phone number	-
Translator's email	-
Original language used in the statement	-

#### PASSENGER 1

Name	PASSENGER
Gender	Female

#### DETAILS OF POLICE ACTION

Was the accident reported to the police?	No
Was notice of intended Prosecution given?	No
If yes, against whom?	-

#### CIRCUMSTANCES OF ACCIDENT

PLEASE REFER TO SKETCH PLAN ATTACHED

#### ATTACHMENT(S)

Are accident photos available for attachment?	Yes
Was there any video captured by Car Camera?	No

#### DETAILS OF OTHER VEHICLE PROPERTY 1

Vehicle Registration Number	SLV2035D
Vehicle Manufacturer	-
Vehicle Model	-

Vehicle Variant	-
Vehicle Colour	-
Vehicle Category	Private car
Name of Driver	-
Contact Number	-
Address	-
Address complement	-
Postcode	-
Insurance Company Name	-
Nature Of Damage	-
Details of property damaged in accident	-
No. Of Passenger (Including Driver)	-



SKETCH PLAN

IMPORTANT NOTICE

1. Please report correctly the details of the accident to speed up the claims process.
  2. This Form must be completed by the Policyholder and/or the Actual Driver.
  3. Information provided must be as truthful and accurate as possible. Any wilful misrepresentation or withholding of material facts may allow insurance companies to repudiate policy liability.
  4. The issue and acceptance of this Form by insurance companies is not an admission of policy liability on the part of the insurance companies.
  5. Any false reporting may be referred to the Traffic Police Department for investigation.
  6. This report will be forwarded by the insurers to the GIA Records Management Centre established by the General Insurance Association of Singapore (GIA) for archiving and that copies of this report will for a fee be made available upon application by interested parties.
  7. By the lodgement of this report to the insurers, you hereby consent to the archiving of this report at the centre and to copies of the report being made available aforesaid.
8. Consent under the Personal Data Protection Act (PDPA)
- I understand, acknowledge, agree and consent that:
- (a) My insurer, my workshop and the General Insurance Association of Singapore ("GIA") may/are permitted to collect, use, disclose and/or process my personal data/personal information set out in this [form] and any other personal information provided by me or possessed by my insurer (collectively the "Personal Information") and disclose and transfer such Personal Information to all insurer(s) who have insured vehicle(s) involved in this accident (all insurer(s) who have insured vehicle(s) involved in this accident shall be collectively referred to as the "Insurers"), the Insurers' lawyers/law firms, the Monetary Authority of Singapore and any relevant government agency/authority (such as the police), for the purpose(s) of:
- (i) processing, handling and/or dealing with my claims including the settlement of the claims and any necessary investigations relating to the claims;
- (ii) investigating the accident and/or my claims;
- (iii) carrying out and/or dealing with my instructions or responding to any enquiries by me;
- (iv) administering my claims (including the mailing of correspondence, statements, invoices, reports or notices to me, which could involve disclosure of certain personal data about me to bring about delivery of the same as well as on the external cover of envelopes/mail packages); and/or
- (v) complying with applicable law in administering, processing, handling and/or dealing with my claims.
- (collectively the "Purposes")
- (b) all insurer(s) who have insured vehicle(s) involved in this accident and the Insurers' lawyers/law firms, may/are permitted to collect, use, disclose and/or process my Personal Information for one or more of the above Purposes; and
- (c) my Personal Information may/can be disclosed by any of the Insurers and/or GIA to their third-party service providers or agents (including their lawyers/law firms), which may be sited outside of Singapore, for one or more of the above Purposes.

Policyholder's Signature (Date & Time)

Driver's Signature (if driver is not the policyholder) / Date & Time

Witnessed by Reporting Centre Personnel  
(Name as in NRIC/D card)

Sketch Plan

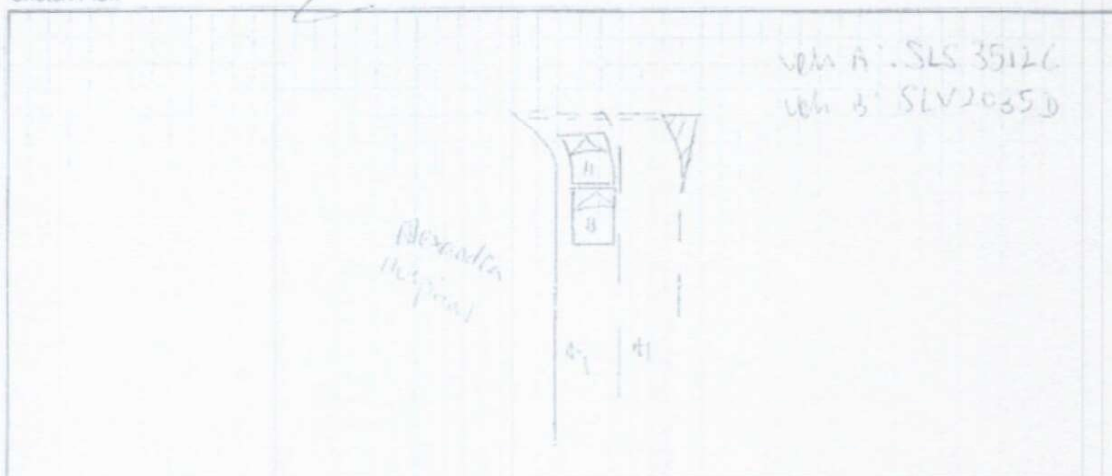

Describe Circumstance of the Accident

Attached /  
the  
to  
Refer

Declaration

I/we declare the foregoing particulars are true in every respect

  
Reporting Centre's Signature - Date & Time

  
Driver's Signature (If driver is not the policyholder's Exor  
- S. Talor



Witnessed by Reporting Centre Personnel  
(Name as in HR/CRD card)

On the stated date and time. I, Vehicle A (SLS3512C) was stationary on Slip Road of Alexandra Road Towards Jalan Bukit Timah to check for incoming car from the main road for clearance before moving off. Suddenly I felt a huge impact from the rear portion of my stationary vehicle. After I alighted I then realise that is Vehicle B (SLV2035D) that had collided onto my vehicle.

I wish to state that I got 1 passenger in my car.

**Vehicle A : SLS3512C**

**Vehicle B : SLV2035D**

