

NATIONAL Assessment Centre Services

Date In 22/09/22	Job description	Date & Time Completed	Done by
Ref No NA/C722009348/13	SAS e-filing		
Veh No XE599D	E-mail (within 3hrs, APC 2hrs)		
DOA 21/09/22 0950	i-Motor Claim Form		
OD/ TP/ <u>Reporting Only</u>	i-Motor W/O (Within: OD 2hrs, TP 4hrs)		
	i-Photo Uploaded		
TP Insurer:	Assessment/Survey Report		
	Ass't Report by Fax / Hand to Owner/Wksp		

Preferred Wksp / INC Assign Wksp / QW: (Tel:	Fax:
TP Particulars:	Veh No: 3772	INC () / Non-INC ()	
Owner / Driver: (Tel: ()	
Policy No: ()	Period: ()	Cover Type: ()	
Confirmed by: (Date:	Time:	
Insured/Driver Liability: ()	[Note-Est. Status (WO): N: 0-20%; P: 21-79%; F: 80-100%]		
Year of Registration: ()	Warranty: YES () / NO ()		
Excess: (\$)	Loading: \$1,000 () / \$2,000 ()		

General Remarks:-

() Walk-In Customer: Customer's information strictly Confidential & Strictly NO refer of repairer.

() Total Loss Case: to e-mail Insurer URGENTLY.

Drive-In () / Towed-In (); Invoice: YES () / NO (); Towing Co. ()

Remarks:- (INC hotline: 6788 6616)	Date & Time Completed	Done by
1) Apply for Transport Allowance () / Courtesy Car ()		
2) QC Check / Post Repair Inspection ()		
3) Upload Resurvey Photo [Repair Cost > \$3000] ()		

Injury:

Date/Time	Actions

NA2202617

Claimant's Particulars :-	Invoice Preparation Checklist	Am't (\$) 1st Bill	Am't (\$) Add Bill
Driver/Owner:	1) AR : Accident Reporting (\$30);		
Contact No:	2) DA : Damage Assessment (\$100); INC (\$80)		
Damaged Portion:	3) TF : Towing Fee \$40/\$45		
QC Checked by (Engr-In-Charge):	4) FT : Follow-Through Survey \$120		
Auditors' Comments :-	5) FT : Follow-Through Survey (Resurvey) \$30		
Cat. 1:	For claiming against INC Only (wef 10 Jan 2005)		
Cat. 2/3:	6) TR : Re-inspection \$75		
	7) N1 : Idac DA + SMRT Survey \$160		
	8) NTUC Additional Services:-		
	ON*		
	*N5: Courtesy Car / Tpt Allowance \$5		
	*N6: Repair Co-ordination \$10		
	*N7: Post Repair Inspection \$25		
	*N8: DV / Collect Excess Coordination \$5		
	TP (N11) : TP (Non INC) against INC \$20		
	9) N12: Idac Mobile \$0		
	Invoice date:	Fee Charged	
	Invoice dated	Fee Charged	

SINGAPORE ACCIDENT STATEMENT

IMPORTANT NOTICE

1. Please report correctly the details of the accident to speed up the claims process.
2. This Form must be completed by the Policyholder and/or the Actual Driver
3. Information provided must be as truthful and accurate as possible. Any wilful misrepresentation or withholding of material facts may allow insurance companies to repudiate policy liability.
4. The issue and acceptance of this Form by insurance companies is not an admission of policy liability on the part of the insurance companies.
5. Any false reporting may be referred to the Police for investigation.
6. This report will be forwarded by the insurers of the GIA Records Management Centre established by the General Insurance Association of Singapore (GIA) for archiving and that copies of this report will, for a fee, be made available upon application by interested parties.
7. By the lodgement of this report to the insurers, you hereby consent to the archiving of this report at the centre and to copies of the report being made available aforesaid.

ACCIDENT STATEMENT

Date of Submission	22/09/2022 16:53 (SGT)
Reported by	Driver
Date of Accident	21/09/2022 09:30 (SGT)
Exact Location of Accident	Fajar Rd, Singapore
Additional Location Information	-
Country/State of Loss	Singapore

DETAILS OF OWN VEHICLE

Vehicle Registration Number	XE599D
-----------------------------	--------

INSURED/POLICYHOLDER

Is company?	Yes
Name Of Registered Owner	YI HUI METALS PTE LTD
Company Reg No	2XXXXX673H
Email Address	jonathan@yihui Metals.com
Mobile Phone No	(Phone) +65-66651808
Alternative Phone No	-

VEHICLE PARTICULARS

Manufacturer	Isuzu
Model	Cyz52r
Variant	-
Exact purpose for which vehicle was being used at time of accident	Employment
Are you claiming under your own insurance policy for repair to your vehicle?	No - Reporting only
Vehicle Category	Commercial vehicle
Transmission	Manual
CC	15681

INSURANCE COMPANY

Name of Insurance Company	China Taiping Insurance (Singapore) Pte. Ltd.
Policy Number / Cover Note Number	DMCVSNW00057582200

DRIVER

Name of Driver	KOO THIAM SIEW
NRIC No	SXXXX439F
Date Of Birth	14/09/1960
Occupation	Outdoor

Date Of Driving Pass	29/03/2005
Driving experience	17 YEARS AND 6 MONTHS
Gender	Male
Mobile Number	(Phone) +65-90881205
Alt. Phone Number	-
Email Address	jonathan@yihuimetals.com
Address	BLK 454 FAJAR RD
Address complement	#10-594
Postcode	670454
Is the driver the policyholder?	No
If No, Relationship of the Driver with the Insured	Employee
Does Driver Own Other Vehicles?	No
Vehicle Registration Number of Other Vehicle Owned by Driver	-
Insurance Company of Other Vehicle Owned by Driver	-

GENERAL INFORMATION OF THE ACCIDENT

Type of Accident	Collided into Parked Vehicle
Weather Conditions	Clear
Road Surface	Dry

OTHER INFORMATION

Was any foreign vehicle involved in the accident?	No
Number of vehicles involved in the accident	2
Was anybody injured in the Accident?	No
Was any injured conveyed to hospital by ambulance?	-
Was any other vehicle or property damaged?	Yes
Number of Passengers (Including Driver)	1
Has the driver been approached by unknown person(s) soliciting/offering accident claims assistance?	No
Translator's name	-
Translator's ID	-
Translator's phone number	-
Translator's email	-
Original language used in the statement	-

DETAILS OF POLICE ACTION

Was the accident reported to the police?	No
Was notice of intended Prosecution given?	No
If yes, against whom?	-

CIRCUMSTANCES OF ACCIDENT

PLS REFER TO THE ATTACHED STATEMENT

ATTACHMENT(S)

Are accident photos available for attachment?	Yes
Was there any video captured by Car Camera?	No

DETAILS OF OTHER VEHICLE PROPERTY 1

Vehicle Registration Number	3773
Vehicle Manufacturer	-
Vehicle Model	-
Vehicle Variant	-
Vehicle Colour	-
Vehicle Category	Private car
Name of Driver	-
Contact Number	-

Address -
Address complement -
Postcode -
Insurance Company Name -
Nature Of Damage -
Details of property damaged in accident -
No. Of Passenger (Including Driver) -

SKETCH PLAN

IMPORTANT NOTICE

1. Please report correctly the details of the accident to speed up the claims process.
2. This Form must be completed by the Policyholder and/or the Actual Driver.
3. Information provided must be as truthful and accurate as possible. Any wilful misrepresentation or withholding of material facts may allow insurance companies to repudiate policy liability.
4. The issue and acceptance of this Form by insurance companies is not an admission of policy liability on the part of the insurance companies.
5. **Any false reporting may be referred to the Traffic Police Department for investigation.**
6. This report will be forwarded by the insurers to the GIA Records Management Centre established by the General Insurance Association of Singapore (GIA) for archiving and that copies of this report will for a fee be made available upon application by interested parties.
7. By the lodgement of this report to the insurers, you hereby consent to the archiving of this report at the centre and to copies of the report being made available aforesaid.

8. Consent under the Personal Data Protection Act (PDPA)

I understand, acknowledge, agree and consent that:

(a) My insurer, my workshop and the General Insurance Association of Singapore ("GIA") may/are permitted to collect, use, disclose and/or process my personal data/personal information set out in this [form] and any other personal information provided by me or possessed by my insurer (collectively the "Personal Information") and disclose and transfer such Personal Information to all insurer(s) who have insured vehicle(s) involved in this accident (all insurer(s) who have insured vehicle(s) involved in this accident shall be collectively referred to as the "Insurers"), the Insurers' lawyers/law firms, the Monetary Authority of Singapore and any relevant government agency/authority (such as the police), for the purpose(s) of:

(i) processing, handling and/or dealing with my claims including the settlement of the claims and any necessary investigations relating to the claims;

(ii) investigating the accident and/or my claims;

(iii) carrying out and/or dealing with my instructions or responding to any enquiries by me;

(iv) administering my claims (including the mailing of correspondence, statements, invoices, reports or notices to me, which could involve disclosure of certain personal data about me to bring about delivery of the same as well as on the external cover of envelopes/mail packages); and/or

(v) complying with applicable law in administering, processing, handling and/or dealing with my claims.

(collectively the "Purposes")

(b) all insurer(s) who have insured vehicle(s) involved in this accident and the Insurers' lawyers/law firms, may/are permitted to collect, use, disclose and/or process my Personal Information for one or more of the above Purposes; and

(c) my Personal Information may/can be disclosed by any of the Insurers and/or GIA to their third-party service providers or agents (including their lawyers/law firms), which may be sited outside of Singapore, for one or more of the above Purposes.

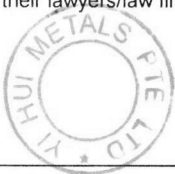

Policyholder's Signature / Date & Time

Actual Driver's Signature (if driver is not the policyholder) / Date & Time

Witnessed by Reporting Centre Personnel
(Name as in NRIC/ID card)

Sketch Plan

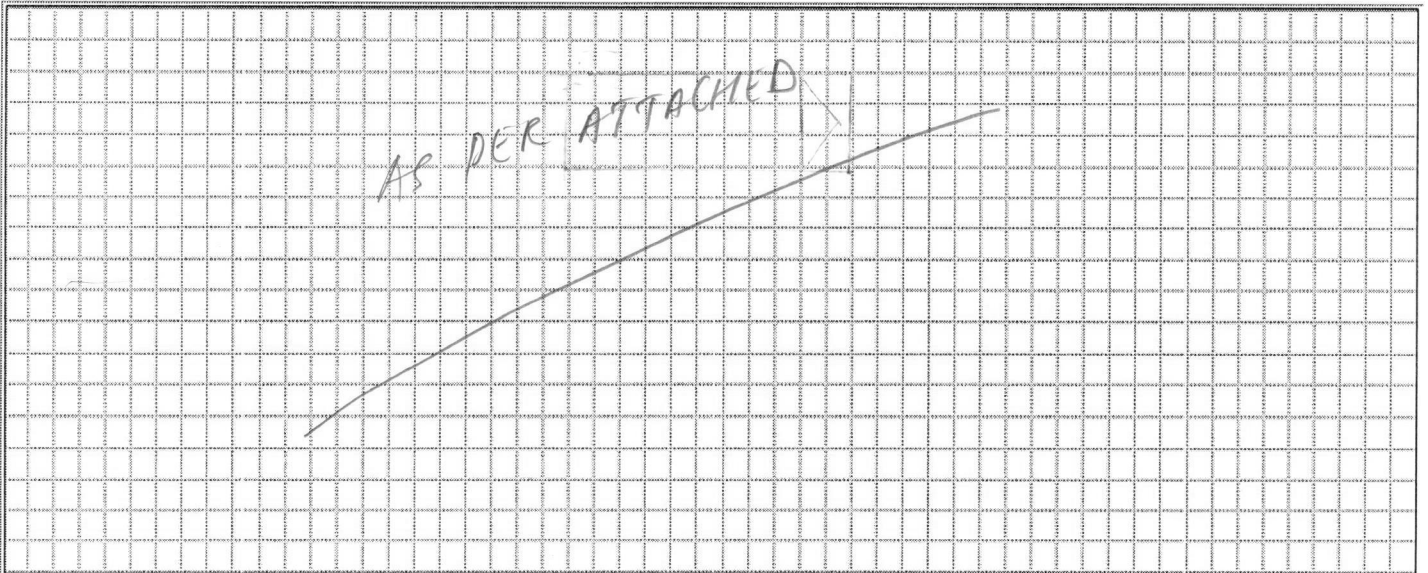

A-XE599D

B-3773

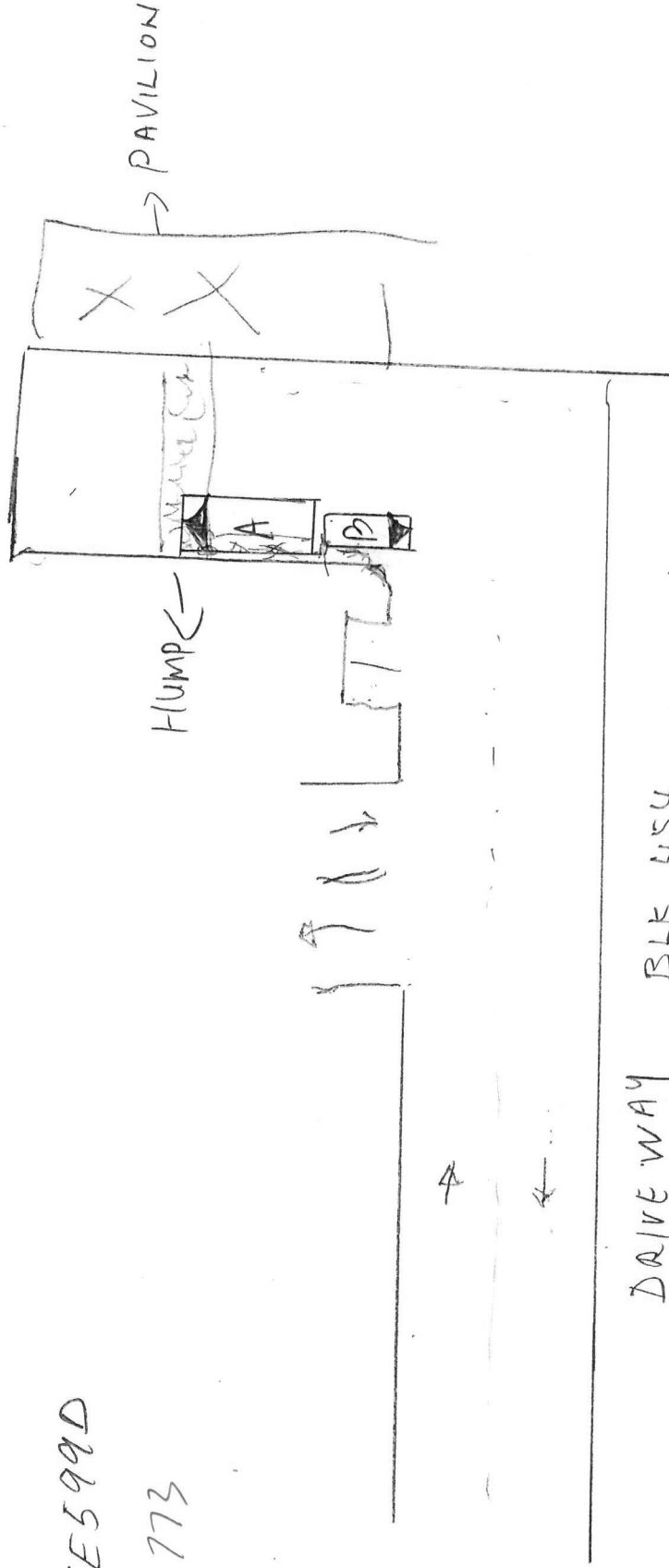

DRIVEWAY BLK 454 X
FAJAR ROAD X

Describe Circumstance of the Accident

- ~~parked at service road beside~~

- parking along service road in front of BLK 454 Fajar rd

- Front wheels is on top of the hump

- B vehicle parking right behind A vehicle & is very close together, not even a distance that a human can walk through

- once I engage my gear the vehicle move backward & ~~hit the~~ ~~hit~~ the B vehicle behind.

Declaration

I/We declare the foregoing particulars are true in every respect.



Policyholder's Signature / Date & Time

Actual Driver's Signature (if driver is not the policyholder)
/ Date & Time

22/09/22

Witnessed by Reporting Centre Personnel
(Name as in NRIC/ID card)

ACCIDENT STATEMENT

ACCIDENT DATE: 21/09/22 (DD/MM/YYYY), TIME: 09:30 (HH:MM)

LOCATION: FAJAR RD

1. DETAILS OF VEHICLE

- a) VEHICLE NUMBER: XE599D
 b) INSURANCE COMPANY: CHINA TAIPING
 c) POLICY NUMBER: OMCVSNW00057582200
 d) POLICY TYPE: (COMPREHENSIVE) THIRD PARTY / THIRD PARTY FIRE & THEFT
 e) MAKE & MODEL: ISUZU CY252R (15681) AUTO / MANUAL
 f) TYPE: (SALOON / COUPE / MPV / VAN / LORRY / MOTORCYCLE / OTHERS)
 g) VEHICLE CATEGORY: (PRIVATE / COMMERCIAL / MOTORCYCLE)
 h) PURPOSE OF USING AT ACCIDENT TIME:
 i) ARE YOU CLAIMING UNDER YOUR OWN INSURANCE (YES/NO)
 IF NO, PLEASE STATE (THIRD PARTY CLAIM / REPORTING ONLY)

2. INSURED / POLICY HOLDER

- a) NAME: YI HUI METALS PTE LTD (MALE / FEMALE)
 b) NRIC/FIN/PASSPORT: 2009036734 CONTACT: 66651808
 c) ADDRESS:

* CONTINUE TO 3.d IF DRIVER ALSO POLICY HOLDER

- DRIVER
 a) NAME: KOO THIAM SIEW (MALE / FEMALE)
 b) NRIC/FIN/PASSPORT: 51448439F CONTACT: 90881205
 c) ADDRESS: BCK 454 FAJAR RD
#10-594 (670454)

* d) DATE OF BIRTH: 14/09/1960 (DD/MM/YYYY)

e) OCCUPATION: (INDOOR / OUTDOOR)

f) YEARS OF DRIVING EXPERIENCE: 29/03/2005

4. WAS DRIVER AN EMPLOYEE OF THE INSURED'S COMPANY? (YES / NO)
 IF NO, RELATIONSHIP OF THE DRIVER WITH INSURED:

5. a) WEATHER CONDITION: (CLEAR / RAINING / OTHERS)

b) ROAD SURFACE: (DRY / WET / OTHERS)

6. WAS ANYBODY INJURED (YES / NO)

7. a) REPORTED TO POLICE (YES / NO)

IF YES, PLEASE STATE WHICH POLICE STATION:

8. THIRD PARTY VEHICLE

- a) VEHICLE NUMBER: 3773 MODEL:
 b) DRIVER'S NAME: NISSAN
 c) NRIC/FIN/PASSPORT: CONTACT:

9. THIRD PARTY VEHICLE

- d) VEHICLE NUMBER: MODEL:
 e) DRIVER'S NAME:
 f) NRIC/FIN/PASSPORT: CONTACT:

No of passenger
 (including driver)
(1)

No of passenger
 (including driver)
()

No of passenger
 (including driver)
()

Email = Jonathan@yihui Metals.com

Fax =

VIDEO =



Motor Commercial

MZ301/C

N SN

AN0712A

Cov. Type:C

CERTIFICATE OF INSURANCE

Motor Vehicles (Third-Party Risks and Compensation) Act (Chapter 189)
Motor Vehicles (Third-Party Risks and Compensation) Rules, 1960
Road Transport Act, 1987 (Malaysia)
Motor Vehicles (Third-Party Risks) Rules, 1959 (Malaysia)

CERTIFICATE No.

DMCVSNW00057582200

Engine No.: 6WG1423953

Cha. No.: JALCYZ52RF7000039

1. Index Mark and Registration
Number of Vehicle

XE599D

AUTOSAFE
=====

2. Name of Policy Holder

YI HUI METALS PTE LTD

3. Effective date of the Commencement of
Insurance for the purposes of the Regulations,
Ordinance or Enactment

05/05/2022
(00:00:00)

Excess Sect I . S\$2,600.00
EX ON WINDSCREEN . S\$100.00

4. Date of Expiry of Insurance

04/05/2023

5. Persons or Classes of Persons entitled to drive*

- (1) Whilst the vehicle is being used in connection with the Policyholder's business
Any person provided he is in the Policyholder's employ and is driving on their order or with their permission.
- (2) Whilst the vehicle is being used for social, domestic or pleasure purposes
Any person who is driving on the Policyholder's order or with their permission.
Provided that the person driving is permitted in accordance with the licensing or other laws or regulations to drive the Motor Vehicle or has been so permitted and is not disqualified by order of a Court of Law or by reason of any enactment or regulation in that behalf from driving the Motor Vehicle.

6. Limitations as to use:

- (1) Use in connection with the Policyholder's business.
(2) Use for the carriage of passengers (other than for hire or reward) in connection with the Policyholder's business.
(3) Use for social, domestic or pleasure purposes.

The Policy does not cover

- (1) Use for racing, pace-making, reliability trial or speed-testing.
(2) Use whilst drawing a trailer except the towing of any one disabled mechanically propelled vehicle.
(3) Use for the carriage of passengers for hire or reward.

** Limitations rendered inoperative by Section 8 of the Motor Vehicles (Third-Party Risks and Compensation) Act (Chapter 189) and Section 95 of the Road Transport Act 1987 (Malaysia), are not to be included under these headings.*

I/We hereby Certify that the policy to which this Certificate relates is issued in accordance with the provisions of the Motor Vehicles (Third-Party Risks and Compensation) Act (Chapter 189) and Part IV of the Road Transport Act, 1987 (Malaysia).

Please see reverse

For CHINA TAIPING INSURANCE (SINGAPORE) PTE. LTD.

Issued By: PLUTUS PRUDENCE PTE. LTD.
Authorised Officer

Authorised Signatory