

SINGAPORE ACCIDENT STATEMENT

IMPORTANT NOTICE

1. Please report correctly the details of the accident to speed up the claims process.
2. This Form must be completed by the Policyholder and/or the Actual Driver
3. Information provided must be as truthful and accurate as possible. Any wilful misrepresentation or withholding of material facts may allow insurance companies to repudiate policy liability.
4. The issue and acceptance of this Form by insurance companies is not an admission of policy liability on the part of the insurance companies.
5. **Any false reporting may be referred to the Police for investigation.**
6. This report will be forwarded by the insurers of the GIA Records Management Centre established by the General Insurance Association of Singapore (GIA) for archiving and that copies of this report will, for a fee, be made available upon application by interested parties.
7. By the lodgement of this report to the insurers, you hereby consent to the archiving of this report at the centre and to copies of the report being made available aforesaid.

ACCIDENT STATEMENT

Date of Submission 06/09/2022 18:58 (SGT)
Reported by Both
Date of Accident 17/08/2022 16:00 (SGT)
Exact Location of Accident Singapore
Additional Location Information MSCP LVL 3 ARC @ M TOWER
Country/State of Loss Singapore

DETAILS OF OWN VEHICLE

Vehicle Registration Number SJD9703G

INSURED/POLICYHOLDER

Is company? No
Name Of Registered Owner WONG SIEW CHEONG
NRIC No SXXXX261D
Email Address sylvesterw@gmail.com
Mobile Phone No (Phone) +65-81110770
Alternative Phone No -

VEHICLE PARTICULARS

Manufacturer Lexus
Model Is 250
Variant -
Exact purpose for which vehicle was being used at time of accident Private use
Are you claiming under your own insurance policy for repair to your vehicle? No - Claiming third party
Vehicle Category Private car
Transmission Auto
CC 2500

INSURANCE COMPANY

Name of Insurance Company AIG Asia Pacific Insurance Pte. Ltd.
Policy Number / Cover Note Number 7220028466

DRIVER

Name of Driver WONG SIEW CHEONG
NRIC No SXXXX261D
Date Of Birth 05/08/1970
Occupation Indoor

| | |
|--|-----------------------|
| Date Of Driving Pass | 27/06/1991 |
| Driving experience | 31 YEARS AND 2 MONTHS |
| Gender | Male |
| Mobile Number | (Phone) +65-81110770 |
| Alt. Phone Number | - |
| Email Address | sylvesterw@gmail.com |
| Address | BLK 221 YISHUN ST 21 |
| Address complement | #05-421 |
| Postcode | 760221 |
| Is the driver the policyholder? | Yes |
| If No, Relationship of the Driver with the Insured | - |
| Does Driver Own Other Vehicles? | No |
| Vehicle Registration Number of Other Vehicle Owned by Driver | - |
| Insurance Company of Other Vehicle Owned by Driver | - |

GENERAL INFORMATION OF THE ACCIDENT

| | |
|--------------------------|---|
| Type of Accident | Hit and run / Vandalism / Damaged whilst parked |
| Weather Conditions | Clear |
| Road Surface | Dry |

OTHER INFORMATION

| | |
|---|-----|
| Was any foreign vehicle involved in the accident? | No |
| Number of vehicles involved in the accident | 2 |
| Was anybody injured in the Accident? | No |
| Was any injured conveyed to hospital by ambulance? | - |
| Was any other vehicle or property damaged? | Yes |
| Number of Passengers (Including Driver) | 0 |
| Has the driver been approached by unknown person(s) soliciting/offering accident claims assistance? | No |
| Translator's name | - |
| Translator's ID | - |
| Translator's phone number | - |
| Translator's email | - |
| Original language used in the statement | - |

DETAILS OF POLICE ACTION

| | |
|---|----|
| Was the accident reported to the police? | No |
| Was notice of intended Prosecution given? | No |
| If yes, against whom? | - |

CIRCUMSTANCES OF ACCIDENT

PLS REFER TO THE ATTACHED STATEMENT

ATTACHMENT(S)

| | |
|---|-----|
| Are accident photos available for attachment? | Yes |
| Was there any video captured by Car Camera? | No |

DETAILS OF OTHER VEHICLE PROPERTY 1

| | |
|-----------------------------------|-------------|
| Vehicle Registration Number | SMU5494K |
| Vehicle Manufacturer | - |
| Vehicle Model | - |
| Vehicle Variant | - |
| Vehicle Colour | - |
| Vehicle Category | Private car |
| Name of Driver | - |
| Contact Number | - |

Address -
Address complement -
Postcode -
Insurance Company Name -
Nature Of Damage -
Details of property damaged in accident -
No. Of Passenger (Including Driver) -

SKETCH PLAN

IMPORTANT NOTICE

1. Please report correctly the details of the accident to speed up the claims process.
2. This Form must be completed by the Policyholder and/or the Actual Driver.
3. Information provided must be as truthful and accurate as possible. Any wilful misrepresentation or withholding of material facts may allow insurance companies to repudiate policy liability.
4. The issue and acceptance of this Form by insurance companies is not an admission of policy liability on the part of the insurance companies.
5. **Any false reporting may be referred to the Traffic Police Department for investigation.**
6. This report will be forwarded by the insurers to the GIA Records Management Centre established by the General Insurance Association of Singapore (GIA) for archiving and that copies of this report will for a fee be made available upon application by interested parties.
7. By the lodgement of this report to the insurers, you hereby consent to the archiving of this report at the centre and to copies of the report being made available aforesaid.
8. **Consent under the Personal Data Protection Act (PDPA)**

I understand, acknowledge, agree and consent that:

- (a) My insurer, my workshop and the General Insurance Association of Singapore ("GIA") may/are permitted to collect, use, disclose and/or process my personal data/personal information set out in this [form] and any other personal information provided by me or possessed by my insurer (collectively the "Personal Information") and disclose and transfer such Personal Information to all insurer(s) who have insured vehicle(s) involved in this accident (all insurer(s) who have insured vehicle(s) involved in this accident shall be collectively referred to as the "Insurers"), the Insurers' lawyers/law firms, the Monetary Authority of Singapore and any relevant government agency/authority (such as the police), for the purpose(s) of:
 - (i) processing, handling and/or dealing with my claims including the settlement of the claims and any necessary investigations relating to the claims;
 - (ii) investigating the accident and/or my claims;
 - (iii) carrying out and/or dealing with my instructions or responding to any enquiries by me;
 - (iv) administering my claims (including the mailing of correspondence, statements, invoices, reports or notices to me, which could involve disclosure of certain personal data about me to bring about delivery of the same as well as on the external cover of envelopes/mail packages); and/or
 - (v) complying with applicable law in administering, processing, handling and/or dealing with my claims.
 (collectively the "Purposes")
- (b) all insurer(s) who have insured vehicle(s) involved in this accident and the Insurers' lawyers/law firms, may/are permitted to collect, use, disclose and/or process my Personal Information for one or more of the above Purposes; and
- (c) my Personal Information may/can be disclosed by any of the Insurers and/or GIA to their third-party service providers or agents (including their lawyers/law firms), which may be sited outside of Singapore, for one or more of the above Purposes.

Policyholder's Signature / Date & Time

Driver's Signature (if driver is not the policyholder) / Date & Time

Witnessed by Reporting Centre Personnel
(Name as in NRIC/ID card)

Sketch Plan

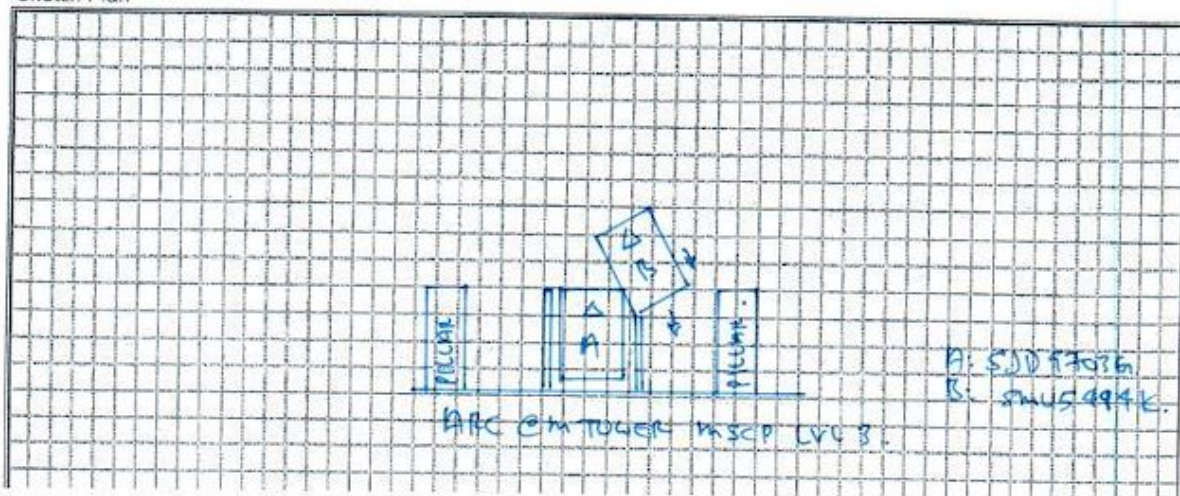

Describe Circumstance of the Accident

ON THE STATED DATE AROUND 1600HRS, I PARKED MY
VEHICLE AND LEFT.

ON THE STATED DATE AROUND 1500HRS, I WENT
BACK AND SAW A NOTE FROM VEH R'S DRIVER STATING
THAT HE APOLOGISED FOR HITTING MY VEHICLE.

I SAW DAMAGES TO MY VEH'S FRONT AND RIGHT
PORTION-

Declaration

I/We declare the foregoing particulars are true in every respect.



Policyholder's Signature / Date & Time

Driver's Signature (if driver is not the policyholder) / Date

shym 06/09/22
Witnessed by Reporting Centre Personnel















