

SINGAPORE ACCIDENT STATEMENT

IMPORTANT NOTICE

1. Please report correctly the details of the accident to speed up the claims process.
2. This Form must be completed by the Policyholder and/or the Actual Driver
3. Information provided must be as truthful and accurate as possible. Any wilful misrepresentation or withholding of material facts may allow insurance companies to repudiate policy liability.
4. The issue and acceptance of this Form by insurance companies is not an admission of policy liability on the part of the insurance companies.
5. **Any false reporting may be referred to the Police for investigation.**
6. This report will be forwarded by the insurers of the GIA Records Management Centre established by the General Insurance Association of Singapore (GIA) for archiving and that copies of this report will, for a fee, be made available upon application by interested parties.
7. By the lodgement of this report to the insurers, you hereby consent to the archiving of this report at the centre and to copies of the report being made available aforesaid.

ACCIDENT STATEMENT

Date of Submission	03/09/2022 09:53 (SGT)
Reported by	Driver
Date of Accident	02/09/2022 15:10 (SGT)
Exact Location of Accident	Claymore Hill, Singapore
Additional Location Information	CLAYMORE HILL
Country/State of Loss	Singapore

DETAILS OF OWN VEHICLE

Vehicle Registration Number	SHB883M
-----------------------------------	---------

INSURED/POLICYHOLDER

Is company?	Yes
Name Of Registered Owner	Strides Taxi Pte Ltd
Company Reg No	1XXXXX369K
Email Address	AUTO-SVCS-TARC@SMRT.COM.SG
Mobile Phone No	(Phone) +65-68662671
Alternative Phone No	-

VEHICLE PARTICULARS

Manufacturer	MG
Model	MG5
Variant	-
Exact purpose for which vehicle was being used at time of accident	-
Are you claiming under your own insurance policy for repair to your vehicle?	No - Claiming third party
Vehicle Category	Taxi
Transmission	Auto
CC	0

INSURANCE COMPANY

Name of Insurance Company	MS First Capital Insurance Ltd
Policy Number / Cover Note Number	D-22099115MFSH

DRIVER

Name of Driver	SIM KENG HONG
NRIC No	SXXXX174J
Date Of Birth	21/09/1962
Occupation	Outdoor

Date Of Driving Pass	17/09/1990
Driving experience	32 YEARS
Gender	Male
Mobile Number	(Phone) +65-68662672
Alt. Phone Number	-
Email Address	AUTO-SVCS-TARC@SMRT.COM.SG
Address	11
Address complement	-
Postcode	-
Is the driver the policyholder?	No
If No, Relationship of the Driver with the Insured	Hirer
Does Driver Own Other Vehicles?	No
Vehicle Registration Number of Other Vehicle Owned by Driver	-
Insurance Company of Other Vehicle Owned by Driver	-

GENERAL INFORMATION OF THE ACCIDENT

Type of Accident	Side Swipe
Weather Conditions	Raining
Road Surface	Wet

OTHER INFORMATION

Was any foreign vehicle involved in the accident?	No
Number of vehicles involved in the accident	2
Was anybody injured in the Accident?	No
Was any injured conveyed to hospital by ambulance?	-
Was any other vehicle or property damaged?	Yes
Number of Passengers (Including Driver)	2
Has the driver been approached by unknown person(s) soliciting/offering accident claims assistance?	No
Translator's name	-
Translator's ID	-
Translator's phone number	-
Translator's email	-
Original language used in the statement	-

PASSENGER 1

Name	UNKNOWN
Gender	Female

DETAILS OF POLICE ACTION

Was the accident reported to the police?	No
Was notice of intended Prosecution given?	No
If yes, against whom?	-

CIRCUMSTANCES OF ACCIDENT

I WAS TRAVELLING STRAIGHT ALONG CLAYMORE HILL TOWARDS SHAW HOUSE WITH A PASSENGER ON BOARD. SUDDENLY A VEHICLE SNE1658D CAME OUT FROM AMERICAN CLUB ON MY LEFT, WITHOUT PROPER LOOKOUT AND COLLIDED ONTO THE LEFT FRONT PORTION OF MY TAXI.

ATTACHMENT(S)

Are accident photos available for attachment?	Yes
Was there any video captured by Car Camera?	No

DETAILS OF OTHER VEHICLE PROPERTY 1

Vehicle Registration Number	SNE1658D
Vehicle Manufacturer	-

Vehicle Model	-
Vehicle Variant	-
Vehicle Colour	-
Vehicle Category	Private car
Name of Driver	-
Contact Number	-
Address	-
Address complement	-
Postcode	-
Insurance Company Name	-
Nature Of Damage	-
Details of property damaged in accident	-
No. Of Passenger (Including Driver)	-

SKETCH PLAN

IMPORTANT NOTICE

1. Please report correctly the details of the accident to speed up the claims process.
2. This Form must be completed by the Policyholder and/or the Actual Driver.
3. Information provided must be as truthful and accurate as possible. Any wilful misrepresentation or withholding of material facts may allow insurance companies to repudiate policy liability.
4. The issue and acceptance of this Form by insurance companies is not an admission of policy liability on the part of the insurance companies.
5. **Any false reporting may be referred to the Traffic Police Department for investigation.**
6. This report will be forwarded by the insurers to the GIA Records Management Centre established by the General Insurance Association of Singapore (GIA) for archiving and that copies of this report will for a fee be made available upon application by interested parties.
7. By the lodgement of this report to the insurers, you hereby consent to the archiving of this report at the centre and to copies of the report being made available aforesaid.

8. Consent under the Personal Data Protection Act (PDPA)

I understand, acknowledge, agree and consent that:

- (a) My insurer, my workshop and the General Insurance Association of Singapore ("GIA") may/are permitted to collect, use, disclose and/or process my personal data/personal information set out in this [form] and any other personal information provided by me or possessed by my insurer (collectively the "Personal Information") and disclose and transfer such Personal Information to all insurer(s) who have insured vehicle(s) involved in this accident (all insurer(s) who have insured vehicle(s) involved in this accident shall be collectively referred to as the "Insurers"), the Insurers' lawyers/law firms, the Monetary Authority of Singapore and any relevant government agency/authority (such as the police), for the purpose(s) of:
- (i) processing, handling and/or dealing with my claims including the settlement of the claims and any necessary investigations relating to the claims;
- (ii) investigating the accident and/or my claims;
- (iii) carrying out and/or dealing with my instructions or responding to any enquiries by me;
- (iv) administering my claims (including the mailing of correspondence, statements, invoices, reports or notices to me, which could involve disclosure of certain personal data about me to bring about delivery of the same as well as on the external cover of envelopes/mail packages); and/or
- (v) complying with applicable law in administering, processing, handling and/or dealing with my claims.
- (collectively the "Purposes")
- (b) all insurer(s) who have insured vehicle(s) involved in this accident and the Insurers' lawyers/law firms, may/are permitted to collect, use, disclose and/or process my Personal Information for one or more of the above Purposes; and
- (c) my Personal Information may/can be disclosed by any of the Insurers and/or GIA to their third-party service providers or agents (including their lawyers/law firms), which may be sited outside of Singapore, for one or more of the above Purposes.



Policyholder's Signature / Date & Time

Actual Driver's Signature (if driver is not the policyholder) / Date & Time

Witnessed by Reporting Centre Personnel
(Name as in NRIC/ID card)

[Signature] 02/9/2022 *[Signature]* 2.9.2022

Sketch Plan

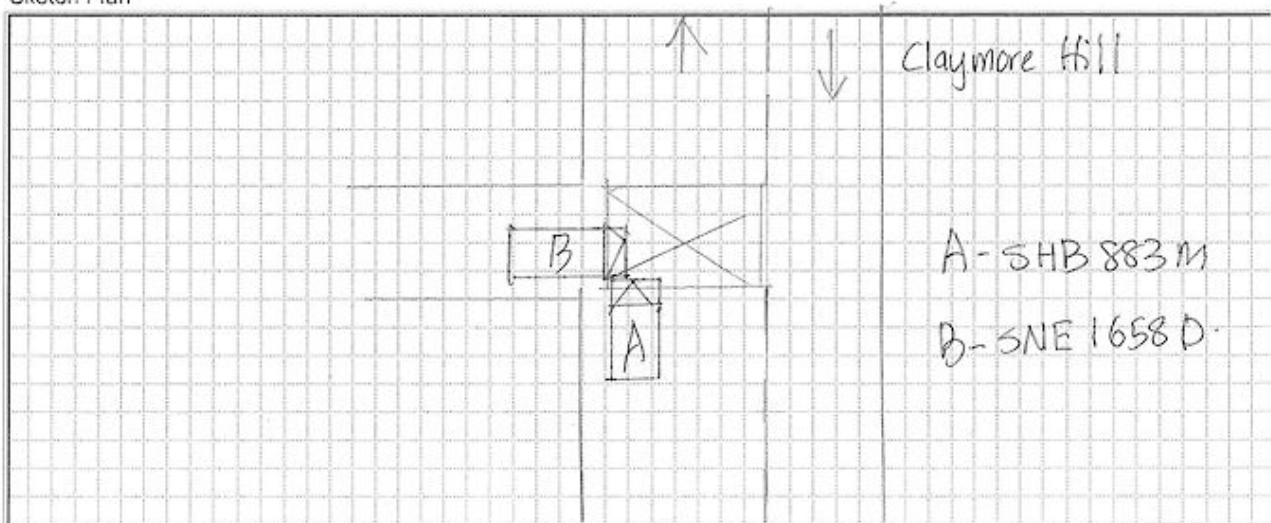

vJun2022

1

Describe Circumstance of the Accident

Declaration

I/We declare the foregoing particulars are true in every respect.



Policyholder's Signature / Date & Time

Actual Driver's Signature (if driver is not the policyholder)
/ Date & Time

2-9-2022

Witnessed by Reporting Centre Personnel
(Name as in NRIC/ID card)











IMPORTANT NOTE: Please submit the completed Addendum form to the same Accident Reporting Centre with whom you submitted the Original Report.

ADDENDUM

(A) PARTICULARS OF PERSON MAKING THE AMENDMENTS:

Original Report No: SS3D2292000A Vehicle Registration No: SHB883M
 Name (as shown in NRIC): STRIDES TAXI PTE LTD NRIC/FIN/Passport No: 198905369K
 (*Vehicle Driver/Policyholder) (*) Please delete as appropriate
 Address: _____ Singapore ()
 Contact (Tel): 68662671 Mobile No.: _____
 Email Address: _____
 Date of Accident: 02/09/2022 Time of Accident: 15:10
 Place of Accident: CLAYMORE HILL
 Insurance Company: MS FIRST CAPITAL INSURANCE LTD

(B) ADDITIONAL INFORMATION /AMENDMENTS:

I have made a report on the above-mentioned accident and would like to include additional information or make the following amendments:

TO ATTACHED CORRECT VEHICLE PHOTOS



Policyholder / Actual Driver's Signature
Date:

Reporting Centre Personnel's Signature
Name (as in NRIC/ID card):

Date: 3/9/22