



> Back to OneMotoring

## Enquire PARF/COE Rebate for Registered Vehicle

<b>Vehicle Owner Particulars</b>	
Owner ID Type:	Business
Owner ID:	493B
<b>Vehicle Details</b>	
Vehicle No.:	PC5869Y
Vehicle to be Exported:	Yes
Intended Deregistration Date:	04 Jul 2022
Vehicle Make:	TOYOTA
Vehicle Model:	HIACE COMMUTER GL 3.0 AT 2WD 4DR LWB
Primary Colour:	Silver
Manufacturing Year:	2016
Engine No.:	1KD2673967
Chassis No.:	KDH2230030443
Maximum Power Output:	-
Open Market Value:	\$45,029.00
Original Registration Date:	27 Jun 2017
First Registration Date:	27 Jun 2017
Transfer Count:	1
Actual ARF Paid:	\$2,252.00
<b>Intended PARF Rebate Details</b>	
PARF Eligibility:	No
PARF Eligibility Expiry Date:	-
PARF Rebate Amount:	\$0.00
<b>Intended COE Rebate Details</b>	
COE Expiry Date:	26 Jun 2027
COE Category:	C - Goods Vehicle & Bus
COE Period(Years):	10
QP Paid:	\$38,501.00
COE Rebate Amount:	\$19,164.00
<b>Total Rebate Amount:</b>	<b>\$19,164.00</b>

The information contained herein is correct as at 04 Jul 2022

OK



SAVE UP TO **\$600** ON YOUR CAR INSURANCE RENEWAL!

[Get Quotes Now](#)

sgcarmart

**Post an Advertisement**  
Sell it yourself! Advertise it at just  
**\$68 until it's SOLD!**

[Post an Ad](#)
[Advertiser Login](#)
[Ways of Selling](#)

08/2018 Honda Jazz \$69800, \$754 Monthly At 1.88%.

\$754 Monthly Only! 1.88% By  
GV Cars Financing, \$0  
Downpayment. PHV/Z10  
Welcome.  
GV Automobile Centre [SBA Ad](#)

**P PRIME MOTOR & LEASING**  
CHENG YONG CREDIT ENTERPRISES PTE LTD. GROUP OF COMPANIES  
With over 200 units of vehicles to choose from, ranging from all European to Japanese Makes.

Sort by   results/page

4 vehicles



toyota hiace commuter

Any Category

Advanced Search



Search

	Make	Model	Price	Depreciation	Reg Date	Eng Cap	Mileage	Veh Type	Status
<b>Search Selection</b>	toyota hiace commuter		Any	Any	2017	Any	Any	Any	Available
	Toyota Hiace Commuter 3.0A GL		\$70,800	\$15,160 /yr	06-Mar-2017	2,982 cc	-	Bus	Available
<b>Fuel Type:</b> Diesel New paintwork, all the wear and tear done, clean interior, well maintained by previous owner, all seat cushion are as clean as new, flexib... ABS Bus Pte Ltd Posted: 27-Jun-2022									
	Toyota Hiace Commuter 3.0A GL		\$70,888	\$14,500 /yr	25-May-2017	2,982 cc	-	Bus	Available
<b>Fuel Type:</b> Diesel Look Like New Auto Transmission 13 Seater Toyota Hiace Commuter! Cheapest And Best Unit In The Market! 1 Careful Owner Only! Low... Net Link Partners Pte Ltd Posted: 30-Jun-2022									
	Toyota Hiace Commuter 3.0A GL		\$69,800	\$13,860 /yr	17-Jul-2017	2,982 cc	-	Bus	Available
<b>Fuel Type:</b> Diesel Please Call To Arrange For Viewing, Thank You. Posted: 15-Jun-2022									
	Toyota Hiace Commuter 3.0A GL High Roof		\$78,800	\$14,420 /yr	21-Dec-2017	2,982 cc	-	Bus	Available
<b>Fuel Type:</b> Diesel Over \$12,000 Spent On Interior, Unique Red On Black Upholstery Stand Out from all the Hiace Buses. Modelista Front Grille, Sports Rims... Posted: 01-Jul-2022									

Save this search criteria, to get email alerts whenever a match is found.

Make	Model	Price	Depreciation	Reg Date	Eng Cap	Mileage	Veh Type	Status
------	-------	-------	--------------	----------	---------	---------	----------	--------

For old advertisements, view [Expired ads](#) results/page**Buy / Rent Cars**[New Cars For Sale](#)[Used Cars For Sale](#)[Cars For Rent](#)**Sell Your Car**[Post an Ad](#)[Sell by Bidding](#)[Sell by Consignment](#)**Aftermarket**[Workshop Directory](#)[Aftermarket Products](#)**Articles**[Car Reviews](#)[Car Advice](#)[Car News](#)[Car Features](#)**General**[About Us](#)[Contact Us](#)[Careers](#)[Site Map](#)

Res [Compare](#)

Follow [Sgcarmart.com](#)

## SINGAPORE ACCIDENT STATEMENT

### IMPORTANT NOTICE

1. Please report correctly the details of the accident to speed up the claims process.
2. This Form must be completed by the Policyholder and/or the Authorised Driver.
3. Information provided must be as truthful and accurate as possible. Any wilful misrepresentation or withholding of material facts may allow insurance companies to repudiate policy liability.
4. The issue and acceptance of this Form by insurance companies is not an admission of policy liability on the part of the insurance companies.
5. **Any false reporting may be referred to the Police for investigation.**
6. This report will be forwarded by the insurers of the GIA Records Management Centre established by the General Insurance Association of Singapore (GIA) for archiving and that copies of this report will, for a fee, be made available upon application by interested parties.
7. By the lodgement of this report to the insurers, you hereby consent to the archiving of this report at the centre and to copies of the report being made available aforesaid.

### ACCIDENT STATEMENT

Date of Submission	04/07/2022 13:05 (SGT)
Reported by	Driver
Date of Accident	01/07/2022 11:15 (SGT)
Exact Location of Accident	528C Pasir Ris Street 51, Singapore 513528
Additional Location Information	-
Country/State of Loss	Singapore

### DETAILS OF OWN VEHICLE

Vehicle Registration Number	PC5869Y
-----------------------------	---------

#### INSURED/POLICYHOLDER

Is company?	Yes
Name Of Registered Owner	JEAN-JERRY L TOURS & TRANSPORT SVCS
Company Reg No	53259493B
Email Address	jamesanthonyisilva@hotmail.com
Mobile Phone No	(Phone) +65-84208702
Alternative Phone No	-

#### VEHICLE PARTICULARS

Manufacturer	Toyota
Model	Hiace
Variant	-
Exact purpose for which vehicle was being used at time of accident	Employment
Are you claiming under your own insurance policy for repair to your vehicle?	No - Claiming third party
Vehicle Category	Commercial vehicle
Transmission	Auto
CC	2982

#### INSURANCE COMPANY

Name of Insurance Company	Great American Insurance Company
Policy Number / Cover Note Number	MOMVC000008552-02-000

#### DRIVER

Name of Driver	HO JENSON, JOHN @ YOCHANAN ELIYAHU BEN HASSAN
NRIC No	S7630617F
Date Of Birth	29/09/1976
Occupation	Outdoor



Date Of Driving Pass .....	20/01/2014
Driving experience .....	8 YEARS AND 6 MONTHS
Gender .....	Male
Mobile Number .....	(Phone) +65-96581040
Alt. Phone Number .....	-
Email Address .....	yochanan_netsarim@yahoo.com
Address .....	BLLK 538 ANG MO KIO AVENUE 5 #03-4036
Address complement .....	-
Postcode .....	560538
Is the driver the policyholder? .....	No
If No, Relationship of the Driver with the Insured .....	Employee
Does Driver Own Other Vehicles? .....	No
Vehicle Registration Number of Other Vehicle Owned by Driver .....	-
Insurance Company of Other Vehicle Owned by Driver .....	-

#### GENERAL INFORMATION OF THE ACCIDENT

Type of Accident .....	Collision - Head to Rear
Weather Conditions .....	Clear
Road Surface .....	Dry

#### OTHER INFORMATION

Was any foreign vehicle involved in the accident? .....	No
Number of vehicles involved in the accident .....	2
Was anybody injured in the Accident? .....	Yes
Was any injured conveyed to hospital by ambulance? .....	No
Was any other vehicle or property damaged? .....	Yes
Number of Passengers (Including Driver) .....	1
Has the driver been approached by unknown person(s) soliciting/offering accident claims assistance? .....	No
Translator's name .....	-
Translator's ID .....	-
Translator's phone number .....	-
Translator's email .....	-
Original language used in the statement .....	-

#### DETAILS OF POLICE ACTION

Was the accident reported to the police? .....	No
Was notice of intended Prosecution given? .....	No
If yes, against whom? .....	-

#### CIRCUMSTANCES OF ACCIDENT

PLEASE REFER TO SKETCH PLAN

#### ATTACHMENT(S)

Are accident photos available for attachment? .....	Yes
Was there any video captured by Car Camera? .....	No

#### DETAILS OF OTHER VEHICLE PROPERTY 1

Vehicle Registration Number .....	YQ3938P
Vehicle Manufacturer .....	-
Vehicle Model .....	-
Vehicle Variant .....	-
Vehicle Colour .....	-
Vehicle Category .....	Commercial vehicle
Name of Driver .....	-
Contact Number .....	-

Address -  
 Address complement -  
 Postcode -  
 Insurance Company Name -  
 Nature Of Damage -  
 Details of property damaged in accident -  
 No. Of Passenger (Including Driver) -

## INJURED PERSONS DETAILS

### INJURED 1

Name of injured person	HO JENSON, JOHN @ YOCHANAN ELIYAHU BEN HASSAN
Gender	Male
Phone No	(Phone) +65-96581040
Address	-
Address Complement	-
Post Code	-
Approximate Age Years Old	-
Injuries Sustained	SLIGHT INJURY
Injured person in which vehicle?	PC5869Y
Were seat belts worn?	Yes
Was this injured conveyed to hospital by ambulance?	No



## SKETCH PLAN

## IMPORTANT NOTICE

1. Please report correctly the details of the accident to speed up the claims process.
2. This Form must be completed by the Policyholder and/or the Authorised Driver.
3. Information provided must be as truthful and accurate as possible. Any wilful misrepresentation or withholding of material facts may allow insurance companies to repudiate policy liability.
4. The issue and acceptance of this Form by insurance companies is not an admission of policy liability on the part of the insurance companies.
5. Any false reporting may be referred to the Police for investigation.
6. The report will be forwarded by the insurers of the GIA Records Management Centre established by the General Insurance Association of Singapore (GIA) for archiving and that copies of this report will for a fee be made available upon application by interested parties.
7. By the lodgement of this report to the Insurers, you hereby consent to the archiving of this report at the centre and to copies of the report being made available aforesaid.
8. **Consent under the Personal Data Protection Act (PDPA)**  
I understand, acknowledge, agree and consent that:
  - (a) My insurer, my workshop and the General Insurance Association of Singapore ("GIA") may/are permitted to collect, use, disclose and/or process my personal data/personal information set out in this [form] and any other personal information provided by me or possessed by my insurer (collectively the "Personal Information") and disclose and transfer such Personal Information to all insurer(s) who have insured vehicle(s) involved in this accident (all insurer(s) who have insured vehicle(s) involved in this accident shall be collectively referred to as the "Insurers"), the Insurers' law yers/law firms, the Monetary Authority of Singapore and any relevant government agency/authority (such as the police), for the purpose(s) of:
    - (i) processing, handling and/or dealing with my claims including the settlement of the claims and any necessary investigations relating to the claims;
    - (ii) investigating the accident and/or my claims;
    - (iii) carrying out and/or dealing with my instructions or responding to any enquiries by me;
    - (iv) administering my claims (including the mailing of correspondence, statements, invoices, reports or notices to me, which could involve disclosure of certain personal data about me to bring about delivery of the same as well as on the external cover of envelopes/mail packages); and/or
    - (v) complying with applicable law in administering, processing, handling and/or dealing with my claims.
  - (b) all insurer(s) who have insured vehicle(s) involved in this accident and the Insurers' law yers/law firms, may/are permitted to collect, use, disclose and/or process my Personal Information for one or more of the above Purposes; and
  - (c) my Personal Information may/can be disclosed by any of the Insurers and/or GIA to their third party service providers or agents (including their law yers/law firms), which may be sited outside of Singapore, for one or more of the above Purposes.

## JEAN-JERRY TOURS &amp; TRANSPORT SVCS

REG. NO: 532594938  
BLK 447A JALAN KAYU #06-366  
SINGAPORE 791447  
HP: 8420 8702 FAX: 6444 9555

Email: [jean-jerry@jean-jerry.com](mailto:jean-jerry@jean-jerry.com)  
Policyholder's Signature / Date & Time

Driver's Signature (if driver is not the policyholder) / Date & Time

Witnessed by Reporting Centre Personnel

Sketch Plan

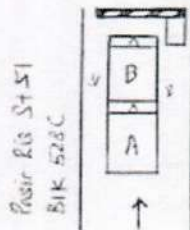

Veh A - PC5869Y

Veh B - YQ5938P

Describe Circumstances of the Accident

On the above mention date and time, I was waiting to exit gantry at Passer Ris St 51, Blk 528C. Suddenly vehicle Y&3933P in front of me reverse abruptly onto my vehicle. My vehicle's front portion was damaged. We exchange particulars and left the scene.

Declaration

We declare the foregoing particulars are true in every respect.

JEAN-JERRY TOURS & TRANSPORT SVCS

REG NO: 53259493B  
BLK 447A JALAN KAYU #06-368  
SINGAPORE 791447  
HP: 8420 8702 FAX: 6444 9655

*[Signature]*

*[Signature]* 08/07/2022

Policyholder's Signature (if driver is not the policyholder) / Date  
Time & Time

Witnessed by Reporting Centre  
Personnel





































# JWG INTERNATIONAL PTE. LTD.

10, ANG MO KIO IND PARK 2A, #03-08 AMK AUTOPOINT, SINGAPORE 568047

H/P: 9698 8882 | FAX: 6909 9592

E-Mail: jwg.claims@yahoo.com

To: CHINA TAIPING

Att: Motor Claims Dept

ACCIDENT INVOLVING SME646G [YOUR INSURED] & PC5869Y [OUR CLIENT]  
ON 01/07/2022.

## ESTIMATED REPAIR COSTS FOR PC5869Y

<u>QTY</u>	<u>PARTS</u>	<u>AMOUNT</u>	
2PCS	HEAD LAMP LH / RH @ \$3,689.10 EACH <i>monny work 2420.50 x 2</i>	\$ 7,378.20	✓ 4841.00
2PCS	HEAD LAMP WIREHARNESS LH / RH @ \$1,891.29 EACH <i>HH</i>	\$ 3,782.58	X
1PC	BONNET <i>Deale 1020-30</i>	\$ 1,180.51	✓
1PC	BONNET TOYOTA LOGO <i>Hu</i>	\$ 79.10	✓
1PC	BONNET SEAL <i>Su</i>	\$ 81.92	X
1PC	BONNET LOCK <i>bt 128.00</i>	\$ 583.00	✓
2PCS	BONNET HINGE LH / RH <i>lgw</i>	\$ 382.00	X
1PC	BONNET STAND <i>HH</i>	\$ 147.00	X
1PC	FRONT GRILLE ASSY <i>monny broken 581-10</i>	\$ 1,082.60	✓
1PC	FRONT BOTTOM <i>HS</i>	\$ 829.00	X
1PC	FRONT GRILLE TOP CHROME <i>HH</i>	\$ 329.00	X
1PC	FRONT GRILLE CENTER CHROME <i>HH</i>	\$ 316.00	X
1PC	FRONT GRILLE BOTTOM CHROME <i>HH</i>	\$ 337.50	X
1PC	FRONT BUMPER <i>HH</i>	\$ 849.80	X
1PC	FRONT BUMPER LOWER GRILLE <i>HH</i>	\$ 385.91	X
2PCS	FRONT BUMPER SIDE RETAINER LH / RH @ \$103.40 EACH <i>HH</i>	\$ 206.80	X
2PCS	FRONT BUMPER FOG LAMP LH / RH @ \$410.59 EACH <i>HH</i>	\$ 821.18	X
1PC	FRONT BUMPER TOW HOOK COVER <i>HH</i>	\$ 69.80	X
2PCS	FRONT BUMPER PARKING SENSOR <i>HH</i>	\$ 649.00	X
1PC	FRONT INTER-COOLER ASSY <i>purchased 1108-60</i>	\$ 3,492.84	✓
1PC	FRONT INTER-COOLER ASSY OUTER GARNISH <i>cut 183.20</i>	\$ 392.00	✓ 183.20
1PC	FRONT RADIATOR ASSY <i>HH</i>	\$ 2,149.85	X
1PC	FRONT RADIATOR FAN MOTOR <i>HH</i>	\$ 526.84	X
1PC	FRONT RADIATOR FAN MOTOR COWLING <i>HH</i>	\$ 498.80	X
1PC	FRONT RADIATOR FAN BLADE <i>HH</i>	\$ 244.50	X
1PC	FRONT RADIATOR SPARE TANK <i>HH</i>	\$ 298.00	X
1PC	FRONT WIPER WASHER TANK <i>HH</i>	\$ 178.10	X
1PC	FRONT A/C CONDENSOR ASSY <i>HH</i>	\$ 1,986.70	X
1PC	FRONT A/C HIGH PRESSURE HOSE <i>HH</i>	\$ 398.40	X
1PC	FRONT A/C LOW PRESSURE HOSE <i>HH</i>	\$ 681.20	X
1PC	FRONT A/C DISCHARGE HOSE <i>HH</i>	\$ 894.54	X



2PCS	FRONT A/C CONDENSOR SIDE COWLING LH / RH @ \$254.10 EACH HH	\$ 508.20	X
1PC	FRONT SUPPORT PANEL reg	\$ 1,782.50	X
1PC	FRONT BRACE PANEL HH	\$ 149.80	X
1PC	FRONT REINFORCEMENT BAR UPPER HH	\$ 984.52	X
1PC	FRONT REINFORCEMENT BAR LOWER HH	\$ 699.81	X
1PC	FRONT REINFORCEMENT BAR BRACKET (TOP) HH	\$ 1,094.50	X
1PC	FRONT RADAR ASSY HH	\$ 3,895.15	X
1PC	FRONT RADAR BRACKET HH	\$ 984.05	X
1PC	FRONT WIPER GARNISH HH	\$ 693.00	X

7,941.30  
5,955.97 =

PARTS SUM: \$ 42,024.20  
PARTS LESS 25%: \$ 10,506.05  
PARTS TOTAL: \$ 31,518.15

### LABOUR & SPECIAL NETT ITEMS

*	TO SUPPLY FRONT NO. PLATE & GARNISH HH	\$ 100.00	X
*	TO SUPPLY FRONT GRILLE CLIPS HCC	\$ <del>50.00</del> 15/-	
*	TO SUPPLY LOWER GRILLE CLIPS HH	\$ 50.00	X
*	TO SUPPLY RADIATOR COOLANT HH	\$ 200.00	X
*	TO SUPPLY FRONT BUMPER CLIPS HH	\$ 50.00	X
*	TO SUPPLY FRONT BUMPER FOG LAMP GARNISH CLIPS HH	\$ 50.00	X
*	TO SUPPLY FRONT BUMPER LOWER GRILLE CLIPS HH	\$ 50.00	X
*	TO REMOVE ALL INTERIOR UPHOLSTERLY ITEMS TO FACILITATE REPAIRS	\$ <del>300.00</del> HH	
*	TO REMOVE & PANEL BEAT ALL DAMAGED ABOVE PARTS & PANELS	\$ <del>2,000.00</del> 500/-	
*	TO RESPRAY NEW PAINTWORK FOR ALL DAMAGED AREAS	\$ <del>2,000.00</del> 400/-	
*	TO TUFF COAT DAMAGED AREAS	\$ <del>300.00</del> 20/-	
*	TO RNR INTER-COOLER TO FACILITATE REPAIRS	\$ <del>200.00</del> 80/-	
*	TO RNR FRONT RADIATOR ASSY & REFILL COOLANT TO FACILITATE REPAIRS	\$ 200.00 HH	
*	TO RNR FRONT A/C CONDENSOR & REFILL A/C GAS TO FACILITATE REPAIRS	\$ 200.00 HH	
*	TO CHECK & RE-FIX ALL ELECTRICAL WIRINGS	\$ <del>200.00</del> 30/-	
*	TO COMPUTERIZE DIAGNOSE FAULT CODES & CONTROL UNITS. RESET ALL MEMORIES TO FACTORY DEFAULT SETTINGS	\$ 300.00 HH	

LABOUR & S/N TOTAL: \$ 6,250.00

GRAND TOTAL ESTIMATED REPAIR COSTS (NON-INCLUSIVE OF 7% GST): \$ 37,768.15

05/07/2022 @ 0930am

Hkt Andre

1/2mm 5 dgs.

2  
mm

LKK Auto

Check part prices.

8

7,000.97

4/5 5,600/-

**LKK Auto Consultants** hence notify  
the Repairer of the following:

- To resurvey before/after spray painting
- To display damaged part(s) during resurvey
- Parts prices are subject to confirmation
- Third party survey is on a "Without Prejudice" basis
- No illegal modification(s) is allowed
- Supplementary item(s) must be resurveyed and  
is subject to final approval from Insurance Company

Acknowledged by Repairer

Signature:

Date: