

SKETCH PLAN**IMPORTANT NOTICE**

1. Please report correctly the details of the accident to speed up the claims process.
2. This Form must be completed by the Policyholder and/or the Authorised Driver.
3. Information provided must be as truthful and accurate as possible. Any wilful misrepresentation or withholding of material facts may allow insurance companies to repudiate policy liability.
4. The issue and acceptance of this Form by insurance companies is not an admission of policy liability on the part of the insurance companies.
5. Any false reporting may be referred to the Police for investigation.
6. The report will be forwarded by the insurers of the GIA Records Management Centre established by the General Insurance Association of Singapore (GIA) for archiving and that copies of this report will for a fee be made available upon application by interested parties.
7. By the lodgement of this report to the insurers, you hereby consent to the archiving of this report at the centre and to copies of the report being made available aforesaid.
8. **Consent under the Personal Data Protection Act (PDPA)**
I understand, acknowledge, agree and consent that :
(a) My insurer, my workshop and the General Insurance Association of Singapore ("GIA") may/are permitted to collect, use, disclose and/or process my personal data/personal information set out in this [form] and any other personal information provided by me or possessed by my insurer (collectively the "Personal Information") and disclose and transfer such Personal Information to all insurer(s) who have insured vehicle(s) involved in this accident (all insurer(s) who have insured vehicle(s) involved in this accident shall be collectively referred to as the "Insurers"), the Insurers' lawyers/law firms, the Monetary Authority of Singapore and any relevant government agency/authority (such as the police), for the purpose(s) of :
(i) processing, handling and/or dealing with my claims including the settlement of the claims and any necessary investigations relating to the claims;
(ii) investigating the accident and/or my claims;
(iii) carrying out and/or dealing with my instructions or responding to any enquiries by me;
(iv) administering my claims (including the mailing of correspondence, statements, invoices, reports or notices to me, which could involve disclosure of certain personal data about me to bring about delivery of the same as well as on the external cover of envelopes/mail packages); and/or
(v) complying with applicable law in administering, processing, handling and/or dealing with my claims.
(collectively the "Purposes")
(b) all insurer(s) who have insured vehicle(s) involved in this accident and the Insurers' lawyers/law firms, may/are permitted to collect, use, disclose and/or process my Personal Information for one or more of the above Purposes; and
(c) my Personal Information may/can be disclosed by any of the insurers and/or GIA to their third party service providers or agents (including their lawyers/law firms), which may be sited outside of Singapore, for one or more of the above Purposes.



Policyholder's Signature / Date & Time



Driver's Signature (if driver is not the policyholder) / Date & Time

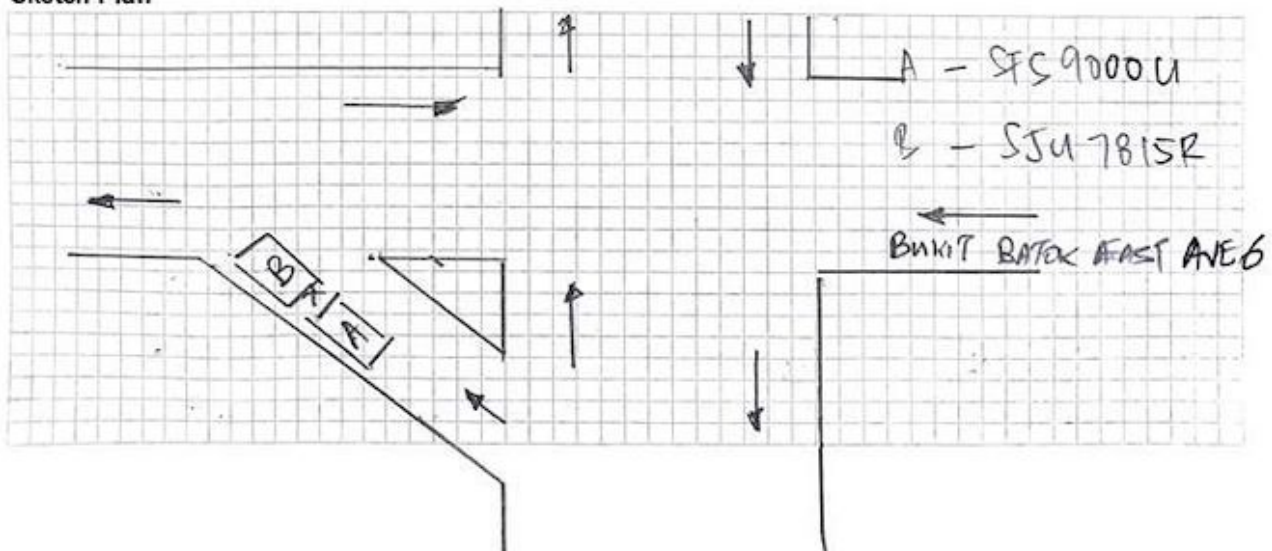

Witnessed by Reporting Centre Personnel

Sketch Plan

Describe Circumstances of the Accident

On 18/6 approximately 2000 hrs. I was travelling along Bukit Batok Ave 6. Traffic was clear and smooth and road is dry.

While turning left, the car in front stopped suddenly at the bend instead of moving on with the flow of traffic, even though when there was no traffic on the main which she was travelling.

As it was a unexpected action from the car in front to stop. I hit her car from behind.

Went out to check both cars, exchanged contact details and both parties agreed and advised each other to make report separately.

NO one was injured

Declaration

I/We declare the foregoing particulars are true in every respect.



Policyholder's Signature / Date & Time



Driver's Signature (If driver is not the policyholder) / Date & Time



Witnessed by Reporting Centre Personnel

