

SINGAPORE ACCIDENT STATEMENT

IMPORTANT NOTICE

1. Please report correctly the details of the accident to speed up the claims process.
2. This Form must be completed by the Policyholder and/or the Authorised Driver
3. Information provided must be as truthful and accurate as possible. Any wilful misrepresentation or withholding of material facts may allow insurance companies to repudiate policy liability.
4. The issue and acceptance of this Form by insurance companies is not an admission of policy liability on the part of the insurance companies.
5. **Any false reporting may be referred to the Police for investigation.**
6. This report will be forwarded by the insurers of the GIA Records Management Centre established by the General Insurance Association of Singapore (GIA) for archiving and that copies of this report will, for a fee, be made available upon application by interested parties.
7. By the lodgement of this report to the insurers, you hereby consent to the archiving of this report at the centre and to copies of the report being made available aforesaid.

ACCIDENT STATEMENT

Date of Submission 07/06/2022 18:08 (SGT)
Date of Accident 27/04/2022 11:00 (SGT)
Exact Location of Accident 416 Pandan Gardens, Singapore
Additional Location Information -
Country/State of Loss Singapore

DETAILS OF OWN VEHICLE

Vehicle Registration Number YQ5000G

INSURED/POLICYHOLDER

Is company? Yes
Name Of Registered Owner AVIALOG EXPRESS PTE LTD
Company Reg No 2XXXXX684H
Email Address jeannie_lee@avialogexpress.com.sg
Mobile Phone No (Phone) +65-63849123
Alternative Phone No (Office) +65-63849123

VEHICLE PARTICULARS

Manufacturer Mitsubishi
Model Fuso
Variant -
Exact purpose for which vehicle was being used at time of accident Employment
Are you claiming under your own insurance policy for repair to your vehicle? No - Reporting only
Vehicle Category Commercial vehicle
Transmission Manual
CC 7545

INSURANCE COMPANY

Name of Insurance Company Lonpac Insurance Bhd
Type of Coverage Comprehensive
Fleet Policy No
Policy Number Z21VC05008414
Cover Note Number -

DRIVER

Name of Driver TEO ENG LEE
NRIC No SXXXX911Z

Date Of Birth	29/07/1983
Occupation	Outdoor
Date Of Driving Pass	20/06/2019
Driving experience	2 YEARS AND 10 MONTHS
Gender	Male
Mobile Number	(Phone) +65-97676576
Alt. Phone Number	-
Email Address	jeannie_lee@avialogexpress.com.sg
Address	28 CONISTON GROVE
Address complement	-
Postcode	558323
Is the driver the policyholder?	No
If No, Relationship of the Driver with the Insured	Employee
Does Driver Own Other Vehicles?	No
Vehicle Registration Number of Other Vehicle Owned by Driver	-
Insurance Company of Other Vehicle Owned by Driver	-

GENERAL INFORMATION OF THE ACCIDENT

Type of Accident	Hit by fallen tree / Other objects
Weather Conditions	Clear
Road Surface	Dry

OTHER INFORMATION

Was any foreign vehicle involved in the accident?	No
Number of vehicles involved in the accident	2
Was anybody injured in the Accident?	No
Was any injured conveyed to hospital by ambulance?	-
Was any other vehicle or property damaged?	Yes
Number of Passengers (Including Driver)	1
Has the driver been approached by unknown person(s) soliciting/offering accident claims assistance?	No

DETAILS OF POLICE ACTION

Was the accident reported to the police?	No
Was notice of intended Prosecution given?	No
If yes, against whom?	-

CIRCUMSTANCES OF ACCIDENT

PLS REFER TO THE ATTACHED STATEMENT.

ATTACHMENT(S)

Are accident photos available for attachment?	Yes
Was there any video captured by Car Camera?	No
Was there any audio recorded?	No

DETAILS OF OTHER VEHICLE PROPERTY 1

Vehicle Registration Number	-
Vehicle Manufacturer	-
Vehicle Model	-
Vehicle Variant	-
Vehicle Colour	-
Vehicle Category	NA / Unknown
Name of Driver	ERP MACHINE
Contact Number	-
Address	-
Address complement	-

Postcode -
Insurance Company Name -
Nature Of Damage -
Details of property damaged in accident -
No. Of Passenger (Including Driver) -

SKETCH PLAN**IMPORTANT NOTICE**

1. Please report correctly the details of the accident to speed up the claims process.
2. This Form must be completed by the Policyholder and/or the Authorised Driver.
3. Information provided must be as truthful and accurate as possible. Any willful misrepresentation or withholding of material facts may allow insurance companies to repudiate policy liability.
4. The issue and acceptance of this Form by insurance companies is not an admission of policy liability on the part of the insurance companies.
5. Any false reporting may be referred to the Police for investigation.
6. The report will be forwarded by the insurers of the GIA Records Management Centre established by the General Insurance Association of Singapore (GIA) for archiving and that copies of this report will for a fee be made available upon application by interested parties.
7. By the lodgement of this report to the insurers, you hereby consent to the archiving of this report at the centre and to copies of the report being made available aforesaid.
8. **Consent under the Personal Data Protection Act (PDPA)**

I understand, acknowledge, agree and consent that:

(a) My insurer, my workshop and the General Insurance Association of Singapore ("GIA") may/are permitted to collect, use, disclose and/or process my personal data/personal information set out in this [form] and any other personal information provided by me or possessed by my insurer (collectively the "Personal Information") and disclose and transfer such Personal Information to all insurer(s) who have insured vehicle(s) involved in this accident (all insurer(s) who have insured vehicle(s) involved in this accident shall be collectively referred to as the "Insurers"), the Insurers' lawyers/law firms, the Monetary Authority of Singapore and any relevant government agency/authority (such as the police), for the purpose(s) of:

(i) processing, handling and/or dealing with my claims including the settlement of the claims and any necessary investigations relating to the claims;

(ii) investigating the accident and/or my claims;

(iii) carrying out and/or dealing with my instructions or responding to any enquiries by me;

(iv) administering my claims (including the mailing of correspondence, statements, invoices, reports or notices to me, which could involve disclosure of certain personal data about me to bring about delivery of the same as well as on the external cover of envelopes/mail packages); and/or

(v) complying with applicable law in administering, processing, handling and/or dealing with my claims.

(collectively the "Purposes")

(b) all insurer(s) who have insured vehicle(s) involved in this accident and the Insurers' lawyers/law firms, may/are permitted to collect, use, disclose and/or process my Personal Information for one or more of the above Purposes; and

(c) my Personal Information may/can be disclosed by any of the Insurers and/or GIA to their third party service providers or agents (including their lawyers/law firms), which may be sited outside of Singapore, for one or more of the above Purposes.



Policyholder's Signature / Date & Time

Driver's Signature (If driver is not the policyholder) / Date & Time

Witnessed by Reporting Centre Personnel

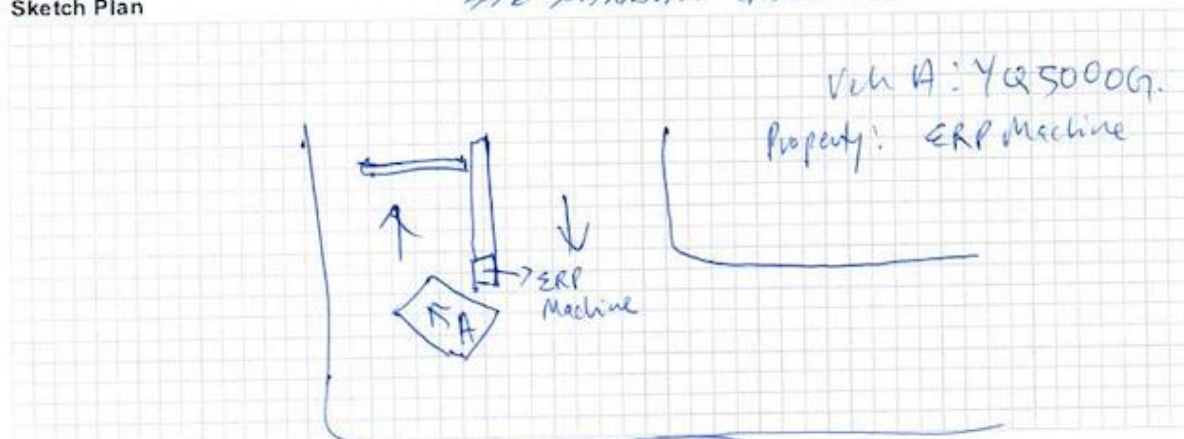
Sketch Plan

Describe Circumstances of the Accident

On 27 April 2022, when I was exiting the carpark probably my tail of the truck had touch the machine. I was not aware because I did not hear any sound.

Declaration

We declare the foregoing particulars are true in every respect.



Policyholder's Signature / Date & Time

Driver's Signature (If driver is not the policyholder) / Date & Time

Witnessed by Reporting Centre Personnel















 MITSUBISHI FUSO
TRUCK & BUS CORPORATION

MODEL FK62FM

CHASSIS
NO. A40217

ENGINE 6M60

三菱ふそうトラック・バス株式会社