

SINGAPORE ACCIDENT STATEMENT

IMPORTANT NOTICE

1. Please report correctly the details of the accident to speed up the claims process.
2. This Form must be completed by the Policyholder and/or the Authorised Driver.
3. Information provided must be as truthful and accurate as possible. Any wilful misrepresentation or withholding of material facts may allow insurance companies to repudiate policy liability.
4. The issue and acceptance of this Form by insurance companies is not an admission of policy liability on the part of the insurance companies.
5. Any false reporting may be referred to the Police for investigation.
6. This report will be forwarded by the insurers of the GIA Records Management Centre established by the General Insurance Association of Singapore (GIA) for archiving and that copies of this report will, for a fee, be made available upon application by interested parties.
7. By the lodgement of this report to the insurers, you hereby consent to the archiving of this report at the centre and to copies of the report being made available aforesaid.

ACCIDENT STATEMENT

Date of Submission	09/05/2022 15:47 (SGT)
Date of Accident	08/05/2022 10:30 (SGT)
Exact Location of Accident	Prinsep Link, Singapore
Additional Location Information	PRINSEP LINK (NEAR LP 2R14) TOWARDS PRINSEP ST
Country/State of Loss	Singapore

DETAILS OF OWN VEHICLE

Vehicle Registration Number	GBJ4293T
INSURED/POLICYHOLDER	
Is company?	Yes
Name Of Registered Owner	JWL ENGINEERING PTE. LTD.
Company Reg No	2XXXXXX681K
Email Address	SAYHOON4293@GMAIL.COM
Mobile Phone No	(Phone) +65-94577603
Alternative Phone No	(Home) +65-94577603

VEHICLE PARTICULARS

Manufacturer	Toyota
Model	Dyna
Variant	-
Exact purpose for which vehicle was being used at time of accident	-
Are you claiming under your own insurance policy for repair to your vehicle?	No - Claiming third party
Vehicle Category	Commercial vehicle
Transmission	Manual
CC	2982

INSURANCE COMPANY

Name of Insurance Company	NTUC Income Insurance Co-operative Ltd
Type of Coverage	Comprehensive
Fleet Policy	No
Policy Number	5108694805-03
Cover Note Number	-

DRIVER

Name of Driver	ONG SAY HOON
NRIC No	SXXXX001B

Date Of Birth	21/03/1968
Occupation	Outdoor
Date Of Driving Pass	29/06/2001
Driving experience	20 YEARS AND 11 MONTHS
Gender	Male
Mobile Number	(Phone) +65-98501729
Alt. Phone Number	-
Email Address	SAYHOON4293@GMAIL.COM
Address	BLK 330 UBI AVENUE 1
Address complement	#07-639
Postcode	400330
Is the driver the policyholder?	No
If No, Relationship of the Driver with the Insured	Employee
Does Driver Own Other Vehicles?	No
Vehicle Registration Number of Other Vehicle Owned by Driver	-
Insurance Company of Other Vehicle Owned by Driver	-

GENERAL INFORMATION OF THE ACCIDENT

Type of Accident	Collision - Major/Minor Rd
Weather Conditions	Raining
Road Surface	Wet

OTHER INFORMATION

Was any foreign vehicle involved in the accident?	No
Number of vehicles involved in the accident	2
Was anybody injured in the Accident?	No
Was any injured conveyed to hospital by ambulance?	-
Was any other vehicle or property damaged?	Yes
Number of Passengers (Including Driver)	1
Has the driver been approached by unknown person(s) soliciting/offering accident claims assistance?	No

DETAILS OF POLICE ACTION

Was the accident reported to the police?	No
Was notice of intended Prosecution given?	No
If yes, against whom?	-

CIRCUMSTANCES OF ACCIDENT

REFER TO SKETCH PLAN ATTACHED

ATTACHMENT(S)

Are accident photos available for attachment?	Yes
Was there any video captured by Car Camera?	No
Was there any audio recorded?	No

DETAILS OF OTHER VEHICLE PROPERTY 1

Vehicle Registration Number	SJB4838U
Vehicle Manufacturer	-
Vehicle Model	-
Vehicle Variant	-
Vehicle Colour	-
Vehicle Category	Private car
Name of Driver	-
Contact Number	-
Address	-
Address complement	-

Postcode	-
Insurance Company Name	-
Nature Of Damage	-
Details of property damaged in accident	-
No. Of Passenger (Including Driver)	-

SKETCH PLAN

IMPORTANT NOTICE

1. Please report correctly the details of the accident to speed up the claims process.
2. This Form must be completed by the Policyholder and/or the Authorised Driver.
3. Information provided must be as truthful and accurate as possible. Any wilful misrepresentation or withholding of material facts may allow insurance companies to repudiate policy liability.
4. The issue and acceptance of this Form by insurance companies is not an admission of policy liability on the part of the insurance companies.
5. Any false reporting may be referred to the Police for investigation.
6. The report will be forwarded by the insurers of the GIA Records Management Centre established by the General Insurance Association of Singapore (GIA) for archiving and that copies of this report will for a fee be made available upon application by interested parties.
7. By the lodgement of this report to the insurers, you hereby consent to the archiving of this report at the centre and to copies of the report being made available aforesaid.

8. Consent under the Personal Data Protection Act (PDPA)

I understand, acknowledge, agree and consent that

(a) my insurer, my workshop and the General Insurance Association of Singapore ("GIA") may/are permitted to collect, use, disclose and/or process my personal data/personal information set out in this [form] and any other personal information provided by me or possessed by my insurer (collectively the "Personal Information") and disclose and transfer such Personal Information to all insurer(s) who have insured vehicle(s) involved in this accident (all insurer(s) who have insured vehicle(s) involved in this accident shall be collectively referred to as the "Insurers"), the Insurers' lawyers/law firms, the Monetary Authority of Singapore and any relevant government agency/authority (such as the police), for the purpose(s) of:

- (i) processing, handling and/or dealing with my claims including the settlement of the claims and any necessary investigations relating to the claims;
- (ii) investigating the accident and/or my claims;
- (iii) carrying out and/or dealing with my instructions or responding to any enquiries by me;
- (iv) administering my claims (including the mailing of correspondence, statements, invoices, reports or notices to me, which could involve disclosure of certain personal data about me to bring about delivery of the same as well as on the external cover of envelopes/mail packages); and/or
- (v) complying with applicable law in administering, processing, handling and/or dealing with my claims (collectively the "Purposes").

(b) all insurer(s) who have insured vehicle(s) involved in this accident and the Insurers' lawyers/law firms, may/are permitted to collect, use, disclose and/or process my Personal Information for one or more of the above Purposes; and

(c) my Personal Information may/can be disclosed by any of the Insurers and/or GIA to their third party service providers or agents (including the lawyers/law firms), which may be sited outside of Singapore, for one or more of the above Purposes.



Policyholder's Signature & Date & Time

[Handwritten Signature]

Driver's Signature (If driver is not the policyholder) (Date & Time)



Witnessed By Reporting Centre Personnel

Sketch Plan

Vehicle 1: 2014 Honda Civic
Vehicle 2: 2014 Honda Civic

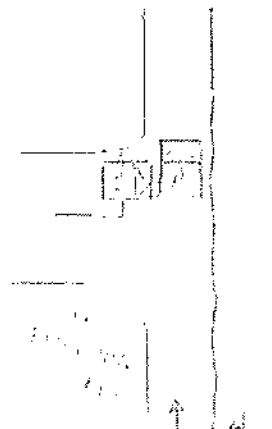

[Handwritten Signature]

DECLARATION OF AUTHENTICITY OF THE ACCIDENT

Handwritten notes on lined paper:

- Top right: *10/10/10*
- Middle right: *10/10/10*
- Center: *10/10/10*
- Bottom left: *10/10/10*

Declaration

I, the undersigned, being duly qualified, hereby declare that the above information is true and correct.



Signature of the Engineer

[Handwritten signature]

Signature of the Inspector of the Department of Transportation

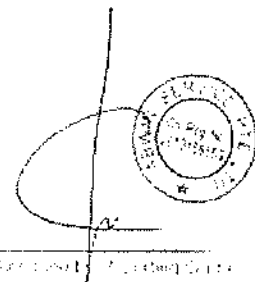

Signature of the Accident Investigator

ON THE STATED DATE AND TIME. I, VEHICLE A (GBJ4293T) WAS TRAVELLING STRAIGHT ON PRINSEP LINK (NEAR LP 2R14) TOWARDS PRINSEP STREET. SUDDENLY, VEHICLE B (SJB4838U) DRIVE OUT FROM THE SMALL ROAD ON THE LEFT SIDE WITHOUT STOPPING AT THE STOP LINE AND COLLIDED ONTO MY VEHICLE LEFT PORTION.

VEHICLE A : GBJ4293T

VEHICLE B : SJB4838U

3/12

