

SINGAPORE ACCIDENT STATEMENT

IMPORTANT NOTICE

1. Please report correctly the details of the accident to speed up the claims process.
2. This Form must be completed by the Policyholder and/or the Authorised Driver
3. Information provided must be as truthful and accurate as possible. Any wilful misrepresentation or withholding of material facts may allow insurance companies to repudiate policy liability.
4. The issue and acceptance of this Form by insurance companies is not an admission of policy liability on the part of the insurance companies.
5. **Any false reporting may be referred to the Police for investigation.**
6. This report will be forwarded by the insurers of the GIA Records Management Centre established by the General Insurance Association of Singapore (GIA) for archiving and that copies of this report will, for a fee, be made available upon application by interested parties.
7. By the lodgement of this report to the insurers, you hereby consent to the archiving of this report at the centre and to copies of the report being made available aforesaid.

ACCIDENT STATEMENT

Date of Submission	04/05/2022 09:21 (SGT)
Date of Accident	29/04/2022 16:16 (SGT)
Exact Location of Accident	Singapore
Additional Location Information	HAVELOCK 2 SHOPPING MALL CAR PARK
Country/State of Loss	Singapore

DETAILS OF OWN VEHICLE

Vehicle Registration Number	SMQ8202M
-----------------------------------	----------

INSURED/POLICYHOLDER

Is company?	No
Name Of Registered Owner	TAN CHIN POH
NRIC No	S1484935A
Email Address	CHINPOH_TAN@YAHOO.COM.SG
Mobile Phone No	(Phone) +65-97661611
Alternative Phone No	+65-97661611

VEHICLE PARTICULARS

Manufacturer	Mercedes
Model	Cla200
Variant	-
Exact purpose for which vehicle was being used at time of accident	-
Are you claiming under your own insurance policy for repair to your vehicle?	Yes
Vehicle Category	Private car
Transmission	Auto
CC	1332

INSURANCE COMPANY

Name of Insurance Company	AIG Asia Pacific Insurance Pte. Ltd.
Type of Coverage	Comprehensive
Fleet Policy	No
Policy Number	1900252171-02
Cover Note Number	-

DRIVER

Name of Driver	TAN CHIN POH
NRIC No	S1484935A

Date Of Birth	26/10/1961
Occupation	Indoor
Date Of Driving Pass	11/12/1979
Driving experience	42 YEARS AND 4 MONTHS
Gender	Male
Mobile Number	(Phone) +65-97661611
Alt. Phone Number	+65-97661611
Email Address	CHINPOH_TAN@YAHOO.COM.SG
Address	12 LENGKOK ANGSA
Address complement	-
Postcode	239264
Is the driver the policyholder?	Yes
If No, Relationship of the Driver with the Insured	-
Does Driver Own Other Vehicles?	No
Vehicle Registration Number of Other Vehicle Owned by Driver	-
Insurance Company of Other Vehicle Owned by Driver	-

GENERAL INFORMATION OF THE ACCIDENT

Type of Accident	Collision - Head to Rear
Weather Conditions	Clear
Road Surface	Dry

OTHER INFORMATION

Was any foreign vehicle involved in the accident?	No
Number of vehicles involved in the accident	2
Was anybody injured in the Accident?	No
Was any injured conveyed to hospital by ambulance?	-
Was any other vehicle or property damaged?	Yes
Number of Passengers (Including Driver)	1
Has the driver been approached by unknown person(s) soliciting/offering accident claims assistance?	No

DETAILS OF POLICE ACTION

Was the accident reported to the police?	No
Was notice of intended Prosecution given?	No
If yes, against whom?	-

CIRCUMSTANCES OF ACCIDENT

REFER TO ATTACHED

ATTACHMENT(S)

Are accident photos available for attachment?	Yes
Was there any video captured by Car Camera?	Yes
Was there any audio recorded?	No

DETAILS OF OTHER VEHICLE PROPERTY 1

Vehicle Registration Number	SKU4054C
Vehicle Manufacturer	-
Vehicle Model	-
Vehicle Variant	-
Vehicle Colour	-
Vehicle Category	Private car
Name of Driver	-
Contact Number	-
Address	-
Address complement	-

Postcode -
Insurance Company Name -
Nature Of Damage -
Details of property damaged in accident -
No. Of Passenger (Including Driver) -

SKETCH PLAN**IMPORTANT NOTICE**

1. Please report correctly the details of the accident to speed up the claims process.
2. This Form must be completed by the Policyholder and/or the Authorised Driver.
3. Information provided must be as truthful and accurate as possible. Any wilful misrepresentation or withholding of material facts may allow insurance companies to repudiate policy liability.
4. The issue and acceptance of this Form by insurance companies is not an admission of policy liability on the part of the insurance companies.
5. Any false reporting may be referred to the Police for investigation.
6. The report will be forwarded by the insurers of the GIA Records Management Centre established by the General Insurance Association of Singapore (GIA) for archiving and that copies of this report will for a fee be made available upon application by interested parties.
7. By the lodgment of this report to the insurers, you hereby consent to the archiving of this report at the centre and to copies of the report being made available aforesaid.

8. Consent under the Personal Data Protection Act (PDPA)

I understand, acknowledge, agree and consent that:

- (a) My insurer, my workshop and the General Insurance Association of Singapore ("GIA") may/are permitted to collect, use, disclose and/or process my personal data/personal information set out in this [form] and any other personal information provided by me or possessed by my insurer (collectively the "Personal Information") and disclose and transfer such Personal Information to all insurer(s) who have insured vehicle(s) involved in this accident (all insurer(s) who have insured vehicle(s) involved in this accident shall be collectively referred to as the "Insurers"), the Insurers' lawyers/law firms, the Monetary Authority of Singapore and any relevant government agency/authority (such as the police), for the purpose(s) of :
 - (i) processing, handling and/or dealing with my claims including the settlement of the claims and any necessary investigations relating to the claims;
 - (ii) investigating the accident and/or my claims;
 - (iii) carrying out and/or dealing with my instructions or responding to any enquiries by me;
 - (iv) administering my claims (including the mailing of correspondence, statements, invoices, reports or notices to me, which could involve disclosure of certain personal data about me to bring about delivery of the same as well as on the external cover of envelopes/mail packages); and/or
 - (v) complying with applicable law in administering, processing, handling and/or dealing with my claims.(collectively the "Purposes")
- (b) all insurer(s) who have insured vehicle(s) involved in this accident and the Insurers' lawyers/law firms, may/are permitted to collect, use, disclose and/or process my Personal Information for one or more of the above Purposes; and
- (c) my Personal Information may/can be disclosed by any of the Insurers and/or GIA to their third party service providers or agents(including their lawyers/law firms), which may be sited outside of Singapore, for one or more of the above Purposes.
- (d) my Personal Information will also be collected and used to compile claims history for the purpose of fraud detection, investigation and management in present and all future claims.
- (e) the information so collected under (d) above may be shared / disclosed:
 - (i) to all insurers and/or any other third parties that assist in evaluating, investigating, controlling or managing fraud, regulators, law enforcement and government agencies as reasonably required for the purposes stated, or
 - (ii) for complying with requirements under any regulations, laws or court orders.

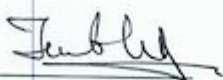
Policyholder's Signature
Date & Time

Driver's Signature
(If driver is not the policyholder)
Date & Time

Go Chee Han
DID : 6771 4336 HP : 9181 7717
Email : cheehan.go@cyclecarriage.com.sg
Cycle & Carriage Industries Pte Ltd
Reporting Centre Personnel's
Name:

SKETCH PLAN

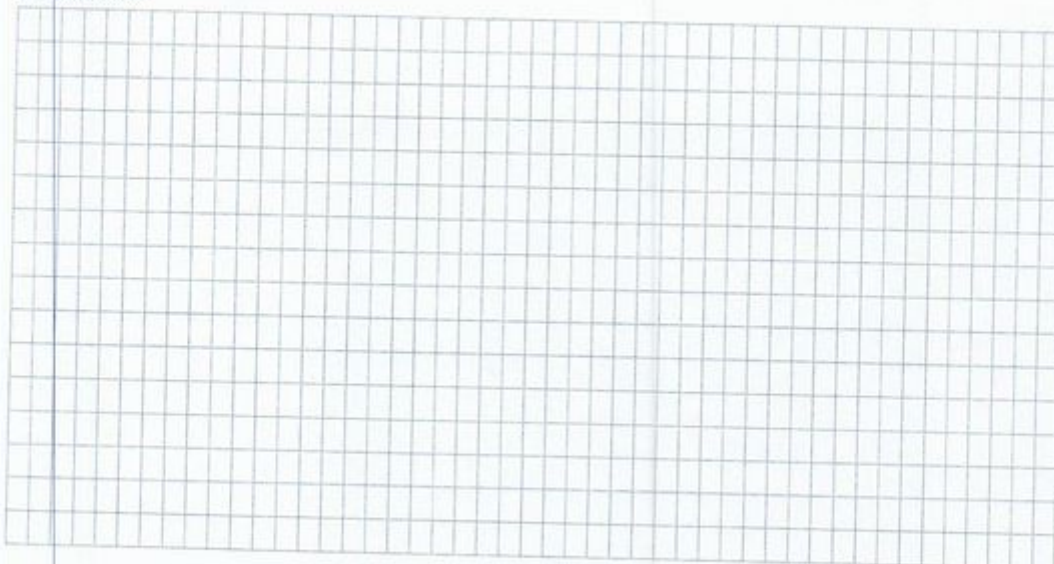

DESCRIBE CIRCUMSTANCES OF THE ACCIDENT

Refer to attachments.

DECLARATION

I/We declare the foregoing particulars are true in every respect.

Please note that you have 14 calendar days to revert and file the claim under your own policy. Failing to do so, your insurance company will not allow nor accept the claim.

(Please contact your insurance company for any further details)

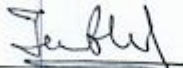
Policyholder's Signature
Date & Time

Driver's Signature
(If driver is not the policyholder)
Date & Time

Reporting Centre Personnel's
Name:

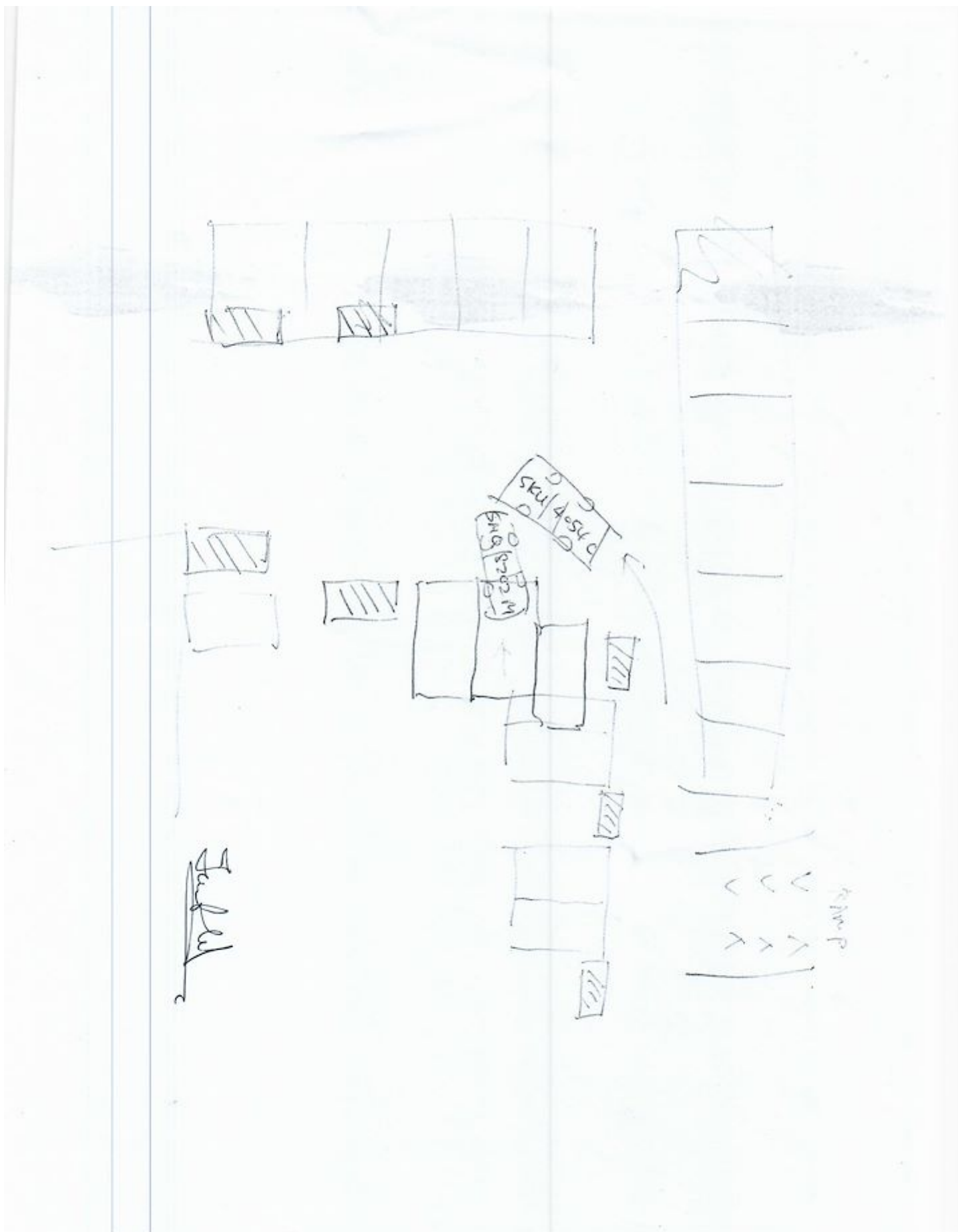

I, Tan Chin Poh (IC No S1484935A) am the owner and driver of a Mercedes Benz CLA 200 (Veh No SMQ8202M) and would like to file the following accident report, which took place at the basement 2 car park of Havelock II on 29 Apr 2022.

At around 4.10pm, I was inching my vehicle halfway out of a car park lot towards the left when a Mazda 5 (Veh No SKU 4054C), driven by Mr Jeffrey Wandly, suddenly cut into my path at speed from the south-easterly direction after rounding a bend, which resulted in a collision between the front right-side of my car and the front left-side of Mr Wandly's vehicle.

Not only did he not brake upon impact, Mr Wandly was going so fast that his Mazda ripped off the entire left section of my car's bumper before stopping a short distance away.

We then exited our vehicles and exchanged notes. According to Mr Wandly, there is a pillar at the bend in the car park that created a blind spot.

Points to consider:

- 1) By Mr Wandly's own admission, there is a blind spot in the car park as vision is hindered by a pillar at the bend
- 2) My car park lot is not aligned to the adjacent lot but protrudes out in front, thus narrowing the pathway after the bend
- 3) My car's front grill was not damaged and the front bumper was also not dented in. Instead the bumper was ripped outwards from the left side, indicating that the impact was from a south-easterly direction
- 4) Mr Wandly was clearly speeding as evidenced by the substantial damage to my car's front bumper when it zipped across the front of my car.



TAN CHIN POH



CERTIFICATE OF INSURANCE

MERCEDES-BENZ MOTOR INSURANCE PRIVATE VEHICLE

Name of Policyholder : TAN CHIN POH
 Period of Insurance : 04 Dec 2021 To 03 Dec 2022
 Engine No. : 28291480249811
 Chassis No. : WDD1183872N042481

Vehicle No. : SMQ8202M
 Policy No. : 1900252171-02
 Endorsement No. :
 Issued Date : 03 Nov 2021

ABOUT THE COVER

Make/Model : MERCEDES BENZ CLA200 COUPE
 Engine Capacity/Tonnage : 1,332.00 CC
 Driver Restriction : NA
 Person or Classes of Persons Entitled to Drive* :
 Sum Insured : Market Value
 Off Peak Car : No
 First Year of Registration : 2019
 Insuring with COE/PARF : Yes

a) The Policyholder
 b) Any other person who is driving on the Policyholder's order or with his/her permission.
 This Policy will indemnify the Policyholder or any authorised driver only if he/she meets the specified age condition.

You have to pay an additional sum of \$3,000 as "Young and/or Inexperienced Driver Excess" ("YIDR") if You are or Your Authorised Driver (named or unnamed) is under the age of 23 and/or has less than 2 years' driving experience.

Age Condition : All Age Condition

Mileage Condition : Unlimited Mileage

Limitation as to use* :

Use only for social, domestic and pleasure purposes and for the Policyholder's business.

This Policy does not cover use for hire or reward, driving tuition, driving test, racing, pace-making, reliability trial or speed-testing, the carriage of goods other than samples in connection with any trade or business or use for any purpose in connection with Motor Trade.

Loss of Use 2000cc

* Limitations rendered inoperative by Section 6 of the Motor Vehicles (Third-Party Risks and Compensation) Act (Cap. 189), Section 95 of the Road Transport Act, 1987 (Malaysia) and Road Transport (Amendment) Act 2019, are not to be included under these headings.

EXCESS

Section 1
 Fire - \$0 Own Damage - \$800 Theft - \$0 Flood Cover - \$800

Section 2
 Property Damage - \$0

Windscreen : \$100

Named Driver and Excess (where applicable)

TAN CHIN POH - \$800 (Own Damage), \$800 (Flood Cover)

APPROVED REPORTING CENTRES/AUTHORISED REPAIRERS (FOR CLAIMS RELATED REPAIRS)

1. Cycle & Carriage Eunos Service Center (For accident reporting only) Add: 330 Ubi Road 3 Singapore 408650 62061818
 2. Cycle & Carriage Pandan Loop Service Center - Body Care & Repair Add: 188 Pandan Loop Singapore 128378 62061818

For other Approved Reporting Centres/AIG Authorised Repairers, please contact our 24-hour accident emergency hotline at +65 6338 6200. Alternatively, you may refer to AIG website www.aig.sg or AIG SG Mobile App. Simply search and download "AIG SG" from iTunes or Google Play.

IMPORTANT NOTES

Hire Purchase Company/Employer's Loan: Daimler Financial Services Africa & Asia Pacific Ltd

I/We hereby certify that the policy to which this Certificate of Insurance relates is issued in accordance with the provisions of the Motor Vehicles(Third Party Risks and Compensation) Act (Cap. 189), Part IV of the Road Transport Act, 1987 (Malaysia), Road Transport (Amendment) Act 2019 and Motor Vehicles (Third Party Risks) Rules, 1959 (Malaysia).

0504612236

CYCLE & CARRIAGE - LEEHAN

AIG Asia Pacific Insurance Pte. Ltd.
 This computer generated document is valid.

1005012334/AC4







