

SINGAPORE ACCIDENT STATEMENT

IMPORTANT NOTICE

1. Please report correctly the details of the accident to speed up the claims process.
2. This Form must be completed by the Policyholder and/or the Authorised Driver
3. Information provided must be as truthful and accurate as possible. Any wilful misrepresentation or withholding of material facts may allow insurance companies to repudiate policy liability.
4. The issue and acceptance of this Form by insurance companies is not an admission of policy liability on the part of the insurance companies.
5. **Any false reporting may be referred to the Police for investigation.**
6. This report will be forwarded by the insurers of the GIA Records Management Centre established by the General Insurance Association of Singapore (GIA) for archiving and that copies of this report will, for a fee, be made available upon application by interested parties.
7. By the lodgement of this report to the insurers, you hereby consent to the archiving of this report at the centre and to copies of the report being made available aforesaid.

ACCIDENT STATEMENT

Date of Submission 12/04/2022 17:39 (SGT)
Date of Accident 12/04/2022 12:27 (SGT)
Exact Location of Accident 1 Opal Cres, Singapore 328396
Additional Location Information OSCP
Country/State of Loss Singapore

DETAILS OF OWN VEHICLE

Vehicle Registration Number SJL2186C

INSURED/POLICYHOLDER

Is company? No
Name Of Registered Owner FOO YEONG MIEN MARTIN
NRIC No S1800343J
Email Address martin.foo2118@gmail.com
Mobile Phone No (Phone) +65-81131928
Alternative Phone No +65-81131928

VEHICLE PARTICULARS

Manufacturer Nissan
Model Latio
Variant -
Exact purpose for which vehicle was being used at time of accident Private use
Are you claiming under your own insurance policy for repair to your vehicle? No - Claiming third party
Vehicle Category Private car
Transmission Auto
CC 1500

INSURANCE COMPANY

Name of Insurance Company Sompo Insurance Singapore Pte. Ltd.
Type of Coverage Comprehensive
Fleet Policy No
Policy Number D21MTPV01015075
Cover Note Number -

DRIVER

Name of Driver XAVIER FOO CHUAN DE
NRIC No S9723746H

Date Of Birth	19/07/1997
Occupation	Indoor
Date Of Driving Pass	03/04/2018
Driving experience	4 YEARS
Gender	Male
Mobile Number	(Phone) +65-87903808
Alt. Phone Number	-
Email Address	mrxavierfoo@gmail.com
Address	BLK 495F TAMPINES STREET 43 #05-360
Address complement	-
Postcode	525495
Is the driver the policyholder?	No
If No, Relationship of the Driver with the Insured	Child
Does Driver Own Other Vehicles?	No
Vehicle Registration Number of Other Vehicle Owned by Driver	-
Insurance Company of Other Vehicle Owned by Driver	-

GENERAL INFORMATION OF THE ACCIDENT

Type of Accident	Hit and run / Vandalism / Damaged whilst parked
Weather Conditions	Clear
Road Surface	Dry

OTHER INFORMATION

Was any foreign vehicle involved in the accident?	No
Number of vehicles involved in the accident	2
Was anybody injured in the Accident?	No
Was any injured conveyed to hospital by ambulance?	-
Was any other vehicle or property damaged?	Yes
Number of Passengers (Including Driver)	1
Has the driver been approached by unknown person(s) soliciting/offering accident claims assistance?	No

DETAILS OF POLICE ACTION

Was the accident reported to the police?	No
Was notice of intended Prosecution given?	No
If yes, against whom?	-

CIRCUMSTANCES OF ACCIDENT

I WAS PARKED STATIONARY AT OSCP OF 1 OPAL CRESCENT IN FRONT OF THE OPAL SUITES AND I WAS INSIDE THE VEHICLE PREPARE TO GO FOR LUNCH. SUDDENLY, I FELT AN IMPACT. A LORRY IN FRONT OF MY VEHICLE DOING PARALLEL PARKING AND COLLIDED INTO FRONT PORTION OF MY VEHICLE AND CAUSED DAMAGES. AFTER THE ACCIDENT, WE EXCHANGED PARTICULARS AND LEFT THE SCENE.

ATTACHMENT(S)

Are accident photos available for attachment?	Yes
Was there any video captured by Car Camera?	No
Was there any audio recorded?	No

DETAILS OF OTHER VEHICLE PROPERTY 1

Vehicle Registration Number	GBG4824C
Vehicle Manufacturer	-
Vehicle Model	-
Vehicle Variant	-
Vehicle Colour	-
Vehicle Category	Commercial vehicle
Name of Driver	-
Contact Number	-

Address	-
Address complement	-
Postcode	-
Insurance Company Name	-
Nature Of Damage	-
Details of property damaged in accident	VEHICLE B
No. Of Passenger (Including Driver)	-

SKETCH PLAN**IMPORTANT NOTICE**

1. Please report correctly the details of the accident to speed up the claims process.
2. This Form must be completed by the Policyholder and/or the Authorised Driver.
3. Information provided must be as truthful and accurate as possible. Any wilful misrepresentation or withholding of material facts may allow insurance companies to repudiate policy liability.
4. The issue and acceptance of this Form by insurance companies is not an admission of policy liability on the part of the insurance companies.
5. Any false reporting may be referred to the Police for investigation.
6. The report will be forwarded by the insurers of the GIA Records Management Centre established by the General Insurance Association of Singapore (GIA) for archiving and that copies of this report will for a fee be made available upon application by interested parties.
7. By the lodgement of this report to the insurers, you hereby consent to the archiving of this report at the centre and to copies of the report being made available aforesaid.
8. **Consent under the Personal Data Protection Act (PDPA)**

I understand, acknowledge, agree and consent that :

(a) My insurer, my workshop and the General Insurance Association of Singapore ("GIA") may/are permitted to collect, use, disclose and/or process my personal data/personal information set out in this [form] and any other personal information provided by me or possessed by my insurer (collectively the "Personal Information") and disclose and transfer such Personal Information to all insurer(s) who have insured vehicle(s) involved in this accident (all insurer(s) who have insured vehicle(s) involved in this accident shall be collectively referred to as the "Insurers"), the Insurers' law yers/law firms, the Monetary Authority of Singapore and any relevant government agency/authority (such as the police), for the purpose(s) of :

- (i) processing, handling and/or dealing with my claims including the settlement of the claims and any necessary investigations relating to the claims;
 - (ii) investigating the accident and/or my claims;
 - (iii) carrying out and/or dealing with my instructions or responding to any enquiries by me;
 - (iv) administering my claims (including the mailing of correspondence, statements, invoices, reports or notices to me, which could involve disclosure of certain personal data about me to bring about delivery of the same as well as on the external cover of envelopes/mail packages); and/or
 - (v) complying with applicable law in administering, processing, handling and/or dealing with my claims.
- (collectively the "Purposes")

- (b) all insurer(s) who have insured vehicle(s) involved in this accident and the Insurers' law yers/law firms, may/are permitted to collect, use, disclose and/or process my Personal Information for one or more of the above Purposes; and
- (c) my Personal Information may/can be disclosed by any of the Insurers and/or GIA to their third party service providers or agents (including their law yers/law firms), which may be sited outside of Singapore, for one or more of the above Purposes.

Policyholder's Signature / Date & Time

Driver's Signature (If driver is not the policyholder) / Date & Time

Witnessed by Reporting Centre Personnel

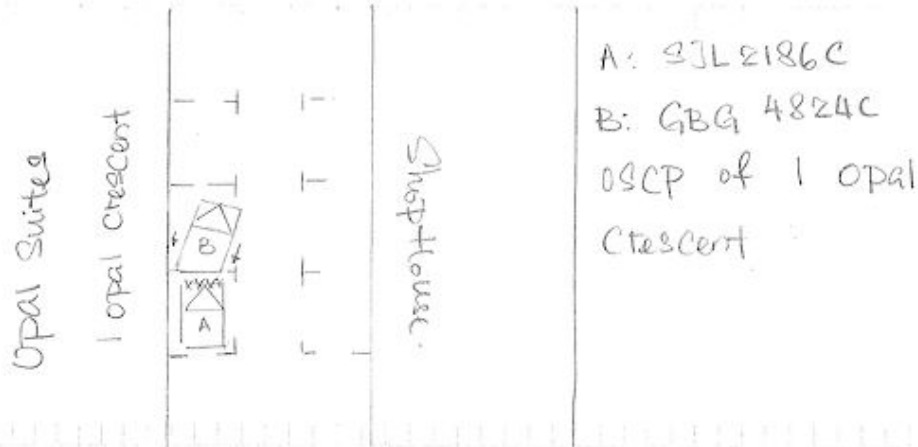
Sketch Plan

DESCRIBE CIRCUMSTANCES OF THE ACCIDENT

I was parked stationary at OSCP of 1 ,Opal Crescent in front of the Opal Suites and I was inside the vehicle prepare go for lunch.

Suddenly, I feel an impact. A lorry in front of my vehicle doing parallel parking and collided into front portion of my vehicle and caused damages.

After the accident, we exchanged particulars and left the scene.

DECLARATION

I/We declare the foregoing particulars are true in every respect.



Policyholder's Signature
Date & Time:



Driver's Signature
(If driver is not the policyholder)
Date & Time:

Reporting Centre Personnel's Signature
Name:
NRIC/FIN No.:

















Certificate of Insurance

ROAD TRAFFIC ACT (CHAPTER 276) (REPUBLIC OF SINGAPORE)
 MOTOR VEHICLES (THIRD-PARTY RISKS AND COMPENSATION) ACT (CHAPTER 189)
 ROAD TRANSPORT ACT 1987 (MALAYSIA)
 ROAD TRANSPORT (AMENDMENT) ACT 2019 (MALAYSIA)
 MOTOR VEHICLES (THIRD-PARTY RISKS) RULES 1959 (MALAYSIA)

Certificate/Policy No. : D21MTPV01015075
 Insured : FOO YEONG MIEN MARTIN
 Motor Vehicle (Registration No.) : ~~SJL2186C~~
 Coverage : Comprehensive - ExcelDrive GOLD
 Policy Commencement Date : 19 NOVEMBER 2021 00:00
 Policy Expiry Date : ~~18 NOVEMBER 2022 23:59~~
 Maximum Liability (Section I) : Market value at time of loss
 Excess* : \$500 - Section I
 Voluntary Excess* : N.A
 Windscreen Excess* : S\$100.00 for each and every applicable claim.
 * Subject to GST wherever applicable

Persons or Classes of Persons entitled to drive*

1. The Insured.
2. Any other person who is driving on the Insured's order or with his permission.
3. In the event of the death of the Insured,
 - a. any member of the Insured's family, or a paid driver who has been driving the Motor Vehicle during the life of the Insured and permission to drive had not been withdrawn prior to the death of the Insured; and
 - b. any other person who has been given permission to drive the Motor Vehicle prior to the death and such permission had not been withdrawn by the Insured.

Provided that the person driving is permitted in accordance with the licensing or other laws or regulations to drive the Motor Vehicle or has been so permitted and is not disqualified by order of a Court of Law or by reason of any enactment or regulation in that behalf from driving the Motor Vehicle. And provided further that the Motor Vehicle is registered under the Road Traffic Act (Chapter 276) and its registration under the Road Traffic Act (Chapter 276) has not been cancelled at the time of the accident, loss or damage.

Limitations As To Use

Use only for social, domestic and pleasure purpose and for the Insured's business. The Policy does not cover use for hire or reward, racing, pace-making, speed testing, reliability trial, the carriage of goods other than samples in connection with any trade or business or use for any purposes in connection with the Motor Trade.

ExcelDrive Workshops and Accident Reporting

It is a condition precedent to liability that the Insured shall call at the Company's Accident Reporting Center with the Motor Vehicle within 24 hours of the accident or by the next working day thereof.

All accident repairs to the Motor Vehicle must be carried out at ExcelDrive Workshops, otherwise the claim is not payable under the Policy. For ExcelDrive Prestige Plan, accident repairs to the Motor Vehicle can be carried out at any workshop other than ExcelDrive Workshops.

For the list of Accident Reporting Centres and ExcelDrive Workshops, please visit our website at www.sompo.com.sg or call our Emergency Hotline: (65) 6226 3323.

WE HEREBY CERTIFY that the policy to which this Certificate relates is issued in accordance with (1) the provisions of the Motor Vehicles (Third-Party Risks and Compensation) Act (Chapter 189) and Part IV of the Road Transport Act 1987 (Malaysia); and (2) the Policy terms, conditions and exceptions of the Private Car Policy ref MTP.30

Sompo Insurance Singapore Pte. Ltd.



Authorised Signatory

Date/Time of Issue : 20 OCTOBER 2021 15:01

IMPORTANT NOTICE

- a. Keep the Certificate in your Motor Vehicle;
- b. Under the Motor Vehicles (Third-Party Risks and Compensation) Act (Chapter 189), it shall be unlawful for any person to use or cause to permit any other person to use a Motor Vehicle without a valid policy of insurance under the Act;
- c. On the sale of the Motor Vehicle or if for any reason the insurance is terminated during its currency, the Insured must surrender the Certificate of Insurance and the Policy to the insurance company. If the Certificate of Insurance has been lost or destroyed, a statutory declaration to that effect must be made. Failure to comply with this obligation is an offence under the Motor Vehicles (Third-Party Risks and Compensation) Act (Chapter 189);
- d. This Policy will cease to be valid once the Motor Vehicle has been sold to another person. The Policy is not transferable to the new owner of the Motor Vehicle.

Intermediary Code & Name : 11A27404 & AUTOSHIELD PTE. LTD. CI Code : 22A XFXDHZK2RB0DBHRA