

Sm - EQ

- LKK - Adrian

SINGAPORE ACCIDENT STATEMENT

IMPORTANT NOTICE

1. Please report correctly the details of the accident to speed up the claims process.
2. This Form must be completed by the Policyholder and/or the Authorised Driver.
3. Information provided must be as truthful and accurate as possible. Any wilful misrepresentation or withholding of material facts may allow insurance companies to repudiate policy liability.
4. The issue and acceptance of this Form by insurance companies is not an admission of policy liability on the part of the insurance companies.
5. Any false reporting may be referred to the Police for investigation.
6. This report will be forwarded by the insurers of the GIA Records Management Centre established by the General Insurance Association of Singapore (GIA) for archiving and that copies of this report will, for a fee, be made available upon application by interested parties.
7. By the lodgement of this report to the insurers, you hereby consent to the archiving of this report at the centre and to copies of the report being made available aforesaid.

ACCIDENT STATEMENT

Date of Submission	12/04/2022 17:39 (SGT)
Date of Accident	12/04/2022 12:27 (SGT)
Exact Location of Accident	1 Opal Cres, Singapore 328396
Additional Location Information	OSCP
Country/State of Loss	Singapore

DETAILS OF OWN VEHICLE

Vehicle Registration Number	SJL2186C
-----------------------------	----------

INSURED/POLICYHOLDER

Is company?	No
Name Of Registered Owner	FOO YEONG MIEN MARTIN
NRIC No	S1800343J
Email Address	martin.foo2118@gmail.com
Mobile Phone No	(Phone) +65-81131928
Alternative Phone No	+65-81131928

VEHICLE PARTICULARS

Manufacturer	Nissan
Model	Latio
Variant	-
Exact purpose for which vehicle was being used at time of accident	Private use
Are you claiming under your own insurance policy for repair to your vehicle?	No - Claiming third party
Vehicle Category	Private car
Transmission	Auto
CC	1500

INSURANCE COMPANY

Name of Insurance Company	Sompo Insurance Singapore Pte. Ltd.
Type of Coverage	Comprehensive
Fleet Policy	No
Policy Number	D21MTPV01015075
Cover Note Number	-

DRIVER

Name of Driver	XAVIER FOO CHUAN DE
NRIC No	S9723746H

Date Of Birth	19/07/1997
Occupation	Indoor
Date Of Driving Pass	03/04/2018
Driving experience	4 YEARS
Gender	Male
Mobile Number	(Phone) +65-87903808
Alt. Phone Number	-
Email Address	mrxavierfoo@gmail.com
Address	BLK 495F TAMPINES STREET 43 #05-360
Address complement	-
Postcode	525495
Is the driver the policyholder?	No
If No, Relationship of the Driver with the Insured	Child
Does Driver Own Other Vehicles?	No
Vehicle Registration Number of Other Vehicle Owned by Driver	-
Insurance Company of Other Vehicle Owned by Driver	-

GENERAL INFORMATION OF THE ACCIDENT

Type of Accident	Hit and run / Vandalism / Damaged whilst parked
Weather Conditions	Clear
Road Surface	Dry

OTHER INFORMATION

Was any foreign vehicle involved in the accident?	No
Number of vehicles involved in the accident	2
Was anybody injured in the Accident?	No
Was any injured conveyed to hospital by ambulance?	-
Was any other vehicle or property damaged?	Yes
Number of Passengers (Including Driver)	1
Has the driver been approached by unknown person(s) soliciting/offering accident claims assistance?	No

DETAILS OF POLICE ACTION

Was the accident reported to the police?	No
Was notice of intended Prosecution given?	No
If yes, against whom?	-

CIRCUMSTANCES OF ACCIDENT

I WAS PARKED STATIONARY AT OSCP OF 1 OPAL CRESCENT IN FRONT OF THE OPAL SUITES AND I WAS INSIDE THE VEHICLE PREPARE TO GO FOR LUNCH. SUDDENLY, I FELT AN IMPACT. A LORRY IN FRONT OF MY VEHICLE DOING PARALLEL PARKING AND COLLIDED INTO FRONT PORTION OF MY VEHICLE AND CAUSED DAMAGES. AFTER THE ACCIDENT, WE EXCHANGED PARTICULARS AND LEFT THE SCENE.

ATTACHMENT(S)

Are accident photos available for attachment?	Yes
Was there any video captured by Car Camera?	No
Was there any audio recorded?	No

DETAILS OF OTHER VEHICLE PROPERTY 1

Vehicle Registration Number	GBG4824C
Vehicle Manufacturer	-
Vehicle Model	-
Vehicle Variant	-
Vehicle Colour	-
Vehicle Category	Commercial vehicle
Name of Driver	-
Contact Number	-



Address	-
Address complement	-
Postcode	-
Insurance Company Name	-
Nature Of Damage	-
Details of property damaged in accident	VEHICLE B
No. Of Passenger (Including Driver)	-

SKETCH PLAN

IMPORTANT NOTICE

1. Please report correctly the details of the accident to speed up the claims process.
2. This Form must be completed by the Policyholder and/or the Authorised Driver.
3. Information provided must be as truthful and accurate as possible. Any wilful misrepresentation or withholding of material facts may allow insurance companies to repudiate policy liability.
4. The issue and acceptance of this Form by insurance companies is not an admission of policy liability on the part of the insurance companies.
5. Any false reporting may be referred to the Police for investigation.
6. The report will be forwarded by the insurers of the GIA Records Management Centre established by the General Insurance Association of Singapore (GIA) for archiving and that copies of this report will for a fee be made available upon application by interested parties.
7. By the lodgement of this report to the insurers, you hereby consent to the archiving of this report at the centre and to copies of the report being made available aforesaid.
8. **Consent under the Personal Data Protection Act (PDPA)**

I understand, acknowledge, agree and consent that :

(a) My insurer, my workshop and the General Insurance Association of Singapore ("GIA") may/are permitted to collect, use, disclose and/or process my personal data/personal information set out in this [form] and any other personal information provided by me or possessed by my insurer (collectively the "Personal Information") and disclose and transfer such Personal Information to all insurer(s) who have insured vehicle(s) involved in this accident (all insurer(s) who have insured vehicle(s) involved in this accident shall be collectively referred to as the "Insurers"), the Insurers' lawyers/law firms, the Monetary Authority of Singapore and any relevant government agency/authority (such as the police), for the purpose(s) of :

(i) processing, handling and/or dealing with my claims including the settlement of the claims and any necessary investigations relating to the claims;

(ii) investigating the accident and/or my claims;

(iii) carrying out and/or dealing with my instructions or responding to any enquiries by me;

(iv) administering my claims (including the mailing of correspondence, statements, invoices, reports or notices to me, which could involve disclosure of certain personal data about me to bring about delivery of the same as well as on the external cover of envelopes/mail packages); and/or

(v) complying with applicable law in administering, processing, handling and/or dealing with my claims (collectively the "Purposes")

(b) all insurer(s) who have insured vehicle(s) involved in this accident and the Insurers' lawyers/law firms, may/are permitted to collect, use, disclose and/or process my Personal Information for one or more of the above Purposes; and

(c) my Personal Information may/can be disclosed by any of the Insurers and/or GIA to their third party service providers or agents (including their lawyers/law firms), which may be sited outside of Singapore, for one or more of the above Purposes.



Policyholder's Signature / Date & Time



Driver's Signature (If driver is not the policyholder) / Date & Time

Witnessed by Reporting Centre Personnel

Sketch Plan

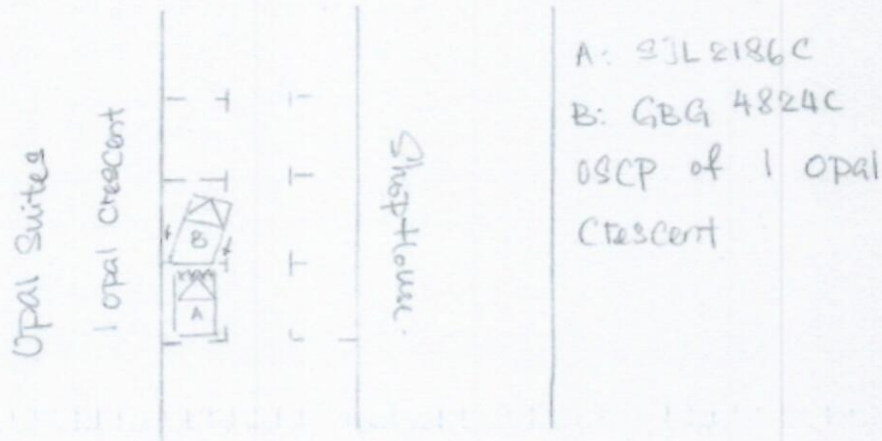

DESCRIBE CIRCUMSTANCES OF THE ACCIDENT

I was parked stationary at OSCP of 1, Opal Crescent in front of the Opal Suites and I was inside the vehicle prepare go for lunch.

Suddenly, I feel an impact. A lorry in front of my vehicle doing parallel parking and collided into front portion of my vehicle and caused damages.

After the accident, we exchanged particulars and left the scene.



DECLARATION

I/We declare the foregoing particulars are true in every respect.



Policyholder's Signature
Date & Time:



Driver's Signature
(If driver is not the policyholder)
Date & Time:

Reporting Centre Personnel's Signature
Name:
NRIC/FIN No.: