

ASS. REC. BY: Kam

REF:

CS/FCI 220001931/RVY3

081N

ASSIGNMENT

From: _____ Date: _____

Estimated Cost: _____

OD / TP / WS / TP RES / OD RES / EVA / INV / MV

To Inspect Vehicle No: SMD 2338Uat Workshop m/s Y6W TEG Automobilesof 39, WOODMAN'S CLOSE #01-12 CMKURInsured: FCI

Policy No. _____

Claims No. _____

Sum Insured: _____ Excess: _____

(Client's Record)

Make of Veh: _____

(Policy Condition)

Remark: The veh had commenced its
repair at the time of inspection.

N/S	O/S

Bal. or Market Value: 189K

IDAC Accident Rpt: _____ Consistent? : Yes or No

GIA / PR Seen: _____ Consistent? : Yes or No

Est. Repairs: _____ days Res.: Yes or No

Lum Sum: _____ % 3 Val.: Yes or No

CA / REV / REP. / 24 HRS

Date: _____ Person Contacted: _____

Vehicle: IN / OUT

Veh No: SMD 2338U Yr Regn: 7019 / D6CType: M. Car / M. Cycle / Bus / Van / Lorry / Taxi / Prime Mover /

Truck / Trailer or _____

Make: B. M. W. 520I c.c. 1998Colour: GRBY A/C: Insured / Std / NI / NASp. Reading: 47774 T/Radio: Insured / Std / NI / NA

Eng/No: _____

C/No: WBAJR120 70WW 55439Gen. Cond: Good / Fair / Poor / Burnt

Steering: In order / Jammed / Leaked / Burnt or _____

Brake: In order / Jammed / Leaked / Burnt or _____

Modl: NII / S/Rim / STD A/Rim or _____

Tyre Size: F: 245/45ZR18R: u 2

BS / DUN / EXNOVA / GY / FS / LIZA / MIC / OHTSU / PIR / SUMI /

TOYO / YOKO or HANKOOK

Front

Rear

R/Bal. 6 mmR/Bal. 6 mmL/Bal. 6 mmL/Bal. 6 mmD.O.A. 26/02/22D.O.I. 02/03/22Survey held at Y6W TEG

Des. of Damages: Frt / Rear / O/S / N/S / U/C / Rooftop or

FRONT O/S

The U/C / Chassis frame / Body Structure affected due to collision.

Date / Time	Action / Instruction
	<u>REPAIR LIMIT 108K</u>

Date/Time, File Pass to?

☐

: Prell. Report

1)

☐

: Final Report

Date/Time, File Return to?

2)

Days Of Repair: _____

Resurvey No. of Trip: _____

Add Fee:

☐

: Site Insp (\$

☐

: Interview (\$

☐

: Tech. Invs (\$

☐

: Weekend (\$

Survey Fee:

Transportation:

\$ + RS. \$

Photos

Others

TOTAL

Repair Format: _____

Lump Sum / L.B. / ()

Yew Tee Automobile Tech Pte Ltd (Co.Reg.No.200311009C)

Mega@Woodlands, 39 Woodlands Close #01-12

Singapore 737856

Tel: Fax: Email:

INSURER : FIRST CAPITAL INSURANCE LTD**PARTICULARS OF CLAIM**

Claim Type:	TP	Ref. No:	
Policy No:	D21MTPV01015541	Date of Loss:	26/02/2022
Vehicle Reg. No.:	SMQ2338U	Driveable?	no
Driver Age:		Third Party Vehicle No.:	GBH5279P
Any Injuries?	no	Contact No:	
Insured/Claimant:	KIAN HUAT TIMBER INDUSTRIES (1978) PTE LTD	Driver:	Teng Zong Liang

PARTS MODEL

Make/Model:	BMW, 520i - WBANT12010CX30284	Vehicle Reg. Date:	
Vehicle Colour:		Engine Number:	
Chassis No:	WBAJR12070WW55439	Odometer:	
Total Loss?		Est. Duration of Repair(Day)	

DESCRIPTION OF ACCIDENT/LOSS

Description of Accident/loss

Remarks:

Present Location: Yew Tee Automobile Tech Pte Ltd (Mega)-YTMG

COST OF CLAIMS

	Amount
Parts	10,944.00
Miscellaneous Items	90.00
Labour	1,260.00
Paintwork Labour	420.00
Towing	0.00
Gross Total(\$\$):	12,714.00
GST 7.00%(\$\$):	889.98
Nett Amount(\$\$):	13,603.98

This claim is handled by: Sky Toh T C

LKK Auto Consultants hence notify the Repairer of the following:

- To resurvey before/after spray painting
- To display damaged part(s) during resurvey
- Parts prices are subject to confirmation
- Third party survey is on a "Without Prejudice" basis
- No illegal modification(s) is allowed
- Supplementary item(s) must be resurveyed and is subject to final approval from Insurance Company

Acknowledged by Repairer

Signature:

Date:

REPAIR DETAILS**Estimates On Parts**

No.	Qty	Particulars	Amount	%Disc	After Disc
1	1	FRONT BUMPER <i>SUC</i>	2,850.00	-5.00	2,707.50
2	1	FRONT BUMPER LOWER GRILLE ?	450.00	-5.00	427.50
3	1	FRONT GRILLE CHROME RH <i>SUC</i>	280.00	-5.00	266.00
4	1	FRONT GRILLE RH ?	290.00	-5.00	275.50
5	1	FRONT HEADLAMP LED RH ?	7,320.00	-5.00	6,954.00
6	1	FRONT HEADLAMP LOWER BRACKET RH ?	330.00	-5.00	313.50

Total Parts (S\$) 10,944.00

Estimates of Miscellaneous Items

No.	Qty	Particulars	Amount	%Disc	After Disc
1	1	FRONT NUMBER PLATE <i>SUC</i>	45.00	0.00	45.00 35
2	1	FRONT BUMPER CLIPS <i>RM</i>	45.00	0.00	45.00 30

Sub Total (S\$) 90.00

Estimates On Labour

No.	Qty	Particulars	Amount	%Disc	After Disc
1	1	To Disconnect and Reconnect, Check Electrical wiring Harness Wire, Sockets, Replace Damaged Parts.	30.00	0.00	30.00 ✓
2	1	To Remove and Refit Front Bumper Sensor.	80.00	0.00	80.00 60
3	1	To Computer Reset and Re-program all fault code.	350.00	0.00	350.00 100
4	1	To Remove and Replace the above Damaged Parts, Straighten, Knock out, Realign and Repair including Cut and Weld body panels. To Re-adjust to the Original position using power tools.	800.00	0.00	800.00 300

Gross Labour Cost (S\$) 1,260.00

Estimates On Paint Work Labour

No.	Qty	Particulars	Amount	%Disc	After Disc
1	1	To Carry-Out Body Cavity Preservation.	70.00	0.00	70.00 X
2	1	To Spray painting on the Replaced and Repair Parts, Prepare Spray Such as Masking Tape the unaffected areas with paper, Cleaning and Sanding of Surfaces, Final Polishing and Waxing are also available.	350.00	0.00	350.00 250

Gross Labour Cost (S\$) 420.00

< END OF ESTIMATES >

Rasul
Hp 90010068

3 days

P/P

02/03/21 @ 1100

Resury before paint

SINGAPORE ACCIDENT STATEMENT

IMPORTANT NOTICE

1. Please report correctly the details of the accident to speed up the claims process.
2. This Form must be completed by the Policyholder and/or the Authorised Driver.
3. Information provided must be as truthful and accurate as possible. Any wilful misrepresentation or withholding of material facts may allow insurance companies to repudiate policy liability.
4. The issue and acceptance of this Form by insurance companies is not an admission of policy liability on the part of the insurance companies.
5. Any false reporting may be referred to the Police for investigation.
6. This report will be forwarded by the insurers of the GIA Records Management Centre established by the General Insurance Association of Singapore (GIA) for archiving and that copies of this report will, for a fee, be made available upon application by interested parties.
7. By the lodgement of this report to the insurers, you hereby consent to the archiving of this report at the centre and to copies of the report being made available aforesaid.

ACCIDENT STATEMENT

Date of Submission	26/02/2022 15:05 (SGT)
Date of Accident	26/02/2022 12:55 (SGT)
Exact Location of Accident	6 Sungei Kadut Street 4, Singapore 729036
Additional Location Information	Open Car Park of 6 Sungei Kadut St 4
Country/State of Loss	Singapore

DETAILS OF OWN VEHICLE

Vehicle Registration Number	SMQ2338U
-----------------------------	----------

INSURED/POLICYHOLDER

Is company?	Yes
Name Of Registered Owner	KIAN HUAT TIMBER INDUSTRIES (1978) PTE LTD
Company Reg No	1XXXXX081N
Email Address	tengzi8899@gmail.com
Mobile Phone No	(Phone) +65-97621666
Alternative Phone No	+65-97621666

VEHICLE PARTICULARS

Manufacturer	BMW
Model	520i
Variant	-
Exact purpose for which vehicle was being used at time of accident	-
Are you claiming under your own insurance policy for repair to your vehicle?	No - Claiming third party
Vehicle Category	Private car
Transmission	Auto
CC	1998

INSURANCE COMPANY

Name of Insurance Company	Sompo Insurance Singapore Pte. Ltd.
Type of Coverage	Comprehensive
Fleet Policy	No
Policy Number	D21MTPV01015541
Cover Note Number	17/12/2021-16/12/2022

DRIVER

Name of Driver	Teng Zong Liang
NRIC No	SXXXX080C

Date Of Birth
Occupation
Date Of Driving Pass
Driving experience
Gender
Mobile Number
Alt. Phone Number
Email Address
Address
Address complement
Postcode

Is the driver the policyholder?
If No, Relationship of the Driver with the Insured
Does Driver Own Other Vehicles?
Vehicle Registration Number of Other Vehicle Owned by Driver
Insurance Company of Other Vehicle Owned by Driver

11/08/1970
Indoor
12/04/1990
31 YEARS AND 10 MONTHS
Male
(Phone) +65-97621666
tengz18899@gmail.com
Blk 605 Senja Road #24-43

GENERAL INFORMATION OF THE ACCIDENT

Type of Accident
Weather Conditions
Road Surface

Collided into Parked Vehicle
Clear
Dry

OTHER INFORMATION

Was any foreign vehicle involved in the accident? No
Number of vehicles involved in the accident 2
Was anybody injured in the Accident? No
Was any injured conveyed to hospital by ambulance? -
Was any other vehicle or property damaged? Yes
Number of Passengers (Including Driver) 0
Has the driver been approached by unknown person(s) soliciting/offering accident claims assistance? No

DETAILS OF POLICE ACTION

Was the accident reported to the police? No
Was notice of intended Prosecution given? No
If yes, against whom? -

CIRCUMSTANCES OF ACCIDENT

Kindly refer to the sketch plan

ATTACHMENT(S)

Are accident photos available for attachment? Yes
Was there any video captured by Car Camera? Yes
Was there any audio recorded? No

DETAILS OF OTHER VEHICLE PROPERTY 1

Vehicle Registration Number GBH5279P
Vehicle Manufacturer Nissan
Vehicle Model -
Vehicle Variant -
Vehicle Colour -
Vehicle Category Commercial vehicle
Name of Driver Elmi Bin Maslan
NRIC No SXXXX892Z
Contact Number -
Address -

Address complement
Postcode
Insurance Company Name
Nature Of Damage
Details of property damaged in accident
No. Of Passenger (Including Driver)

-
-
-
-
-
-

SKETCH PLANIMPORTANT NOTICE

1. Please report correctly the details of the accident to speed up the claims process.
2. This Form must be completed by the Policyholder and/or the Authorised Driver.
3. Information provided must be as truthful and accurate as possible. Any wilful misrepresentation or withholding of material facts may allow insurance companies to repudiate policy liability.
4. The issue and acceptance of this Form by insurance companies is not an admission of policy liability on the part of the insurance companies.
5. Any false reporting may be referred to the Police for investigation.
6. The report will be forwarded by the insurers of the GIA Records Management Centre established by the General Insurance Association of Singapore (GIA) for archiving and that copies of this report will for a fee be made available upon application by interested parties.
7. By the lodgment of this report to the insurers, you hereby consent to the archiving of this report at the centre and to copies of the report being made available aforesaid.
8. **Consent under the Personal Data Protection Act (PDPA)**

I understand, acknowledge, agree and consent that:

- (a) My insurer, my workshop and the General Insurance Association of Singapore ("GIA") may/are permitted to collect, use, disclose and/or process my personal data/personal information set out in this [form] and any other personal information provided by me or possessed by my insurer (collectively the "Personal Information") and disclose and transfer such Personal Information to all insurer(s) who have insured vehicle(s) involved in this accident (all insurer(s) who have insured vehicle(s) involved in this accident shall be collectively referred to as the "Insurers"), the Insurers' lawyers/law firms, the Monetary Authority of Singapore and any relevant government agency/authority (such as the police), for the purpose(s) of:
 - (i) processing, handling and/or dealing with my claims including the settlement of the claims and any necessary investigations relating to the claims;
 - (ii) investigating the accident and/or my claims;
 - (iii) carrying out and/or dealing with my instructions or responding to any enquiries by me;
 - (iv) administering my claims (including the mailing of correspondence, statements, invoices, reports or notices to me, which could involve disclosure of certain personal data about me to bring about delivery of the same as well as on the external cover of envelopes/mail packages); and/or
 - (v) complying with applicable law in administering, processing, handling and/or dealing with my claims (collectively the "Purposes")
- (b) all insurer(s) who have insured vehicle(s) involved in this accident and the Insurers' lawyers/law firms, may/are permitted to collect, use, disclose and/or process my Personal Information for one or more of the above Purposes; and
- (c) my Personal Information may/can be disclosed by any of the Insurers and/or GIA to their third party service providers or agents (including their lawyers/law firms), which may be sited outside of Singapore, for one or more of the above Purposes.
- (d) my Personal Information will also be collected and used to compile claims history for the purpose of fraud detection, investigation and management in present and all future claims.
- (e) the information so collected under (d) above may be shared / disclosed:
 - (i) to all insurers and/or any other third parties that assist in evaluating, investigating, controlling or managing fraud, regulators, law enforcement and government agencies as reasonably required for the purposes stated, or
 - (ii) for complying with requirements under any regulations, laws or court orders.

Policyholder's Signature
Date & Time:

Driver's Signature
(If driver is not the policyholder)
Date & Time: 26/02/22 14:30pm

Reporting Centre Personnel's Signature
Name: Rakesh Kumar
NRIC/FIN No.:

SKETCH PLAN

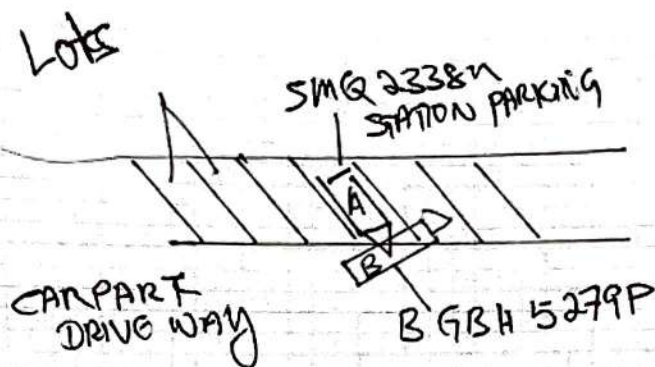

NO 6 SUNGAI KADUT SP4 OFFICE

DESCRIBE CIRCUMSTANCES OF THE ACCIDENT

On 26/03/2022, my car SMQ 2338N PARKED AT MY OFFICE CARPARK IN FRONT MY OFFICE AS I AM HAVING LUNCH IN MY OFFICE, SUDDENLY I HEARD A BANG SOUND AND NOTICED A VAN (GBH 5279P) SIDE BANG & HIT INTO MY CAR FRONT RIGHT PORTION AS MY CAR IS STATION PARKED.

You had been advised by workshop that in the event that you wish to claim against your own policy (OD claim), there is a Fourteen (14) days clause whereby the claim must be made within the stipulated timeframe from the day of occurrence.

Reporting Only
Claim OD
Claim TP
Claim OD TP at other workshop

DECLARATION

I/We declare the foregoing particulars are true in every respect.

Policy No. of:
 Date & Time:



Driver's Signature
 (if driver is not the policy holder)
 Date & Time: 26/03/22
 14:30 pm.

Reporting Centre Personnel's Signature
 Name: Rakeshwar Arund
 NRIC/FIN No.:

> Back to OneMotoring

Enquire PARF/COE Rebate for Registered Vehicle

Vehicle Owner Particulars

Owner ID Type:

Company

Owner ID:

081N

Vehicle Details

Vehicle No.:

SMQ2338U

Vehicle to be Exported:

No

Intended Deregistration Date:

02 Mar 2022

Vehicle Make:

B.M.W.

Vehicle Model:

520i

Primary Colour:

Blue

Manufacturing Year:

2019

Engine No.:

11675754B48B20A

Chassis No.:

WBAJR12070WW55439

Maximum Power Output:

135.0 kW (181 bhp)

Open Market Value:

\$51,807.00

Original Registration Date:

17 Dec 2019

First Registration Date:

17 Dec 2019

Transfer Count:

0

Actual ARF Paid:

\$65,253.00

Intended PARF Rebate Details

PARF Eligibility:

Yes

PARF Eligibility Expiry Date:

16 Dec 2029

PARF Rebate Amount:

\$48,939.00

Intended COE Rebate Details

COE Expiry Date:

16 Dec 2029

COE Category:

E - Open - all except motorcycle

COE Period(Years):

10

QP Paid:

\$40,101.00

COE Rebate Amount:

\$31,157.00

Total Rebate Amount:

\$80,096.00

The information contained herein is correct as at 02 Mar 2022

OK

BMW 5 Series 520i

Overview

Financial

Accessories

Similar

Research

Photos

Map



CAR EMPIRE
AUTOMOBILES PTE LTD

Price	\$189,800		
Depreciation ⓘ	\$20,090 /yr View models with similar depre.	Reg Date	26-Dec-2019 7yrs 9mths 23days COE left)
Mileage	24,008 km (11k /yr)	Manufactured ⓘ	2019
Road Tax ⓘ	\$1,210 /yr	Transmission	Auto
Dereg Value ⓘ	\$80,231 as of today (change)	OMV ⓘ	\$51,807
COE ⓘ	\$40,101	ARF ⓘ	\$65,253
Engine Cap	1,998 cc	Power	135.0 kW (181 bhp)
Curb Weight ⓘ	1,540 kg	No. of Owners ⓘ	1