

# SINGAPORE ACCIDENT STATEMENT

## IMPORTANT NOTICE

1. Please report correctly the details of the accident to speed up the claims process.
2. This Form must be completed by the Policyholder and/or the Authorised Driver
3. Information provided must be as truthful and accurate as possible. Any wilful misrepresentation or withholding of material facts may allow insurance companies to repudiate policy liability.
4. The issue and acceptance of this Form by insurance companies is not an admission of policy liability on the part of the insurance companies.
5. **Any false reporting may be referred to the Police for investigation.**
6. This report will be forwarded by the insurers of the GIA Records Management Centre established by the General Insurance Association of Singapore (GIA) for archiving and that copies of this report will, for a fee, be made available upon application by interested parties.
7. By the lodgement of this report to the insurers, you hereby consent to the archiving of this report at the centre and to copies of the report being made available aforesaid.

## ACCIDENT STATEMENT

Date of Submission .....	21/02/2022 16:15 (SGT)
Date of Accident .....	19/02/2022 11:35 (SGT)
Exact Location of Accident .....	Jurong East Street 31, Singapore
Additional Location Information .....	TOWARDS BOON LAY WAY
Country/State of Loss .....	Singapore

## DETAILS OF OWN VEHICLE

Vehicle Registration Number .....	SLH2735R
-----------------------------------	----------

### INSURED/POLICYHOLDER

Is company? .....	No
Name Of Registered Owner .....	CHEN RUIE
NRIC No .....	SXXXX801C
Email Address .....	yuege196@gmail.com
Mobile Phone No .....	(Phone) +65-82220456
Alternative Phone No .....	+65-98752326

### VEHICLE PARTICULARS

Manufacturer .....	Toyota
Model .....	Wish
Variant .....	-
Exact purpose for which vehicle was being used at time of accident .....	Private use
Are you claiming under your own insurance policy for repair to your vehicle? .....	No - Claiming third party
Vehicle Category .....	Private car
Transmission .....	Auto
CC .....	1794

### INSURANCE COMPANY

Name of Insurance Company .....	China Taiping Insurance (Singapore) Pte. Ltd.
Type of Coverage .....	Comprehensive
Fleet Policy .....	No
Policy Number .....	DMPCSNW00200832102
Cover Note Number .....	-

### DRIVER

Name of Driver .....	LIAN YUEGE
NRIC No .....	SXXXX889B



Date Of Birth .....	09/09/1966
Occupation .....	Indoor
Date Of Driving Pass .....	10/04/2008
Driving experience .....	13 YEARS AND 10 MONTHS
Gender .....	Male
Mobile Number .....	(Phone) +65-98752326
Alt. Phone Number .....	-
Email Address .....	yuege196@gmail.com
Address .....	BLK 196A BOON LAY DRIVE #12-127
Address complement .....	-
Postcode .....	641196
Is the driver the policyholder? .....	No
If No, Relationship of the Driver with the Insured .....	Spouse
Does Driver Own Other Vehicles? .....	No
Vehicle Registration Number of Other Vehicle Owned by Driver .....	-
Insurance Company of Other Vehicle Owned by Driver .....	-

#### GENERAL INFORMATION OF THE ACCIDENT

Type of Accident .....	Collision - Head to Rear
Weather Conditions .....	Clear
Road Surface .....	Dry

#### OTHER INFORMATION

Was any foreign vehicle involved in the accident? .....	No
Number of vehicles involved in the accident .....	2
Was anybody injured in the Accident? .....	Yes
Was any injured conveyed to hospital by ambulance? .....	No
Was any other vehicle or property damaged? .....	Yes
Number of Passengers (Including Driver) .....	1
Has the driver been approached by unknown person(s) soliciting/offering accident claims assistance? .....	No

#### DETAILS OF POLICE ACTION

Was the accident reported to the police? .....	No
Was notice of intended Prosecution given? .....	No
If yes, against whom? .....	-

#### CIRCUMSTANCES OF ACCIDENT

PLEASE REFER TO SKETCH PLAN

#### ATTACHMENT(S)

Are accident photos available for attachment? .....	Yes
Was there any video captured by Car Camera? .....	No
Was there any audio recorded? .....	No

#### DETAILS OF OTHER VEHICLE PROPERTY 1

Vehicle Registration Number .....	SKQ9053T
Vehicle Manufacturer .....	-
Vehicle Model .....	-
Vehicle Variant .....	-
Vehicle Colour .....	-
Vehicle Category .....	Private car
Name of Driver .....	-
Contact Number .....	-
Address .....	-
Address complement .....	-



Postcode .....	-
Insurance Company Name .....	AXA Insurance Pte Ltd
Nature Of Damage .....	-
Details of property damaged in accident .....	-
No. Of Passenger (Including Driver) .....	-

#### INJURED PERSONS DETAILS

##### INJURED 1

Name of injured person .....	LIAN YUEGE
Gender .....	Male
Phone No .....	(Phone) +65-98752326
Address .....	-
Address Complement .....	-
Post Code .....	-
Approximate Age Years Old .....	-
Injuries Sustained .....	SLIGHT INJURY
Injured person in which vehicle? .....	SLH2735R
Were seat belts worn? .....	Yes
Was this injured conveyed to hospital by ambulance? .....	No



# SKETCH PLAN

## IMPORTANT NOTICE

1. Please report correctly the details of the accident to speed up the claims process.
2. This Form must be completed by the Policyholder and/or the Authorised Driver.
3. Information provided must be as truthful and accurate as possible. Any wilful misrepresentation or withholding of material facts may allow insurance companies to repudiate policy liability.
4. The issue and acceptance of this Form by insurance companies is not an admission of policy liability on the part of the insurance companies.
5. Any false reporting may be referred to the Police for investigation.
6. The report will be forwarded by the insurers of the GIA Records Management Centre established by the General Insurance Association of Singapore (GIA) for archiving and that copies of this report will for a fee be made available upon application by interested parties.
7. By the lodgement of this report to the insurers, you hereby consent to the archiving of this report at the centre and to copies of the report being made available aforesaid.
8. **Consent under the Personal Data Protection Act (PDPA)**  
I understand, acknowledge, agree and consent that :  
(a) My insurer, my workshop and the General Insurance Association of Singapore ("GIA") may/are permitted to collect, use, disclose and/or process my personal data/personal information set out in this [form] and any other personal information provided by me or possessed by my insurer (collectively the "Personal Information") and disclose and transfer such Personal Information to all insurer(s) who have insured vehicle(s) involved in this accident (all insurer(s) who have insured vehicle(s) involved in this accident shall be collectively referred to as the "Insurers"), the Insurers' lawyers/law firms, the Monetary Authority of Singapore and any relevant government agency/authority (such as the police), for the purpose(s) of :  
(i) processing, handling and/or dealing with my claims including the settlement of the claims and any necessary investigations relating to the claims;  
(ii) investigating the accident and/or my claims;  
(iii) carrying out and/or dealing with my instructions or responding to any enquiries by me;  
(iv) administering my claims (including the mailing of correspondence, statements, invoices, reports or notices to me, which could involve disclosure of certain personal data about me to bring about delivery of the same as well as on the external cover of envelopes/mail packages); and/or  
(v) complying with applicable law in administering, processing, handling and/or dealing with my claims.  
(collectively the "Purposes")  
(b) all insurer(s) who have insured vehicle(s) involved in this accident and the Insurers' lawyers/law firms, may/are permitted to collect, use, disclose and/or process my Personal Information for one or more of the above Purposes; and  
(c) my Personal Information may/can be disclosed by any of the Insurers and/or GIA to their third party service providers or agents (including their lawyers/law firms), which may be sited outside of Singapore, for one or more of the above Purposes.

Policyholder's Signature / Date & Time

Driver's Signature (If driver is not the policyholder) / Date & Time

Witnessed by Reporting Centre Personnel

Sketch Plan

JULIANE EAST ST 31 TOWARDS BOON LAY WAY

A: SLH 2735R

B: SKQ 9053T

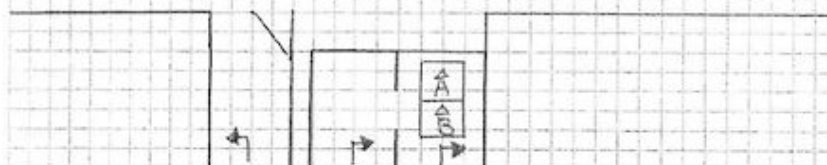



**Describe Circumstances of the Accident**

On 19.02.2022 at about 11:35 am. I was travelling along Jurong East Street 31 towards Boon Lay Way. I was stationery due to traffic light. Suddenly, vehicle B hit my rear portion.

**Declaration**

We declare the foregoing particulars are true in every respect.

Policyholder's Signature / Date & Time

Driver's Signature (If driver is not the policyholder) / Date & Time

Witnessed by Reporting Centre Personnel



















































