

File No. Therian | 14 1760

# ASSIGNMENT

From \_\_\_\_\_ Date \_\_\_\_\_  
 Estimated Cost: \_\_\_\_\_  
OD / TP / WS / TP RES / OD RES / EVA / INV / MV  
 To Inspect Vehicle No. \_\_\_\_\_  
 at Workshop m/s \_\_\_\_\_  
 of \_\_\_\_\_  
 Insured \_\_\_\_\_  
 Policy No. \_\_\_\_\_  
 Claims No. \_\_\_\_\_  
 Sum Insured \_\_\_\_\_ Excess \_\_\_\_\_  
 (Client's Record)  
 Make of Veh \_\_\_\_\_

<input checked="" type="checkbox"/>	<input checked="" type="checkbox"/>
N/S	O/S

(Policy Condition)  
 Remark: The veh had commenced its repair at the time of inspection.

Bal. or Market Value: 186k  
 IDAC Accident Report: \_\_\_\_\_ Consistent? : Yes or No  
 GIA / PR Seen: \_\_\_\_\_ Consistent? : Yes or No  
 Est. Repairs: 5 days Res.: Yes or No  
 Lum Sum: \_\_\_\_\_ % 3 Val.: Yes or No

CA / REV / REP. / 24 HRS

Date: \_\_\_\_\_ Person Contacted: \_\_\_\_\_ Vehicle: IN / OUT

Veh No. SNAQ8218T Yr Regn. 28/7/21  
 Type ☒ Car / ☐ M.Cycle / ☐ Bus / ☐ Van / ☐ Lorry / ☐ Taxi / ☐ Prime Mover /  
 Truck / Trailer or \_\_\_\_\_  
 Make: Audi Q3 Sportback cc 1498  
 Colour: red AC: ☐ Insured / ☐ Std / ☐ HI / ☐ NA  
 Sp Reading: 4674 T/Radio: ☐ Insured / ☐ Std / ☐ HI / ☐ NA  
 Eng No \_\_\_\_\_  
 CNo: WAUZZZF30M1128013  
 Gen Cond: ☒ Good / ☐ Fair / ☐ Poor / ☐ Burnt  
 Steering: ☒ Inorder / ☐ Jammed / ☐ Leaked / ☐ Burnt or \_\_\_\_\_  
 Brake: ☒ Inorder / ☐ Jammed / ☐ Leaked / ☐ Burnt or \_\_\_\_\_  
 Modi: ☒ Nil / ☐ S/Rm / ☐ STD A/Rm or \_\_\_\_\_  
 Tyre Size: F: 215/65R17  
 R: 215/65R17  
 BS / DUN / EXNOVA / GY / FS / LIZA / MIC / OHTSU / PIR / SUMI /  
 TOYO / YOKO or Continental  
 Front: 7 mm Rear: 7 mm  
 R/Bal. 7 mm L/Bal. 7 mm  
 D.O.A. 4/2/22 D.O.I. 8/2/22 1630  
 Survey held at Premium  
 Des. of Damages: ☒ Frt / ☐ Rear / ☐ O/S / ☐ N/S / ☐ UIC / ☐ Rooftop or \_\_\_\_\_  
 The UIC / Chassis frame / Body Structure affected due to collision.

Date / Time	Action / Instruction
	mv: 186k
	rebate: 815/8
	rv: 104482
	EXCESS: TB

Case/Time File Pass to? ☐ : Proff. Report  
☐ : Final Report  
 Date/Time File Return to? \_\_\_\_\_

Days Of Repair: \_\_\_\_\_  
 Resurvey No. of Trlp: \_\_\_\_\_

Add Fee: ☐ : Site Insp (\$) ☐ : Interview (\$) ☐ : Tech. Invs (\$) ☐ : Visual Insp (\$)  
 Survey Fee: \_\_\_\_\_  
 Transportation: \_\_\_\_\_  
 S + RS: \_\_\_\_\_  
 Fines: \_\_\_\_\_  
 Other: \_\_\_\_\_  
 Total: \_\_\_\_\_

Request Form: \_\_\_\_\_  
 Date: 21/06/2022

> Back to OneMotoring

## Enquire PARF/COE Rebate for Registered Vehicle

### Vehicle Owner Particulars

Owner ID Type: Singapore NRIC  
Owner ID: 983F

### Vehicle Details

Vehicle No.: SMQ8218T  
Vehicle to be Exported: No  
Intended Deregistration Date: 09 Feb 2022  
Vehicle Make: AUDI  
Vehicle Model: Q3 SPORTBACK 1.4 TFSI S TRONIC (17")  
Primary Colour: Red  
Manufacturing Year: 2021  
Engine No.: CZDC41672  
Chassis No.: WAUZZZF30M1128013  
Maximum Power Output: 110.0 kW (147 bhp)  
Open Market Value: \$29,714.00  
Original Registration Date: 28 Jul 2021  
First Registration Date: 28 Jul 2021  
Transfer Count: 0  
Actual ARF Paid: \$33,600.00

### Intended PARF Rebate Details

PARF Eligibility: Yes  
PARF Eligibility Expiry Date: 27 Jul 2031  
PARF Rebate Amount: \$25,200.00

### Intended COE Rebate Details

COE Expiry Date: 27 Jul 2031  
COE Category: B - Car above 1600cc or 97kW (130bhp)  
COE Period(Years): 10  
QP Paid: \$59,501.00  
COE Rebate Amount: \$56,318.00  
Total Rebate Amount: \$81,518.00

The information contained herein is correct as at 09 Feb 2022

OK

## AUDI Q3 SPORTBACK Used Vehicle List (4 vehicles)

Car Model	Price	Depreciation	Reg Date	Eng Cap	Mileage	Company	Availability
Audi Q3 Sportback 1.4A TFSI S-tronic	\$185,800	\$18,180 /yr	27-May-2021	1,395 cc	5,000 km	Car Guru.Com Pte Ltd	Available

Low Mileage Of 5000km. 5 Years Warranty From Audi Singapore. 4 Free Servicing To Go. Car Not Even Done 1st Servicing Yet. Pristine Condition Coupled With Luxury Interior. New Car Priced At \$230,000. C...

Office No. - 67639595

Jimmy Cal - 90079944

Audi RS Q3 Sportback 2.5A TFSI Quattro S-tronic	\$338,000	\$32,830 /yr	23-Apr-2021	2,480 cc	6,282 km		Available
---	-----------	--------------	-------------	----------	----------	--	-----------

Pristine Condition With Low Mileage, Exterior Paint In Turbo Blue, Fine Nappa Leather Interior And Trim In Black With Honey Comb Pattern, Agent Unit, Agent Warranty Till 2026, Strictly No Dealers Plea...

Office No. - -

TTM - 86867753

Audi Q3 Sportback 1.4A TFSI S-tronic	\$188,800	\$18,330 /yr	28-Jun-2021	1,395 cc	16,200 km	Delgrow Automotive	Available
--------------------------------------	-----------	--------------	-------------	----------	-----------	--------------------	-----------

Well Taken Care Unit, Comes With Premium Auto Warranty. Massive Savings From New. Call/WhatsApp Now For A Non Obligatory Viewing And Discussion. Loan/Trade In Can Be Arranged For Your Convenience.

Office No. - 62518397

Eugene - 91804201 | Lina - 96732411 | Lili Tan - 96731288

Audi Q3 Sportback Mild Hybrid 1.5A 35 TFSI S-tronic (Petrol-Electric)	\$185,800	\$17,980 /yr	30-Jun-2021	1,498 cc	5,819 km	Dickson Automobile	Available
---	-----------	--------------	-------------	----------	----------	--------------------	-----------

Very Low Mileage, Low Bank Rate From 1.85%, All Our Cars Go Through Proper Anti Bacteria Sanitization, Fully Maintained By Optima With Proper Service Records, Can Verify The Authenticity Of The Mileage...

Office No. - 68447667

Ricky Eng - 91853390 | Frankie - 96213635 | Eric Lee - 91827304

sgCarMart is the number one car classifieds for parallel import cars, Toyota, Honda, Nissan, Mitsubishi & BMW. There are plenty of cars for sale, even for COE cars, OPC cars, vans, trucks, hybrid cars, sports cars or stationwagons. You can also buy from a car auction, look up car loans, financial services, low mileage cars, car brands, carpark rates & car insurance. We have new car dealers comprising parallel importers, authorised car dealers, and used car dealers on our site. Find new car price lists, new car launches and new car promotions, and also motoring advice, car reviews & car news on the latest models. Find the right Rental Car for you - get short term rental, long term lease, private hire cars, wedding cars to cars for p-plate probation drivers. Visit our partner sites for job openings for Singapore jobs, real estate, mover, car performance parts, car discussion, forum discussion, commercial vehicle leasing & COE results.

© 2004-2022 sgCarMart. All rights reserved.

$$\begin{array}{r} 118k \\ 12 \\ \hline = 1500 \end{array}$$

$$9 \text{ yrs sm} / 113m$$

$$1500 \times 113$$

$$= 169500$$

$$169500 + 16800$$

$$= 186300$$

$$= 186k$$

$$186k - 81518$$

$$= 104482$$

# WILLIAMS AUTOMOBILES

0500

ESTIMATE : ACCIDENT REPAIRS  
WORKSHOP : UBI ROAD 1  
CONTACT NO : 6366 2323  
FAX NO : 6841 1183  
REFERENCE : PA/OD/0082/2022/JT  
DATE : 7-Feb-22  
WIP : 10411

VEHICLE NOT IN WORKSHOP. KINDLY ARRANGE FOR SURVEY ON 8/2/22

AIG ASIA PACIFIC INSURANCE PTE LTD  
78 SHENTON WAY  
#07-16 AIG BUILDING  
SINGAPORE 079120  
Attn: Motor Claims Dept  
Tel: 6880 4602 - Fax: 6880 4838

OWNER'S NAME : MR LIEW MUN KIONG  
ADDRESS : 50 AMBER ROAD  
#12-01  
SINGAPORE 439888  
TELEPHONE : HP +65 87818438  
TYPE OF CLAIM : OWN DAMAGE CLAIM  
POLICY NO : 7210074983  
VEHICLE NO : SMQ 8218 T  
MODEL CODE : AUDI Q3 SB 1.4 TFSI  
MODEL YEAR : 28/7/2021  
ENGINE NO : CZD C41672  
CHASSIS NO : WAUZZZF30M1128013  
MILEAGE : -  
DATE IN : -  
ESTIMATED BY : JOHNNY BOO / ALLAN WU  
ACCIDENT DATE : 4-Feb-22  
PLACE OF ACCIDENT : 238 THOMSON ROAD CAR PARK

(177)

He also has a *Ph.D.* in *Education* from *University of Illinois*.

$\mathcal{O}(n^2)$  and  $\mathcal{O}(n^2)$  respectively. The total complexity of the algorithm is  $\mathcal{O}(n^2)$ .

ESTIMATED / ABOUT CHARGES FOR ACCIDENT VEHICLE SMQ 8218 T

S/N	NATURE OF JOBS	ESTIMATED CHARGES	SURVEYOR'S RECOMMENDATIONS
1	TO REMOVE, CHECK AND TRANSFER FRONT WIRE HARNESS FOR HEADLIGHTS, HORNS, OUTSIDE TEMPERATURE SENSOR, HEADLIGHT WASHER ASSY AND FRONT PARKING AID.	S/N \$ 480.00	/
2	TO REMOVE AND TRANSFER LHS HEADLIGHT'S CONTROL UNIT AND POWER MODULE.	S/N \$ 400.00	/
3	TO REMOVE AND REINSTALL LHS FRONT DOOR PANEL TRIM. TO REMOVE AND REINSTALL LHS WING MIRROR ASSY TO FACILITATE RESPRAY OF LHS FRONT DOOR.	S/N \$ 280.00	/
4	TO DISMANTLE AND RENEW FRONT BUMPER, LHS FRONT FENDER LHS HEADLIGHT. TO REPAIR LHS FRONT DOOR. RE-ORGANIZE CRASH MANAGEMENT COMPONENTS. REINSTALL ALL PARTS REMOVED.	\$ 2,800.00	<del>Handwritten</del> 1500
5	TO RESPRAY FRONT BUMPER, FRONT BUMPER LOWER SPOILER, LHS FRONT FENDER, LHS FRONT DOOR, LHS REAR DOOR, TWO DOOR COVERS AND BOTH FRONT WHEEL ARCH TRIMS.	\$ 6,000.00	2450
6	TO RENEW LHS FRONT RIM AND CARRY OUT WHEEL ALIGNMENT.	S/N \$ 280.00	XNN
7	TO CARRY OUT DIAGNOSTIC CHECK.	S/N \$ 192.00	/
<b>TOTAL LABOUR CHARGES</b>		<b>\$ 10,432.00</b>	

# PREMIUM AUTOMOBILES



4000 LADY SINGAPORE 4000  
TEL: 6264 1103 FAX: 6264 1103  
100, 101, 102, 103, 104, 105, 106, 107, 108, 109, 110, 111, 112, 113, 114, 115, 116, 117, 118, 119, 120, 121, 122, 123, 124, 125, 126, 127, 128, 129, 130, 131, 132, 133, 134, 135, 136, 137, 138, 139, 140, 141, 142, 143, 144, 145, 146, 147, 148, 149, 150, 151, 152, 153, 154, 155, 156, 157, 158, 159, 160, 161, 162, 163, 164, 165, 166, 167, 168, 169, 170, 171, 172, 173, 174, 175, 176, 177, 178, 179, 180, 181, 182, 183, 184, 185, 186, 187, 188, 189, 190, 191, 192, 193, 194, 195, 196, 197, 198, 199, 200, 201, 202, 203, 204, 205, 206, 207, 208, 209, 210, 211, 212, 213, 214, 215, 216, 217, 218, 219, 220, 221, 222, 223, 224, 225, 226, 227, 228, 229, 230, 231, 232, 233, 234, 235, 236, 237, 238, 239, 240, 241, 242, 243, 244, 245, 246, 247, 248, 249, 250, 251, 252, 253, 254, 255, 256, 257, 258, 259, 260, 261, 262, 263, 264, 265, 266, 267, 268, 269, 270, 271, 272, 273, 274, 275, 276, 277, 278, 279, 280, 281, 282, 283, 284, 285, 286, 287, 288, 289, 290, 291, 292, 293, 294, 295, 296, 297, 298, 299, 300, 301, 302, 303, 304, 305, 306, 307, 308, 309, 310, 311, 312, 313, 314, 315, 316, 317, 318, 319, 320, 321, 322, 323, 324, 325, 326, 327, 328, 329, 330, 331, 332, 333, 334, 335, 336, 337, 338, 339, 340, 341, 342, 343, 344, 345, 346, 347, 348, 349, 350, 351, 352, 353, 354, 355, 356, 357, 358, 359, 360, 361, 362, 363, 364, 365, 366, 367, 368, 369, 370, 371, 372, 373, 374, 375, 376, 377, 378, 379, 380, 381, 382, 383, 384, 385, 386, 387, 388, 389, 390, 391, 392, 393, 394, 395, 396, 397, 398, 399, 400, 401, 402, 403, 404, 405, 406, 407, 408, 409, 410, 411, 412, 413, 414, 415, 416, 417, 418, 419, 420, 421, 422, 423, 424, 425, 426, 427, 428, 429, 430, 431, 432, 433, 434, 435, 436, 437, 438, 439, 440, 441, 442, 443, 444, 445, 446, 447, 448, 449, 450, 451, 452, 453, 454, 455, 456, 457, 458, 459, 460, 461, 462, 463, 464, 465, 466, 467, 468, 469, 470, 471, 472, 473, 474, 475, 476, 477, 478, 479, 480, 481, 482, 483, 484, 485, 486, 487, 488, 489, 490, 491, 492, 493, 494, 495, 496, 497, 498, 499, 500, 501, 502, 503, 504, 505, 506, 507, 508, 509, 510, 511, 512, 513, 514, 515, 516, 517, 518, 519, 520, 521, 522, 523, 524, 525, 526, 527, 528, 529, 530, 531, 532, 533, 534, 535, 536, 537, 538, 539, 540, 541, 542, 543, 544, 545, 546, 547, 548, 549, 550, 551, 552, 553, 554, 555, 556, 557, 558, 559, 560, 561, 562, 563, 564, 565, 566, 567, 568, 569, 570, 571, 572, 573, 574, 575, 576, 577, 578, 579, 580, 581, 582, 583, 584, 585, 586, 587, 588, 589, 590, 591, 592, 593, 594, 595, 596, 597, 598, 599, 600, 601, 602, 603, 604, 605, 606, 607, 608, 609, 610, 611, 612, 613, 614, 615, 616, 617, 618, 619, 620, 621, 622, 623, 624, 625, 626, 627, 628, 629, 630, 631, 632, 633, 634, 635, 636, 637, 638, 639, 640, 641, 642, 643, 644, 645, 646, 647, 648, 649, 650, 651, 652, 653, 654, 655, 656, 657, 658, 659, 660, 661, 662, 663, 664, 665, 666, 667, 668, 669, 670, 671, 672, 673, 674, 675, 676, 677, 678, 679, 680, 681, 682, 683, 684, 685, 686, 687, 688, 689, 690, 691, 692, 693, 694, 695, 696, 697, 698, 699, 700, 701, 702, 703, 704, 705, 706, 707, 708, 709, 710, 711, 712, 713, 714, 715, 716, 717, 718, 719, 720, 721, 722, 723, 724, 725, 726, 727, 728, 729, 730, 731, 732, 733, 734, 735, 736, 737, 738, 739, 740, 741, 742, 743, 744, 745, 746, 747, 748, 749, 750, 751, 752, 753, 754, 755, 756, 757, 758, 759, 760, 761, 762, 763, 764, 765, 766, 767, 768, 769, 770, 771, 772, 773, 774, 775, 776, 777, 778, 779, 780, 781, 782, 783, 784, 785, 786, 787, 788, 789, 790, 791, 792, 793, 794, 795, 796, 797, 798, 799, 800, 801, 802, 803, 804, 805, 806, 807, 808, 809, 810, 811, 812, 813, 814, 815, 816, 817, 818, 819, 820, 821, 822, 823, 824, 825, 826, 827, 828, 829, 830, 831, 832, 833, 834, 835, 836, 837, 838, 839, 840, 841, 842, 843, 844, 845, 846, 847, 848, 849, 850, 851, 852, 853, 854, 855, 856, 857, 858, 859, 860, 861, 862, 863, 864, 865, 866, 867, 868, 869, 870, 871, 872, 873, 874, 875, 876, 877, 878, 879, 880, 881, 882, 883, 884, 885, 886, 887, 888, 889, 890, 891, 892, 893, 894, 895, 896, 897, 898, 899, 900, 901, 902, 903, 904, 905, 906, 907, 908, 909, 910, 911, 912, 913, 914, 915, 916, 917, 918, 919, 920, 921, 922, 923, 924, 925, 926, 927, 928, 929, 930, 931, 932, 933, 934, 935, 936, 937, 938, 939, 940, 941, 942, 943, 944, 945, 946, 947, 948, 949, 950, 951, 952, 953, 954, 955, 956, 957, 958, 959, 960, 961, 962, 963, 964, 965, 966, 967, 968, 969, 970, 971, 972, 973, 974, 975, 976, 977, 978, 979, 980, 981, 982, 983, 984, 985, 986, 987, 988, 989, 990, 991, 992, 993, 994, 995, 996, 997, 998, 999, 1000

## MATERIAL LIST FOR ACCIDENT VEHICLE REGN. NO. SMQ 8218 T

### DAMAGED PARTS & PRICES

S/N	PARTS DESCRIPTION	QTY	UNIT	S/NETT	REMARKS
1	FRONT BUMPER - LH	1	\$	1,423.00	/Scr
2	FRONT BUMPER FIXING PARTS	1	\$	433.00	XNN
3	FRONT BUMPER CLOSING ELEMENT - LH	1	\$	66.00	?
4	FRONT BUMPER CLOSING ELEMENT END PLATE	1	\$	212.00	?
5	FRONT BUMPER SPOILER	1	\$	850.00	/Scr
6	FRONT BUMPER BRACKET	1	\$	24.00	/NIC
7	FRONT BUMPER AIR GUIDE GRILLE - LH	1	\$	171.00	XScr
8	FRONT BUMPER TRIM - LH	1	\$	182.00	XScr
9	FRONT PARKING AID SENSOR SUPPORT - LH	1	\$	29.00	/NIC
10	FRONT BUMPER GUIDE SECTION - LH	1	\$	43.00	XScr
11	FRONT BUMPER TOP COVER	1	\$	137.00	XScr
12	CAUTION STICKER	1	\$	16.00	XScr
13	AIR COND STICKER	1	\$	9.00	XScr
14	FRONT FENDER - LH	1	\$	1,445.00	/Df
15	FRONT FENDER ATTACHMENT PARTS	1	\$	66.00	XNN
16	FRONT FENDER BRACE - LH	1	\$	98.00	?
17	FRONT FENDER BRACKET - LH	1	\$	39.00	?
18	FRONT FENDER CLOSING ELEMENT - LH	1	\$	37.00	?
19	FRONT WHEEL HOUSING LINER - LH	1	\$	260.00	XNN
20	FRONT WHEEL HOUSING LINER ATTACHMENT PARTS	1	\$	105.00	XNN
<b>SUB TOTAL SPARE PARTS</b>				<b>5,645.00</b>	

ALL CHARGES ARE NOT INCLUSIVE OF GST

LEGEND: REMARKS (OK) = APPROVED, REMARKS (X) = NOT APPROVED  
SPARE PARTS ARE SPECIAL NETT.

# PREMIUM AUTOMOBILES

AS PER TAD 1, UNIT 1 FUR 100659  
TEL: 0366 2223 FAX: 0364 1116  
EMAIL: info@premiumaut.com

## MATERIAL LIST FOR ACCIDENT VEHICLE REGN NO. SMQ 8218 T

				DAMAGED PARTS & PRICES	
S/N	PARTS DESCRIPTION	QTY		S/NETT	REMARKS
21	FRONT WHEEL HOUSING LINER COVER - LH	1	\$	18.00	XNN
22	HEADLIGHT MOUNTING - LH	1	\$	132.00	?
23	HEADLIGHT - LH	1	\$	5,952.00	/ Scr
24	LIFT CYLINDER - LH	1	\$	231.00	?
25	LIFT CYLINDER HOSE - LH	1	\$	92.00	?
26	FRONT WHEEL ARCH COVER - LH / RH	2	\$	1,132.00	?
27	FRONT DOOR COVER - LH	1	\$	390.00	XNN
28	REAR DOOR COVER - LH	1	\$	368.00	XNN
29	ALUMINIUM RIM	1	\$	1,414.00	XBVC
30	SUNDRIES		\$	400.00	XNN
TOTAL SPARE PARTS			:	\$	15,774.00
TOTAL LABOUR CHARGES			:	\$	10,432.00
GRAND TOTAL			:	\$	26,206.00

ALL CHARGES ARE NOT INCLUSIVE OF GST

LEGEND: REMARKS (OK) = APPROVED, REMARKS (X) = NOT APROVED  
SPARE PARTS ARE SPECIAL NETT.

NAME

SURVEYED DATE

AUTHORISED DATE

EXCESS COST

LIABILITY

REMARKS

Thuan@Lthayto.com

82235769

8/2/20 1630

Plp excess: TBC

5 days wp

PLEASE NOTE

THIS ESTIMATE IS BASED ON VISUAL INSPECTION OF THE AFFECTED VEHICLE. SHOULD WE REQUIRE FURTHER LABOUR CHARGES AND SPARE PARTS IN THE PROGRESS OF REPAIR, WE SHALL INFORM YOU ACCORDINGLY.

FOR INSPECTION OF VEHICLE, PLEASE REFER TO MS. NORAH KHAI AT TEL: 6768 9828 / 6768 9911 FOR APPOINTMENT.

YOURS FAITHFULLY,

PREMIUM AUTOMOBILES PTE LTD

LKK Auto Consultants hence notify the Repairer of the following:

- To resurvey before/after spray painting
- To display damaged part(s) during resurvey
- Parts prices are subject to confirmation
- Third party survey is on a "Without Prejudice" basis
- No illegal modification(s) is allowed
- Supplementary item(s) must be resurveyed and is subject to final approval from Insurance Company

Acknowledged by Repairer

Signature:

Date:

JOHNNY BOO  
BODY REPAIR MANAGER

ALLAN WU  
CLAIMS CONSULTANT



## ACCIDENT STATEMENT

Date of Submission ..... 05/02/2022 11:57 (SGT)  
 Date of Accident ..... 04/02/2022 20:15 (SGT)  
 Exact Location of Accident ..... 238 Thomson Rd, Singapore 307683  
 Additional Location Information ..... CAR PARK  
 Country/State of Loss ..... Singapore

## DETAILS OF OWN VEHICLE

Vehicle Registration Number ..... SMQ8218T  
 INSURED/POLICYHOLDER  
 Is company? ..... No  
 Name Of Registered Owner ..... LIEW MUN KIONG  
 NRIC No ..... SXXXX983F  
 Email Address ..... LIEWMUNKIONG@GMAIL.COM  
 Mobile Phone No ..... (Phone) +65-87818438  
 Alternative Phone No ..... +65-87818438

## VEHICLE PARTICULARS

Manufacturer ..... Audi  
 Model ..... Q3  
 Variant ..... -  
 Exact purpose for which vehicle was being used at time of accident ..... Private use  
 Are you claiming under your own insurance policy for repair to your vehicle? ..... Yes  
 Vehicle Category ..... Private car  
 Transmission ..... Auto  
 CC ..... 1395

## INSURANCE COMPANY

Name of Insurance Company ..... AIG Asia Pacific Insurance Pte. Ltd.  
 Type of Coverage ..... Comprehensive  
 Fleet Policy ..... No  
 Policy Number ..... 7210074983  
 Cover Note Number ..... -

## DRIVER

Name of Driver ..... LIEW MUN KIONG  
 NRIC No ..... SXXXX983F

Date Of Birth	07/11/1961
Occupation	Indoor
Date Of Driving Pass	22/04/1980
Driving experience	41 YEARS AND 10 MONTHS
Gender	Male
Mobile Number	(Phone) +65-87818438
Alt. Phone Number	+65-87818428
Email Address	LIEWMUNKIONG@GMAIL.COM
Address	50 AMBER ROAD
Address complement	#12-01
Postcode	439888
Is the driver the policyholder?	Yes
If Not, Relationship of the Driver with the Insured	-
Does Driver Own Other Vehicles?	No
Vehicle Registration Number of Other Vehicle Owned by Driver	-
Insurance Company of Other Vehicle Owned by Driver	-

#### GENERAL INFORMATION OF THE ACCIDENT

Type of Accident	Collided into Property
Weather Conditions	Clear
Road Surface	Dry

#### OTHER INFORMATION

Was any foreign vehicle involved in the accident?	No
Number of vehicles involved in the accident	1
Was anybody injured in the Accident?	No
Was any injured conveyed to hospital by ambulance?	-
Was any other vehicle or property damaged?	No
Number of Passengers (Including Driver)	2
Has the driver been approached by unknown person(s) soliciting/offering accident claims assistance?	No

#### PASSENGER 1

Name	NG PEI LING
Gender	Female

#### DETAILS OF POLICE ACTION

Was the accident reported to the police?	No
Was notice of intended Prosecution given?	No
If yes, against whom?	-

#### CIRCUMSTANCES OF ACCIDENT

THE ACCIDENT HAPPENED ON VELOCITY TURNING OUT THE CAR PARK SLOPE AND ACCIDENTALLY SCRATCH THE WALL.

#### ATTACHMENT(S)

Are accident photos available for attachment?	Yes
Was there any video captured by Car Camera?	No
Was there any audio recorded?	No

# SKETCH PLAN

1. This form must be completed by the Policyholder and/or the Authorized Driver. Information must be as truthful and accurate as possible. Any willful misrepresentation is a breach of the insurance policy and may result in the insurance companies to repudiate policy liability.

2. The issue and acceptance of this Form by insurance companies is not an admission of policy liability on the part of the insurance companies.

## 5. Any false reporting may be referred to the Police for investigation.

6. The report will be forwarded by the insurers of the GIA Records Management Centre established by the General Insurance Association of Singapore (GIA) for archiving and that copies of this report will for a fee be made available upon application by interested parties.

7. By the lodgement of this report to the insurers, you hereby consent to the archiving of this report at the centre and to copies of the report being made available aforesaid.

## 8. Consent under the Personal Data Protection Act (PDPA)

I understand, acknowledge, agree and consent that:

- (a) My insurer, my workshop and the General Insurance Association of Singapore ("GIA") may/are permitted to collect, use, disclose and/or process my personal data/personal information set out in this [form] and any other personal information provided by me or possessed by my insurer (collectively the "Personal Information") and disclose and transfer such Personal Information to all insurer(s) who have insured vehicle(s) involved in this accident (all insurer(s) who have insured vehicle(s) involved in this accident shall be collectively referred to as the "Insurers"), the Insurers' lawyers/law firms, the Monetary Authority of Singapore and any relevant government agency/authority (such as the police), for the purpose(s) of:
  - (i) processing, handling and/or dealing with my claims including the settlement of the claims and any necessary investigations relating to the claims;
  - (ii) investigating the accident and/or my claims;
  - (iii) carrying out and/or dealing with my instructions or responding to any enquiries by me;
  - (iv) administering my claims (including the mailing of correspondence, statements, invoices, reports or notices to me, which could involve disclosure of certain personal data about me to bring about delivery of the same as well as on the external cover of envelopes/mail packages), and/or
  - (v) complying with applicable law in administering, processing, handling and/or dealing with my claims.
 (collectively the "Purposes")
- (b) all insurer(s) who have insured vehicle(s) involved in this accident and the Insurers' lawyers/law firms, may/are permitted to collect, use, disclose and/or process my Personal Information for one or more of the above Purposes; and
- (c) my Personal Information may/can be disclosed by any of the Insurers and/or GIA to their third party service providers or agents (including their lawyers/law firms), which may be sited outside of Singapore, for one or more of the above Purposes.



Policyholder's Signature / Date & Time  
 11/30hrs

Driver's Signature (If driver is not the policyholder) / Date & Time

Witnessed by Reporting Centre Personnel Tony Fong

## Sketch Plan

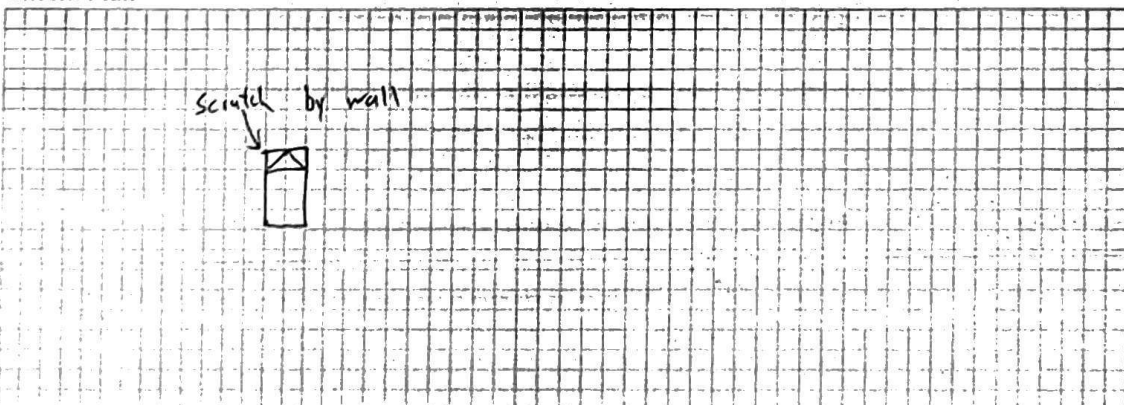

## December 10th 1888.

The accident happened on Sunday evening on the way back home. I accidentally scratch the wall.

### Declaration

**We declare the foregoing particulars are true in every respect.**

Policyholder's Signature / Date &  
Time 1130hrs

Driver's Signature (If driver is not the policyholder) / Date & Time

Witnessed by Reporting Centre  
Personnel *Tony Fong*

