

(08/11/13) waf

ASS. REC. BY: P. AmREF: CC4/11/22000/29/Riga3

2768

**ASSIGNMENT**

From: \_\_\_\_\_

Date: \_\_\_\_\_

Estimated Cost: \_\_\_\_\_

OD / TP / WS / TP RES / OD RES / EVA / INV / MVTo Inspect Vehicle No: SMW 6973Cat Workshop m/s TRANS EUROKARSof 27A, PENJURANInsured: 111

Policy No. \_\_\_\_\_

Claims No. \_\_\_\_\_

Sum Insured: \_\_\_\_\_ Excess: \_\_\_\_\_

(Client's Record)

Make of Veh: \_\_\_\_\_

(Policy Condition)

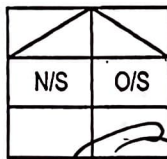
Remark: The veh had commenced its  
repair at the time of inspection.Bal. or Market Value: 120K

IDAC Accident Rpt: Consistent? : Yes or No

GIA / PR Seen: Consistent? : Yes or No

Est. Repairs: days Res.: Yes or No

Lum Sum: % 3 Val.: Yes or No

CA / REV / REP. / 24 HRS

Date: \_\_\_\_\_ Person Contacted: \_\_\_\_\_

Vehicle: IN / OUT

Date / Time Action / Instruction

REPAIR LIMIT - 67KVeh No: SMW 6973CYr Regn: 2020 / 06CType: M. Car / M. Cycle / Bus / Van / Lorry / Taxi / Prime Mover /

Truck / Trailer or

Make: MAZDA 6 SEDAN 2.0 AT c.c. 1998Colour: BLUE A/C: Insured / Std / NI / NASp. Reading: 9208 T/Radio: Insured / Std / NI / NA

Eng/No: \_\_\_\_\_

C/No: JM6GL1073LO465.846Gen. Cond: Good / Fair / Poor / BurntSteering: In order / Jammed / Leaked / Burnt orBrake: In order / Jammed / Leaked / Burnt orModi: Nil / S/Rim / STD A/Rim orTyre Size: F: 225/55R17

R: \_\_\_\_\_

BS / DUN / EXNOVA / GY / FS / LIZA / MIC / OHTSU / PIR / SUMI /

TOYO / YOKO or

Front

Rear

R/Bal. 6 mm R/Bal. 6 mmL/Bal. 6 mm L/Bal. 6 mmD.O.A. 3/12/21 D.O.I. 07/01/22Survey held at TRANS EUROKARS

Des. of Damages: Frt / Rear / O/S / N/S / U/C / Rooftop or

REAR O/S

The U/C / Chassis frame / Body Structure affected due to collision.

Date/Time, File Pass to?

☐ : Preli. Report☐ : Final Report

1)

Date/Time, File Return to?

2)

Days Of Repair: \_\_\_\_\_

Resurvey No. of Trip: \_\_\_\_\_

Survey Fee: \_\_\_\_\_

Transportation: \_\_\_\_\_

Add Fee: ☐ : Site Insp (\$ \_\_\_\_\_)☐ : Interview (\$ \_\_\_\_\_)☐ : Tech. Invs (\$ \_\_\_\_\_)☐ : Weekend (\$ \_\_\_\_\_)

) Photos

) Others

Report Format : \_\_\_\_\_

Lump Sum / I.B.I. (\$) \_\_\_\_\_



TRANS EUROKARS PTE LTD

27A TANJONG PENJURU, SINGAPORE 609042

EUROKARS SERVICES

## ESTIMATE COST OF REPAIRS

<b>INDIA INTERNATIONAL INSURANCE P/L</b>		<b>NAME :</b>		<b>WIP :</b> 44986
64 CECIL STREET		<b>ADDRESS :</b>		<b>EXCESS :</b>
#04-#05 IOB BUILDING				<b>DATE:</b> 5-Jan-22
SINGAPORE 049711		<b>TEL :</b>		
<b>ATTN. :</b> MOTOR CLAIMS				
<b>FAX :</b>				
<b>VEH NO :</b>	<b>SMW6973C</b>	<b>DATE IN :</b>	<b>CONTACT PERSON :</b>	JESS
<b>CHASSIS NO :</b>	JM6GL1073L0405846	<b>MILEAGE :</b>	<b>TYPE OF CLAIM :</b>	THIRD PARTY CLAIM
<b>MODEL :</b>	MAZDA 6	<b>DATE REG.</b>	<b>POLICY NO. :</b>	

## NATURE OF WORKS

NO	DESCRIPTION	QTY	UNIT PRICE	DISC %	1st	Supp	PARTS NO	REVISED	PRICES
1	REAR BUMPER <i>da /</i>	1	1,154.80	-	✓		MGSK2-50-221ABB		1,154.80
2	TAPE, PROTECTOR <i>new /</i>	4	4.70	-	✓		MBCKA-50-EM1		18.80
3	RETAINER S.S ULTRASONIC CENTER <i>X</i>	2	18.20	-			MKD45-67-UC5A13		36.40
4	SENSOR ULTRASONIC CENTER <i>X</i>	2	181.70	-			MGMK6-67-UC1 13		363.40
5	BRACKET CENTER REAR BUMPER <i>?</i>	1	5.40	-			MDFR5-50-251		5.40
6	REINFORCEMENT REAR <i>?</i>	1	538.30	-			MGHK1-50-260		538.30
7	TAPE SEAL <i>new /</i>	2	13.70	-	✓		MGSH7-50-2G1		27.40
8	COVER TOWING RH REAR <i>MS /</i>	1	46.60	-	✓		MGSH7-50-EK1 BB		46.60
9	REFLECTOR RH <i>X</i>	1	41.20	-			MGRF5-51-5L0A		41.20
10	RIVET <i>new /</i>	2	9.20	-	✓		MTK21-50-355		18.40
11	FASTENER <i>new /</i>	6	8.00	-	✓		MEA01-50-037		48.00
12	GASKET TAIL LAMP RH <i>new /</i>	1	46.00	-	✓		MGRF5-51-153		46.00
13	GASKET TAIL LAMP LH <i>new /</i>	1	46.00	-	✓		MGRF5-51-163		46.00

## SUPPLEMENTARY

NO	DESCRIPTION	QTY	UNIT PRICE	DISC %	1st	Supp	PARTS NO	REVISED	PRICES
1									
							<b>TOTAL PARTS</b>		2,390.70
							<b>TOTAL PARTS COST</b>		2,390.70

## Labour Description

		REVISED	PRICES
1	TO REPLACE REAR BUMPER AND REPAIR ALL AREAS AFFECTED BY THE ACCIDENTS.	660	1,320.00
2	TO RESPRAY REAR BUMPER AND ALL AREAS AFFECTED BY THE ACCIDENTS.	630	1,260.00
3	MZ-BR-REVSER TO TRANSFER REVERSE SENSORS.	330	660.00
4	MZ-BR-ELECTR TO CHECK ELECTRICAL SYSTEM FOR PROPER FUNCTIONING.	180	250.00
5	MZ-BR-REPROG TO REPROGRAMME AFTER THE ACCIDENT REPAIR WORKS.	250	300.00



MZ-BR-SUNDRI SUNDRIES.

20

50.00

**SUPPLEMENTARY LABOUR DESCRIPTION**

REVISED

PRICES

1

#N/A

REMARKS:

THIS IS ONLY AN ESTIMATE FROM VISUAL INSPECTION AND SHOULD THERE BE MORE DAMAGES FOUND DURING THE PROCESS OF REPAIRING, YOU WILL BE INFORMED BEFORE THE REPAIRS ARE BEING CARRIED OUT. TAKE NOTE THAT SHOULD YOU DECIDE NOT TO PROCEED WITH THE REPAIRS, A **QUOTATION FEE OF \$400** WILL BE APPLIED ACCORDINGLY FOR MAN-HOURS INVOLVED IN SOURCING FOR PARTS PRICE AS WELL AS LABOUR CHARGES.

TOTAL LABOUR	-	<b>3,840.00</b>
TOTAL PARTS	-	<b>2,390.70</b>
TOTAL	-	<b>6,230.70</b>
LESS EXCESS	-	-
TOTAL AFTER EXCESS	-	-
GST 7%	-	-
<b>GRAND TOTAL</b>	-	-

**TRANS EUROKARS PTE LTD**

Authorised Signature

LKK Auto Consultants hence notify the Repairer of the following:

- To resurvey before/after spray painting
- To display damaged part(s) during resurvey
- Parts prices are subject to confirmation
- Third party survey is on a "Without Prejudice" basis
- No illegal modification(s) is allowed
- Supplementary item(s) must be resurveyed and is subject to final approval from Insurance Company

Acknowledged by Repairer

Signature:

Date:

Repair  
4p 9000068  
3 days  
01/01/22 @ 1000  
Reg before paint

# SINGAPORE ACCIDENT STATEMENT

## IMPORTANT NOTICE

1. Please report correctly the details of the accident to speed up the claims process.
2. This Form must be completed by the Policyholder and/or the Authorised Driver
3. Information provided must be as truthful and accurate as possible. Any wilful misrepresentation or withholding of material facts may allow insurance companies to repudiate policy liability.
4. The issue and acceptance of this Form by insurance companies is not an admission of policy liability on the part of the insurance companies.
5. Any false reporting may be referred to the Police for investigation.
6. This report will be forwarded by the insurers of the GIA Records Management Centre established by the General Insurance Association of Singapore (GIA) for archiving and that copies of this report will, for a fee, be made available upon application by interested parties.
7. By the lodgement of this report to the insurers, you hereby consent to the archiving of this report at the centre and to copies of the report being made available aforesaid.

## ACCIDENT STATEMENT

Date of Submission	03/01/2022 18:33 (SGT)
Date of Accident	31/12/2021 09:25 (SGT)
Exact Location of Accident	Singapore
Additional Location Information	FROM CTE TWDS JLN BT. MERAH
Country/State of Loss	Singapore

## DETAILS OF OWN VEHICLE

Vehicle Registration Number	SMW6973C
-----------------------------	----------

### INSURED/POLICYHOLDER

Is company?	No
Name Of Registered Owner	TAN CHIN WEE GODWIN
NRIC No	S8703276J
Email Address	godwin.tan@gmail.com
Mobile Phone No	(Phone) +65-97364527
Alternative Phone No	+65-97364527

### VEHICLE PARTICULARS

Manufacturer	Mazda
Model	MAZDA6 SEDAN 2.0 AT STANDARD I4
Variant	-
Exact purpose for which vehicle was being used at time of accident	Private use
Are you claiming under your own insurance policy for repair to your vehicle?	No - Claiming third party
Vehicle Category	Private car
Transmission	Auto
CC	1998

### INSURANCE COMPANY

Name of Insurance Company	Allianz Insurance Singapore Pte. Ltd.
Type of Coverage	Comprehensive
Fleet Policy	No
Policy Number	SP2000616456
Cover Note Number	01/12/21 - 30/11/22

### DRIVER

Name of Driver	TAN CHIN WEE GODWIN
NRIC No	S8703276J

Date Of Birth	11/02/1987
Occupation	Indoor
Date Of Driving Pass	07/04/2006
Driving experience	15 YEARS AND 8 MONTHS
Gender	Male
Mobile Number	(Phone) +65-97364527
Alt. Phone Number	+65-97364527
Email Address	godwin.tan@gmail.com
Address	200 CANBERRA DRIVE #07-64
Address complement	-
Postcode	767962
Is the driver the policyholder?	Yes
If No, Relationship of the Driver with the Insured	-
Does Driver Own Other Vehicles?	No
Vehicle Registration Number of Other Vehicle Owned by Driver	-
Insurance Company of Other Vehicle Owned by Driver	-

#### GENERAL INFORMATION OF THE ACCIDENT

Type of Accident	Collision - Head to Rear
Weather Conditions	Drizzling
Road Surface	Wet

#### OTHER INFORMATION

Was any foreign vehicle involved in the accident?	No
Number of vehicles involved in the accident	2
Was anybody injured in the Accident?	No
Was any injured conveyed to hospital by ambulance?	-
Was any other vehicle or property damaged?	Yes
Number of Passengers (Including Driver)	2
Has the driver been approached by unknown person(s) soliciting/offering accident claims assistance?	No

#### PASSENGER 1

Name	WIFE
Gender	Female

#### DETAILS OF POLICE ACTION

Was the accident reported to the police?	No
Was notice of intended Prosecution given?	No
If yes, against whom?	-

#### CIRCUMSTANCES OF ACCIDENT

REFER TO SKETCH ATTACHED. \*THIRD PARTY CLAIM BY AGENT\*

#### ATTACHMENT(S)

Are accident photos available for attachment?	Yes
Was there any video captured by Car Camera?	Yes
Was there any audio recorded?	No

#### DETAILS OF OTHER VEHICLE PROPERTY 1

Vehicle Registration Number	GX7505E
Vehicle Manufacturer	-
Vehicle Model	-
Vehicle Variant	-
Vehicle Colour	-
Vehicle Category	Commercial vehicle



Name of Driver

Policy No

Contact Number

Address

Address complement

Postcode

Insurance Company Name

Nature Of Damage

Details of property damaged in accident

No. Of Passenger (Including Driver)

LUI SEW KHONG

S2633373C

(Phone) +65-90212535

-  
-  
-  
-  
-  
-  
-

SKETCH PLAN

IMPORTANT NOTICE

1 VEHICLE NO SMW 6973C

2 INSURER CO Allianz

3 ACCIDENT  
DATE & TIME: 31/12/21 @ 9:25am

- 1 Please report correctly the details of the accident to speed up the claims process
- 2 This Form must be completed by the Policyholder and/or the Authorised Driver
- 3 Information provided must be as truthful and accurate as possible. Any willful misrepresentation or withholding of material facts may allow insurance companies to repudiate policy liability
- 4 The issue and acceptance of this Form by insurance companies is not an admission of policy liability on the part of the insurance companies.
- 5 Any false reporting may be referred to the Police for investigation
- 6 The report will be forwarded by the insurers of the GIA Records Management Centre established by the General Insurance Association of Singapore (GIA) for archiving and that copies of this report will for a fee be made available upon application by interested parties
7. By the lodgement of this report to the insurers, you hereby consent to the archiving of this report at the centre and to copies of the report being made available aforesaid

**8 Consent under the Personal Data Protection Act (PDPA)**

I understand, acknowledge, agree and consent that:

(a) My insurer, my workshop and the General Insurance Association of Singapore ("GIA") may/are permitted to collect, use, disclose and/or process my personal data/personal information set out in this [form] and any other personal information provided by me or possessed by my insurer (collectively the "Personal Information") and disclose and transfer such Personal Information to all insurer(s) who have insured vehicle(s) involved in this accident (all insurer(s) who have insured vehicle(s) involved in this accident shall be collectively referred to as the "Insurers"), the Insurers' lawyers/law firms, the Monetary Authority of Singapore and any relevant government agency/authority (such as the police), for the purpose(s) of:

(i) processing, handling and/or dealing with my claims including the settlement of the claims and any necessary investigations relating to the claims;

(ii) investigating the accident and/or my claims;

(iii) carrying out and/or dealing with my instructions or responding to any enquiries by me;

(iv) administering my claims (including the mailing of correspondence, statements, invoices, reports or notices to me, which could involve disclosure of certain personal data about me to bring about delivery of the same as well as on the external cover of envelopes/mail packages); and/or

(v) complying with applicable law in administering, processing, handling and/or dealing with my claims (collectively the "Purposes")

(b) all insurer(s) who have insured vehicle(s) involved in this accident and the Insurers' lawyers/law firms, may/are permitted to collect, use, disclose and/or process my Personal Information for one or more of the above Purposes; and

(c) my Personal Information may/can be disclosed by any of the Insurers and/or GIA to their third party service providers or agents (including their lawyers/law firms), which may be sited outside of Singapore, for one or more of the above Purposes.

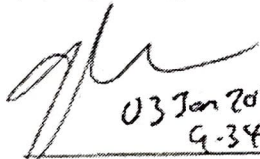
  
03 Jan 2022  
9:34

Policyholder's Signature / Date & Time

Driver's Signature (If driver is not the policyholder) / Date & Time

Witnessed by Reporting Centre Personnel

(45)

**Sketch Plan**

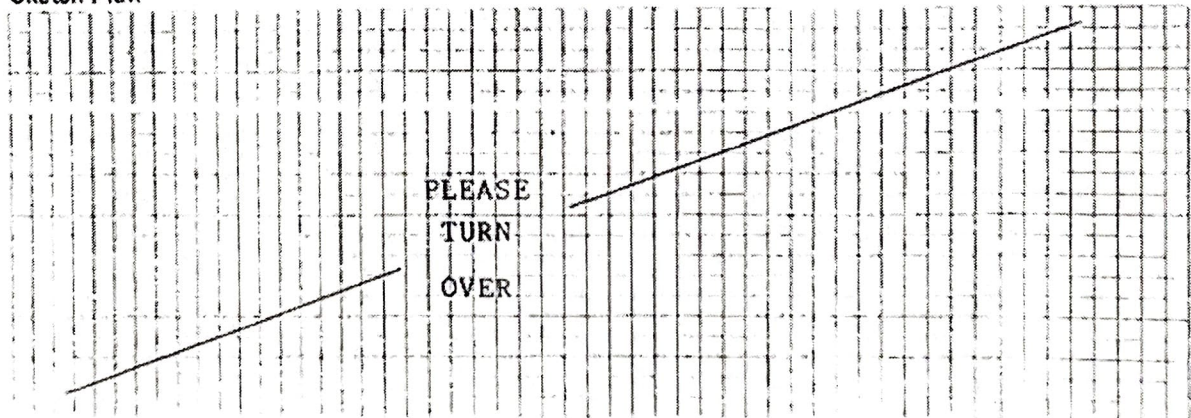

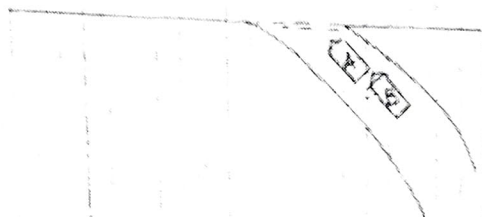
Jln Bt Merah  
←

from LTE

A: SMW 6973C

B: GX7505E

Lui Seng Khong

C: 633373C

HP-90212535

## DESCRIBE CIRCUMSTANCES OF THE ACCIDENT

I was exiting LTE to enter Jalan Bukit Merah At the left filter lane (for 1 lane) (1 vehicle lane), I stopped at the give way line as there was oncoming traffic at the main road (Jalan Bukit Merah). At about 9.25am, the Van hit the back of my car, when I was still stationary. There was no injury. I've confirmed with the van driver as well.

Note: Please note that your insurer may have 14days Time Frame for you to submit an Own Damage Claim under your own comprehensive policy. Please check with your policy for more information.

## DECLARATION

I/We declare the foregoing particulars are true in every respect.

Policyholder's Signature  
Date & Time:

03 Jan 2022  
9.34

Driver's Signature  
(If driver is not the policyholder)  
Date & Time:

( ) Claim Own Policy ( ) Claim Third Party ( ) Reporting Only  
(x) Claim OD/TP at other workshop (by Agent)

Reporting Centre Personnel's Signature  
Name:  
NRIC/FIN No:

3/1/22  
(45)



> Back to OneMotoring

### Enquire PARF/COE Rebate for Registered Vehicle

Owner ID Type:	Singapore NRIC
Owner ID:	276J
Vehicle No.:	SMW6973C
Vehicle to be Exported:	No
Intended Deregistration Date:	08 Jan 2022
Vehicle Make:	MAZDA
Vehicle Model:	MAZDA6 SEDAN 2.0 AT STANDARD I4
Primary Colour:	Blue
Manufacturing Year:	2019
Engine No.:	PE21355396
Chassis No.:	JM6GL1073L0405846
Maximum Power Output:	121.0kW (162 bhp)
Open Market Value:	\$21,194.00
Original Registration Date:	01 Dec 2020
First Registration Date:	01 Dec 2020
Transfer Count:	0
Actual ARF Paid:	\$21,672.00
PARF Eligibility:	Yes
PARF Eligibility Expiry Date:	30 Nov 2030
PARF Rebate Amount:	\$16,254.00
COE Expiry Date:	30 Nov 2030
COE Category:	B - Car above 1600cc or 97kW (130bhp)
COE Period(Years):	10
QP Paid:	\$41,101.00
COE Rebate Amount:	\$36,557.00
Total Rebate Amount:	\$52,811.00

The information contained herein is correct as at 08 Jan 2022

OK



# Mazda 6 2.0A

Overview

Financial

Accessories

Similar

Research

Photos

Map

Price **\$118,000**

Depreciation ⓘ \$12,260 /yr  
[View models with similar depre](#)

Reg Date 08-Oct-2020  
(8yrs 8mths 29days COE left)

Mileage 13,706 km (10.9k /yr)

Manufactured ⓘ 2019

Road Tax ⓘ \$1,210 /yr

Transmission Auto

Dereg Value ⓘ \$51,905 as of today ([change](#))

OMV ⓘ \$20,987

COE ⓘ \$40,989

ARF ⓘ \$21,382

Engine Cap 1,998 cc

Power 121.0 kW (162 bhp)

Curb Weight ⓘ 1,514 kg

No. of Owners ⓘ 1

Type of Vehicle [Luxury Sedan](#)