

ASS. REC. BY: TGum

REF:

23/MSG24013336/Bgf3Shiau Chan

## ASSIGNMENT

From:

Date: 31/12/2021

Estimated Cost:

OD / ☒ TP / WS / TP RES / OD RES / EVA / INV / MVTo Inspect Vehicle No: SMK 7567Zat Workshop m/s Bifrost Auto

of

Insured:

Policy No.

Claims No.

Sum Insured: Excess:

(Client's Record)

Make of Veh:

(Policy Condition)

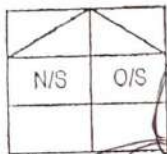
Remark: The veh had commenced its  
repair at the time of inspection.Bal. or Market Value: 57,000/-

IDAC Accident Rpt: Consistent? : Yes or No

GIA / PR Seen: Consistent? : Yes or No

Est. Repairs: 9 days Res.: Yes or No

Lum Sum: % 3 Val.: Yes or No

CA / REV / REP. / 24 HRS

Vehicle: IN / OUT

Date: Person Contacted:

Veh No: SMK 7567Z Yr Regn: 23/4/2019Type: ☒ Car / M.Cycle / Bus / Van / Lorry / Taxi / Prime Mover /

Truck / Trailer or

Make: Mitsubishi Attrage 1.2 C.C. 1193Colour: Silver NC: Insured / Std / NI / NASp. Reading: 213031 T/Radio: Insured / Std / NI / NAEng/No: 3A92UHN 8093C/No: NMBTA13AH00105Gen. Cond: Good / ☒ Fair / Poor / BurntSteering: ☒ In order / Jammed / Leaked / Burnt orBrake: ☒ In order / Jammed / Leaked / Burnt orModi: Nil / ☒ SRM / STD A/Rim orTyre Size: F: 185/55/15R: 185/55/15☒ DUN / EXNOVA / GY / FS / LIZA / MIC / OHTSU / PIR / SUMI /

TOYO / YOKO or

Front

Rear

R/Bal. 5 mmR/Bal. 5 mmL/Bal. 5 mmL/Bal. 5 mmD.O.A. 30/12/2021D.O.I. 31/12/2021Survey held at Bifrost AutoDes. of Damages: Frt / ☒ Rear / ☒ O/S / N/S / U/C / Rooftop or

The U/C / Chassis frame / Body Structure affected due to collision.

Date / Time	Action / Instruction
	Range <u>4,000/- - 5,000/-</u>
	Recommended COR is LS \$ <u>4,450.00</u> TGum <u>7/2/2022</u>
	MV <u>57,000/-</u>
	PV <u>22,991/-</u>
	NV <u>34,009/-</u> TGum <u>4/1/2022</u>

Date/Time, File Pass to?

☐ : Prel. Report

1)

☐ : Final Report

Date/Time, File Return to?

2)

Report Format:

Lump Sum / L&amp;L: ( )

Days Of Repair:

Resurvey No. of Trip:

Add Fee:

☐ Site Insp (\$ 1)  
☐ Interview (\$ )  
☐ Tech. Invs (\$ )  
☐ Weekend (\$ )

Survey Fee:

Transportation:

S + RS \$

Photos

Office

TOTAL

**BIFROST AUTO PTE LTD**

8 KAKI BUKIT AVE 4, PREMIER @ KAKI BUKIT #01-49 SINGAPORE 415875

Tel: +65 64524457

Fax: +65 64524584

Company Reg No: 201929175W

Estimate

Vehicle No: SMK7567Z  
 Make and model: Mitsubishi Attarge  
 Chassis: MMBSTA13AKH001065

Qty Spare partsList price

2019

- 1 Rear bumper
- 1 Rear bumper RH side retainer
- 1 Rear bumper LH side retainer
- 1 RH taillamp assy
- 1 RH rear fender
- 1 RH rear fender inner trim
- 1 RH rear fender splash shield
- 1 RH rear door
- 1 RH rear door frame black tape
- 1 RH rear door lock
- 1 RH rear door weatherstrip
- 1 RH rear door inner trim board
- 1 RH rear sport rim
- 1 RH rear wheel bearing
- 1 RH rear shock absorber
- 1 Rear axle beam

S	659.00	745.00	BRV
S		✓28.00	NECV
S		✓28.00	NECV
S		332.00	? NDX
S	725.00	826.00	DDV
S		178.00	? NDX
S		48.00	NDX
S		✓848.00	DB ✓
S		✓23.00	NECV
S		192.00	NDX
S		157.00	NDX
S		312.00	? NDX
S	450.00	708.00	cut ✓
S		231.00	NDX
S		178.00	NDX
S		833.00	NDX

S	5,667.00
-10% S	566.70
S	5,100.30

Qty Spare partsSpecial Nett price

- 1set Rear bumper clips
- 1 Rear windscreen glass sealant
- 1 Rear windscreen glass inner seal
- 1set RH rear fender inner trim clips
- 1set RH rear fender splash shield clips
- 1 RH rear fender joint sealant
- 1 RH rear tyre
- 1 Brake fluid
- 1set RH rear door inner trim board clips

S	30.00	70.00	NECV
S	40.00	70.00	NECV
S	30.00	50.00	NECV
S	30.00	60.00	NECV
S		40.00	NNX
S	30.00	70.00	NECV
S		350.00	NDX
S		60.00	NNX
S	30.00	60.00	NECV

Labour and painting

Labour charges to remove, check, replace and reinstall damages bodyparts.  
 To panel beating, cut / weld and re-align all affected panels

S	1,000.00	1,200.00
---	----------	----------

SC  
30/12/21

BIFROST AUTO PTE LTD  
8 KAKI BUKIT AVE 4, PREMIER @ KAKI BUKIT #01-49 SINGAPORE 415875  
Tel: +65 64524457  
Fax: +65 64524584  
Company Reg No: 201929175W

# Supplementary

Vehicle No: SMK7567Z  
Model and make: Mitsubishi Attrage

Qty	Parts		List price	2019
1	RH front door	\$	✓ 845.00	DD ✓
1	RH front door frame black tape	\$	✓ 26.00	NE ✓
		\$	✓ 871.00	
		-10% \$	✓ 87.10	
		\$	✓ 783.90	
	Labour	\$	250.00	WNT
	Spray painting	\$	250.00	
	Remove and reinstall RH front door inner mechanism to new door	\$	80.00	-100.00
Total:		\$	863.90	1,383.90

Resurvey  
5/1/2022  
T. Lim

**LKK Auto Consultants** hence notify  
the Repairer of the following:

- To resurvey before/after spray painting
- To display damaged part(s) during resurvey
- Parts prices are subject to confirmation
- Third party survey is on a "Without Prejudice" basis
- No illegal modification(s) is allowed
- Supplementary item(s) must be resurveyed and is subject to final approval from Insurance Company

Acknowledged by Repairer

Signature:

Date:



Spray painting on affected panels	\$ 800.00	1,200.00 ✓
Check wiring and lighting system	\$	<del>80.00</del> } NNX
Apply rust coating chemical on affected panels	\$	<del>100.00</del> }
Remove and reinstall rear windscreen glass to assist repair	\$ 120.00	<del>220.00</del> ✓
Remove and replace RH rear door inner mechanism to assist repair	\$ 80.00	<del>180.00</del> ✓
Remove and replace rear undercarriage parts to assist repair	\$	<del>450.00</del> } ? NNX
Test drive and adjust wheel alignment system to assist repair	\$	<del>120.00</del> }
Remove and reinstall roof lining, seats, seat belts and carpet to assist repair	\$	<del>380.00</del> NNX

Total: \$ 9,860.30

Survey & Resurvey

31/12/2021

Time in

1340 hrs

Lump sum repair

Repair days 9

Parts	3268.80
SN	190.00
Labour	2080.00
	<u>5538.80</u>
@ 2070	<u>1107.76</u>
	4431.04

LS 4450/2

**LKK Auto Consultants** hence notify the Repairer of the following:

- To resurvey before/after spray painting
- To display damaged part(s) during resurvey
- Parts prices are subject to confirmation
- Third party survey is on a "Without Prejudice" basis
- No illegal modification(s) is allowed
- Supplementary item(s) must be resurveyed and is subject to final approval from Insurance Company

Acknowledged by Repairer  
Signature:  
Date:

> Back to OneMotoring

## Enquire PARF/COE Rebate for Registered Vehicle

Vehicle Owner Particulars	
Owner ID Type:	Foreign Identification Number
Owner ID:	813X
Vehicle Details	
Vehicle No.:	SMK7567Z
Vehicle to be Exported:	Yes
Intended Deregistration Date:	30 Dec 2021
Vehicle Make:	MITSUBISHI
Vehicle Model:	ATTRAGE 1.2 CVT
Primary Colour:	Silver
Manufacturing Year:	2018
Engine No.:	3A92UHN8093
Chassis No.:	MMBSTA13AKH001065
Maximum Power Output:	59.0 kW (79 bhp)
Open Market Value:	\$13,554.00
Original Registration Date:	23 Apr 2019
First Registration Date:	23 Apr 2019
Transfer Count:	1
Actual ARF Paid:	\$5,000.00
Intended PARF Rebate Details	
PARF Eligibility:	Yes
PARF Eligibility Expiry Date:	22 Apr 2029
PARF Rebate Amount:	\$3,750.00
Intended COE Rebate Details	
COE Expiry Date:	22 Apr 2029
COE Category:	A - Car up to 1600cc & 97kW (130bhp)
COE Period(Years):	10
QP Paid:	\$26,309.00
COE Rebate Amount:	\$19,241.00
<b>Total Rebate Amount:</b>	<b>\$22,991.00</b>

The information contained herein is correct as at 30 Dec 2021

OK

MV 57,000/-  
PV 22,991/-  
NV 34,009/-

Tayin Min  
4/1/2022



Posted: 30-Dec-2021 Tags: 2019 Mitsubishi Attrage, Mitsubishi Attrage, Mitsubishi, Attrage



**Mitsubishi Attrage 1.2A** **\$59,800** **\$7,790 /yr** **13-May-2019** **1,193 cc** **19,000 km** **Sedan** **Available**

100% Loan Approval, Sports Model With Body Kit And Leather Seat, \$600 Monthly Installment, \$6K Yearly Depreciation, New Paintwork, New Rims, Excellent Maintained Condition, No Repairs Needed, Call For A No Obligation Door Step Viewing And Test Drive, Flexible Loan...

PREMIUM AD

✓ This car comes with 12-mth sgCarMart Warranty - the best protection for your car. Learn More

Posted: 16-Dec-2021 Tags: 2019 Mitsubishi Attrage, Mitsubishi Attrage, Mitsubishi, Attrage



**Mitsubishi Attrage 1.2A** **\$64,800** **\$8,160 /yr** **22-Aug-2019** **1,193 cc** **21,000 km** **Sedan** **Available**

Buy With Confidence With Inchcape Certified Preowned Selection, 145 Points Certification, Approved Service History, 12 Months/20,000km Mileage Warranty, Complimentary Servicing Inclusive.

Borneo Motors (S)

Posted: 30-Dec-2021 Tags: 2019 Mitsubishi Attrage, Mitsubishi Attrage, Mitsubishi, Attrage



**Mitsubishi Attrage 1.2A Sports** **\$63,800** **\$7,930 /yr** **25-Sep-2019** **1,193 cc** **28,000 km** **Sedan** **Available**

Posted: 27-Dec-2021 Tags: 2019 Mitsubishi Attrage, Mitsubishi Attrage, Mitsubishi, Attrage



Get an instant OCBC Car Loan at 1.88% p.a.

OCBC Car Loan. Now redefined. Apply online with MyInfo before you shop for a car so you can buy with confidence! T&Cs apply.

Find out more!



**Mitsubishi Attrage 1.2A Sports** **\$64,800** **\$8,000 /yr** **18-Oct-2019** **1,193 cc** **33,113 km** **Sedan** **Available**

1 Owner Unit. Vehicle Fully Maintained By Agent C&C Since Day 1 And Come With 5 Years Warranty. Engine Warranty 10 Years. Well Known For Its Reliability, Exceptional Fuel Efficiency, Excellent Length, Comfortable Interior Space And Come With Enormous Boot Space...

PREMIUM AD

✓ This car comes with 6-mth sgCarMart Warranty - the best protection for your car. Learn More

Mayfair Motoring

Posted: 03-Jan-2022 Tags: 2019 Mitsubishi Attrage, Mitsubishi Attrage, Mitsubishi, Attrage

Save this search criteria, to get email alerts whenever a match is found.

Make Model Price Depreciation Reg Date Eng Cap Mileage Veh Type Status

For old advertisements, view Expired ads

20 results/page

[Home](#) | [New Cars](#) | [Used Cars](#) | [Rental Cars](#) | [Sell My Car](#) | [Directory](#) | [Products](#) | [Insurance](#) | [Article](#) | [Forum](#) | [Resources](#)

sgCarMart is the number one car classifieds for parallel import cars, Toyota, Honda, Nissan, Mitsubishi & BMW. There are plenty of cars for sale, from vans, trucks, sedan cars, luxury cars, sports cars or stationwagons, SUV, MPV, hatchback, to COE cars & OPC cars. You can also buy from a car auction, look up car loans, financial services, low mileage cars, car brands, carpark rates & car insurance. Find buy used Mitsubishi, Mitsubishi Singapore, used Mitsubishi Singapore, used Mitsubishi, used vehicles Singapore or even buy used Mitsubishi Singapore. We have new car dealers comprising parallel importers, authorised car dealers, and used car dealers on our site. Find new car price lists, new car launches and new car promotions. Visit our partner sites for job openings for Singapore jobs, real estate, mover, car performance parts, car discussion, forum discussion, commercial vehicle leasing & COE results.

All prices and other information displayed on sgCarMart.com are gathered from sources and based on algorithms that are believed by sgCarMart.com to be reliable, but no assurance can be given that this information is accurate, complete or current. sgCarMart.com does not assume any responsibility for errors or omissions or warrant the accuracy of this information.

Follow [sgCarMart.com](#)

[About Us](#) | [Careers](#) | [Contact Us](#) | [Sitemap](#) | [Terms of Service](#) | [Privacy Policy](#) | [Personal Data Protection Statement](#)

©2004-2022 sgCarMart, Singapore. All rights reserved.

VEHICLE NO: SMC 75672		MAKE & MODEL: MIT ATTRAAGE.		AUTO / MANUAL	
DATE OF ACCIDENT		30 / 12 / 21.		C.C.	
TIME OF ACCIDENT		0128		AM / PM	
LOCATION OF ACCIDENT		BOON LAM LAM X JOHNG LEFT ST 51.			
EXACT PURPOSE USED AT TIME OF ACCIDENT		EMPLOYMENT / PRIVATE USE / PRIVATE HIRE			
NAME OF OWNER		CARMEN LIG			
EMAIL:		Scotthhere123@gmail.com		Office: MOBILE 8223 2276.	
NRIC		60767813X.			
CLAIM TYPE		OD / THIRD PARTY / REPORTING ONLY			
FLEET POLICY:		YES / NO?			
INSURANCE CO.		NTUC.			
TYPE OF COVERAGE		Comprehensive / Third Party / Third Party Fire & Theft			
POLICY NO.		5119333028			
NAME OF DRIVER		AS ABOVE / IF NO. TAN JIA NI, JERLYN (CHEN JIANI).			
NRIC		59814131P).			
DATE OF BIRTH		29 / 09 / 98.			
ANY PASSENGER		YES / NO: 4			
NAME OF PASSENGER		1x MALE, 3x FEMALE (UNKNOWN).			
GENDER OF PASSENGER		MALE / FEMALE			
OCCUPATION		Outdoor / Indoor			
DATE OF DRIVING PASS		09 / 07 / 19.			
GENDER		Male / Female			
CONTACT NO.		Mobile: 97617219		Office: Home:	
EMAIL:					
ADDRESS		31 JALAN MENARONG. S(577938).			
DOES DRIVER OWN OTHER VEHICLES?		NO / If yes: Reg No.		INSURER: -	
RELATIONSHIP		Employee / If No: FRIEND			
WEATHER CONDITION		Clear / Raining / Other:			
ROAD SURFACE		Dry / Wet / Other:			
ANY INJURIES		NO / If yes: Who?			
CONTACT NO.					
POLICE REPORT		No / If yes: Where?			
NOTICE OF INTENDED PROSECUTION GIVEN?		NO / IF YES: WHO?			
VEHICLE B NO.		SLK 35372.		Any Passenger:	
NAME					
CONTACT NO.					
VEHICLE C NO.		Any Passenger:			
VEHICLE D NO.		Any Passenger:			
VEHICLE E NO.		Any Passenger:			
VEHICLE F NO.		Any Passenger:			
ANY WITNESS					
WITNESS CONTACT NO.					
WAS THERE ANY VIDEO CAPTURE?		YES / NO			
WAS THERE ANY AUDIO RECORDED?		YES / NO			
SCENE ACCIDENT PHOTOS TAKEN?		YES / NO			



## SKETCH PLAN

### IMPORTANT NOTICE

1. Please report **correctly** the details of the accident to speed up the claims process.
2. This Form must be **completed by the Policyholder and/or the Authorised Driver**.
3. Information provided must be as **truthful and accurate as possible**. Any wilful misrepresentation or withholding of material facts may allow insurance companies to **repudiate policy liability**.
4. The issue and acceptance of this Form by insurance companies is not an admission of policy liability on the part of the Insurance companies.
5. **Any false reporting may be referred to the Police for investigation.**
6. The report will be forwarded by the insurers of the GIA Records Management Centre established by the General Insurance Association of Singapore (GIA) for archiving and that copies of this report will for a fee be made available upon application by interested parties.
7. By the lodgement of this report to the insurers, you hereby consent to the archiving of this report at the centre and to copies of the report being made available aforesaid.
8. **Consent under the Personal Data Protection Act (PDPA)**

I understand, acknowledge, agree and consent that :

(a) My insurer, my workshop and the General Insurance Association of Singapore ("GIA") may/are permitted to collect, use, disclose and/or process my personal data/personal information set out in this [form] and any other personal information provided by me or possessed by my insurer (collectively the "Personal Information") and disclose and transfer such Personal Information to all insurer(s) who have insured vehicle(s) involved in this accident (all insurer(s) who have insured vehicle(s) involved in this accident shall be collectively referred to as the "Insurers"), the Insurers' lawyers/law firms, the Monetary Authority of Singapore and any relevant government agency/authority (such as the police), for the purpose(s) of :

(i) processing, handling and/or dealing with my claims including the settlement of the claims and any necessary investigations relating to the claims;

(ii) investigating the accident and/or my claims;

(iii) carrying out and/or dealing with my instructions or responding to any enquiries by me;

(iv) administering my claims (including the mailing of correspondence, statements, invoices, reports or notices to me, which could involve disclosure of certain personal data about me to bring about delivery of the same as well as on the external cover of envelopes/mail packages); and/or

(v) complying with applicable law in administering, processing, handling and/or dealing with my claims.

(collectively the "Purposes")

(b) all insurer(s) who have insured vehicle(s) involved in this accident and the Insurers' lawyers/law firms, may/are permitted to collect, use, disclose and/or process my Personal Information for one or more of the above Purposes; and

(c) my Personal Information may/can be disclosed by any of the Insurers and/or GIA to their third party service providers or agents (including their lawyers/law firms), which may be sited outside of Singapore, for one or more of the above Purposes.

Policyholder's Signature / Date & Time

Driver's Signature (If driver is not the policyholder) / Date & Time

Witnessed by Reporting Centre Personnel

### Sketch Plan

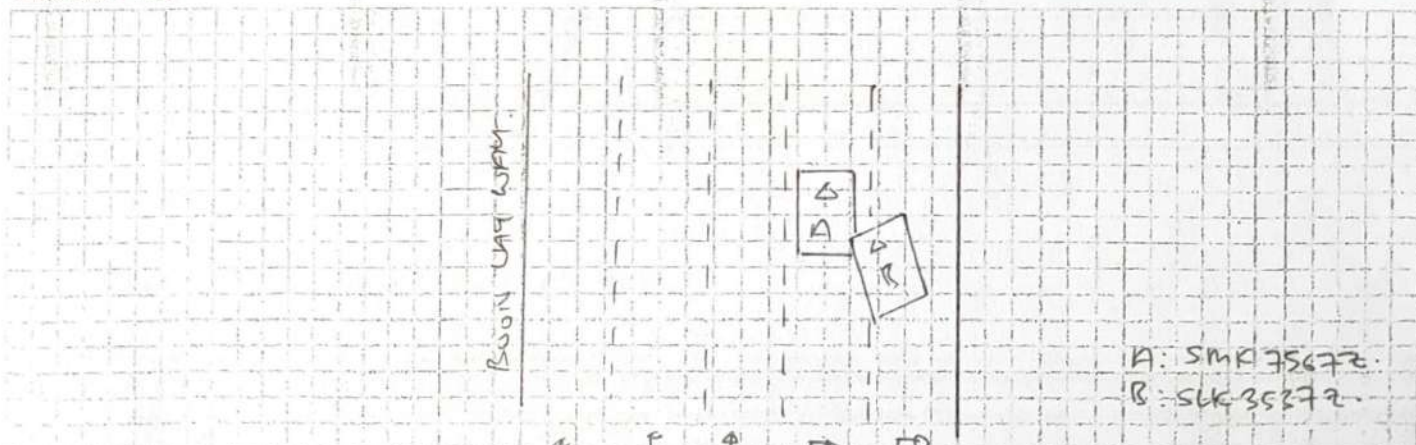



**Describe Circumstances of the Accident**

ON THE STATED DATE AND TIME, I WAS TRAVELLING STRAIGHT  
NEARING THE JUNCTION OF BOON LAY WAY AND JURONG WEST ST ST.  
I WAS ON THE SECOND LANE FROM THE RIGHT TURNING RIGHT  
TO JURONG WEST ST ST.  
OUT OF A Sudden, VEH B CAME OUT AND MADE AN ABRUPT  
LANE CHANGE INTO MY LANE AND HIT ON THE RIGHT PORTION  
OF MY VEHICLE.

**Declaration**

We declare the foregoing particulars are true in every respect.



