

SM821C70001

28/12/2021 11:51  
N28/CT2210/3267/Y  
SCR 2052L  
28/12/2021 15:25  
TP

Incident Description: SASE filing  
E-mail: [blank]  
E-Motor Claim Form  
E-Motor WFO [blank]  
E-Photo Uploaded  
Assessment/Survey Report  
Ass't Report by Fax/Hand to Owner/Whse

Preferred Wksp / INC Assign Wksp / QW: ( ) Tel: ( ) Fax: ( )

TP Particulars: Vch No: GBK 9958X INC ( ) Non-INC ( )  
Owner / Driver: ( ) Tel: ( )  
Policy No: ( ) Period: ( ) Cover Type: ( )  
Confirmed by: ( ) Date: ( ) Time: ( )  
Insured/Driver Liability: ( ) (Note: Est Status (W/O) N: 0-20% P: 21-79 F: 80-100%)  
Year of Registration: ( ) Warranty YES ( ) / NO ( )  
Excess: (\$ ) Loading: \$1,000 ( ) / \$2,000 ( )

General Remarks:-  
( ) Walk-In Customer: Customer's information strictly Confidential & Strictly NO later or repairs  
( ) Total Loss Case: to e-mail Insurer URGENTLY.  
Drive-In ( ) / Towel-In ( ) ; Invoice YES ( ) / NO ( ) ; Towing Co ( )  
Remarks:- (INC hotline: 6788 6616)  
1) Apply for Transport Allowance ( ) / Courtesy Car ( )  
2) QC Check / Post Repair Inspection ( )  
3) Upload Resurvey Photo (Repair Cost > \$3000) ( )

Injury: ( )  
Date/Time Actions

Claimant's Particulars :-  
Driver/Owner:  
Contact No:  
Damaged Portion:  
QC Checked by (Engr-In-Charge):  
Auditors' Comments :-  
Cat 1:  
Cat 2,3:

Invoice Preparation Checklist		Am (\$)	Am (\$)
		Inc/Full	Acc/Full
1) AK: Accident Reporting	(\$40)		
2) DA: Damage Assessment	(\$100)	INC (\$30)	
3) TF: Towing Fee		\$40.845	
4) FT: Follow-Through Survey		\$120	
5) FT: Follow-Through Survey (Resurvey)		\$120	
For claimant record (24 Hrs) (w/ C) (on Jan 3, 2022)			
6) FR: Re-inspection		\$180	
7) N1: Basic DA - SMRT Survey		\$180	
8) N2: Additional Services			
Q12:			
* N5: Courtesy Car / Transport Allowance			
* N6: Repairer's Location			
* N7: Post Repair Inspection			
* N8: DV / Collect Excess Coordination			
* N9: Final Bill / Final Invoice			
* N12: Final Bill			
Invoice dated			
Invoice created			

## SINGAPORE ACCIDENT STATEMENT

### IMPORTANT NOTICE

1. Please report correctly the details of the accident to speed up the claims process.
2. This Form must be completed by the Policyholder and/or the Authorised Driver
3. Information provided must be as truthful and accurate as possible. Any wilful misrepresentation or withholding of material facts may allow insurance companies to repudiate policy liability.
4. The issue and acceptance of this Form by insurance companies is not an admission of policy liability on the part of the insurance companies.
5. Any false reporting may be referred to the Police for investigation.
6. This report will be forwarded by the insurers of the GIA Records Management Centre established by the General Insurance Association of Singapore (GIA) for archiving and that copies of this report will, for a fee, be made available upon application by interested parties.
7. By the lodgement of this report to the insurers, you hereby consent to the archiving of this report at the centre and to copies of the report being made available aforesaid.

### ACCIDENT STATEMENT

Date of Submission	29/12/2021 11:51 (SGT)
Date of Accident	28/12/2021 15:25 (SGT)
Exact Location of Accident	Petir Rd, Singapore
Additional Location Information	BETWEEN BLK 214 AND BLK 216
Country/State of Loss	Singapore

### DETAILS OF OWN VEHICLE

Vehicle Registration Number	SKR2052L
-----------------------------	----------

#### INSURED/POLICYHOLDER

Is company?	No
Name Of Registered Owner	RAMLE BIN ISMAIL
NRIC No	SXXXX980B
Email Address	hancarrepairs@gmail.com
Mobile Phone No	(Phone) +65-88165420
Alternative Phone No	+65-88165420

#### VEHICLE PARTICULARS

Manufacturer	Toyota
Model	Prius
Variant	-
Exact purpose for which vehicle was being used at time of accident	Employment
Are you claiming under your own insurance policy for repair to your vehicle?	No - Claiming third party
Vehicle Category	Commercial vehicle
Transmission	Auto
CC	1497

#### INSURANCE COMPANY

Name of Insurance Company	China Taiping Insurance (Singapore) Pte. Ltd.
Type of Coverage	Comprehensive
Fleet Policy	No
Policy Number	DMHCSNW00014392100
Cover Note Number	-

#### DRIVER

Name of Driver	RAMLE BIN ISMAIL
NRIC No	SXXXX980B



Date Of Birth	15/11/1955
Occupation	Outdoor
Date Of Driving Pass	22/06/1994
Driving experience	27 YEARS AND 6 MONTHS
Gender	Male
Mobile Number	(Phone) +65-88165420
Alt. Phone Number	+65-88165420
Email Address	hancarrepairs@gmail.com
Address	BLK 37 MARSILING DRIVE #07-419
Address complement	-
Postcode	730037
Is the driver the policyholder?	Yes
If No, Relationship of the Driver with the Insured	-
Does Driver Own Other Vehicles?	No
Vehicle Registration Number of Other Vehicle Owned by Driver	-
Insurance Company of Other Vehicle Owned by Driver	-

#### GENERAL INFORMATION OF THE ACCIDENT

Type of Accident	Collision - Major/Minor Rd
Weather Conditions	Clear
Road Surface	Dry

#### OTHER INFORMATION

Was any foreign vehicle involved in the accident?	No
Number of vehicles involved in the accident	2
Was anybody injured in the Accident?	No
Was any injured conveyed to hospital by ambulance?	-
Was any other vehicle or property damaged?	Yes
Number of Passengers (Including Driver)	1
Has the driver been approached by unknown person(s) soliciting/offering accident claims assistance?	No

#### DETAILS OF POLICE ACTION

Was the accident reported to the police?	No
Was notice of intended Prosecution given?	No
If yes, against whom?	-

#### CIRCUMSTANCES OF ACCIDENT

#### PLEASE REFER TO SKETCH PLAN

#### ATTACHMENT(S)

Are accident photos available for attachment?	Yes
Was there any video captured by Car Camera?	Yes
Was there any audio recorded?	No

#### DETAILS OF OTHER VEHICLE PROPERTY 1

Vehicle Registration Number	GBK9958X
Vehicle Manufacturer	Toyota
Vehicle Model	Hiace
Vehicle Variant	-
Vehicle Colour	-
Vehicle Category	Commercial vehicle
Name of Driver	NG ZHEN CHAI, IVAN
NRIC No	SXXXX688H
Contact Number	-
Address	-

• Address complement	.....	-
Postcode	.....	-
• Insurance Company Name	.....	-
Nature Of Damage	.....	-
Details of property damaged in accident	.....	-
No. Of Passenger (Including Driver)	.....	-

## SKETCH PLAN

### IMPORTANT NOTICE

1. Please report **correctly** the details of the accident to speed up the claims process.
2. This Form must be **completed by the Policyholder and/or the Authorised Driver**.
3. Information provided must be as **truthful and accurate as possible**. Any wilful misrepresentation or withholding of material facts may allow insurance companies to **repudiate policy liability**.
4. The issue and acceptance of this Form by insurance companies is not an admission of policy liability on the part of the insurance companies.
5. **Any false reporting may be referred to the Police for investigation.**
6. The report will be forwarded by the insurers of the GIA Records Management Centre established by the General Insurance Association of Singapore (GIA) for archiving and that copies of this report will for a fee be made available upon application by interested parties.
7. By the lodgement of this report to the insurers, you hereby consent to the archiving of this report at the centre and to copies of the report being made available aforesaid.
8. **Consent under the Personal Data Protection Act (PDPA)**

I understand, acknowledge, agree and consent that :

(a) My insurer, my workshop and the General Insurance Association of Singapore ("GIA") may/are permitted to collect, use, disclose and/or process my personal data/personal information set out in this [form] and any other personal information provided by me or possessed by my insurer (collectively the "**Personal Information**") and disclose and transfer such Personal Information to all insurer(s) who have insured vehicle(s) involved in this accident (all insurer(s) who have insured vehicle(s) involved in this accident shall be collectively referred to as the "**Insurers**"), the Insurers' law yers/law firms, the Monetary Authority of Singapore and any relevant government agency/authority (such as the police), for the purpose(s) of :

- (i) processing, handling and/or dealing with my claims including the settlement of the claims and any necessary investigations relating to the claims;
- (ii) investigating the accident and/or my claims;
- (iii) carrying out and/or dealing with my instructions or responding to any enquiries by me;
- (iv) administering my claims (including the mailing of correspondence, statements, invoices, reports or notices to me, which could involve disclosure of certain personal data about me to bring about delivery of the same as well as on the external cover of envelopes/mail packages); and/or
- (v) complying with applicable law in administering, processing, handling and/or dealing with my claims.

(collectively the "**Purposes**")

(b) all insurer(s) who have insured vehicle(s) involved in this accident and the Insurers' law yers/law firms, may/are permitted to collect, use, disclose and/or process my Personal Information for one or more of the above Purposes; and

(c) my Personal Information may/can be disclosed by any of the Insurers and/or GIA to their third party service providers or agents (including their law yers/law firms), which may be sited outside of Singapore, for one or more of the above Purposes.

*PD* 1035  
29/12/21

Policyholder's Signature / Date & Time

Driver's Signature (If driver is not the policyholder) / Date & Time

*29/12/2021*  
Witnessed by Reporting Centre Personnel

### Sketch Plan

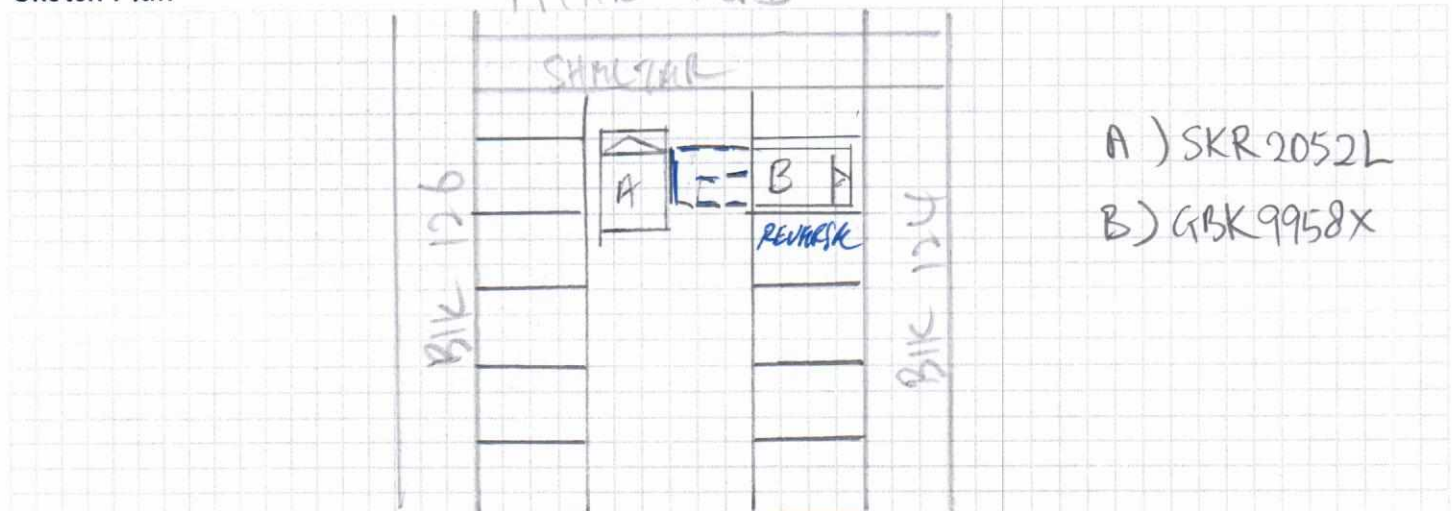



**Describe Circumstances of the Accident**

ON 28/12/2021 AT ABOUT 15:16 HRS I WAS AT BIK 126 & BIK 124  
PETIR ROAD WANTING TO FETCH MY PASSENGER AT THE SPECTAR  
NEAR BIK 124 PETIR. BEFORE I WAS ABOUT TO STOP I, SAW  
A VAN WHICH ABOUT TO REVERSE OUT FROM THE PARKING LOT  
I HORN BUT THE VAN DRIVER STILL REVERSE & BACK ONTO  
THE RIGHT SIDE DRIVER & MY RIGHT SIDE MIRROR DROP  
OUT, AFTER THE BUMP HE QUICKLY DRIVE BACK INTO THE LOT  
WHICH HE PARK JUST NOW.

**Declaration**

We declare the foregoing particulars are true in every respect.

 1035  
29/12/21

Policyholder's Signature / Date &  
Time

Driver's Signature (If driver is not the policyholder) / Date  
& Time

 29/12/2021  
Witnessed by Reporting Centre  
Personnel

## ACCIDENT STATEMENT

ACCIDENT DATE: (28 / 12 / 2021) (DD/MM/YYYY), TIME: (15 : 25) (HH:MM)

LOCATION: BTW BIK 214 & 216 PETIR ROAD

### 1. DETAILS OF VEHICLE

- a) VEHICLE NUMBER: SKR 2052L  
b) INSURANCE COMPANY: CHINA TAI PING  
c) POLICY NUMBER:  
d) POLICY TYPE: (COMPREHENSIVE / THIRD PARTY / THIRD PARTY FIRE & THEFT)  
e) MAKE & MODEL: TOYOTA PRIUS  
f) TYPE: (SALOON / COUPE / MPV / VAN / LORRY / MOTORCYCLE / OTHERS)  
g) VEHICLE CATEGORY: (PRIVATE / COMMERCIAL / MOTORCYCLE)  
h) PURPOSE OF USING AT ACCIDENT TIME: WORKING  
i) ARE YOU CLAIMING UNDER YOUR OWN INSURANCE (YES/NO)  
IF NO, PLEASE STATE (THIRD PARTY CLAIM / REPORTING ONLY)

### 2. INSURED / POLICY HOLDER

- a) NAME: RAMLIK BIN ISMAIL (MALE / FEMALE)  
b) NRIC/FIN/PASSPORT: S1268980 B CONTACT: 88165420  
c) ADDRESS:

\* CONTINUE TO 3.d IF DRIVER ALSO POLICY HOLDER

### DRIVER

- a) NAME: AS ARBOUT (MALE / FEMALE)  
b) NRIC/FIN/PASSPORT: CONTACT:  
c) ADDRESS:

\*d) DATE OF BIRTH: (15 / 11 / 1955) (DD/MM/YYYY)

e) OCCUPATION: (INDOOR / OUTDOOR)

f) DATE OF DRIVING PASS

4. WAS DRIVER AN EMPLOYEE OF THE INSURED'S COMPANY? (YES / NO)  
IF NO, RELATIONSHIP OF THE DRIVER WITH INSURED: OWNER

5. a) WEATHER CONDITION: (CLEAR / RAINING / OTHERS)  
b) ROAD SURFACE: (DRY / WET / OTHERS)

6. WAS ANYBODY INJURED (YES / NO)

7. a) REPORTED TO POLICE (YES / NO)

IF YES, PLEASE STATE WHICH POLICE STATION:

### 8. THIRD PARTY VEHICLE

- a) VEHICLE NUMBER: GBK 9958 X MODEL: TOYOTA HIACME  
b) DRIVER'S NAME: NG ZHEN CHAI, (VAN)  
c) NRIC/FIN/PASSPORT: S8309688 H CONTACT:

### 9. THIRD PARTY VEHICLE

- d) VEHICLE NUMBER: MODEL:  
e) DRIVER'S NAME:  
f) NRIC/FIN/PASSPORT: CONTACT:

Email = RAMLIK.BIN.ISMAIL126@GMAIL.COM

VIDEO





中国太平  
CHINA TAIPING

中国太平保险(新加坡)有限公司  
CHINA TAIPING INSURANCE (SINGAPORE) PTE. LTD.

Motor Hire Car

COWELL  
INSURANCE  
Agency Pte Ltd

**CERTIFICATE OF INSURANCE**  
Motor Vehicles (Third-Party Risks and Compensation) Act (Chapter 189)  
Motor Vehicles (Third-Party Risks and Compensation) Rules, 1960  
Road Transport Act, 1987 (Malaysia)  
Motor Vehicles (Third-Party Risks) Rules, 1959 (Malaysia)

MZ406L/B

N SN

AN0055A

Cov. Type:C

CERTIFICATE No.

DMHCSNW00014392100

Engine No.: 1NZR213715

Cha. No.: JTDKD3B3301572678

1. Index Mark and Registration  
Number of Vehicle

SKR2052L

AUTOSAFE  
=====

2. Name of Policy Holder

RAMLE BIN ISMAIL

3. Effective date of the Commencement of  
Insurance for the purposes of the Regulations,  
Ordinance or Enactment

23/11/2021  
(00:00:00)

Excess Sect I. S\$1,250.00

Excess Sect. I (Outside Singapore) S\$2,500.00

Excess Sect. II S\$1,250.00

Excess Sect. II (Outside Singapore). S\$2,500.00

EX ON WINDSCREEN. S\$100.00

4. Date of Expiry of Insurance

22/11/2022

5. Persons or Classes of Persons entitled to drive\*

As per Named Driver(s) stated below.

Provided that the person driving is permitted in accordance with the licensing or other laws or regulations to drive the Motor Vehicle or has been so permitted and is not disqualified by order of a Court of Law or by reason of any enactment or regulation in that behalf from driving the Motor Vehicle.

RAMLE BIN ISMAIL

6. Limitations as to use:\*

(1) Use for the carriage of passengers or goods in connection with the Policyholder's business.

(2) Use for social domestic pleasure purposes and business purposes of any person to whom the vehicle is hired.

The Policy does not cover

(1) Use for racing, pace-making, reliability trial or speed-testing.

(2) Use whilst drawing a trailer except the towing (other than for reward) of any one disabled mechanically propelled vehicle.

HIRE PURCHASE CO.: TOKYO CENTURY LEASING (S) PTE LTD

\* Limitations rendered inoperative by Section 8 of the Motor Vehicles (Third-Party Risks and Compensation) Act (Chapter 189) and Section 95 of the Road Transport Act 1987 (Malaysia), are not to be included under these headings.

**I/We hereby Certify** that the policy to which this Certificate relates is issued in accordance with the provisions of the Motor Vehicles (Third-Party Risks and Compensation) Act (Chapter 189) and Part IV of the Road Transport Act, 1987 (Malaysia).

Please see reverse

For CHINA TAIPING INSURANCE (SINGAPORE) PTE. LTD.

Issued By: COWELL INSURANCE (AGENCY) PTE LTD  
Authorised Officer

Authorised Signatory

China Taiping Insurance (Singapore) Pte. Ltd. (Co. Reg. No. 200208384E)  
3 Anson Road #16-00 Springleaf Tower Singapore 079909

6389 6111

6222 1033

www.sg.cntaiping.com



# Annex

Transaction ref 20211123150408920203

Please check that the owner and vehicle details are correct:

1. Name	: RAMLE BIN ISMAIL
2. Identification No. Type	: Singapore NRIC
3. Identification No.	: SXXXXX980B
4. Country/Region	: -
5. Vehicle Registration No.	: SKR2052L
6. Previous Vehicle Registration No.	: -
7. Effective Date of Ownership	: 23 Nov 2021
8. Original Registration Date	: 23 Jan 2015
9. First Registration Date	: 23 Jan 2015
10. Vehicle Type	: P10 - Passenger Motor Car
11. Vehicle Scheme	: Normal
12. Attachment 1	: No Attachment
13. Attachment 2	: -
14. Attachment 3	: -
15. Vehicle Make	: TOYOTA
16. Vehicle Model	: PRIUS C CVT
17. Year of Manufacture	: 2014
18. Primary Colour	: Grey
19. Secondary Colour	: -
20. Passenger Capacity	: 4
21. Chassis/Trailer Chassis No.	: JTDKD3B3301572678 / -
22. Propellant	: Petrol-Electric
23. Engine No./Motor No.	: 1NZR213715 / 1LMR213715
24. Engine Capacity(cc)/Power Rating(kW)	: 1497 / 45.0
25. Maximum Power Output(kW/bhp)	: 74.0 / 99
26. Unladen Weight(kg)	: 1120
27. Maximum Laden Weight(kg)	: 1565
28. Open Market Value	: \$23,578.00