

# SINGAPORE ACCIDENT STATEMENT

## IMPORTANT NOTICE

1. Please report correctly the details of the accident to speed up the claims process.
2. This Form must be completed by the Policyholder and/or the Authorised Driver
3. Information provided must be as truthful and accurate as possible. Any wilful misrepresentation or withholding of material facts may allow insurance companies to repudiate policy liability.
4. The issue and acceptance of this Form by insurance companies is not an admission of policy liability on the part of the insurance companies.
5. **Any false reporting may be referred to the Police for investigation.**
6. This report will be forwarded by the insurers of the GIA Records Management Centre established by the General Insurance Association of Singapore (GIA) for archiving and that copies of this report will, for a fee, be made available upon application by interested parties.
7. By the lodgement of this report to the insurers, you hereby consent to the archiving of this report at the centre and to copies of the report being made available aforesaid.

## ACCIDENT STATEMENT

Date of Submission ..... 16/11/2021 15:56 (SGT)  
Date of Accident ..... 16/11/2021 07:05 (SGT)  
Exact Location of Accident ..... Near 9QWF+JJ Singapore  
Additional Location Information ..... ALONG BKE TOWARDS KJE (BEFORE EXIT 5)  
Country/State of Loss ..... Singapore

## DETAILS OF OWN VEHICLE

Vehicle Registration Number ..... SKE8785J

### INSURED/POLICYHOLDER

Is company? ..... No  
Name Of Registered Owner ..... SUNDARAM VELOSAMY  
NRIC No ..... SXXXX175E  
Email Address ..... sundaram.v03@gmail.com  
Mobile Phone No ..... (Phone) +65-97640101  
Alternative Phone No ..... +65-97640101

### VEHICLE PARTICULARS

Manufacturer ..... Mercedes  
Model ..... C180  
Variant ..... -  
Exact purpose for which vehicle was being used at time of accident ..... Private use  
Are you claiming under your own insurance policy for repair to your vehicle? ..... No - Claiming third party  
Vehicle Category ..... Private car  
Transmission ..... Auto  
CC ..... 1597

### INSURANCE COMPANY

Name of Insurance Company ..... Great Eastern General Insurance Limited  
Type of Coverage ..... Comprehensive  
Fleet Policy ..... No  
Policy Number ..... 2020-V8010513-VDP-E002  
Cover Note Number ..... -

### DRIVER

Name of Driver ..... SUNDARAM VELOSAMY  
NRIC No ..... SXXXX175E

Date Of Birth .....	03/08/1964
Occupation .....	Indoor
Date Of Driving Pass .....	14/07/1995
Driving experience .....	26 YEARS AND 4 MONTHS
Gender .....	Male
Mobile Number .....	(Phone) +65-97640101
Alt. Phone Number .....	+65-97640101
Email Address .....	sundaram.v03@gmail.com
Address .....	BLK 328 WOODLANDS ST 32
Address complement .....	#05-61
Postcode .....	730328
Is the driver the policyholder? .....	Yes
If No, Relationship of the Driver with the Insured .....	-
Does Driver Own Other Vehicles? .....	No
Vehicle Registration Number of Other Vehicle Owned by Driver .....	-
Insurance Company of Other Vehicle Owned by Driver .....	-

#### GENERAL INFORMATION OF THE ACCIDENT

Type of Accident .....	Collision - Head to Rear
Weather Conditions .....	Clear
Road Surface .....	Dry

#### OTHER INFORMATION

Was any foreign vehicle involved in the accident? .....	No
Number of vehicles involved in the accident .....	2
Was anybody injured in the Accident? .....	No
Was any injured conveyed to hospital by ambulance? .....	-
Was any other vehicle or property damaged? .....	Yes
Number of Passengers (Including Driver) .....	2
Has the driver been approached by unknown person(s) soliciting/offering accident claims assistance? .....	No

#### PASSENGER 1

Name .....	SEKKHER
Gender .....	Male

#### DETAILS OF POLICE ACTION

Was the accident reported to the police? .....	No
Was notice of intended Prosecution given? .....	No
If yes, against whom? .....	-

#### CIRCUMSTANCES OF ACCIDENT

PLEASE REFER TO THE SKETCH PLAN FOR ACCIDENT DETAIL.

#### ATTACHMENT(S)

Are accident photos available for attachment? .....	Yes
Was there any video captured by Car Camera? .....	No
Was there any audio recorded? .....	No

#### DETAILS OF OTHER VEHICLE PROPERTY 1

Vehicle Registration Number .....	GBF4860C
Vehicle Manufacturer .....	-
Vehicle Model .....	-
Vehicle Variant .....	-
Vehicle Colour .....	-
Vehicle Category .....	Commercial vehicle

Name of Driver .....	FOO HENG HONG
Contact Number .....	-
Address .....	-
Address complement .....	-
Postcode .....	-
Insurance Company Name .....	-
Nature Of Damage .....	-
Details of property damaged in accident .....	-
No. Of Passenger (Including Driver) .....	-

## SKETCH PLAN

## IMPORTANT NOTICE

1. Please report correctly the details of the accident to speed up the claims process.
2. This Form must be completed by the Policyholder and/or the Authorised Driver.
3. Information provided must be as truthful and accurate as possible. Any wilful misrepresentation or withholding of material facts may allow insurance companies to repudiate policy liability.
4. The issue and acceptance of this Form by insurance companies is not an admission of policy liability on the part of the insurance companies.
5. Any false reporting may be referred to the Police for investigation.
6. The report will be forwarded by the insurers of the GIA Records Management Centre established by the General Insurance Association of Singapore (GIA) for archiving and that copies of this report will for a fee be made available upon application by interested parties.
7. By the lodgement of this report to the insurers, you hereby consent to the archiving of this report at the centre and to copies of the report being made available aforesaid.

## 8. Consent under the Personal Data Protection Act (PDPA)

I understand, acknowledge, agree and consent that:

(a) My insurer, my workshop and the General Insurance Association of Singapore ("GIA") may/are permitted to collect, use, disclose and/or process my personal data/personal information set out in this [form] and any other personal information provided by me or possessed by my insurer (collectively the "Personal Information") and disclose and transfer such Personal Information to all insurer(s) who have insured vehicle(s) involved in this accident (all insurer(s) who have insured vehicle(s) involved in this accident shall be collectively referred to as the "Insurers"), the Insurers' lawyers/law firms, the Monetary Authority of Singapore and any relevant government agency/authority (such as the police), for the purpose(s) of:

- (i) processing, handling and/or dealing with my claims including the settlement of the claims and any necessary investigations relating to the claims;
  - (ii) investigating the accident and/or my claims;
  - (iii) carrying out and/or dealing with my instructions or responding to any enquiries by me;
  - (iv) administering my claims (including the mailing of correspondence, statements, invoices, reports or notices to me, which could involve disclosure of certain personal data about me to bring about delivery of the same as well as on the external cover of envelopes/mail packages); and/or
  - (v) complying with applicable law in administering, processing, handling and/or dealing with my claims.
- (collectively the "Purposes")

(b) all insurer(s) who have insured vehicle(s) involved in this accident and the Insurers' lawyers/law firms, may/are permitted to collect, use, disclose and/or process my Personal Information for one or more of the above Purposes; and

(c) my Personal Information may/can be disclosed by any of the Insurers and/or GIA to their third party service providers or agents (including their lawyers/law firms), which may be sited outside of Singapore, for one or more of the above Purposes.

*Pundaraw* 16/11/2021  
15:25 hrs  
Policyholder's Signature / Date & Time

Driver's Signature (If driver is not the policyholder) / Date & Time



Witnessed by Reporting Centre Personnel

## Sketch Plan

ALONG BKE TOWARDS KJE (BEFORE EXIT 5)

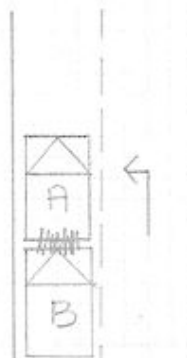

VEH A: SKE 8785J

VEH B: GBF4860C

## Describe Circumstances of the Accident

On the 16<sup>th</sup> of Nov at around 0705hrs, I was driving my vehicle A along BKE and filtering into the lane towards KJE, the vehicle in front of me braked and I applied my brake, suddenly the vehicle B at rear collided into my Rear.

## Declaration

We declare the foregoing particulars are true in every respect.

*Pundarikanti* 16/11/2021  
1525hrs

Policyholder's Signature / Date & Time

Driver's Signature (If driver is not the policyholder) / Date & Time



Witnessed by Reporting Centre Personnel





















For Customer Service please visit  
 1 Pickering Street  
 #01-01 Great Eastern Centre  
 Tel: +65 6248 2888 Fax: +65 6327 3080

## Certificate of Insurance

**ORIGINAL**

The Motor Policy to which this Certificate relates is issued in accordance with the provisions of the following  
 Legislation :  
 Motor Vehicles (Third-Party Risks and Compensation) Act (Cap.189 of the Revised Edition) (Singapore)  
 Motor Vehicles (Third-Party Risks and Compensation) Rules, 1996 Edition (Singapore)  
 Motor Vehicles (Third-Party Risks) Rules, 1959 (of Federation of Malaysia)  
 Motor Vehicles (Third-Party Risks) Act, 1987 (of Malaysia)  
 Road Transport Act 1987 (of Malaysia)  
 Road Transport (Amendment) Act 2019 (of Malaysia)

FORM MK1

Policy No. : 2020-V8010513-VDP-E002  
 Policy Type : Drive And Save Plus

Risk# : 0001  
 Cover : Comprehensive

**DESCRIPTION OF VEHICLES:**

Vehicle Registration : SKE8785J  
 Vehicle Make & Model : MERCEDES-BENZ - C180

Name of Insured : SUNDARAM VELOSAMY

Period of Insurance : 13-11-2020 (0000 HRS ) to 11-04-2022

**PERSONS OR CLASSES OF PERSONS ENTITLED TO DRIVE \***

(a) The Policyholder.

The Policyholder may also drive a motor car not belonging to or hired (under a hire purchase agreement or otherwise) to him/her or his/her employer or his/her partner.

(b) Any other person who is driving on the Policyholder's order or with his/her permission.

(c) In the event of the death of the Policyholder; (i) any member of the Policyholder's family, or a paid driver who has been driving the car during the lifetime of the Policyholder & permission to drive had not been withdrawn prior to the death of the Policyholder; (ii) any other person who has been given permission to drive the vehicle prior to the death & such permission had not been withdrawn by the Policyholder.

\* Provided that the person driving is permitted in accordance with the licensing or other laws or regulations to drive the Motor Vehicle or has been so permitted and is not disqualified by order of a Court of Law or by reason of any enactment or regulation in that behalf from driving the Motor Vehicle.

And provided further that the Motor Vehicle is registered under the Road Traffic Act and its registration under the Road Traffic Act has not been cancelled at the time of the accident loss or damage.

**LIMITATIONS AS TO USE**

Use for social domestic and pleasure purposes and for the Policyholder's business.

The policy does not cover use for hire or reward, racing, pace-making, reliability trial, speed-testing or the carriage of goods (other than samples) in connection with any other trade or business or use for any purpose in connection with the Motor Trade.

Limitations rendered inoperative by Section 8 of the Motor Vehicles (Third Party Risks and Compensation) Act (Chapter 189) and Section 95 of the Road Transport Act, 1987 (of Malaysia) are not to be included under these headings.

Signed for and on behalf of the Company

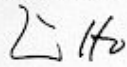

Authorized Signature

GPCSYLL

28-09-2021

Great Eastern General Insurance Limited (Reg. No. 1920 00003W)  
 a wholly-owned subsidiary of Great Eastern Holdings Limited  
 Pickering Street, #01-01 Great Eastern Centre, Singapore 048659  
 Tel: +65 6248 2888 Fax: +65 6327 3080 greateasterngeneral.com