

SINGAPORE ACCIDENT STATEMENT

IMPORTANT NOTICE

1. Please report correctly the details of the accident to speed up the claims process.
2. This Form must be completed by the Policyholder and/or the Authorised Driver
3. Information provided must be as truthful and accurate as possible. Any wilful misrepresentation or withholding of material facts may allow insurance companies to repudiate policy liability.
4. The issue and acceptance of this Form by insurance companies is not an admission of policy liability on the part of the insurance companies.
5. **Any false reporting may be referred to the Police for investigation.**
6. This report will be forwarded by the insurers of the GIA Records Management Centre established by the General Insurance Association of Singapore (GIA) for archiving and that copies of this report will, for a fee, be made available upon application by interested parties.
7. By the lodgement of this report to the insurers, you hereby consent to the archiving of this report at the centre and to copies of the report being made available aforesaid.

ACCIDENT STATEMENT

Date of Submission 27/10/2021 19:33 (SGT)
Date of Accident 27/10/2021 08:25 (SGT)
Exact Location of Accident Singapore
Additional Location Information DUNEARN ROAD
Country/State of Loss Singapore

DETAILS OF OWN VEHICLE

Vehicle Registration Number SBL30B

INSURED/POLICYHOLDER

Is company? No
Name Of Registered Owner CHUNG CHIN LIAN
NRIC No SXXXX550H
Email Address DIANECHEE@GMAIL.COM
Mobile Phone No (Phone) +65-96492144
Alternative Phone No +65-96492144

VEHICLE PARTICULARS

Manufacturer Volkswagen
Model Golf
Variant GOLF 1.4 TSI R-LINE AT SR
Exact purpose for which vehicle was being used at time of accident Private use
Are you claiming under your own insurance policy for repair to your vehicle? No - Claiming third party
Vehicle Category Private car
Transmission Auto
CC 1395

INSURANCE COMPANY

Name of Insurance Company QBE Insurance (Singapore) Pte Ltd
Type of Coverage Comprehensive
Fleet Policy No
Policy Number 8-V0023037-MVA-R002
Cover Note Number -

DRIVER

Name of Driver DIANE CHEE SUI-YEN
NRIC No SXXXX546J

Date Of Birth	13/03/1974
Occupation	Indoor
Date Of Driving Pass	15/08/1996
Driving experience	25 YEARS AND 2 MONTHS
Gender	Female
Mobile Number	(Phone) +65-96492144
Alt. Phone Number	-
Email Address	DIANECHEE@GMAIL.COM
Address	BLK 39 MOUNT SINAI RISE
Address complement	#17-02
Postcode	276957
Is the driver the policyholder?	No
If No, Relationship of the Driver with the Insured	Parent
Does Driver Own Other Vehicles?	No
Vehicle Registration Number of Other Vehicle Owned by Driver	-
Insurance Company of Other Vehicle Owned by Driver	-

GENERAL INFORMATION OF THE ACCIDENT

Type of Accident	Collision - Head to Rear
Weather Conditions	Clear
Road Surface	Wet

OTHER INFORMATION

Was any foreign vehicle involved in the accident?	No
Number of vehicles involved in the accident	2
Was anybody injured in the Accident?	Yes
Was any injured conveyed to hospital by ambulance?	No
Was any other vehicle or property damaged?	Yes
Number of Passengers (Including Driver)	1
Has the driver been approached by unknown person(s) soliciting/offering accident claims assistance?	No

DETAILS OF POLICE ACTION

Was the accident reported to the police?	No
Was notice of intended Prosecution given?	No
If yes, against whom?	-

CIRCUMSTANCES OF ACCIDENT

REFER TO THE SKETCH PLAN

ATTACHMENT(S)

Are accident photos available for attachment?	No
Was there any video captured by Car Camera?	No
Was there any audio recorded?	No

DETAILS OF OTHER VEHICLE PROPERTY 1

Vehicle Registration Number	GBE2838L
Vehicle Manufacturer	-
Vehicle Model	-
Vehicle Variant	-
Vehicle Colour	-
Vehicle Category	Commercial vehicle
Name of Driver	-
Contact Number	-
Address	-
Address complement	-

Postcode -
Insurance Company Name -
Nature Of Damage -
Details of property damaged in accident -
No. Of Passenger (Including Driver) -

INJURED PERSONS DETAILS

INJURED 1

Name of injured person	DIANE CHEE SUI-YEN
Gender	Female
Phone No	-
Address	-
Address Complement	-
Post Code	-
Approximate Age Years Old	-
Injuries Sustained	-
Injured person in which vehicle?	SBL30B
Were seat belts worn?	Yes
Was this injured conveyed to hospital by ambulance?	-

SKETCH PLAN**IMPORTANT NOTICE**

1. Please report correctly the details of the accident to speed up the claims process.
2. This Form must be completed by the Policyholder and/or the Authorised Driver.
3. Information provided must be as truthful and accurate as possible. Any wilful misrepresentation or withholding of material facts may allow insurance companies to repudiate policy liability.
4. The issue and acceptance of this Form by insurance companies is not an admission of policy liability on the part of the insurance companies.
5. Any false reporting may be referred to the Police for investigation.
6. The report will be forwarded by the insurers of the GIA Records Management Centre established by the General Insurance Association of Singapore (GIA) for archiving and that copies of this report will for a fee be made available upon application by interested parties.
7. By the lodgement of this report to the insurers, you hereby consent to the archiving of this report at the centre and to copies of the report being made available aforesaid.
8. **Consent under the Personal Data Protection Act (PDPA)**

I understand, acknowledge, agree and consent that :

(a) My insurer, my workshop and the General Insurance Association of Singapore ("GIA") may/are permitted to collect, use, disclose and/or process my personal data/personal information set out in this [form] and any other personal information provided by me or possessed by my insurer (collectively the "Personal Information") and disclose and transfer such Personal Information to all insurer(s) who have insured vehicle(s) involved in this accident (all insurer(s) who have insured vehicle(s) involved in this accident shall be collectively referred to as the "Insurers"), the Insurers' law yers/law firms, the Monetary Authority of Singapore and any relevant government agency/authority (such as the police), for the purpose(s) of :

(i) processing, handling and/or dealing with my claims including the settlement of the claims and any necessary investigations relating to the claims;

(ii) investigating the accident and/or my claims;

(iii) carrying out and/or dealing with my instructions or responding to any enquiries by me;

(iv) administering my claims (including the mailing of correspondence, statements, invoices, reports or notices to me, which could involve disclosure of certain personal data about me to bring about delivery of the same as well as on the external cover of envelopes/mail packages); and/or

(v) complying with applicable law in administering, processing, handling and/or dealing with my claims.

(collectively the "Purposes")

(b) all insurer(s) who have insured vehicle(s) involved in this accident and the Insurers' law yers/law firms, may/are permitted to collect, use, disclose and/or process my Personal Information for one or more of the above Purposes; and

(c) my Personal Information may/can be disclosed by any of the Insurers and/or GIA to their third party service providers or agents (including their law yers/law firms), which may be sited outside of Singapore, for one or more of the above Purposes.

Policyholder's Signature / Date & Time

Driver's Signature (If driver is not the policyholder) / Date & Time

Witnessed by Reporting Centre Personnel

Sketch Plan

Refer to attachment

Describe Circumstances of the Accident

[illegible]

Declaration

We declare the foregoing particulars are true in every respect.

Policyholder's Signature / Date & Time

Driver's Signature (If driver is not the policyholder) / Date & Time

Witnessed by Reporting Centre
Personnel



**SINGAPORE
POLICE FORCE**



T/20211027/7014

Police Station Of Origin:
Traffic Police
10 Ubi Avenue 3 SINGAPORE 408865
Tel No: 65470000

1 of 4

Report No. T/20211027/7014

REPORT OF A TRAFFIC ACCIDENT

Date/Time Report Made: 27/10/2021 14:21		Vide Report No.:		Station Diary No.:	
Informant's Particulars					
Name of Informant: DIANE CHEE SUI-YEN			Address: 39 MOUNT SINAI RISE #17-02 SINGAPORE 276957		
ID Type / ID No.: NRIC NO / S7407546J			Contact No.: Home/Office: Mobile: 96492144		
Nationality: SINGAPORE CITIZEN			Email: dianechee@gmail.com		
Sex: Female	Age: 47	Date of Birth: 13/03/1974	Type of Informant: Driver		
Race: Chinese			Language: English		Institution / School Name:
Occupation: Curator (art gallery and museum)			Driving Licence Information: Class: 3 Date of Expiry:		

General Information of the Accident				
Type of Accident:	Injury Others	Drink Drive: No	Date/Time of Accident: 27/10/2021 08:25	Type of Location: Straight Road
Location: DUNEARN ROAD				
Weather: Cloudy		Road Surface: Wet		Road Speed Limit: 70 Km/h
Traffic Flow: One Way		Traffic Control: Not Controlled		Traffic Volume: Heavy
Type of Collision: Between Moving Vehicles - Head To Rear				Anyone conveyed by ambulance: No

Details of Vehicle Involved						
Vehicle No.	Type	Make	Model	Color	Conditio	No of
GBE2838L	Lorry	TOYOTA		Blue	Slightly Damaged	3
SBL30B	Car					0

Details of Vehicle Insurance				
Vehicle No.	Insurance Company	Insurance No	Effective	Expiry Date



**SINGAPORE
POLICE FORCE**



T/20211027/7014

Police Station Of Origin:
Traffic Police
10 Ubi Avenue 3 SINGAPORE 408865
Tel No: 65470000

2 of 4

Report No. T/20211027/7014

CONTINUATION OF REPORT

Details of Vehicle Insurance				
Vehicle No.	Insurance Company	Insurance No	Effective	Expiry Date
GBE2838L	INDIA INTERNATIONAL INSURANCE PTE LTD	D20MCV0005655_01	22/10/2021	21/10/2022

Details of Person Involved			
Any Pedestrian Involved: No			
No. of Pedestrians Injured: NIL		Use of Pedestrian Crossing: NA	
Driver			
Name	MOHAN GURU	ID No.	O 36327286
Related Vehicle	GBE2838L (Lorry)	Contact No.	67608383
Hospital/Clinic	NIL	Class of Driving Licence & Expiry	Class: NIL Date of Expiry: 15/10/2026
Date	NIL	Date	NIL
No. of Days granted Medical Leave	NIL	Degree of	NIL
Driver			
Name	DIANE CHEE SUI-YEN	ID No.	S7407546J
Related Vehicle	SBL30B (Car)	Contact No.	96492144
Hospital/Clinic	BUKIT TIMAH CLINIC	Class of Driving Licence & Expiry	Class: 3 Date of Expiry: NIL
Date	27/10/2021	Date	27/10/2021
No. of Days granted Medical Leave	03	Degree of	Slight

Brief Details.

At 8:25am on Wednesday 27 Oct 2021, I was driving my car SBL 30 B along Dunearn Road in the stretch between Whitley Road and Newton Circus. I was travelling in the centre lane. Just before passing Goldhill Avenue there was a line of stationary cars in the left most lane, queuing behind a stationary bus that had stopped at a bus stop located after the entrance to Goldhill Avenue.

One of the cars in the stationary queue in the left lane pulled out of the queue and partially entered the centre lane in front of me where traffic was free flowing. In order to avoid a collision with the car pulling out into the centre lane I stopped my car. At this point, the blue Toyota lorry travelling behind me (GBE 2838 L) failed to stop in time and collided with the rear of my car. I heard the skid of the lorry's brakes before it hit the back of my car. Both the lorry and my car came to a halt in the middle of the centre lane. There was damage to both the rear of my car and the front of the lorry.



**SINGAPORE
POLICE FORCE**



T/20211027/7014

Police Station Of Origin:
Traffic Police
10 Ubi Avenue 3 SINGAPORE 408865
Tel No: 65470000

3 of 4

Report No. T/20211027/7014

CONTINUATION OF REPORT

The car that had pulled out into the centre lane causing me to stop drove away and I did not manage to obtain the vehicle or driver details. There was no damage to that car. There is no in-car video footage of the accident from my car.

The lorry (GBE 2838 L) that collided with the rear of my car belongs to Ferco Shutters & Seating Systems Pte Ltd (120 Hillview Avenue, 02-04, Kewalram Hillview, Singapore 669594). The driver of the lorry was their employee Mohan Guru (Driving Licence No. G2422516Q, Work Permit No. O 36327286). There appeared to be no injuries to the driver of the lorry or the two passengers.

After taking photographs of both vehicles in situ for record purposes, we moved both vehicles into Goldhill Avenue and exchanged particulars.

As my car had been hit from behind with some force I was thrown forward in my seat. I was wearing a seatbelt. However afterwards I noted pain and stiffness in my neck and shoulders and informed Mohan Guru that I would be seeing a doctor about my neck. I visited my family doctor the same morning for assessment. He issued me a three day MC, prescribed painkillers, and has advised me to undergo a neck x-ray.

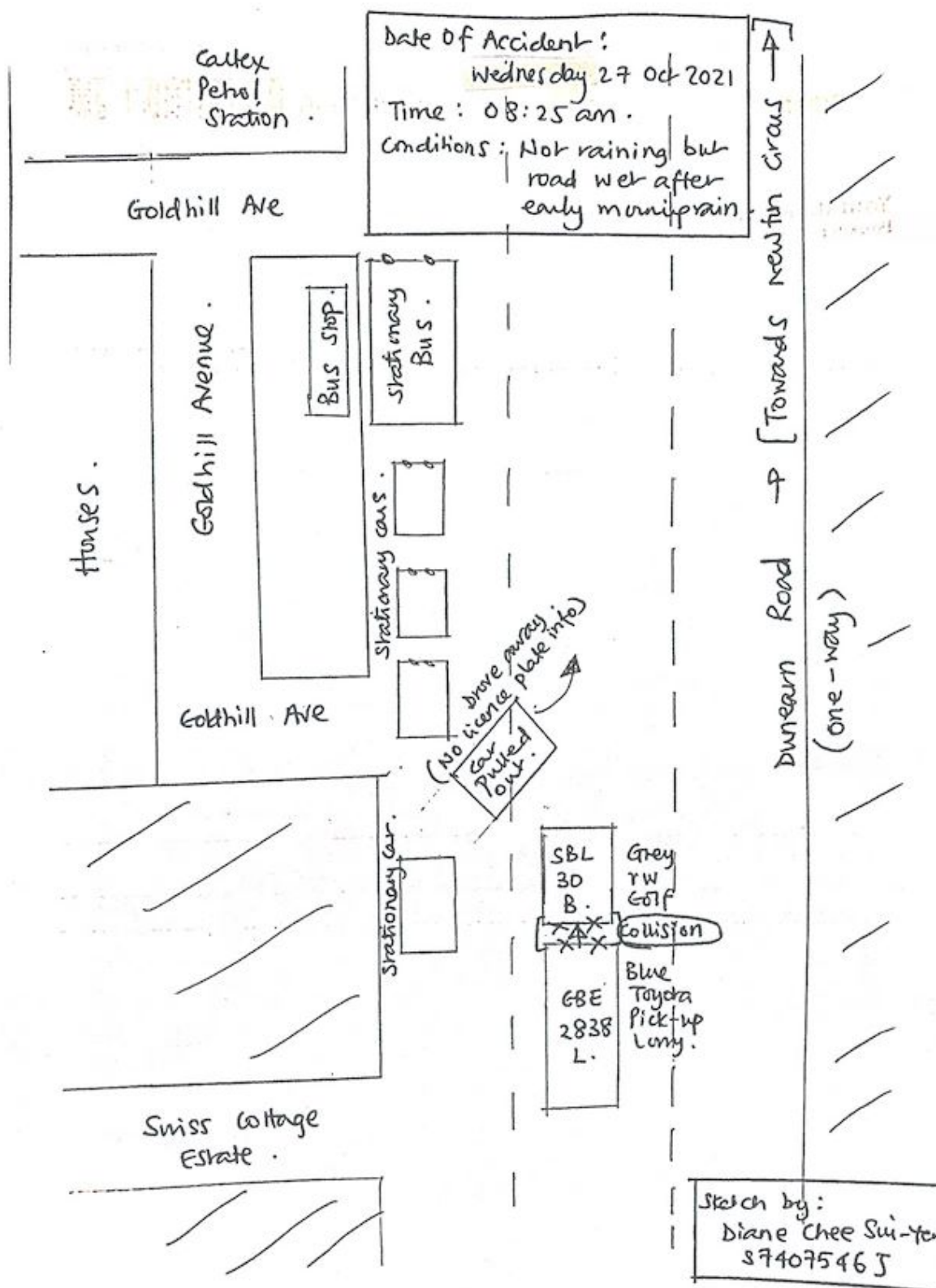

Scanned with CamScanner

Scanned with CamScanner

Accident involving SBL 30 B and GBE 2838L on Wednesday 27 October at 08:25am
 Images taken by Diane Chee Sui-Yen (S7407546J)











QBE

QBE Insurance (Singapore) Pte Ltd
 Part of QBE Insurance Group - Unique Entity No. 188401363C
 1 Wallich Street, #15-01 Quoc Tower, Singapore 078881
 Tel: 65-6224 6933 Fax: 65 6333 3270
 GST Registration No.: M200644018
 www.qbe.com.sg

Date of issue 19/07/2021

Page 1 of 2

PRIVATE CAR
POLICY SCHEDULE

Renewal

CHUNG CHIN LIAN
 19 TANGLIN ROAD #12-03
 TANGLIN SHOPPING CENTRE
 SINGAPORE 247909

Policy Number 8-V0023037-MVA-R002	Period of Insurance 18/08/2021 to 17/08/2022 (Both Dates Inclusive)	Account Number 09L00173 QBE-DIRECT ACCOUNT
--------------------------------------	---	--

This policy is issued/renewed from information you have disclosed. If there are any material changes during the period of this cover, please inform us.

The Insured : CHUNG CHIN LIAN

Risk Details

Sum Insured	Market Value	Cover
Make & Model	VOLKSWAGEN GOLF 1.4 TSI R-LINE	Registration No.
Type of Body	Saloon with Sunroof	Cubic Capacity
Year of Manufacture	2016	Chassis No.
		Engine No.
		No Claims Discount
		Safe Driver Discount

Risk No 0001

Comprehensive

SBL30B

1395

WWWZZAUZHWO19037

CZD246356

50.00

5.00

Excess	SGD	600	1,000
--------	-----	-----	-------

Insured/Named Driver

Unnamed Driver

Other Information

NAMED DRIVERS

1) CHEE SUI-YEN DIANE (S7407546J, 13/03/1974)

2) CHEE GUAN CHYE (S1111634E, 29/01/1940)

M2 EXCESS OWN DAMAGE CLAIMS (NOT APPLICABLE TO YOUNG AND INEXPERIENCED DRIVER EXCESS)

EA162 LOSS OF USE BENEFIT

EZ93A YOUNG AND INEXPERIENCED DRIVER EXCESS - ALL CLAIMS (EXCESS : \$53,500.00)

SGPGLN



















