

SINGAPORE ACCIDENT STATEMENT

IMPORTANT NOTICE

1. Please report correctly the details of the accident to speed up the claims process.
2. This Form must be completed by the Policyholder and/or the Authorised Driver
3. Information provided must be as truthful and accurate as possible. Any wilful misrepresentation or withholding of material facts may allow insurance companies to repudiate policy liability.
4. The issue and acceptance of this Form by insurance companies is not an admission of policy liability on the part of the insurance companies.
5. **Any false reporting may be referred to the Police for investigation.**
6. This report will be forwarded by the insurers of the GIA Records Management Centre established by the General Insurance Association of Singapore (GIA) for archiving and that copies of this report will, for a fee, be made available upon application by interested parties.
7. By the lodgement of this report to the insurers, you hereby consent to the archiving of this report at the centre and to copies of the report being made available aforesaid.

ACCIDENT STATEMENT

Date of Submission 02/11/2021 13:39 (SGT)
Date of Accident 02/11/2021 07:30 (SGT)
Exact Location of Accident Singapore
Additional Location Information KJE towards Choa Chu Kang Drive
Country/State of Loss Singapore

DETAILS OF OWN VEHICLE

Vehicle Registration Number GBD3907U

INSURED/POLICYHOLDER

Is company? Yes
Name Of Registered Owner Hua Chen Construction Pte Ltd
Company Reg No 201115204Z
Email Address huachen_constr@ymail.com
Mobile Phone No (Phone) +65-97535168
Alternative Phone No +65-97535168

VEHICLE PARTICULARS

Manufacturer Toyota
Model Dyna
Variant -
Exact purpose for which vehicle was being used at time of accident -
Are you claiming under your own insurance policy for repair to your vehicle? No - Reporting only
Vehicle Category Commercial vehicle
Transmission Manual
CC 2982

INSURANCE COMPANY

Name of Insurance Company EQ Insurance Company Ltd
Type of Coverage Comprehensive
Fleet Policy No
Policy Number DMCPHQ21-003488
Cover Note Number -

DRIVER

Name of Driver Xi Xing Hua
Passport No/FIN G7138023N

Date Of Birth	07/06/1972
Occupation	Outdoor
Date Of Driving Pass	23/08/2016
Driving experience	5 YEARS AND 3 MONTHS
Gender	Male
Mobile Number	(Phone) +65-97535168
Alt. Phone Number	-
Email Address	huachen_constr@ymail.com
Address	9 Lorong 34 Geylang
Address complement	-
Postcode	398207
Is the driver the policyholder?	No
If No, Relationship of the Driver with the Insured	Employee
Does Driver Own Other Vehicles?	No
Vehicle Registration Number of Other Vehicle Owned by Driver	-
Insurance Company of Other Vehicle Owned by Driver	-

GENERAL INFORMATION OF THE ACCIDENT

Type of Accident	Collision - Head to Rear
Weather Conditions	Clear
Road Surface	Dry

OTHER INFORMATION

Was any foreign vehicle involved in the accident?	No
Number of vehicles involved in the accident	2
Was anybody injured in the Accident?	No
Was any injured conveyed to hospital by ambulance?	-
Was any other vehicle or property damaged?	Yes
Number of Passengers (Including Driver)	2
Has the driver been approached by unknown person(s) soliciting/offering accident claims assistance?	No

PASSENGER 1

Name	Golam
Gender	Male

DETAILS OF POLICE ACTION

Was the accident reported to the police?	No
Was notice of intended Prosecution given?	No
If yes, against whom?	-

CIRCUMSTANCES OF ACCIDENT

I was travelling from KJE towards Choa Chu Kang Drive, and at the junction, as it was pedestrian crossing behind, I slid forward a bit, hit into stationary vehicle in front, SMU1822Z, causing scratches to the front vehicle's rear.

ATTACHMENT(S)

Are accident photos available for attachment?	Yes
Was there any video captured by Car Camera?	No
Was there any audio recorded?	No

DETAILS OF OTHER VEHICLE PROPERTY 1

Vehicle Registration Number	SMU1822Z
Vehicle Manufacturer	-
Vehicle Model	-
Vehicle Variant	-
Vehicle Colour	-

Vehicle Category	Private car
Name of Driver	-
Contact Number	-
Address	-
Address complement	-
Postcode	-
Insurance Company Name	-
Nature Of Damage	-
Details of property damaged in accident	-
No. Of Passenger (Including Driver)	-

SKETCH PLAN

IMPORTANT NOTICE

1. Please report correctly the details of the accident to speed up the claims process.
2. This Form must be completed by the Policyholder and/or the Authorised Driver.
3. Information provided must be as truthful and accurate as possible. Any wilful misrepresentation or withholding of material facts may allow insurance companies to repudiate policy liability.
4. The issue and acceptance of this Form by insurance companies is not an admission of policy liability on the part of the insurance companies.
5. Any false reporting may be referred to the Police for investigation.
6. The report will be forwarded by the insurers of the GIA Records Management Centre established by the General Insurance Association of Singapore (GIA) for archiving and that copies of this report will for a fee be made available upon application by interested parties.
7. By the lodgement of this report to the insurers, you hereby consent to the archiving of this report at the centre and to copies of the report being made available aforesaid.

8. Consent under the Personal Data Protection Act (PDPA)

I understand, acknowledge, agree and consent that :

(a) My insurer, my workshop and the General Insurance Association of Singapore ("GIA") may/are permitted to collect, use, disclose and/or process my personal data/personal information set out in this [form] and any other personal information provided by me or possessed by my insurer (collectively the "Personal Information") and disclose and transfer such Personal Information to all insurer(s) who have insured vehicle(s) involved in this accident (all insurer(s) who have insured vehicle(s) involved in this accident shall be collectively referred to as the "Insurers"), the Insurers' law yers/law firms, the Monetary Authority of Singapore and any relevant government agency/authority (such as the police), for the purpose(s) of :

(i) processing, handling and/or dealing with my claims including the settlement of the claims and any necessary investigations relating to the claims;

(ii) investigating the accident and/or my claims;

(iii) carrying out and/or dealing with my instructions or responding to any enquiries by me;

(iv) administering my claims (including the mailing of correspondence, statements, invoices, reports or notices to me, which could involve disclosure of certain personal data about me to bring about delivery of the same as well as on the external cover of envelopes/mail packages); and/or

(v) complying with applicable law in administering, processing, handling and/or dealing with my claims.

(collectively the "Purposes")

(b) all insurer(s) who have insured vehicle(s) involved in this accident and the Insurers' law yers/law firms, may/are permitted to collect, use, disclose and/or process my Personal Information for one or more of the above Purposes; and

(c) my Personal Information may/can be disclosed by any of the Insurers and/or GIA to their third party service providers or agents (including their law yers/law firms), which may be sited outside of Singapore, for one or more of the above Purposes.



Policyholder's Signature / Date & Time

Sketch Plan

Thm 2/11/2021

Driver's Signature (if driver is not the policyholder) / Date & Time

h 2/11/21

Witnessed by Reporting Centre Personnel

A- GBD3907U
B- SMU1822Z

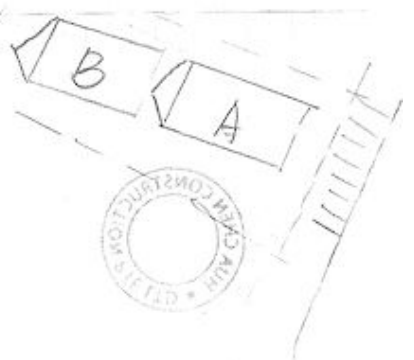

Please note that you might be able to submit an Own Damage claim under your own policy within 14 days.
() Claim Own Damage (OD) () Claim Third Party (TP) (✓) Reporting Only () Claim OD/TP at other workshop

Describe Circumstances of the Accident

我从 EJE 转去 Choa Chu Kong Dr.
 但在转弯处。为了后面是人行道。向
 前滑行一点。然后碰到前面停在那里的车辆
 给前面的车尾刮去一点痕迹。

I was travelling from EJE towards Choa Chu Kong Drive, and at the
 junction, as it was pedestrian crossing behind, I slid forward a bit, hit
 stationary
 into vehicle in front, SMV1822Z, causing scratches to the front vehicle's
 rear.

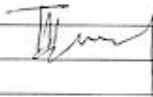

Declaration

We declare the foregoing particulars are true in every respect.

 
 Policyholder's Signature / Date &
 Time

 2/11/2021
 Driver's Signature (if driver is not the policyholder) / Date
 & Time

 2/11/21
 Witnessed by Reporting Centre
 Personnel















EQ Insurance Company Limited
 5 Maxwell Road #17-00 Tower Block MND Complex, Singapore 069110
 tel 65 6223 9433 | fax 65 6224 3933 | www.eqinsurance.com.sg
 reg no. 1976-00490-N



CERTIFICATE OF INSURANCE

ROAD TRANSPORT ACT 1987 (MALAYSIA)
 THE MOTOR VEHICLES (THIRD-PARTY RISKS) RULES 1959 (FEDERATION OF MALAYSIA)
 THE MOTOR VEHICLES(THIRD-PARTY RISKS AND COMPENSATION) ACT (CAP.189 OF THE REVISED EDITION)
 (REPUBLIC OF SINGAPORE)
 THE MOTOR VEHICLES(THIRD-PARTY RISKS AND COMPENSATION) RULES 1996 EDITION(REPUBLIC OF SINGAPORE)
 OR ANY AMENDMENT, ACT OR ACTS PASSED IN SUBSTITUTION THEREOF

COMMERCIAL VEHICLE PRIVATE (SCH I) Comprehensive Classic

Certificate No. : DMCPHQ21-003488

Classic Plan - EQ Authorised Workshop Only
 Form: LCVPI
 Excess:
 Section 1: S\$500.00
 YEID-AC Additional: S\$3,000.00

1. Index Mark and Registration Number of Vehicles

GBD3907U

2. Name of Policyholder

HUA CHEN CONSTRUCTION PTE LTD

3. Effective Date of the Commencement of Insurance for the purpose of the Act

23/09/2021

4. Date of Expiry of Insurance

22/09/2022

5. Person or Classes of persons entitled to drive*

Goods carrying - (MZ300) Authorised Driver.

Any of the following :-

1. The Policyholder
2. Any person on the order or with the permission of the Policyholder

* Provided that the person driving is permitted in accordance with the licensing or other laws or regulation to drive the Motor Vehicle or has been permitted and is not disqualified by order of Court of Law or by reason of any enactment enactment or regulation in that behalf from driving the Motor Vehicle. And provided further that the Motor Vehicle is registered under the Road Traffic Act has not been cancelled at the time of accident loss or damage.

6. Limitation as to use*

- 1) Use in connection with the Insured's business.
 - 2) Use for the carriage of passengers (other than for hire or reward) in connection with the Insured's business.
 - 3) Use for social domestic and pleasure purposes.
- THE POLICY DOES NOT COVER
- 1) Use for hire or reward or for racing pace-making reliability trial or speed testing.
 - 2) Use whilst drawing a greater number of trailers in all than is permitted by Law.
 - 3) Use for the carriage of passengers for hire or reward.
 - 4) Liability arising from or in connection with the carriage of hazardous materials, high explosives, inflammable liquid or gases including LPG in cylinders.

*Limitations rendered inoperative by Section 8 of the Motor vehicles (Third-Party Risks and Compensation) Act (Chapter 189) and Section 95 of the Road Transport Act, 1987 (Malaysia), are not to be included under these headings.

I/WE HEREBY CERTIFY that the Policy to which this Certificate relates is issued in accordance with the provisions of the Motor Vehicles (Third-Party Risks and Compensation) Act (Chapter 189) and Part IV of the Road Transport Act, 1987 (Malaysia) or and Amendment, Act or Acts passed in substitution thereof.

Hire Purchase : Abwin Pte Ltd

A000342/Abwin Pte Ltd
 Date of Issue : 16/09/2021 11:41

Authorised Signatory
 EQ Insurance Company Limited

Exp No. : DMCPHQ20-003505

A Member of Citystate