

SINGAPORE ACCIDENT STATEMENT

IMPORTANT NOTICE

1. Please report correctly the details of the accident to speed up the claims process.
2. This Form must be completed by the Policyholder and/or the Authorised Driver
3. Information provided must be as truthful and accurate as possible. Any wilful misrepresentation or withholding of material facts may allow insurance companies to repudiate policy liability.
4. The issue and acceptance of this Form by insurance companies is not an admission of policy liability on the part of the insurance companies.
5. **Any false reporting may be referred to the Police for investigation.**
6. This report will be forwarded by the insurers of the GIA Records Management Centre established by the General Insurance Association of Singapore (GIA) for archiving and that copies of this report will, for a fee, be made available upon application by interested parties.
7. By the lodgement of this report to the insurers, you hereby consent to the archiving of this report at the centre and to copies of the report being made available aforesaid.

ACCIDENT STATEMENT

Date of Submission	14/09/2021 17:22 (SGT)
Date of Accident	14/09/2021 11:30 (SGT)
Exact Location of Accident	Singapore
Additional Location Information	JUNCTION OF JALAN BESAR AND SAM LEONG ROAD
Country/State of Loss	Singapore

DETAILS OF OWN VEHICLE

Vehicle Registration Number	SJU2714G
INSURED/POLICYHOLDER	
Is company?	No
Name Of Registered Owner	ZHENG KANG WEI
NRIC No	S8026380E
Email Address	BOYSACT@YAHOO.COM
Mobile Phone No	(Phone) +65-91093396
Alternative Phone No	+65-91093396

VEHICLE PARTICULARS

Manufacturer	Mazda
Model	3
Variant	-
Exact purpose for which vehicle was being used at time of accident	-
Are you claiming under your own insurance policy for repair to your vehicle?	No - Claiming third party
Vehicle Category	Private car
Transmission	Auto
CC	1600

INSURANCE COMPANY

Name of Insurance Company	EQ Insurance Company Ltd
Type of Coverage	Comprehensive
Fleet Policy	No
Policy Number	DMPPHQ20-007528
Cover Note Number	-

DRIVER

Name of Driver	ZHENG KANG WEI
NRIC No	S8026380E

Date Of Birth	30/08/1980
Occupation	Indoor
Date Of Driving Pass	30/11/2000
Driving experience	20 YEARS AND 10 MONTHS
Gender	Male
Mobile Number	(Phone) +65-91093396
Alt. Phone Number	+65-91093396
Email Address	BOYSACT@YAHOO.COM
Address	BLK 629 SENJA ROAD #15-196
Address complement	-
Postcode	670629
Is the driver the policyholder?	Yes
If No, Relationship of the Driver with the Insured	-
Does Driver Own Other Vehicles?	No
Vehicle Registration Number of Other Vehicle Owned by Driver	-
Insurance Company of Other Vehicle Owned by Driver	-

GENERAL INFORMATION OF THE ACCIDENT

Type of Accident	Collision - Head to Rear
Weather Conditions	Clear
Road Surface	Dry

OTHER INFORMATION

Was any foreign vehicle involved in the accident?	No
Number of vehicles involved in the accident	2
Was anybody injured in the Accident?	Yes
Was any injured conveyed to hospital by ambulance?	No
Was any other vehicle or property damaged?	Yes
Number of Passengers (Including Driver)	1
Has the driver been approached by unknown person(s) soliciting/offering accident claims assistance?	No

DETAILS OF POLICE ACTION

Was the accident reported to the police?	No
Was notice of intended Prosecution given?	No
If yes, against whom?	-

CIRCUMSTANCES OF ACCIDENT

REFER TO REPORT ATTACHED

ATTACHMENT(S)

Are accident photos available for attachment?	Yes
Was there any video captured by Car Camera?	Yes
Was there any audio recorded?	No

DETAILS OF OTHER VEHICLE PROPERTY 1

Vehicle Registration Number	GBK6791D
Vehicle Manufacturer	-
Vehicle Model	-
Vehicle Variant	-
Vehicle Colour	-
Vehicle Category	Commercial vehicle
Name of Driver	VEERA
Contact Number	(Phone) +65-88680401
Address	-
Address complement	-

Postcode _____ -
 Insurance Company Name _____ -
 Nature Of Damage _____ -
 Details of property damaged in accident _____ -
 No. Of Passenger (Including Driver) _____ -

INJURED PERSONS DETAILS

INJURED 1

Name of injured person ZHENG KANG WEI
 Gender Male
 Phone No (Phone) +65-91093396
 Address _____
 Address Complement _____
 Post Code _____
 Approximate Age Years Old _____
 Injuries Sustained _____
 Injured person in which vehicle? SJU2714G
 Were seat belt's worn? Yes
 Was this injured conveyed to hospital by ambulance? No

Estimate

W 1000 Y 1000 1000 1000	1'00	1500'00	53'00	884'32
W 1000 Y 1000 1000 1000	1'00	1500'00	53'00	884'32
W 1000 Y 1000 1000 1000	1'00	1500'00	53'00	884'32
W 1000 Y 1000 1000 1000	1'00	1500'00	53'00	884'32
W 1000 Y 1000 1000 1000	1'00	1500'00	53'00	884'32
W 1000 Y 1000 1000 1000	1'00	1500'00	53'00	884'32
W 1000 Y 1000 1000 1000	1'00	1500'00	53'00	884'32
W 1000 Y 1000 1000 1000	1'00	1500'00	53'00	884'32

Vehicle No	Year	Make/Model	Color	Ins / Insured	Policy No
1000000	2000	TOYOTA CAMRY	GRN	1000000	1000000

1000000	2000	TOYOTA CAMRY	GRN	1000000	1000000
1000000	2000	TOYOTA CAMRY	GRN	1000000	1000000
1000000	2000	TOYOTA CAMRY	GRN	1000000	1000000
1000000	2000	TOYOTA CAMRY	GRN	1000000	1000000
1000000	2000	TOYOTA CAMRY	GRN	1000000	1000000
1000000	2000	TOYOTA CAMRY	GRN	1000000	1000000
1000000	2000	TOYOTA CAMRY	GRN	1000000	1000000
1000000	2000	TOYOTA CAMRY	GRN	1000000	1000000

ESTIMATE

STANDARD CYBERNETS CUSTOMER SERVICE CENTRE
 SINGAPORE CYBERNETS VILLAGE

SKETCH PLAN

Before completing this form, you must read the instructions carefully. The information you provide on this form will be used to process your claim. It is important that you provide accurate and complete information. If you provide false information, your claim may be rejected. The information you provide on this form will be used to process your claim. It is important that you provide accurate and complete information. If you provide false information, your claim may be rejected.

SKETCH PLAN

IMPORTANT NOTICE

1. Please report correctly the details of the accident to speed up the claims process.
 2. This Form must be completed by the Policyholder and/or the Authorized Driver.
 3. Information provided must be as truthful and accurate as possible. Any willful misrepresentation or withholding of material facts may allow insurance companies to repudiate policy liability.
 4. The issue and acceptance of this Form by insurance companies is not an admission of policy liability on the part of the insurance companies.
 5. Any false reporting may be referred to the Police for investigation.
 6. The report will be forwarded by the insurers of the GIA Records Management Centre established by the General Insurance Association of Singapore (GIA) for archiving and that copies of this report will for a fee be made available upon application by interested parties.
 7. By the lodgement of this report to the insurers, you hereby consent to the archiving of this report at the centre and to copies of the report being made available aforesaid.
 8. Consent under the Personal Data Protection Act (PDPA)
- I understand, acknowledge, agree and consent that:
- (a) My insurer, my workshop and the General Insurance Association of Singapore ("GIA") may be permitted to collect, use, disclose and/or process my personal data/personal information set out in this form and any other personal information provided by me or possessed by my insurer (collectively the "Personal Information") and disclose and transfer such Personal Information to all insurers who have insured vehicle(s) involved in this accident (all insurer(s) who have insured vehicle(s) involved in this accident shall be collectively referred to as the "Insurers"), the Insurers' lawyers/law firms, the Monetary Authority of Singapore and any relevant government agency/authority (such as the police), for the purpose(s) of:
 - (i) processing, handling and/or dealing with my claims including the settlement of the claims and any necessary investigations relating to the claims;
 - (ii) investigating the accident and/or my claims;
 - (iii) carrying out and/or dealing with my instructions or responding to any enquiries by me;
 - (iv) administering my claims (including the mailing of correspondence, statements, invoices, reports or notices to me, which could involve disclosure of certain personal data about me to bring about delivery of the same as well as on the external cover of envelopes/mail packages); and/or
 - (v) complying with applicable law in administering, processing, handling and/or dealing with my claims.
 (collectively the "Purposes");
 - (b) all insurer(s) who have insured vehicle(s) involved in this accident and the Insurers' lawyers/law firms, may be permitted to collect, use, disclose and/or process my Personal Information for one or more of the above Purposes; and
 - (c) my Personal Information may be disclosed by any of the Insurers and/or GIA to their third party service providers or agents (including their lawyers/law firms), which may be sited outside of Singapore, for one or more of the above Purposes.

Policyholder's Signature / Date & Time
 27/ 14.9.21
 4.38 pm

Driver's Signature (if driver is not the policyholder) / Date & Time

Witnessed by Reporting Centre Personnel

Sketch Plan

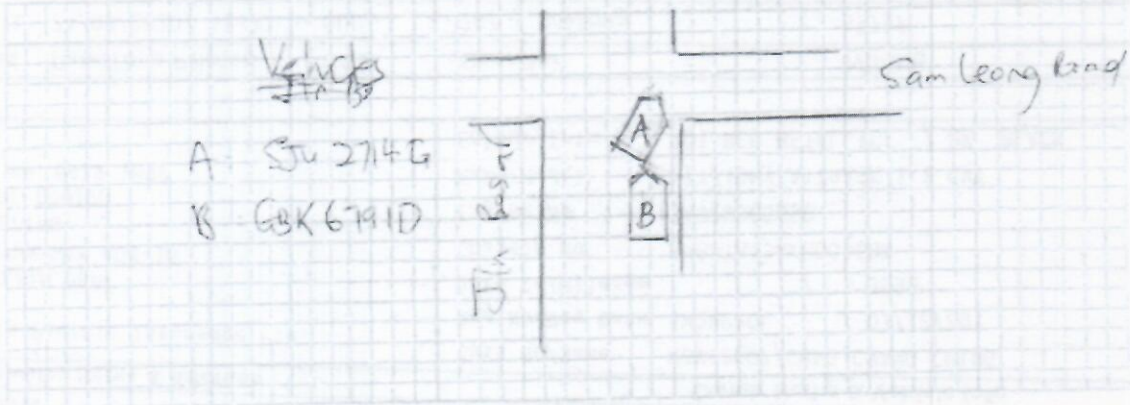

Describe Circumstances of the Accident

I (Vehicle A) was travelling along Jalan Besar, coming down from Bendemeer Road.

I had checked my blind spot and side mirrors and my surroundings. I spotted Vehicle B was parked stationary on the roadside on ~~the right~~ ^{the right} lane when I overtake him and I made a right turn into Sam Leong Road.

There was a sudden bang from behind my vehicle as I made my turning.

I stopped my vehicle at the side not to block traffic and got off my car.

Declaration

We declare the foregoing particulars are true in every respect.

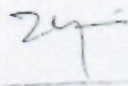
Policyholder's Signature / Date & Time
14.9.21
4.38 pm

Driver's Signature (if driver is not the policyholder) / Date & Time

Witnessed by Reporting Centre Personnel

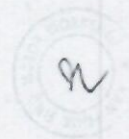

[> Back to OneMotoring](#)**Enquire PARF/COE Rebate for Registered Vehicle****Vehicle Owner Particulars**

Owner ID Type: Singapore NRIC
Owner ID: 380E

Vehicle Details

Vehicle No.: SJU2714G
Vehicle to be Exported: No
Intended Deregistration Date: 21 Sep 2021
Vehicle Make: MAZDA
Vehicle Model: MAZDA3 1.6L SDN LUX
Primary Colour: Silver
Manufacturing Year: 2009
Engine No.: Z6817093
Chassis No.: JM6BL10Z1A0117827
Maximum Power Output: 77.0 kW (103 bhp)
Open Market Value: \$21,684.00
Original Registration Date: 25 Nov 2009
First Registration Date: 25 Nov 2009
Transfer Count: 3
Actual ARF Paid: \$21,684.00

Intended PARF Rebate Details

PARF Eligibility: Forfeited
PARF Eligibility Expiry Date: -
PARF Rebate Amount: \$0.00

Intended COE Rebate Details

COE Expiry Date: 24 Nov 2024
COE Category: A - Car (1600cc & below)
COE Period(Years): 5
PQP Paid: \$16,208.00
COE Rebate Amount: \$10,292.00
Total Rebate Amount: \$10,292.00

Message

Please note that the 5-year COE for this vehicle cannot be further renewed. The vehicle must be de-registered upon COE expiry or when the vehicle reaches its statutory lifespan (if applicable), whichever is earlier.

The information contained herein is correct as at 21 Sep 2021

OK

**Mazda 3 1.6A SP (COE till 02/2024)****\$17,800**

\$7,380 /yr

19-Feb-2009

1,598 cc

Sedan

Available

Full Loan Available, Flexible Loan Scheme, Carbon Fibre Bonnet, Sunline Exhaust, Very Well Maintained, Perfect Car For A Short Term Drive, The Only One In The Market With Bonnet And Exhaust, Call Now And Enquire More On The Promotions.

Posted: 13-Sep-2021 Tags: 2009 Mazda 3, Mazda 3, Mazda, 3

**Mazda 3 1.6A Luxury (COE till 08/2024)****\$21,800**

\$7,460 /yr

24-Aug-2009

1,598 cc

125,500 km

Sedan

Available

Consignment Code B571. Well Maintained By Owner. Car In Good Condition And Clean. New Wheel Bearing, New Wheel Drive Axle, New Brake Switch, New Battery. Flexible And Attractive Loan Available. Trade-In Available For Your Car! No Hidden Costs. For Further Inform...

Posted: 30-Aug-2021 Tags: 2009 Mazda 3, Mazda 3, Mazda, 3

CONSIGNMENT

**Mazda 3 HB 1.6A Luxury (COE till 06/2024)****\$21,800**

\$7,850 /yr

24-Aug-2009

1,598 cc

Hatchback

Available

Good Condition, Bank Loan And In House Loan Available, Trade In Welcome, Call/WhatsApp Us For More Information And Viewing.

360 VR Cars

Posted: 19-Jul-2021 Tags: 2009 Mazda 3, Mazda 3, Mazda, 3

**Mazda 3 1.6A Luxury (COE till 09/2024)****\$22,888**

\$7,570 /yr

29-Sep-2009

1,598 cc

157,088 km

Sedan

Available

New Gearbox. With Receipt To Prove. New Paintwork. No Further Repair Needed. Immaculate Condition. Clean And Beautiful, View To Believe. Don't Miss It, Call Today For Viewing Appointment Before It's Gone.

Posted: 17-Sep-2021 Tags: 2009 Mazda 3, Mazda 3, Mazda, 3

PREMIUM AD

ADVERTISING

**Mazda 3 1.6A Luxury (COE till 10/2024)****\$20,800**

\$6,710 /yr

28-Oct-2009

1,598 cc

165,000 km

Sedan

Available

2nd Owner, Low Mileage Done, No Repair Needed As Most Of The Wear And Tears Been Replaced, Leather Seats, Sports Rims, Factory Integrated Audio, Auto Retractable Side Mirrors, Multi- Function Steering Controls. Bank Or Inhouse Loan Available.

Posted: 18-Sep-2021 Tags: 2009 Mazda 3, Mazda 3, Mazda, 3

**Mazda 3 1.6A Luxury (COE till 11/2029)****\$49,000**

\$5,990 /yr

23-Nov-2009

1,598 cc

Sedan

Available

Good Condition. 2 Owners. First And Second Owner Friends Can Tell You History Of Car From Day 1. Accident Free. Can Help You With Loan Application. Flexible Viewing Timing.

Posted: 06-Sep-2021 Tags: 2009 Mazda 3, Mazda 3, Mazda, 3

DIRECT OWNER

**Mazda 3 1.6A Luxury (COE till 10/2029)****\$48,888**

\$6,020 /yr

15-Dec-2009

1,598 cc

142,300 km

Sedan

Available

Door Step Viewing Available! Excellent Condition, Low Mileage, Fuel Efficient, Very Well Maintained, No Repairs Needed, Accident Free! Flexible Up To 100% In House/Bank Loan/High Trade In Available! Must View To Appreciate!

Posted: 20-Sep-2021 Tags: 2009 Mazda 3, Mazda 3, Mazda, 3

**Mazda 3 1.6A Luxury (COE till 12/2024)****\$25,800**

\$7,970 /yr

17-Dec-2009

1,598 cc

130,300 km

Sedan

Available

2 Owners Only. One Of The Most Economical Car In The Market. Low Depreciation. Smooth And Perfect Drive Till End Of COE. No Repairs Needed. Very Well Taken Care COE Car. Large Boot. 55L Fuel Tank. Flexible Banks And In House Loan Plans And High Trade In Availabl...

Posted: 14-Sep-2021 Tags: 2009 Mazda 3, Mazda 3, Mazda, 3

PREMIUM AD