

ASS. REC. BY:

REF:

ASSIGNMENT

From: _____ Date: _____

Estimated Cost: _____

OD / TP / WS / TP RES / OD RES / EVA / INV / MV

To Inspect Vehicle No: _____

at Workshop m/s _____

of _____

Insured: _____

Policy No. _____

Claims No. _____

Sum Insured: _____ Excess: _____

(Client's Record)

Make of Veh: _____

(Policy Condition)

Remark: The veh had commenced its
repair at the time of inspection.

N/S	O/S

Bal. or Market Value: _____

IDAC Accident Rpt: _____ Consistent? : Yes or No

GIA / PR Seen: _____ Consistent? : Yes or No

Est. Repairs: _____ days Res.: Yes or No

Lum Sum: _____ % 3 Val.: Yes or No

CA / REV / REP. / 24 HRS

Vehicle: IN / OUT

Date: _____ Person Contacted: _____

Veh No:

GBD 9869G

Yr Regn:

2015 August

Type: M.Car / M.Cycle / Bus / Van / Lorry / Taxi / Prime Mover /

Truck / Trailer or

Make:

Nissan NV350

c.c

2488

Colour

Grey

A/C:

Insured / Std / NI / NA

Sp. Reading

187355

T/Radio:

Insured / Std / NI / NA

Eng/No:

JN1MC2E2620004798

C/No:

Gen. Cond: Good / Fair / Poor / BurntSteering: Inorder / Jammed / Leaked / Burnt orBrake: Inorder / Jammed / Leaked / Burnt orModi: Nil / S/Rim / STD A/Rim or

Tyre Size:

F:

195R15C

R:

195R15C

BS / DUN / EXNOVA / GY / FS / LIZA / MIC / OHTSU / PIR / SUMI /

TOYO / YOKO or

Front

Rear

R/Bal.

06

mm

R/Bal.

06

mm

L/Bal.

06

mm

L/Bal.

06

mm

D.O.A.

D.O.I.

26/08/21

Survey held at

Kai Motor.

Des. of Damages: Frt / Rear / O/S / N/S / U/C / Rooftop or

The U/C / Chassis frame / Body Structure affected due to collision.

Date / Time

Action / Instruction

TP EQ.

MV: 33K

PV: 16.4K

Nett: 16.6K.

Date/Time, File Pass to?

☐

Preli. Report

1)

Date/Time, File Return to?

☐

Final Report

2)

Days Of Repair: _____

Resurvey No. of Trip: _____

Survey Fee:

Transportation:

3 + RS, SI

Photos

Others

Add Fee:

☐

Site Insp (\$)

☐

Interview (\$)

☐

Tech. Invs (\$)

☐

Weekend (\$)

Report Format: _____

Lump Sum / L&L: (\$)

SINGAPORE ACCIDENT STATEMENT

IMPORTANT NOTICE

1. Please report correctly the details of the accident to speed up the claims process.
2. This Form must be completed by the Policyholder and/or the Authorised Driver
3. Information provided must be as truthful and accurate as possible. Any wilful misrepresentation or withholding of material facts may allow insurance companies to repudiate policy liability.
4. The issue and acceptance of this Form by insurance companies is not an admission of policy liability on the part of the insurance companies.
5. Any false reporting may be referred to the Police for investigation.
6. This report will be forwarded by the insurers of the GIA Records Management Centre established by the General Insurance Association of Singapore (GIA) for archiving and that copies of this report will, for a fee, be made available upon application by interested parties.
7. By the lodgement of this report to the insurers, you hereby consent to the archiving of this report at the centre and to copies of the report being made available aforesaid.

ACCIDENT STATEMENT

Date of Submission	23/08/2021 15:19 (SGT)
Date of Accident	20/08/2021 08:20 (SGT)
Exact Location of Accident	Airport Rd, Singapore
Additional Location Information	-
Country/State of Loss	Singapore

DETAILS OF OWN VEHICLE

Vehicle Registration Number	GBD9869G
-----------------------------	----------

INSURED/POLICYHOLDER

Is company?	Yes
Name Of Registered Owner	SAFETECH DEVICES PTE. LTD.
Company Reg No	200405277H
Email Address	jenny@safetech.com.sg
Mobile Phone No	(Phone) +65-90225247
Alternative Phone No	(Office) +65-67455455

VEHICLE PARTICULARS

Manufacturer	Nissan
Model	Nv350
Variant	-
Exact purpose for which vehicle was being used at time of accident	Employment
Are you claiming under your own insurance policy for repair to your vehicle?	No - Claiming third party
Vehicle Category	Commercial vehicle
Transmission	Manual
CC	2488

INSURANCE COMPANY

Name of Insurance Company	India International Insurance Pte Ltd
Type of Coverage	Comprehensive
Fleet Policy	No
Policy Number	D21MCV0005034
Cover Note Number	-

DRIVER

Date Of Birth	09/02/1992
Occupation	Outdoor
Date Of Driving Pass	05/05/2018
Driving experience	3 YEARS AND 3 MONTHS
Gender	Male
Mobile Number	(Phone) +65-90225247
Alt. Phone Number	-
Email Address	andrewchuah92@gmail.com
Address	BLK 667 HOUGANG AVENUE 4 #06-331
Address complement	-
Postcode	530667
Is the driver the policyholder?	No
If No, Relationship of the Driver with the Insured	Employee
Does Driver Own Other Vehicles?	No
Vehicle Registration Number of Other Vehicle Owned by Driver	-
Insurance Company of Other Vehicle Owned by Driver	-

GENERAL INFORMATION OF THE ACCIDENT

Type of Accident	Collision - Head to Rear
Weather Conditions	Raining
Road Surface	Wet

OTHER INFORMATION

Was any foreign vehicle involved in the accident?	No
Number of vehicles involved in the accident	2
Was anybody injured in the Accident?	No
Was any injured conveyed to hospital by ambulance?	-
Was any other vehicle or property damaged?	Yes
Number of Passengers (Including Driver)	2
Has the driver been approached by unknown person(s) soliciting/offering accident claims assistance?	No

PASSENGER 1

Name	LEE SHEAU MIN
Gender	Female

DETAILS OF POLICE ACTION

Was the accident reported to the police?	No
Was notice of intended Prosecution given?	No
If yes, against whom?	-

CIRCUMSTANCES OF ACCIDENT

PLEASE REFER TO SKETCH PLAN

ATTACHMENT(S)

Are accident photos available for attachment?	Yes
Was there any video captured by Car Camera?	No
Was there any audio recorded?	No

DETAILS OF OTHER VEHICLE PROPERTY 1

Vehicle Registration Number	GBF8436T
Vehicle Manufacturer	-
Vehicle Model	-
Vehicle Variant	-

(E07)

Name of Driver	XIE AIMIN
Passport No/FIN	G8265730X
Contact Number	(Phone) +65-83685263
Address	-
Address complement	-
Postcode	-
Insurance Company Name	-
Nature Of Damage	-
Details of property damaged in accident	-
No. Of Passenger (Including Driver)	-

Describe Circumstances of the Accident

I was travelling straight along Airport Road on the 3rd lane of A4-lane road. When approaching the traffic light zone I stop my veh when the light change amber. Suddenly veh B came from behind hit onto my rear portion of my veh.

Declaration

We declare the foregoing particulars are true in every respect.



Policyholder's Signature / Date & Time

Driver's Signature (If driver is not the policyholder) / Date & Time

Witnessed by Reporting Centre Personnel

SKETCH PLAN

IMPORTANT NOTICE

1. Please report correctly the details of the accident to speed up the claims process.
2. This Form must be completed by the Policyholder and/or the Authorised Driver.
3. Information provided must be as truthful and accurate as possible. Any willful misrepresentation or withholding of material facts may allow insurance companies to repudiate policy liability.
4. The issue and acceptance of this Form by insurance companies is not an admission of policy liability on the part of the insurance companies.
5. Any false reporting may be referred to the Police for investigation.
6. The report will be forwarded by the insurers of the GIA Records Management Centre established by the General Insurance Association of Singapore (GIA) for archiving and that copies of this report will for a fee be made available upon application by interested parties.
7. By the lodgement of this report to the insurers, you hereby consent to the archiving of this report at the centre and to copies of the report being made available aforesaid.
8. **Consent under the Personal Data Protection Act (PDPA)**
I understand, acknowledge, agree and consent that:
(a) My insurer, my workshop and the General Insurance Association of Singapore ("GIA") may/are permitted to collect, use, disclose and/or process my personal data/personal information set out in this [form] and any other personal information provided by me or possessed by my insurer (collectively the "Personal Information") and disclose and transfer such Personal Information to all insurer(s) who have insured vehicle(s) involved in this accident (all insurer(s) who have insured vehicle(s) involved in this accident shall be collectively referred to as the "Insurers"), the Insurers' lawyers/law firms, the Monetary Authority of Singapore and any relevant government agency/authority (such as the police), for the purpose(s) of:
(i) processing, handling and/or dealing with my claims including the settlement of the claims and any necessary investigations relating to the claims;
(ii) investigating the accident and/or my claims;
(iii) carrying out and/or dealing with my instructions or responding to any enquiries by me;
(iv) administering my claims (including the mailing of correspondence, statements, invoices, reports or notices to me, which could involve disclosure of certain personal data about me to bring about delivery of the same as well as on the external cover of envelopes/mail packages); and/or
(v) complying with applicable law in administering, processing, handling and/or dealing with my claims.
(collectively the "Purposes")
(b) all insurer(s) who have insured vehicle(s) involved in this accident and the Insurers' lawyers/law firms, may/are permitted to collect, use, disclose and/or process my Personal Information for one or more of the above Purposes; and
(c) my Personal Information may/can be disclosed by any of the Insurers and/or GIA to their third party service providers or agents (including their lawyers/law firms), which may be sited outside of Singapore, for one or more of the above Purposes.



Policyholder's Signature / Date & Time

Sketch Plan

Driver's Signature (If driver is not the policyholder) / Date & Time

Witnessed by Reporting Centre Personnel

KDE

MALPHERCON

A - GBD98694
B - GBF84367

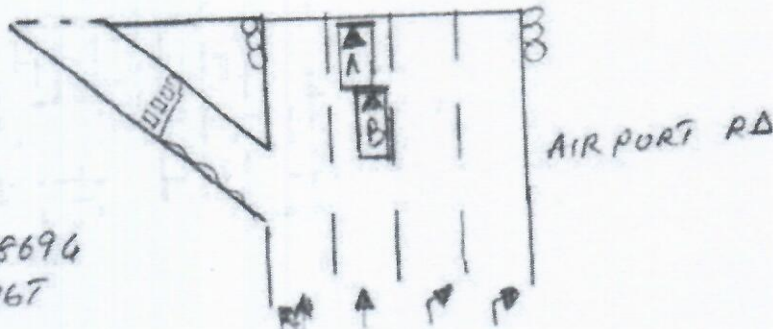

> [Back to OneMotoring](#)

Enquire PARF/COE Rebate for Registered Vehicle

Vehicle Owner Particulars	
Owner ID Type:	Company
Owner ID:	277H
Vehicle Details	
Vehicle No.:	GBD9869G
Vehicle to be Exported:	No
Intended Deregistration Date:	26 Aug 2021
Vehicle Make:	NISSAN
Vehicle Model:	NV350 PANEL VAN 2.5 5MT 5DR EURO V
Primary Colour:	Grey
Manufacturing Year:	2015
Engine No.:	YD25376045A
Chassis No.:	JN1MC2E26Z0004798
Maximum Power Output:	-
Open Market Value:	\$22,176.00
Original Registration Date:	08 Aug 2015
First Registration Date:	08 Aug 2015
Transfer Count:	0
Actual ARF Paid:	\$1,109.00
Intended PARF Rebate Details	
PARF Eligibility:	No
PARF Eligibility Expiry Date:	-
PARF Rebate Amount:	\$0.00
Intended COE Rebate Details	
COE Expiry Date:	07 Aug 2025
COE Category:	C - Goods Vehicle & Bus
COE Period(Years):	10
PQP Paid:	\$41,480.00
COE Rebate Amount:	\$16,380.00
Total Rebate Amount:	\$16,380.00

The information contained herein is correct as at 26 Aug 2021

OK

**Nissan NV350 2.5M****\$33,800**

\$8,700 /yr

15-Jul-2015

2,488 cc

Van

Available**Fuel Type:** Diesel

Nice Double Digit Registration Number "GZ58P". Well Maintained 5 Door Van. Brand New 2K Paintwork Done Up. Bank/ In-house Loan Available. Trade In Welcome.

Posted: 13-Aug-2021 Tags: 2015 Nissan NV350, Nissan NV350, Nissan, NV350

**Nissan NV350 2.5M****\$33,800**

\$8,670 /yr

20-Jul-2015

2,488 cc

Van

Available**Fuel Type:** Diesel

1 Owner Only Unit! Promo 3 Month Warranty Guaranteed With Free Servicing! New Paintwork And Leather Seat Refurbished For Hygiene Purposes And Quality Of Our Product. Cash Or Higher Loan Is Possible. Call/Whatsapp Our Friendly Sales Handphone Number Now For...

Car (S) Pte Ltd

Posted: 16-Aug-2021 Tags: 2015 Nissan NV350, Nissan NV350, Nissan, NV350

**Nissan NV350 2.5M****\$35,800**

\$9,180 /yr

20-Jul-2015

2,488 cc

80,000 km

Van

Available**Fuel Type:** Diesel

1 Owner, Low Mileage, Full Loan Available, New Company Welcome, Full Size Van Suitable For Delivery Etc. Call Now For More Details.

Posted: 14-Aug-2021 Tags: 2015 Nissan NV350, Nissan NV350, Nissan, NV350

**Nissan NV350 2.5M****\$35,800**

\$9,180 /yr

20-Jul-2015

2,488 cc

85,000 km

Van

Available**Fuel Type:** Diesel

1 Owner, Low Mileage, Full Loan Available, New Company Welcome, Full Size Van Suitable For Delivery, Low Monthly, Call Now For More Details.

Posted: 29-Jul-2021 Tags: 2015 Nissan NV350, Nissan NV350, Nissan, NV350

**Stand out with a bidded car plate number!**

Bring luck and prosperity with an auspicious car licence plate number starting from only \$2,3xx! Single digit and lucky numbers available right here!

Find out more!

**Nissan NV350 2.5M****\$34,800**

\$8,690 /yr

27-Aug-2015

2,488 cc

90,000 km

Van

Available**Fuel Type:** Diesel

1 Owner, Low Mileage, New Company Welcome, Full Size Van Suitable For Delivery. Servicing Regularly. Well Kept Condition. Full Loan Available.

Starise Automobile

Posted: 15-Aug-2021 Tags: 2015 Nissan NV350, Nissan NV350, Nissan, NV350

**Nissan NV350 2.5M****\$34,800**

\$8,680 /yr

29-Aug-2015

2,488 cc

99,000 km

Van

Available**Fuel Type:** Diesel

Posted: 21-Jul-2021 Tags: 2015 Nissan NV350, Nissan NV350, Nissan, NV350

**Nissan NV350 2.5M****\$33,800**

\$8,380 /yr

07-Sep-2015

2,488 cc

Van

Available**Fuel type:** Diesel

Deals Up For Grab! 1 Owner Only Unit. Well Maintain Interior With Rear Carpet Floorboard. New Paintwork Done And Servicing All Done Up. Drive Away With A Piece Of Mind. Don't Miss This Opportunity To Own This Workhorse. Flexible Loan Plans Up To 100% Loan Availa...

Ezy-1 Pte Ltd

Posted: 26-Aug-2021 Tags: 2015 Nissan NV350, Nissan NV350, Nissan, NV350

**Nissan NV350 2.5M****\$35,800**

\$8,820 /yr

16-Sep-2015

2,488 cc

Van

Available**Fuel Type:** Diesel

Only 1 Owner Previously. All Wear And Tear Done Up. Cargo Area Comes With Wooden Plank And Carpet. Kindly Contact Our Sales Person For Test Drive And Viewing.

Posted: 11-Aug-2021 Tags: 2015 Nissan NV350, Nissan NV350, Nissan, NV350

**Nissan NV350 2.5M****\$36,800**

\$8,980 /yr

30-Sep-2015

2,488 cc

47,303 km

Van

Available**Fuel Type:** Diesel

3 Months Engine & Gearbox Warranty! 1 Owner, Servicing Done At Agent. Genuine Low Mileage! New Paintwork! Guaranteed In Tip Top Condition With No Repairs Needed! Flexible Financing Up To 100% With Fast Approvals! Highest Trade In Quote Given! Whatsapp / Call...

Car (S) Pte Ltd

Posted: 16-Aug-2021 Tags: 2015 Nissan NV350, Nissan NV350, Nissan, NV350

Nissan NV350 2.5M**\$35,388**

\$8,630 /yr

02-Oct-2015

2,488 cc

Van

Available**Fuel Type:** Diesel

id Flexible Finance Options Available. Contact Our Professional Sales Team Now For More Information.