

NATIONAL Assessment Centre Services

Date In: 24/06/21	Job description	Date & Time Completed	Done by
Ref No: NA/CTE21006990/13	SAS e-filing		
Veh No: GBJ9947H	E-mail (within 8hrs, AP: 2hrs)		
D.O.A: 14/06/21 1100	i-Motor Claim Form		
OD (TP) Reporting Only	i-Motor W/O (Within: OD 2hrs, TP 4hrs)		
	i-Photo Uploaded		
TP Insurer:	Assessment/Survey Report		
	Ass't Report by Fax / Hand to Owner/Wksp		

Preferred Wksp / INC Assign Wksp / QW: (Tel:	Fax:
TP Particulars:	Veh No: SKP3215	INC () / Non-INC ()
Owner / Driver: (Tel:	
Policy No: ()	Period: ()	Cover Type: ()
Confirmed by: (Date:	Time:
Insured/Driver Liability: (%)	[Note-Est. Status (WO): N: 0-20%; P: 21-79%; F: 80-100%]	
Year of Registration: ()	Warranty: YES () / NO ()	
Excess: (\$)	Loading: \$1,000 () / \$2,000 ()	

General Remarks:-

() Walk-In Customer : Customer's information strictly Confidential & Strictly NO refer of repairer.

() Total Loss Case : to e-mail Insurer URGENTLY.

Drive-In () / Towed-In () ; Invoice: YES () / NO () ; Towing Co. ()

Remarks:- (INC hotline: 6788 6616)	Date & Time Completed	Done by
1) Apply for Transport Allowance () / Courtesy Car ()		
2) QC Check / Post Repair Inspection ()		
3) Upload Resurvey Photo [Repair Cost > \$3000] ()		

Injury : _____

Date/Time	Actions

NA2103303	Invoice Preparation Checklist	Amt (\$)	Amt (\$)
Claimant's Particulars :-	1) AR : Accident Reporting (\$30);	1st Bill	Add Bill
Driver/Owner:	2) DA : Damage Assessment (\$100); INC (\$80)		
Contact No:	3) TF : Towing Fee \$40/\$45		
Damaged Portion:	4) FT : Follow-Through Survey \$120		
QC Checked by (Engr-In-Charge):	5) RT : Follow-Through Survey (Resurvey) \$30		
Auditors' Comments :-	For claiming against INC Only (wef 10 Jan 2005)		
Cat. 1:	6) TR : Re-inspection \$75		
Cat. 2 / 3:	7) N1 : Idac DA + SMRT Survey \$160		
	8) NTUC Additional Services:-		
	OD*		
	*N5: Courtesy Car / Tpt Allowance \$5		
	*N6: Repair Co-ordination \$10		
	*N7: Post Repair Inspection \$25		
	*N8: DV / Collect Excess Coordination \$5		
	TP (N11) : TP (Non INC) against INC \$20		
	9) N12: Idac Mobile 30		

Invoice dated	Fee Charged
Invoice dated	Fee Charged

SINGAPORE ACCIDENT STATEMENT

IMPORTANT NOTICE

1. Please report correctly the details of the accident to speed up the claims process.
2. This Form must be completed by the Policyholder and/or the Authorised Driver
3. Information provided must be as truthful and accurate as possible. Any wilful misrepresentation or withholding of material facts may allow insurance companies to repudiate policy liability.
4. The issue and acceptance of this Form by insurance companies is not an admission of policy liability on the part of the insurance companies.
5. Any false reporting may be referred to the Police for investigation.
6. This report will be forwarded by the insurers of the GIA Records Management Centre established by the General Insurance Association of Singapore (GIA) for archiving and that copies of this report will, for a fee, be made available upon application by interested parties.
7. By the lodgement of this report to the insurers, you hereby consent to the archiving of this report at the centre and to copies of the report being made available aforesaid.

ACCIDENT STATEMENT

Date of Submission	24/06/2021 11:53 (SGT)
Date of Accident	14/06/2021 11:00 (SGT)
Exact Location of Accident	Thomson Rd, Singapore
Additional Location Information	-
Country/State of Loss	Singapore

DETAILS OF OWN VEHICLE

Vehicle Registration Number	GBJ9947H
-----------------------------	----------

INSURED/POLICYHOLDER

Is company?	Yes
Name Of Registered Owner	RI SHEN SERVICES PTE LTD
Company Reg No	3XXXX600E
Email Address	BKUJUNHAO@GMAIL.COM
Mobile Phone No	(Phone) +65-97380060
Alternative Phone No	+65-97380060

VEHICLE PARTICULARS

Manufacturer	Toyota
Model	Hiace
Variant	-
Exact purpose for which vehicle was being used at time of accident	Employment
Are you claiming under your own insurance policy for repair to your vehicle?	No - Claiming third party
Vehicle Category	Commercial vehicle
Transmission	Manual
CC	2982

INSURANCE COMPANY

Name of Insurance Company	China Taiping Insurance (Singapore) Pte. Ltd.
Type of Coverage	Comprehensive
Fleet Policy	No
Policy Number	DMCVSNW00107152000
Cover Note Number	-

DRIVER

Name of Driver	BRANDON KU JUN HAO
NRIC No	SXXXX208Z

Date Of Birth	20/11/1992
Occupation	Outdoor
Date Of Driving Pass	01/01/2013
Driving experience	8 YEARS AND 5 MONTHS
Gender	Male
Mobile Number	(Phone) +65-92222663
Alt. Phone Number	-
Email Address	BKUJUNHAO@GMAIL.COM
Address	1 BUTTERWORTH LANE
Address complement	#12-04
Postcode	439444
Is the driver the policyholder?	No
If No, Relationship of the Driver with the Insured	Employee
Does Driver Own Other Vehicles?	No
Vehicle Registration Number of Other Vehicle Owned by Driver	-
Insurance Company of Other Vehicle Owned by Driver	-

GENERAL INFORMATION OF THE ACCIDENT

Type of Accident	Side Swipe
Weather Conditions	Clear
Road Surface	Dry

OTHER INFORMATION

Was any foreign vehicle involved in the accident?	No
Number of vehicles involved in the accident	2
Was anybody injured in the Accident?	No
Was any injured conveyed to hospital by ambulance?	-
Was any other material or property damaged?	Yes
Number of Passengers (Including Driver)	0
Has the driver been approached by unknown person(s) soliciting/offering accident claims assistance?	No

DETAILS OF POLICE ACTION

Was the accident reported to the police?	No
Was notice of intended Prosecution given?	No
If yes, against whom?	-

CIRCUMSTANCES OF ACCIDENT

PLS REFER TO THE ATTACHED STATEMENT.

ATTACHMENT(S)

Are accident photos available for attachment?	Yes
Was there any video captured by Car Camera?	No
Was there any audio recorded?	No

DETAILS OF OTHER VEHICLE PROPERTY 1

Vehicle Registration Number	SKP321J
Vehicle Manufacturer	-
Vehicle Model	-
Vehicle Variant	-
Vehicle Colour	-
Vehicle Category	Private car
Name of Driver	-
Contact Number	-
Address	-
Address complement	-

Postcode	-
Insurance Company Name	-
Nature Of Damage	-
Details of property damaged in accident	-
No. Of Passenger (Including Driver)	-

SKETCH PLAN

IMPORTANT NOTICE

1. Please report correctly the details of the accident to speed up the claims process.
2. This Form must be completed by the Policyholder and/or the Authorised Driver.
3. Information provided must be as truthful and accurate as possible. Any wilful misrepresentation or withholding of material facts may allow insurance companies to repudiate policy liability.
4. The issue and acceptance of this Form by insurance companies is not an admission of policy liability on the part of the insurance companies.
5. Any false reporting may be referred to the Police for investigation.
6. The report will be forwarded by the Insurers of the GIA Records Management Centre established by the General Insurance Association of Singapore (GIA) for archiving and that copies of this report will for a fee be made available upon application by interested parties.
7. By the lodgment of this report to the insurers, you hereby consent to the archiving of this report at the centre and to copies of the report being made available aforesaid.
8. **Consent under the Personal Data Protection Act (PDPA)**

I understand, acknowledge, agree and consent that:

- (a) My insurer, my workshop and the General Insurance Association of Singapore ("GIA") may/are permitted to collect, use, disclose and/or process my personal data/personal information set out in this [form] and any other personal information provided by me or possessed by my insurer (collectively the "Personal Information") and disclose and transfer such Personal Information to all insurer(s) who have insured vehicle(s) involved in this accident (all insurer(s) who have insured vehicle(s) involved in this accident shall be collectively referred to as the "Insurers"), the Insurers' lawyers/law firms, the Monetary Authority of Singapore and any relevant government agency/authority (such as the police), for the purpose(s) of:
 - (i) processing, handling and/or dealing with my claims including the settlement of the claims and any necessary investigations relating to the claims;
 - (ii) investigating the accident and/or my claims;
 - (iii) carrying out and/or dealing with my instructions or responding to any enquiries by me;
 - (iv) administering my claims (including the mailing of correspondence, statements, invoices, reports or notices to me, which could involve disclosure of certain personal data about me to bring about delivery of the same as well as on the external cover of envelopes/mail packages); and/or
 - (v) complying with applicable law in administering, processing, handling and/or dealing with my claims, (collectively the "Purposes")
- (b) all insurer(s) who have insured vehicle(s) involved in this accident and the insurers' lawyers/law firms; may/are permitted to collect, use, disclose and/or process my Personal Information for one or more of the above Purposes; and
- (c) my Personal Information may/can be disclosed by any of the Insurers and/or GIA to their third party service providers or agents (including their lawyers/law firms), which may be sited outside of Singapore, for one or more of the above Purposes.
- (d) my Personal Information will also be collected and used to compile claims history for the purpose of fraud detection, investigation and management in present and all future claims.
- (e) the information so collected under (d) above may be shared / disclosed:
 - (i) to all insurers and/or any other third parties that assist in evaluating, investigating, controlling or managing fraud, regulators, law enforcement and government agencies as reasonably required for the purposes stated, or
 - (ii) for complying with requirements under any regulations, laws or court orders.

Policyholder's Signature
Date & Time:

Driver's Signature
(If driver is not the policyholder)
Date & Time:

Reporting Centre Personnel's Signature
Name:
NRIC/FIN No.:

SKETCH PLAN

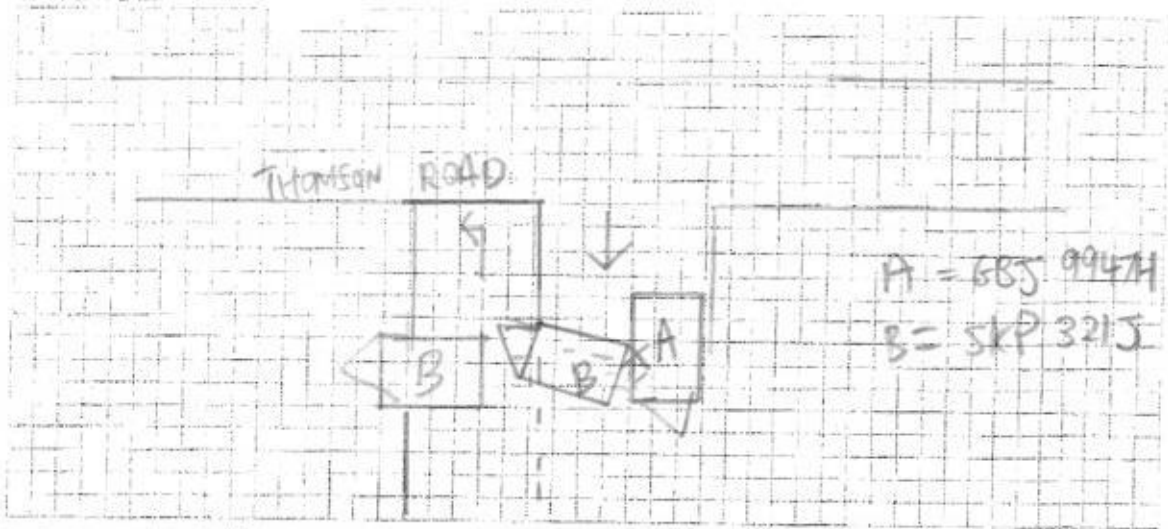

DESCRIBE CIRCUMSTANCES OF THE ACCIDENT

ON THE STATED TIME AND DATE, I WAS UNLOADING,
 OUT OF A SUDDEN, I HEARD A BANG. I WENT TO CHECK
 AND FOUND OUT THAT VEHICLE B REVERSE AND HIT UNTILL
 MY REAR RIGH FENDER.

DECLARATION

I/We declare the foregoing particulars are true in every respect.

Policyholder's Signature

Date & Time:

Driver's Signature

(If driver is not the policyholder)

Date & Time:

Reporting Centre Personnel's Signature

Name:

NRIC/FIN No.:

ACCIDENT STATEMENT

ACCIDENT DATE: 14 / 06 / 2021 (DD/MM/YYYY), TIME: 11 : 00 (HH:MM)LOCATION: THOMSON ROAD

1. DETAILS OF VEHICLE

- a) VEHICLE NUMBER: GBS 9947 H
 b) INSURANCE COMPANY: CHINA TAIPIING
 c) POLICY NUMBER: DMCVSNW00107152000
 d) POLICY TYPE: (COMPREHENSIVE / THIRD PARTY / THIRD PARTY FIRE & THEFT)
 e) MAKE & MODEL: TOYOTA HIACE
 f) TYPE: (SALOON / COUPE / MPV / VAN / LORRY / MOTORCYCLE / OTHERS)
 g) VEHICLE CATEGORY: (PRIVATE / COMMERCIAL / MOTORCYCLE)
 h) PURPOSE OF USING AT ACCIDENT TIME: WORK
 i) ARE YOU CLAIMING UNDER YOUR OWN INSURANCE (YES / NO)
 IF NO, PLEASE STATE (THIRD PARTY CLAIM / REPORTING ONLY)

2. INSURED / POLICY HOLDER

- A) NAME: RISHEN SERVICES PTE LTD (MALE / FEMALE)
 b) NRIC/FIN/PASSPORT: 39356600E CONTACT: 9738 0060
 c) ADDRESS: 444 Beijing Road S(379452)

* CONTINUE TO 3.d IF DRIVER ALSO POLICY HOLDER

DRIVER

- a) NAME: BRANDON KU JUN HAO (MALE / FEMALE)
 b) NRIC/FIN/PASSPORT: S9244208Z CONTACT: 92222663
 c) ADDRESS: 1 BUTTERWORTH LANE #12-04
SINGAPORE 439444

* d) DATE OF BIRTH: 20 / 11 / 1992 (DD/MM/YYYY)e) OCCUPATION: (INDOOR / OUTDOOR)f) YEARS OF DRIVING EXPERIENCE: 8 YEARS

4. WAS DRIVER AN EMPLOYEE OF THE INSURED'S COMPANY? (YES / NO)
 IF NO, RELATIONSHIP OF THE DRIVER WITH INSURED: _____

5. a) WEATHER CONDITION: (CLEAR / RAINING / OTHERS)
 b) ROAD SURFACE: (DRY / WET / OTHERS)

6. WAS ANYBODY INJURED (YES / NO)

7. a) REPORTED TO POLICE (YES / NO)

IF YES, PLEASE STATE WHICH POLICE STATION: _____

8. THIRD PARTY VEHICLE

- a) VEHICLE NUMBER: SKP 321 J MODEL: _____
 b) DRIVER'S NAME: _____
 c) NRIC/FIN/PASSPORT: _____ CONTACT: _____

9. THIRD PARTY VEHICLE

- d) VEHICLE NUMBER: _____ MODEL: _____
 e) DRIVER'S NAME: _____
 f) NRIC/FIN/PASSPORT: _____ CONTACT: _____

Email = BRUNJUNHAO@gmail.com

Fax = _____



中国太平
CHINA TAIPING

中国太平保险(新加坡)有限公司
CHINA TAIPING INSURANCE (SINGAPORE) PTE. LTD.

Motor Commercial

MZ300/C

N SN

AN0576A

Cov. Type: C

CERTIFICATE OF INSURANCE

Motor Vehicles (Third-Party Risks and Compensation) Act (Chapter 189)
Motor Vehicles (Third-Party Risks and Compensation) Rules, 1980
Road Transport Act, 1987 (Malaysia)
Motor Vehicles (Third-Party Risks) Rules, 1959 (Malaysia)

CERTIFICATE No.

DMCVSNW00107152000

Engine No.: 1GD8382179

Chassis No.: GDH2012004958

1. Index Mark and Registration
Number of Vehicle

GBJ9947H

AUTOSAFE

2. Name of Policy Holder

RI SHEN SERVICES PTE LTD

3. Effective date of the Commencement of
Insurance for the purposes of the Regulations,
Ordinance or Enactment

04/11/2020

Excess Sect I : S\$500.00
EX ON WINDSCREEN : S\$100.00

4. Date of Expiry of Insurance

03/11/2021

5. Persons or Classes of Persons entitled to drive*

Any person who is driving on the Policyholder's order or with their permission.

Provided that the person driving is permitted in accordance with the licensing or other laws or regulations to drive the Motor Vehicle or has been so permitted and is not disqualified by order of a Court of Law or by reason of any enactment or regulation in that behalf from driving the Motor Vehicle.

6. Limitations as to use*

- (1) Use in connection with the Policyholder's business.
- (2) Use for the carriage of passengers (other than for hire or reward) in connection with the Policyholder's business.
- (3) Use for social, domestic or pleasure purposes.

The Policy does not cover:

- (1) Use for hire or reward or racing, pace-making, reliability trial or speed testing.
- (2) Use whilst drawing a trailer except the towing of any one disabled mechanically propelled vehicle.

HIRE PURCHASE CO.: UNITED OVERSEAS BANK LIMITED

* Limitations rendered inoperative by Section 8 of the Motor Vehicles (Third-Party Risks and Compensation) Act (Chapter 189) and Section 95 of the Road Transport Act 1987 (Malaysia), are not to be included under these headings.

I/We hereby Certify that the policy to which this Certificate relates is issued in accordance with the provisions of the Motor Vehicles (Third-Party Risks and Compensation) Act (Chapter 189) and Part IV of the Road Transport Act, 1987 (Malaysia).

Please see reverse

For CHINA TAIPING INSURANCE (SINGAPORE) PTE. LTD.

Issued By:

MARKETING AGENCY

Authorised Officer

Authorised Signatory