

NATIONAL Assessment Centre Services

Date In: 23/06/21	Job description	Date & Time Completed	Done by
Ref No: NA/CTI21006939/12	SAS e-filing		
Veh No: SMG8298P	E-mail (within 8hrs, MT, 2hrs)		
DOA 22/06/21 0925	i-Motor Claim Form		
OD (TP) Reporting Only	i-Motor W/O (Within: OD 2hrs, TP 4hrs)		
TP Insurer:	i-Photo Uploaded		
	Assessment/Survey Report		
	Ass't Report by Fax / Hand to Owner/Wksp		

Preferred Wksp / INC Assign Wksp / QW: () Tel: () Fax: ()

TP Particulars: Veh No: SMT9371K INC () / Non-INC ()

Owner / Driver: () Tel: ()

Policy No: () Period: () Cover Type: ()

Confirmed by: () Date: () Time: ()

Insured/Driver Liability: () % [Note-Est. Status (WO): N: 0-20%, P: 21-79%, F: 80-100%]

Year of Registration: () Warranty: YES () / NO ()

Excess: (\$) Loading: \$1,000 () / \$2,000 ()

General Remarks:-

() Walk-In Customer: Customer's information strictly Confidential & Strictly NO refer of repairer.

() Total Loss Case : to e-mail Insurer URGENTLY.

Drive-In () / Towed-In () ; Invoice: YES () / NO () ; Towing Co. ()

Remarks:- (INC hotline: 6788 6616)	Date & Time Completed	Done by
1) Apply for Transport Allowance () / Courtesy Car ()		
2) QC Check / Post Repair Inspection ()		
3) Upload Resurvey Photo [Repair Cost > \$3000] ()		

Injury : _____

Date/Time	Actions

NA2103280

Claimant's Particulars :-	Invoice Preparation Checklist	Amt (\$)	Amt (\$)
		1st Bill	Add Bill
Driver/Owner:	1) AR: Accident Reporting (\$30);		
Contact No:	2) DA: Damage Assessment (\$100); INC (\$80)		
Damaged Portion:	3) TF: Towing Fee \$40/\$45		
QC Checked by (Engr-In-Charge):	4) FT: Follow-Through Survey \$120		
Auditors' Comments :-	5) RT: Follow-Through Survey (Resurvey) \$30		
	For claiming against INC Only (wef 10 Jan 2005)		
Cat 1:	6) TR: Re-inspection \$75		
	7) NI: Idac DA + SMRT Survey \$160		
Cat 2/3:	8) NTUC Additional Services -		
	9) NI12: Idac Mobile 30		
	9) NI12: Idac Mobile 30		
	Invoice dated	Fee Charged	
	Invoice dated	Fee Charged	

SINGAPORE ACCIDENT STATEMENT

IMPORTANT NOTICE

1. Please report **correctly** the details of the accident to speed up the claims process.
2. This Form must be **completed by the Policyholder and/or the Authorised Driver**
3. Information provided must be as truthful and accurate as possible. Any willful misrepresentation or withholding of material facts may allow insurance companies to repudiate policy liability.
4. The issue and acceptance of this Form by insurance companies is not an admission of policy liability on the part of the insurance companies.
5. **Any false reporting may be referred to the Police for investigation.**
6. This report will be forwarded by the insurers of the GIA Records Management Centre established by the General Insurance Association of Singapore (GIA) for archiving and that copies of this report will, for a fee, be made available upon application by interested parties.
7. By the lodgement of this report to the insurers, you hereby consent to the archiving of this report at the centre and to copies of the report being made available aforesaid.

ACCIDENT STATEMENT

Date of Submission	23/06/2021 11:39 (SGT)
Date of Accident	22/06/2021 09:25 (SGT)
Exact Location of Accident	Tai Seng St, Singapore
Additional Location Information	-
Country/State of Loss	Singapore

DETAILS OF OWN VEHICLE

Vehicle Registration Number	SMG8298P
-----------------------------	----------

INSURED/POLICYHOLDER

Is company?	Yes
Name Of Registered Owner	VISION E&C PTE. LTD
Company Reg No	2XXXXX430G
Email Address	yuankai@visionec.com.sg
Mobile Phone No	(Phone) +65-90625839
Alternative Phone No	+65-90625839

VEHICLE PARTICULARS

Manufacturer	BMW
Model	530
Variant	-
Exact purpose for which vehicle was being used at time of accident	Private use
Are you claiming under your own insurance policy for repair to your vehicle?	No - Claiming third party
Vehicle Category	Private car
Transmission	Auto
CC	1998

INSURANCE COMPANY

Name of Insurance Company	China Taiping Insurance (Singapore) Pte. Ltd.
Type of Coverage	Comprehensive
Fleet Policy	No
Policy Number	DMPCSNW00155312000
Cover Note Number	-

DRIVER

Name of Driver	YUAN KAI
NRIC No	SXXXX613A

Date Of Birth	17/10/1973
Occupation	Indoor
Date Of Driving Pass	16/06/2001
Driving experience	20 YEARS
Gender	Male
Mobile Number	(Phone) +65-90625839
Alt. Phone Number	-
Email Address	yuankai@visionec.com.sg
Address	193 MEYER ROAD
Address complement	#11-05
Postcode	437981
Is the driver the policyholder?	No
If No, Relationship of the Driver with the Insured	Other
Does Driver Own Other Vehicles?	No
Vehicle Registration Number of Other Vehicle Owned by Driver	-
Insurance Company of Other Vehicle Owned by Driver	-

GENERAL INFORMATION OF THE ACCIDENT

Type of Accident	Side Swipe
Weather Conditions	Clear
Road Surface	Dry

OTHER INFORMATION

Was any foreign vehicle involved in the accident?	No
Number of vehicles involved in the accident	2
Was anybody injured in the Accident?	No
Was any injured conveyed to hospital by ambulance?	-
Was any other material or property damaged?	Yes
Number of Passengers (Including Driver)	1
Has the driver been approached by unknown person(s) soliciting/offering accident claims assistance?	No

DETAILS OF POLICE ACTION

Was the accident reported to the police?	No
Was notice of intended Prosecution given?	No
If yes, against whom?	-

CIRCUMSTANCES OF ACCIDENT

PLS REFER TO THE ATTACHED STATEMENT.

ATTACHMENT(S)

Are accident photos available for attachment?	Yes
Was there any video captured by Car Camera?	Yes
Reasons for not uploading a video of the accident	WITH WORKSHOP
Was there any audio recorded?	No

DETAILS OF OTHER VEHICLE PROPERTY 1

Vehicle Registration Number	SMT9371K
Vehicle Manufacturer	Honda
Vehicle Model	Vezel
Vehicle Variant	-
Vehicle Colour	-
Vehicle Category	Private car
Name of Driver	TAN LEE HWA
NRIC No	SXXXX014G
Contact Number	(Phone) +65-90036585

Address -
Address complement -
Postcode -
Insurance Company Name -
Nature Of Damage -
Details of property damaged in accident -
No. Of Passenger (Including Driver) -

SKETCH PLAN

IMPORTANT NOTICE

1. Please report **correctly** the details of the accident to speed up the claims process.
2. This Form must be **completed by the Policyholder and/or the Authorised Driver**.
3. Information provided must be as **truthful and accurate as possible**. Any wilful misrepresentation or withholding of material facts may allow insurance companies to **repudiate policy liability**.
4. The issue and acceptance of this Form by insurance companies is not an admission of policy liability on the part of the insurance companies.
5. **Any false reporting may be referred to the Police for investigation.**
6. The report will be forwarded by the insurers of the GIA Records Management Centre established by the General Insurance Association of Singapore (GIA) for archiving and that copies of this report will for a fee be made available upon application by interested parties.
7. By the lodgement of this report to the insurers, you hereby consent to the archiving of this report at the centre and to copies of the report being made available aforesaid.
8. **Consent under the Personal Data Protection Act (PDPA)**

I understand, acknowledge, agree and consent that:

(a) My insurer, my workshop and the General Insurance Association of Singapore ("GIA") may/are permitted to collect, use, disclose and/or process my personal data/personal information set out in this [form] and any other personal information provided by me or possessed by my insurer (collectively the "Personal Information") and disclose and transfer such Personal Information to all insurer(s) who have insured vehicle(s) involved in this accident (all insurer(s) who have insured vehicle(s) involved in this accident shall be collectively referred to as the "Insurers"), the Insurers' lawyers/law firms, the Monetary Authority of Singapore and any relevant government agency/authority (such as the police), for the purpose(s) of:

(i) processing, handling and/or dealing with my claims including the settlement of the claims and any necessary investigations relating to the claims;

(ii) investigating the accident and/or my claims;

(iii) carrying out and/or dealing with my instructions or responding to any enquiries by me;

(iv) administering my claims (including the mailing of correspondence, statements, invoices, reports or notices to me, which could involve disclosure of certain personal data about me to bring about delivery of the same as well as on the external cover of envelopes/mail packages); and/or

(v) complying with applicable law in administering, processing, handling and/or dealing with my claims.

(collectively the "Purposes")

(b) all insurer(s) who have insured vehicle(s) involved in this accident and the Insurers' lawyers/law firms, may/are permitted to collect, use, disclose and/or process my Personal Information for one or more of the above Purposes, and

(c) my Personal Information may/can be disclosed by any of the Insurers and/or GIA to their third party service providers or agents (including their lawyers/law firms), which may be sited outside of Singapore, for one or more of the above Purposes.



[Handwritten signature] 23/06/21

Policyholder's Signature / Date & Time

Driver's Signature (If driver is not the policyholder) / Date & Time

Witnessed by Reporting Centre Personnel

Sketch Plan

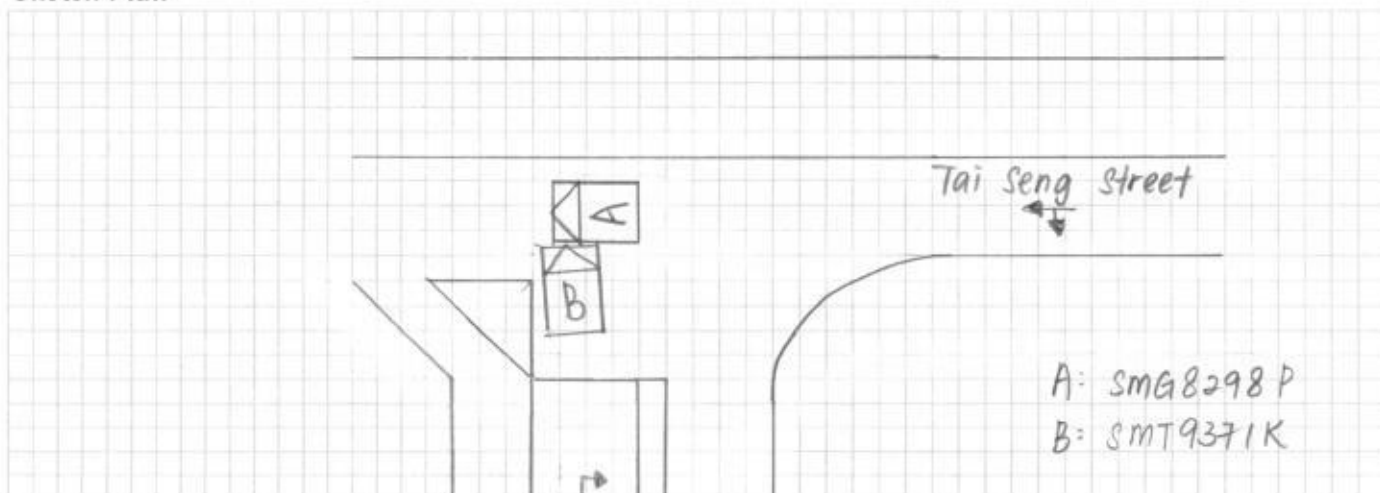

Describe Circumstances of the Accident

I was travelling straight along Tai Seng Street. I was travelling at my own lane. Vehicle B suddenly dashed out from the minor road without stopping at the stop line and hit onto the left portion of my vehicle.

Declaration

We declare the foregoing particulars are true in every respect.



Policyholder's Signature / Date & Time

Driver's Signature (If driver is not the policyholder) / Date & Time

23/06/21

Witnessed by Reporting Centre Personnel

SINGAPORE ACCIDENT STATEMENT

IMPORTANT NOTICE

- ❖ Complete and submit this form to the individual insurance authorised reporting centre.
- ❖ Please report correctly on the details of the accident to speed up the claim process.
- ❖ This form must be filled up by the policy holder and/or authorised driver.
- ❖ Information provided must be as fruitful and accurate as possible. Any wilful misrepresentation or withholding of material facts may allow insurance companies to repudiate policy liability.
- ❖ The issue and acceptance of this form by insurance companies is not an admission of policy liability on the part of the insurance companies.
- ❖ Any false reporting may be referred to the traffic police department for investigation.

ACCIDENT DETAILS

Date of accident	22/06/2021	(DD/MM/YY)
Time of accident	0925	(HH:MM)
Exact location of accident	Along Tai Seng Street	

DETAILS OF VEHICLE

Vehicle registration number	SMG 8298P		
Vehicle make and model	BMW 530		
Type of vehicle	Saloon <input type="checkbox"/>	MPV <input type="checkbox"/>	CRV <input type="checkbox"/> Van <input type="checkbox"/>
	Lorry <input type="checkbox"/>	Bus <input type="checkbox"/>	Motorcycle <input type="checkbox"/> Others: _____
Vehicle category	Private <input type="checkbox"/>	Commercial <input checked="" type="checkbox"/>	Motorcycle <input type="checkbox"/>
Purpose of using at said time			
Are you claiming under your own insurance company?	Yes <input type="checkbox"/>	No <input checked="" type="checkbox"/>	if no, please select: Third part claim <input checked="" type="checkbox"/> Reporting only <input type="checkbox"/>

INSURANCE INFORMATION

Insurance company	China Taiping		
Policy number			
Type of policy	Comprehensive <input type="checkbox"/>	Third party fire & theft <input type="checkbox"/>	TP only <input type="checkbox"/>

INSURED / POLICY HOLDER

Name	Vision E & C Pte Ltd	Male <input type="checkbox"/>	Female <input type="checkbox"/>
NRIC / Fin / Passport number			
Contact			
Address			

DRIVER

SAME AS INSURED ABOVE (SKIP TO D.O.B)

Name	Yuan Kai	Male <input checked="" type="checkbox"/>	Female <input type="checkbox"/>
NRIC / Fin / Passport number	S7383613A		
Contact	9062 5839		
Address	193 Meyer Road #11-05 SC437 981)		
Email address	yuankai@visionec.com.sg		
Date of birth	17/10/1973		
Occupation	Indoor <input checked="" type="checkbox"/>	Outdoor <input type="checkbox"/>	
Driving date pass	16/06/2001		

GENERAL INFORMATION OF THE ACCIDENT	
Was driver an employee of the insured's company?	Yes <input type="checkbox"/> No <input checked="" type="checkbox"/> If no, relationship of the driver and insured: <u>BOSS</u>
Accident captured by camera?	Yes <input checked="" type="checkbox"/> No <input type="checkbox"/>
Weather condition	Clear <input checked="" type="checkbox"/> Raining <input type="checkbox"/> Others: _____
Road surface	Dry <input checked="" type="checkbox"/> Wet <input type="checkbox"/>
No of passenger	<u>01</u> (Inclusive of driver)

PASSENGER 1	
Name	
Gender	Male <input type="checkbox"/> Female <input type="checkbox"/>

PASSENGER 2	
Name	
Gender	Male <input type="checkbox"/> Female <input type="checkbox"/>

PASSENGER 3	
Name	
Gender	Male <input type="checkbox"/> Female <input type="checkbox"/>

PASSENGER 4	
Name	
Gender	Male <input type="checkbox"/> Female <input type="checkbox"/>

PASSENGER 5	
Name	
Gender	Male <input type="checkbox"/> Female <input type="checkbox"/>

PASSENGER 6	
Name	
Gender	Male <input type="checkbox"/> Female <input type="checkbox"/>

OTHER INFORMATION	
Was anybody injured?	Yes <input type="checkbox"/> No <input checked="" type="checkbox"/>
Was other vehicle damaged?	Yes <input checked="" type="checkbox"/> No <input type="checkbox"/>

DETAILS OF POLICE STATION ACTION	
Reported to police?	Yes <input type="checkbox"/> No <input checked="" type="checkbox"/> If yes, please state which police station.
Police station name	

WITNESS 1	
Name	

WITNESS 2	
Name	

THIRD PARTY VEHICLE 1	
Vehicle registration number	SMT 9371K
Vehicle make model	Honda Vezel
Name	Tan Lee Hwa
NRIC / Fin / Passport number	S1783014G
Contact	9003 6585

THIRD PARTY VEHICLE 2	
Vehicle registration number	
Vehicle make model	
Name	
NRIC / Fin / Passport number	
Contact	

THIRD PARTY VEHICLE 3	
Vehicle registration number	
Vehicle make model	
Name	
NRIC / Fin / Passport number	
Contact	

THIRD PARTY VEHICLE 4	
Vehicle registration number	
Vehicle make model	
Name	
NRIC / Fin / Passport number	
Contact	

THIRD PARTY VEHICLE 5	
Vehicle registration number	
Vehicle make model	
Name	
NRIC / Fin / Passport number	
Contact	

THIRD PARTY VEHICLE 6	
Vehicle registration number	
Vehicle make model	
Name	
NRIC / Fin / Passport number	
Contact	

THIRD PARTY VEHICLE 7	
Vehicle registration number	
Vehicle make model	
Name	
NRIC / Fin / Passport number	
Contact	

INJURED PERSON 1		
Name		
Injuries sustained		
Which vehicle person in?		
Were seat belts worn?	Yes <input type="checkbox"/>	No <input type="checkbox"/>
Was injured conveyed to hospital by ambulance?	Yes <input type="checkbox"/>	No <input type="checkbox"/>

INJURED PERSON 2		
Name		
Injuries sustained		
Which vehicle person in?		
Were seat belts worn?	Yes <input type="checkbox"/>	No <input type="checkbox"/>
Was injured conveyed to hospital by ambulance?	Yes <input type="checkbox"/>	No <input type="checkbox"/>

INJURED PERSON 3		
Name		
Injuries sustained		
Which vehicle person in?		
Were seat belts worn?	Yes <input type="checkbox"/>	No <input type="checkbox"/>
Was injured conveyed to hospital by ambulance?	Yes <input type="checkbox"/>	No <input type="checkbox"/>

INJURED PERSON 4		
Name		
Injuries sustained		
Which vehicle person in?		
Were seat belts worn?	Yes <input type="checkbox"/>	No <input type="checkbox"/>
Was injured conveyed to hospital by ambulance?	Yes <input type="checkbox"/>	No <input type="checkbox"/>

INJURED PERSON 5		
Name		
Injuries sustained		
Which vehicle person in?		
Were seat belts worn?	Yes <input type="checkbox"/>	No <input type="checkbox"/>
Was injured conveyed to hospital by ambulance?	Yes <input type="checkbox"/>	No <input type="checkbox"/>

INJURED PERSON 6		
Name		
Injuries sustained		
Which vehicle person in?		
Were seat belts worn?	Yes <input type="checkbox"/>	No <input type="checkbox"/>
Was injured conveyed to hospital by ambulance?	Yes <input type="checkbox"/>	No <input type="checkbox"/>

Motor Private Car

MX4E

N SN

AN0646A

Cov. Type:C

CERTIFICATE OF INSURANCE
Motor Vehicles (Third-Party Risks and Compensation) Act (Chapter 189)
Motor Vehicles (Third-Party Risks and Compensation) Rules, 1960
Road Transport Act, 1987 (Malaysia)
Motor Vehicles (Third-Party Risks) Rules, 1959 (Malaysia)

CERTIFICATE No.	DMPCSNW00155312000	Engine No.: 14305273B48B20A	
		Cha. No.:WBAJA92030BN71647	
1. Index Mark and Registration Number of Vehicle	SMG8298P	AUTOSAFE	*****
2. Name of Policy Holder	VISION E&C PTE. LTD.		
3. Effective date of the Commencement of Insurance for the purposes of the Regulations, Ordinance or Enactment	30/11/2020	Named Drivers Ex Sect. I	\$S750.00
		Additional Ex Other than Named Drivers:	
		Ex Sect. I - Age <= 25	\$S3,000.00
4. Date of Expiry of Insurance	29/11/2021	Ex Sect. I - Age >= 26	\$S500.00
		* Age as at date of accident	
		EX ON WINDSCREEN ,	\$S100.00
5. Persons or Classes of Persons entitled to drive*	Any person who is driving on the Policyholder's order or with their permission.		
	Provided that the person driving is permitted in accordance with the licensing or other laws or regulations to drive the Motor Vehicle or has been so permitted and is not disqualified by order of a Court of Law or by reason of any enactment or regulation in that behalf from driving the Motor Vehicle.		
6. Limitations as to use.*	Use for social, domestic and pleasure purposes and for the Policyholder's business. The policy does not cover use for hire or reward tuition driving test racing pace-making, reliability trial, speed-testing, the carriage of goods other than samples in connection with any trade or business or use for any purpose in connection with the Motor Trade. Excess whichever is applicable for losses occurring outside Singapore (Constructive Total Loss/Theft) will be doubled. One time Waiver of Excess for the first \$S1,000 will apply to the Insured and Named Drivers in the event of Own Damage Claim at our Authorised Workshops for each Policy Year.		
HIRE PURCHASE CO. : HONG LEONG FINANCE LTD			
* Limitations rendered inoperative by Section 8 of the Motor Vehicles (Third-Party Risks and Compensation) Act (Chapter 189) and Section 95 of the Road Transport Act 1987 (Malaysia), are not to be included under these headings.			

I/We hereby Certify that the policy to which this Certificate relates is issued in accordance with the provisions of the Motor Vehicles (Third-Party Risks and Compensation) Act (Chapter 189) and Part IV of the Road Transport Act, 1987 (Malaysia).

Please see reverse

For CHINA TAIPING INSURANCE (SINGAPORE) PTE. LTD.

Issued By: NET LINK COMMERCIAL PTE LTD
Authorised Officer

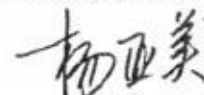

Authorised Signatory