

C

Келлетт

TOTAL

Veh No: STR 2341P Yr Regn: 06, 09
Type: M. Car / M. Cycle / Bus / Van / Lorry / Taxi / Prime Mover /
Truck / Trailer or
Make: Toy AIAJ C.C. 1598
Colour M. Silver A/C: Insured / Std / NI / NA
Sp. Reading 282571 T/Radio: Insured / Std / NI / NA
Eng/No:
C/No: NR0537EE106147410
Gen. Cond: Good / Fair / Poor / Burnt
Steering: In order / Jammed / Leaked / Burnt or
Brake: In order / Jammed / Leaked / Burnt or
Modl: Nil / S/Rlm / STD A/Rlm or
Tyre Size: F: 195/65R15
R:
BS / DUN / EXNOVA / GY / FS / LIZA / MIC / OHTSU / PIR / SUMI /
TOYO / YOKO or Continental
Front
R/Bal. 8 mm
L/Bal. 8 mm
D.O.A. 23/4/21
Rear
R/Bal. 7 mm
L/Bal. 7 mm
D.O.I. 24/5/2021
Survey held at
Des. of Damages: Frt / Rear / O/S / N/S / U/C / Rooftop or
197 O/S
The U/C / Chassis frame / Body Structure affected due to collision.

Lai Huat (Meng Kee) Motor Pte Ltd
160 Sin Ming Drive, #04-01, #04-02 &
#07-03, Sin Ming Autocity
575722

Insurer Reference: TP-SLF 6495S
Repairer Reference: 72036
Date calculated: 07/05/2021 2:34 PM

Full Report
Registration: SJR 2341P
Printed: 07/05/2021 2:35 PM

Summary Information

Claim			
Location:	Singapore (SG)	Work Provider:	China Taiping Insurance (Singapore) Pte Ltd
Printed by:	Jenny Lim	Currency:	SGD
Claim Reference:	TP-SLF 6495S	Date of Incident:	25/04/21
Estimated Repair Time:		Hire Car Start:	
Actual Repair Days:		Hire Car End:	

Vehicle Details

Vehicle			
Manufacturer:	TOYOTA		
Model:	COROLLA E14		
Sub Model:	ALTIS		
Model Sheet Number:	70 CM 13		
Registration:	SJR 2341P		
VIN number:			
Odometer:	261763		
Model Specs			
FROM 05/2009	AIR CONDITIONING	FOG LAMPS	1.6 LTR 82 KW
TYRES 195/65 R15..V	TWO COAT METALLIC	PREPARE OFF VEHICLE	

*Not Authorized
 Repairing By painting
 4 days*

Labour

Code	Description	Time Base 10 WU/h	Price = 42.00 SGD/h	
			WU	Price SGD
NO NUMBER	ADJUST HEADLAMPS		3.0	12.60
B100	R + R R/WING		4.0	16.80
B110)	RENEW R/F WING (REMOVED)		2.0	8.40
B010	R + R FRONT BUMPER		5.0	21.00
B020)	RENEW FRONT BUMPER (REMOVED)		11.0	46.20
B040)	R + R RIGHT HEADLAMP		1.0	4.20
B040)	RENEW HEADLAMP		1.0	4.20
B085	R + R FRONT SCREEN FRAME MOULDING		2.0	8.40
NO NUMBER	R + R FRONT ENGINE PROTECTION		2.0	8.40
Labour Cost		Hrs	WU	
Panel / Mechanical Labour		3.10	31.0	130.20
Total of Labour				130.20

LKK Auto Consultants hence notify the Repairer of the following:

- To resurvey before/after spray painting
- To display damaged part(s) during resurvey
- Parts prices are subject to confirmation
- Third party survey is on a "Without Prejudice" basis
- No illegal modification(s) is allowed
- Supplemental items must be resurveyed and is subject to final approval from Insurance Company

Acknowledged by Repairer
 Signature:
 Date:

Paint

Paint Work

SYSTEM AZT

Time Basis 10 WU/h

Code	Description - TWO COAT METALLIC	WU	Price SGD
	R/F WING NEW PART PAINTING	10.0	
	FRONT BUMPER NEW PART PAINT K1R	13.0	

Paint Material Per Part

Code	Description	Price SGD
0742	R/F WING NEW PART PAINTING	21.16
0281	FRONT BUMPER NEW PART PAINT K1R	67.40

Labour Cost - Paint

	Factor	42.00 SGD/h	Hrs	WU	Price SGD
	Time Paint			23.0	
	Preparation Main Work Metal		2.50	25.0	105.00
	Preparation Comp. Work Plastic		0.50	5.0	21.00
Total		10 WU/h	5.30	53.0	222.60

Material Cost - Paint

	Price SGD
New Part Painting	21.16
New Part Painting - Plastic K1R	67.40
Material-constant Metal Preparation	28.60
Material constant Plastic	9.00
Total	126.16

Spare Parts

Code	Description	Part Number	Part Source	prices as at 2015-06-01/01	Price SGD
0281	FRONT BUMPER	52119 02850	Original	Buelcom ✓	185.00
0742	R/F WING	53811 02250	Original	Bu ✓	150.00
0527	RADIATOR GRILL SEAL	53395 02050	Original	nu ✓	25.00
0562	RIGHT HEADLAMP ASSY	81130 02720	Original	CNT	150.00
f: OEM Parts	Savings				0.00
n: Non-OEM Parts	Subtotal				510.00
u: Used parts	Fixed Sundry Parts Price				100.00
	Total				610.00

Final Calculation

	SGD	SGD
Parts	510.00	
Fixed Sundry Parts Price	100.00	
Total Parts		610.00
Labour Time Base 10 WU/h		
Total 31.0 WU X 42.00 SGD/h	130.20	
Total of Labour		130.20
Paint Work Time Base 10 WU/h		
Labour Cost 53.0 WU X 42.00 SGD/h	222.60	
Material Cost	126.16	
Total Paint Including Material		348.76
Repair Cost Excludes GST		1,088.96
GST (+7.0%)		76.23
Repair Cost Included GST		1,165.19

Comments

* - USER SUPPLIED DATA
NN - NO MANUFACTURERS CODE EXISTS
) - WU PARTIAL INCL IN OTHER POSITIONS

Assessment Note

No assessment notes entered.

SINGAPORE ACCIDENT STATEMENT

IMPORTANT NOTICE

1. Please report correctly the details of the accident to speed up the claims process.
2. This Form must be completed by the Policyholder and/or the Authorised Driver.
3. Information provided must be as truthful and accurate as possible. Any wilful misrepresentation or withholding of material facts may allow insurance companies to repudiate policy liability.
4. The issue and acceptance of this Form by insurance companies is not an admission of policy liability on the part of the insurance companies.
5. Any false reporting may be referred to the Police for investigation.
6. This report will be forwarded by the insurers of the GIA Records Management Centre established by the General Insurance Association of Singapore (GIA) for archiving and that copies of this report will, for a fee, be made available upon application by interested parties.
7. By the lodgement of this report to the insurers, you hereby consent to the archiving of this report at the centre and to copies of the report being made available aforesaid.

ACCIDENT STATEMENT

Date of Submission	27/04/2021 10:37 (SGT)
Date of Accident	25/04/2021 15:37 (SGT)
Exact Location of Accident	Singapore
Additional Location Information	JUNCTION OF KEW AVE AND TANAH MERAH KECHIL RD
Country/State of Loss	SOUTH Singapore

DETAILS OF OWN VEHICLE

Vehicle Registration Number	SJR2341P
INSURED/POLICYHOLDER	
Is company?	Yes
Name Of Registered Owner	HAI YONG ENGINEERING PTE LTD
Company Reg No	1XXXXX456N
Email Address	gansf@haiyong.com.sg
Mobile Phone No	(Phone) +65-98260302
Alternative Phone No	+65-98260302

VEHICLE PARTICULARS

Manufacturer	Toyota
Model	COROLLA ALTIS
Variant	-
Exact purpose for which vehicle was being used at time of accident	Employment
Are you claiming under your own insurance policy for repair to your vehicle?	No - Claiming third party
Vehicle Category	Private car
Transmission	Auto
CC	1600

INSURANCE COMPANY

Name of Insurance Company	NTUC Income Insurance Co-operative Ltd
Type of Coverage	Comprehensive
Fleet Policy	No
Policy Number	5044079277-10 (DRIVO CLASSIC)
Cover Note Number	-

DRIVER

Name of Driver	GAN SIOK FONG
----------------	---------------

NRIC No	SXXXX178H
Date Of Birth	18/01/1962
Occupation	Indoor
Date Of Driving Pass	06/10/1989
Driving experience	31 YEARS AND 6 MONTHS
Gender	Female
Mobile Number	(Phone) +65-98260302
Alt. Phone Number	-
Email Address	gansf@haiyong.com.sg
Address	BLK 527 BEDOK NORTH ST 3 #03-526
Address complement	-
Postcode	460527
Is the driver the policyholder?	No
If No, Relationship of the Driver with the Insured	Employee
Does Driver Own Other Vehicles?	No
Vehicle Registration Number of Other Vehicle Owned by Driver	-
Insurance Company of Other Vehicle Owned by Driver	-

GENERAL INFORMATION OF THE ACCIDENT

Type of Accident	Collision - Change/cross lane
Weather Conditions	Clear
Road Surface	Dry

OTHER INFORMATION

Was any foreign vehicle involved in the accident?	No
Number of vehicles involved in the accident	2
Was anybody injured in the Accident?	No
Was any injured conveyed to hospital by ambulance?	-
Was any other material or property damaged?	Yes
Number of Passengers (Including Driver)	2
Has the driver been approached by unknown person(s) soliciting/offering accident claims assistance?	No

PASSENGER 1

Name	UNKNOWN
Gender	Female

DETAILS OF POLICE ACTION

Was the accident reported to the police?	No
Was notice of intended Prosecution given?	No
If yes, against whom?	-

CIRCUMSTANCES OF ACCIDENT

REFER TO STATEMENT ATTACHED.

ATTACHMENT(S)

Are accident photos available for attachment?	Yes
Was there any video captured by Car Camera?	No
Was there any audio recorded?	No

DETAILS OF OTHER VEHICLE PROPERTY 1

Vehicle Registration Number	SLF6495S
Vehicle Manufacturer	-
Vehicle Model	-
Vehicle Variant	-
Vehicle Colour	-

SKETCH PLAN

IMPORTANT NOTICE

1. Please report correctly the details of the accident to speed up the claims process.
2. This Form must be completed by the Policyholder and/or the Authorised Driver.
3. Information provided must be as truthful and accurate as possible. Any willful misrepresentation or withholding of material facts may allow insurance companies to repudiate policy liability.
4. The issue and acceptance of this Form by insurance companies is not an admission of policy liability on the part of the insurance companies.
5. Any false reporting may be referred to the Police for investigation.
6. The report will be forwarded by the insurers of the GIA Records Management Centre established by the General Insurance Association of Singapore (GIA) for archiving and that copies of this report will for a fee be made available upon application by interested parties.
7. By the lodgement of this report to the insurers, you hereby consent to the archiving of this report at the centre and to copies of the report being made available aforesaid.
8. **Consent under the Personal Data Protection Act (PDPA)**
I understand, acknowledge, agree and consent that :
(a) My insurer, my workshop and the General Insurance Association of Singapore ("GIA") may/are permitted to collect, use, disclose and/or process my personal data/personal information set out in this (form) and any other personal information provided by me or possessed by my insurer (collectively the "Personal Information") and disclose and transfer such Personal Information to all insurer(s) who have insured vehicle(s) involved in this accident (all insurer(s) who have insured vehicle(s) involved in this accident shall be collectively referred to as the "Insurers"), the Insurers' lawyers/law firms, the Monetary Authority of Singapore and any relevant government agency/authority (such as the police), for the purpose(s) of :
(i) processing, handling and/or dealing with my claims including the settlement of the claims and any necessary investigations relating to the claims;
(ii) investigating the accident and/or my claims;
(iii) carrying out and/or dealing with my instructions or responding to any enquiries by me;
(iv) administering my claims (including the mailing of correspondence, statements, invoices, reports or notices to me, which could involve disclosure of certain personal data about me to bring about delivery of the same as well as on the external cover of envelopes/mail packages); and/or
(v) complying with applicable law in administering, processing, handling and/or dealing with my claims.
(collectively the "Purposes")
(b) all insurer(s) who have insured vehicle(s) involved in this accident and the Insurers' lawyers/law firms, may/are permitted to collect, use, disclose and/or process my Personal Information for one or more of the above Purposes; and
(c) my Personal Information may/can be disclosed by any of the Insurers and/or GIA to their third party service providers or agents (including their lawyers/law firms), which may be sited outside of Singapore, for one or more of the above Purposes.



27 APR 2021

Policyholder's Signature / Date & Time

Driver's Signature (If driver is not the policyholder) / Date & Time

Witnessed by Reporting Centre Personnel

Sketch Plan

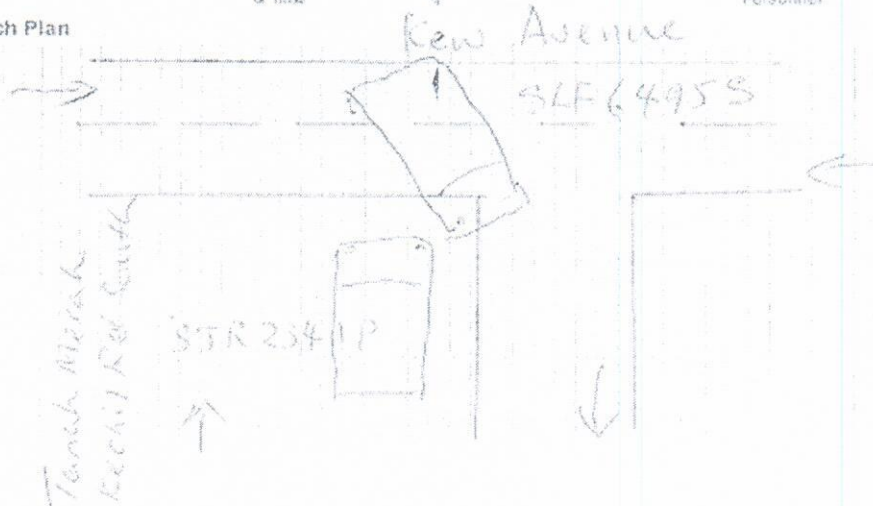

Describe Circumstances of the Accident

On 25-04-2021 at about 15:37 when I was driving towards
 New Avenue along Tannan Meral Kechil Road Surin, I stopped
 at the junction.
 At this time, a vehicle SLF68953 made a sharp turn into my lane
 and at high speed. As a result, his vehicle hit my car.
 The right head lamp and end of my car was damaged.

Declaration

We declare the foregoing particulars are true in every respect.

27 APR 2021



Policyholder's Signature / Date & Time

Driver's Signature (if driver is not the policyholder) / Date & Time

Witnessed by Reporting Centre Personnel

Certificate of Insurance

MOTOR VEHICLES (THIRD PARTY RISKS AND COMPENSATION) ACT (CHAPTER 189)
 MOTOR VEHICLES (THIRD PARTY RISKS AND COMPENSATION) RULES, 1960
 ROAD TRANSPORT ACT, 1987 (MALAYSIA)
 ROAD TRANSPORT (AMENDMENT) ACT, 2019 (MALAYSIA)
 MOTOR VEHICLES (THIRD PARTY RISKS) RULES, 1959 (MALAYSIA)

Certificate Number: 5044079277-10

Cover : drive CLASSIC

1. Index mark and Registration Number of Vehicle : **SJR2341P**
 Chassis Number : MR053ZEE106147410
2. Name of Policyholder : HAI YONG ENGINEERING PTE LTD
3. Effective Date of Insurance : 15 Jun 2020
4. Expiry Date of Insurance : 14 Jun 2021
5. Persons or Classes of Persons entitled to drive#
 - (a) The Policyholder.
 - (b) Any other person who is driving on the Policyholder's order or with his/her permission.
 Provided that the person driving is permitted in accordance with the licensing or other laws or regulations to drive the Motor Vehicle or has been so permitted and is not disqualified by order of a Court of Law or by reason of any enactment or regulation in that behalf from driving the Motor Vehicle.
6. Limitations as to Use#
 - (a) Use for social domestic and pleasure purposes and in connection with the Policyholder's business or profession.

This Policy does not cover

- (a) Use for hire or reward.
- (b) Use for racing, pace-making, reliability trial or speed-testing.
- (c) Use for the carriage of goods (other than samples) in connection with any trade or business.
- (d) Use for any purpose in connection with the Motor Trade.

Limitations rendered inoperative by Section 8 of the Motor Vehicle (Third Party Risks and Compensation) Act (Chapter 189) and Section 95 of the Road Transport Act, 1987 (Malaysia), are not to be included under these headings.

EXCESS (SECTION 1)	: S\$600
EXCESS (SECTION 2)	: N/A
WINDSCREEN EXCESS	: S\$100
ADDITIONAL EXCESS	: N/A
UNNAMED DRIVER EXCESS	: PLEASE REFER OVERLEAF
REPAIR AT OWNER'S PREFERRED WORKSHOP	: NO
INSURE WITH COE	: YES
NCD PROTECTION	: YES (FREE)
TRANSPORT ALLOWANCE	: NO
EXCESS WAIVER	: NO
PRIMARY DRIVER	: N/A
NAMED DRIVER (1)	: N/A
NAMED DRIVER (2)	: N/A
HIRE PURCHASE COMPANY	: HONG LEONG FINANCE LIMITED
SUM INSURED	: MARKET VALUE OF INSURED VEHICLE AT TIME OF LOSS

I/We hereby Certify that the Policy to which this Certificate relates is issued in accordance with the provisions of the Motor Vehicles (Third Party Risks and Compensation) Act (Chapter 189) and Part IV of the Road Transport Act, 1987 (Malaysia)

Agency : LEADENHALL INSURANCE BROKERS PTE LTD (00000690546)
 Date of Issue : 02 Jun 2020 15:03 hrs

For NTUC INCOME INSURANCE CO-OPERATIVE LIMITED



Chief Executive

> Back to OneMotoring

Enquire PARF/COE Rebate for Registered Vehicle

Vehicle Owner Particulars

Owner ID Type:

Company

Owner ID:

456N

Vehicle Details

Vehicle No.:

SJR2341P

Vehicle to be Exported:

Yes

Intended Deregistration Date:

05 May 2021

Vehicle Make:

TOYOTA

Vehicle Model:

COROLLA ALTIS 1.6 AUTO

Primary Colour:

Silver

Manufacturing Year:

2009

Engine No.:

3ZZ4900431

Chassis No.:

MR053ZEE106147410

Maximum Power Output:

80.0 kW (107 bhp)

Open Market Value:

\$17,500.00

Original Registration Date:

15 Jun 2009

First Registration Date:

15 Jun 2009

Transfer Count:

0

Actual ARF Paid:

\$17,500.00

Intended PARF Rebate Details

PARF Eligibility:

Forfeited

PARF Eligibility Expiry Date:

-

PARF Rebate Amount:

\$0.00

Intended COE Rebate Details

COE Expiry Date:

31 May 2024

COE Category:

A - Car (1600cc & below)

COE Period(Years):

5

PQP Paid:

\$13,943.00

COE Rebate Amount:

\$8,560.00

Total Rebate Amount:

\$8,560.00

Message

Please note that the 5-year COE for this vehicle cannot be further renewed. The vehicle must be de-registered upon COE expiry or when the vehicle reaches its statutory lifespan (if applicable), whichever is earlier.

The information contained herein is correct as at 05 May 2021

OK

INSURER ENQUIRY

Find
insurer

Vehicle reg. no.

SLF6495S

Date of Accident

25/04/2021 

Reset

% RESULT & RECEIPT

TP Insurer Enquiry

Insurance China Taiping Insurance (Sing...

Period of Insurance 07/06/2020 - 06/06/2021

Requested By Jenny Lim (Lai Huat (Meng Ke...

Requested Date 05/05/2021 17:09

Payment details

Request Amount: **S\$1.87**GST Amount: **S\$0.13**Total Amount Due (GST Inclusive): **S\$2**

General Insurance Association

Records Management Centre

GST Registration No: **M400017735**