

ASS. REC. BY:

REF:

LPC / CS/LPC21005591/Ktf3

Kenneth

ASSIGNMENT

From: _____ Date: _____

Estimated Cost: _____

OD / TP / WS / TP RES / OD RES / EVA / INV / MV

To Inspect Vehicle No: _____

at Workshop m/s _____

of _____

Insured: _____

Policy No. _____

Claims No. 21/21/21/VC05/024526

Sum Insured: _____ Excess: 600 ?

(Client's Record)

Make of Veh: _____

(Policy Condition)

Remark: The veh had commenced its repair at the time of inspection.

N/S	O/S

Bal. or Market Value: 850k

IDAC Accident Rpt: _____ Consistent? : Yes or No

GIA / PR Seen: _____ Consistent? : Yes or No

Est. Repairs: 07 days Res.: Yes or No

Lum Sum: 20 % 3 Val.: Yes or No

CA / REV / REP. / 24 HRS

Date: _____ Person Contacted: _____

Vehicle: IN / OUT

Veh No: YP 12628 Yr Regn: 02 16

Type: M.Car / M.Cycle / Bus / Van / Lorry / Taxi / Prime Mover /

Truck / Trailer or (m) :

Make: Honda XR 250 710R cc 400P

Colour: White A/C: Insured / Std / NI / NA

Sp. Reading: 62178 T/Radio: Insured / Std / NI / NA

Eng/No: _____

C/No: JH44UCS314 40K 014884

Gen. Cond: Good / Fair / Poor / Burnt

Steering: In order / Jammed / Leaked / Burnt or

Brake: In order / Jammed / Leaked / Burnt or

Mod: M / S/Rim / STD A/Rim or

Tyre Size: F: _____

R: 700R12X10 (D)

BS / DUN / EXNOVA / GY / FS / LIZA / MIC / OHTSU / PIR / SUMI /

TOYO / YOKO or

Front: _____ Rear: _____

R/Bal: 8 mm R/Bal: 9 mm

L/Bal: 8 mm L/Bal: 9 mm

D.O.A. 30/4/21 D.O.I. 7/5/2021

Survey held at _____

Des. of Damages: Frt / Rear / O/S / N/S / U/C / Rooftop or

The U/C / Chassis frame / Body Structure affected due to collision.

Date / Time Action / Instruction

LUMP SUM \$10,050,7DAYS

RED: 5962;37%

Date/Time, File Pass to?

☐ : Prell. Report

Days Of Repair: 7

1) Date/Time, File Return to?

☐ : Final Report

Resurvey No. of Trip: _____

2) _____

Add Fee: ☐ : Site Insp (\$ _____)☐ : Interview (\$ _____)☐ : Tech Invs (\$ _____)☐ : Weekend (\$ _____)

Survey Fee: _____

Transportation: _____

S + FS, SI

Pilot

Others

Report Format: _____

Lump Sum / I.B.I: (\$ _____)

> Back to OneMotoring

Enquire PARF/COE Rebate for Registered Vehicle

Vehicle Owner Particulars	
Owner ID Type:	Company
Owner ID:	631D
Vehicle Details	
Vehicle No.:	YP1262Z
Vehicle to be Exported:	No
Intended Deregistration Date:	03 May 2021
Vehicle Make:	HINO
Vehicle Model:	HINO XZU710R-HKFMS3
Primary Colour:	White
Manufacturing Year:	2015
Engine No.:	N04CUS24344
Chassis No.:	JHHUCS3H40K014684
Maximum Power Output:	-
Open Market Value:	\$28,558.00
Original Registration Date:	02 Feb 2016
First Registration Date:	02 Feb 2016
Transfer Count:	1
Actual ARF Paid:	\$1,428.00
Intended PARF Rebate Details	
PARF Eligibility:	No
PARF Eligibility Expiry Date:	-
PARF Rebate Amount:	\$0.00
Intended COE Rebate Details	
COE Expiry Date:	01 Feb 2026
COE Category:	C - Goods Vehicle & Bus
COE Period(Years):	10
PQP Paid:	\$5,285.00
COE Rebate Amount:	\$2,574.00
Total Rebate Amount:	\$2,574.00

The information contained herein is correct as at 03 May 2021

OK

金興(龔)汽車私人有限公司

160 Sin Ming Drive, #02-20,
Sin Ming AutoCity, Singapore 575722
Tel: 6452 7018 Fax: 6458 3895
Email: service@kkinhin.com.sg

Your Reference : Z21VC05007141
Accident Date : 30-Apr-2021

No. : 31797

Date : 07-May-2021

Our Ref : 021181 / QUEK

PAGE : 1

LONPAC INSURANCE BHD
300 BEACH ROAD
#17-04/07 THE CONCOURSE
Singapore 199555

NOT Notarised
21 Sep 8
Penny Ate Paim

Fdelay

ESTIMATED COST OF REPAIR FOR HINO XZU710R (4009cc)(2016) YP1262Z =====

1 pc front bumper		Ry	580.00	c	✓
2 pcs front bumper bracket (LH/RH)	@ S\$200.00	Ry	400.00	c	✓
2 pcs front bumper fog lamp(LH/RH)	@ S\$250.00	nl/Ry	500.00	c	✓
1 pc front grille		nl/Ry	510.00	c	✓
1 pc front grille logo		nl	70.00	c	✓
10 pcs front grille clips +VE	@ S\$ 1.50	nl	15.00	c	✓
10 pcs front grille clips -VE	@ S\$ 1.50	nl	15.00	c	✓
2 pcs headlamp assy (LH/RH)	@ S\$580.00	1, Ry	1,160.00	c	nl/Ry ✓
1 pc front panel - outer		Ry	300.00	c	✓
1 pc front panel - inner			530.00	c	?
2 pcs front panel socket cover	@ S\$ 90.00		180.00	c	?
2 pcs front wiper blade (LH/RH)	@ S\$ 65.00	nl	130.00	c	✓
2 pcs front wiper arm (LH/RH)	@ S\$110.00	nl/Ry	220.00	c	✓
1 pc front wiper linkage			165.00	c	?
1 pc front wiper motor			280.00	c	?
1 pc front windscreen glass c/w moulding		CM	850.00	c	✓
1 pc air con blower			300.00	c	?
1 pc air con heater unit c/w cooling coil			1,100.00	c	?
1 pc air con heater bypass pipe (inlet)		nl	120.00	c	✓
1 pc air con heater bypass pipe (outlet)		nl	150.00	c	✓
1 pc dashboard assy			580.00	c	?
1 pc dashboard reinforcement			400.00	c	?
2 pcs brake pipe upper (LH/RH)	@ S\$145.00		290.00	c	?

LKK Auto Consultants hence notify the Repairer of the following:

- To resurvey before/after spray painting
- To display damaged part(s) during resurvey
- Parts prices are subject to confirmation
- Third party survey is on a "Without Prejudice" basis
- No illegal modification(s) is allowed
- Supplementary item(s) must be resurveyed and is subject to final approval from Insurance Company

Acknowledged by Repairer

Con't Page 2 ...

金興(龔)汽車私人有限公司

160 Sin Ming Drive, #02-20,
Sin Ming AutoCity, Singapore 575722
Tel: 6452 7018 Fax: 6458 3895
Email: service@kkinhin.com.sg

Your Reference : Z21VC05007141
Our Ref : 021181

Page : 2
No. : 31797

1 pc clutch pipe upper	160.00	c	7
2 pcs front corner panel (LH/RH)	370.00	c	2
1 pc n/s wingmirror - big	105.00	c	1
1 pc n/s wingmirror stay cap cover	60.00	c	1
1 pc n/s wingmirror stay	210.00	c	1
1 pc n/s front door step garnish	165.00	c	1
1 pc air con liquid pipe	185.00	c	1
1 pc air con discharge pipe	240.00	c	1

n/s cm

@ S\$185.00

drive

Br

cm

cm

cm

cm

cm

cm

cm

cm

cm

cm

cm

cm

cm

cm

cm

cm

cm

cm

cm

cm

cm

cm

cm

cm

cm

cm

cm

cm

cm

cm

cm

cm

cm

cm

cm

cm

cm

cm

cm

cm

cm

cm

cm

cm

Add 15% : 1,551.00

10,340.00

1,551.00

11,891.00

40.00

150.00

60.00

20.00

26.00

320.00

195.00

450.00

sn

sn

sn

sn

sn

sn

sn

sn

sn

sn

sn

sn

sn

sn

sn

sn

sn

sn

sn

sn

sn

sn

sn

sn

sn

sn

sn

sn

- 1 pc front number plate
- 1 pc front panel heat insulation
- 1 pc front windscreen glass sealant
- 1 pc front windscreen glass damping seal
- 1 pc ERP bracket
- 1 pc air con condenser
- 1 pc air con condenser bracket
- 1 pc air con condenser fan assy

To remove, cut out damaged parts, panel beating, welding, align, refix and to renew affected parts.

To remove aircon condenser, pipes and driers. Vaccum and recharge gas

To remove and renew front windscreen glass and conduct water leak test.

To remove and renew front instrument panel assy, to rewiring and transfer instrument fittings.

1,200.00

100.00

120.00

240.00

Con't Page 3 ...

金興(龔)汽車私人有限公司

160 Sin Ming Drive, #02-20,
Sin Ming AutoCity, Singapore 575722
Tel: 6452 7018 Fax: 6458 3895
Email: service@kkimhin.com.sg

Your Reference : Z21VC05007141
Our Ref : 021181

Page : 3
No. : 31797

To putty and respray on affected
portions.

Pool
1,200.00

Total : S\$16,012.00
=====

Singapore Dollars Sixteen Thousand and Twelve Only

Note: Amount quoted above is subject to prevailing GST at time of tax invoice.

SINGAPORE ACCIDENT STATEMENT

IMPORTANT NOTICE

1. Please report correctly the details of the accident to speed up the claims process.
2. This Form must be completed by the Policyholder and/or the Authorised Driver
3. Information provided must be as truthful and accurate as possible. Any wilful misrepresentation or withholding of material facts may allow insurance companies to repudiate policy liability.
4. The issue and acceptance of this Form by insurance companies is not an admission of policy liability on the part of the insurance companies.
5. Any false reporting may be referred to the Police for investigation.
6. This report will be forwarded by the insurers of the GIA Records Management Centre established by the General Insurance Association of Singapore (GIA) for archiving and that copies of this report will, for a fee, be made available upon application by interested parties.
7. By the lodgement of this report to the insurers, you hereby consent to the archiving of this report at the centre and to copies of the report being made available aforesaid.

ACCIDENT STATEMENT

Date of Submission 03/05/2021 18:45 (SGT)
Date of Accident 30/04/2021 16:45 (SGT)
Exact Location of Accident Singapore
Additional Location Information AYE TOWARDS TUAS BEFORE JURONG TOWN HALL EXIT
Country/State of Loss Singapore

DETAILS OF OWN VEHICLE

Vehicle Registration Number YP1262Z

INSURED/POLICYHOLDER

Is company? Yes
Name Of Registered Owner FUKUYAMA ENGINEERING & CONSTRUCTION PTE LTD
Company Reg No 2XXXXX631D
Email Address AUDREY@FUKUYAMA.COM.SG
Mobile Phone No (Phone) +65-67470159
Alternative Phone No (Office) +65-67470159

VEHICLE PARTICULARS

Manufacturer Hino
Model XZU710R-HKFMS3
Variant -
Exact purpose for which vehicle was being used at time of accident -
Are you claiming under your own insurance policy for repair to your vehicle? Yes
Vehicle Category Commercial vehicle
Transmission Manual
CC 4009

INSURANCE COMPANY

Name of Insurance Company Lonpac Insurance Bhd
Type of Coverage Comprehensive
Fleet Policy No
Policy Number Z21VC05007141
Cover Note Number -

DRIVER

Name of Driver JOSEPH MOHAN
Passport No/FIN GXXXX273U

 Accident report SK0J21530002

SKETCH PLAN

IMPORTANT NOTICE

1. Please report correctly the details of the accident to speed up the claims process.
2. This Form must be completed by the Policyholder and/or the Authorised Driver.
3. Information provided must be as truthful and accurate as possible. Any wilful misrepresentation or withholding of material facts may allow insurance companies to repudiate policy liability.
4. The issue and acceptance of this Form by insurance companies is not an admission of policy liability on the part of the insurance companies.
5. Any false reporting may be referred to the Police for investigation.
6. The report will be forwarded by the insurers of the GIA Records Management Centre established by the General Insurance Association of Singapore (GIA) for archiving and that copies of this report will for a fee be made available upon application by interested parties.
7. By the lodgement of this report to the insurers, you hereby consent to the archiving of this report at the centre and to copies of the report being made available aforesaid.
8. Consent under the Personal Data Protection Act (PDPA)

I understand, acknowledge, agree and consent that:

- (a) My insurer, my workshop and the General Insurance Association of Singapore ("GIA") may/are permitted to collect, use, disclose and/or process my personal data/personal information set out in this [form] and any other personal information provided by me or possessed by my insurer (collectively the "Personal Information") and disclose and transfer such Personal Information to all insurer(s) who have insured vehicle(s) involved in this accident (all insurer(s) who have insured vehicle(s) involved in this accident shall be collectively referred to as the "Insurers"), the Insurers' lawyers/law firms, the Monetary Authority of Singapore and any relevant government agency/authority (such as the police), for the purpose(s) of:
 - (i) processing, handling and/or dealing with my claims including the settlement of the claims and any necessary investigations relating to the claims;
 - (ii) investigating the accident and/or my claims;
 - (iii) carrying out and/or dealing with my instructions or responding to any enquiries by me;
 - (iv) administering my claims (including the mailing of correspondence, statements, invoices, reports or notices to me, which could involve disclosure of certain personal data about me to bring about delivery of the same as well as on the external cover of envelopes/mail packages); and/or
 - (v) complying with applicable law in administering, processing, handling and/or dealing with my claims.
 (collectively the "Purposes")
- (b) all insurer(s) who have insured vehicle(s) involved in this accident and the Insurers' lawyers/law firms, may/are permitted to collect, use, disclose and/or process my Personal Information for one or more of the above Purposes; and
- (c) my Personal Information may/can be disclosed by any of the Insurers and/or GIA to their third party service providers or agents (including their lawyers/law firms), which may be sited outside of Singapore, for one or more of the above Purposes.



Policyholder's Signature / Date & Time

Sketch Plan

Driver's Signature (If driver is not the policyholder) / Date & Time

Witnessed by Reporting Centre Personnel

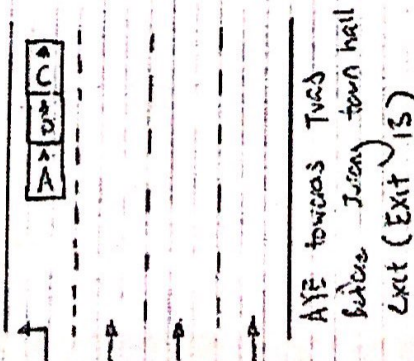
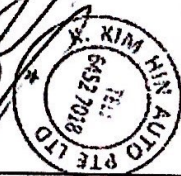

Vehicle 'A': 7P1262Z

Vehicle 'B': SMV 8617Z

Vehicle 'C': SHA 7575L