

ASS. REC. BY:

REF: CS/ASM21004284/Avc

ASSIGNMENT

From: _____ Date: _____

Estimated Cost: _____

OD / TP / WS / TP RES / OD RES / EVA / INV / MV

To Inspect Vehicle No: _____

at Workshop m/s _____

of _____

Insured: **SKW 7789K**

Policy No. _____

Claims No. **S1M0372S**

Sum Insured: _____ Excess: _____

(Client's Record)

Make of Veh: _____

(Policy Condition)

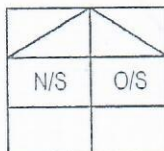
Remark: The veh had commenced its
repair at the time of inspection.

Bal. or Market Value: _____

IDAC Accident Rpt: _____ Consistent? : Yes or No

GIA / PR Seen: _____ Consistent? : Yes or No

Est. Repairs: _____ days Res.: Yes or No

Lum Sum: _____ % 3 Val.: Yes or No

CA / REV / REP. / 24 HRS

Date: _____ Person Contacted: _____

Vehicle: IN / OUT

Veh No: **EV1668S** Yr Regn: **2016 April**Type: **M.Car** / M.Cycle / Bus / Van / Lorry / Taxi / Prime Mover /

Truck / Trailer or

Make: **Mazda 3** C.C. **1496**Colour: **Grey** A/C: Insured / Std / NI / NASp. Reading: **67240** T/Radio: Insured / Std / NI / NA

Eng/No: _____

C/No: **Jm6BM42AS60328712**Gen. Cond: **Good** / Fair / Poor / BurntSteering: **Inorder** / Jammed / Leaked / Burnt orBrake: **Inorder** / Jammed / Leaked / Burnt orModi: Nil / **S/Rim** / STD A/Rim orTyre Size: F: **205/60R16**R: **205/60R16****BS** / DUN / EXNOVA / GY / FS / LIZA / MIC / OHTSU / PIR / SUMI /

TOYO / YOKO or

Front _____ Rear _____

R/Bal. **06** mm R/Bal. **06** mmL/Bal. **06** mm L/Bal. **06** mmD.O.A. **2/4/21** D.O.I. **05/04/21**Survey held at **JEC**

Des. of Damages: Frt / Rear / O/S / N/S / U/C / Rooftop or

Front o/s

The U/C / Chassis frame / Body Structure affected due to collision.

Date / Time	Action / Instruction
	TP AXA
	MV : 50K
	PV : 312K
	Nett : 18.8K
13/4/21	Adrian confirmed LS \$3900 (Red 3408.16, 46%)

Date/Time, File Pass to?

☐

: Preli. Report

1)

☐

: Final Report

Date/Time, File Return to?

2) **13/4/21-Typist**Days Of Repair: **4**Resurvey No. of Trip: **2**

Survey Fee:

Transportation:

Photos

Others

TOTAL

Add Fee:

☐

: Site Insp (\$

☐

: Interview (\$

☐

: Tech. Invs (\$

☐

: Weekend (\$

Report Format: **SMART CLAIM**Lump Sum / LBJ: **LS \$3900**

SINGAPORE ACCIDENT STATEMENT

IMPORTANT NOTICE

1. Please report correctly the details of the accident to speed up the claims process.
2. This Form must be completed by the Policyholder and/or the Authorised Driver
3. Information provided must be as truthful and accurate as possible. Any wilful misrepresentation or withholding of material facts may allow insurance companies to repudiate policy liability.
4. The issue and acceptance of this Form by insurance companies is not an admission of policy liability on the part of the insurance companies.
5. Any false reporting may be referred to the Police for investigation.
6. This report will be forwarded by the insurers of the GIA Records Management Centre established by the General Insurance Association of Singapore (GIA) for archiving and that copies of this report will, for a fee, be made available upon application by interested parties.
7. By the lodgement of this report to the insurers, you hereby consent to the archiving of this report at the centre and to copies of the report being made available aforesaid.

ACCIDENT STATEMENT

Date of Submission	03/04/2021 11:07 (SGT)
Date of Accident	02/04/2021 11:40 (SGT)
Exact Location of Accident	Hougang Ave 10, Singapore
Additional Location Information	-
Country/State of Loss	Singapore

DETAILS OF OWN VEHICLE

Vehicle Registration Number	EV1668S
-----------------------------	---------

INSURED/POLICYHOLDER

Is company?	No
Name Of Registered Owner	TAN SIANG MONG
NRIC No	SXXXX471A
Email Address	tan.chorjin@yahoo.com.SG
Mobile Phone No	(Phone) +65-90884233
Alternative Phone No	(Home) +65-90884233

VEHICLE PARTICULARS

Manufacturer	Mazda
Model	3
Variant	-
Exact purpose for which vehicle was being used at time of accident	Private use
Are you claiming under your own insurance policy for repair to your vehicle?	No - Claiming third party
Vehicle Category	Private car
Transmission	Auto
CC	1600

INSURANCE COMPANY

Name of Insurance Company	AXA Insurance Pte Ltd
Type of Coverage	Comprehensive
Fleet Policy	No
Policy Number	GA173674/1
Cover Note Number	-

DRIVER

Name of Driver	TAN SIANG MONG
NRIC No	SXXXX471A

Date Of Birth	25/01/1948
Occupation	Indoor
Date Of Driving Pass	06/10/1986
Driving experience	34 YEARS AND 6 MONTHS
Gender	Male
Mobile Number	(Phone) +65-90884233
Alt. Phone Number	(Home) +65-90884233
Email Address	tan.chorjin@yahoo.com.SG
Address	77 TAI KENG GARDENS
Address complement	-
Postcode	-
Is the driver the policyholder?	Yes
If No, Relationship of the Driver with the Insured	-
Does Driver Own Other Vehicles?	No
Vehicle Registration Number of Other Vehicle Owned by Driver	-
Insurance Company of Other Vehicle Owned by Driver	-

GENERAL INFORMATION OF THE ACCIDENT

Type of Accident	Collision - Cross Junction
Weather Conditions	Clear
Road Surface	Dry

OTHER INFORMATION

Was any foreign vehicle involved in the accident?	No
Number of vehicles involved in the accident	2
Was anybody injured in the Accident?	No
Was any injured conveyed to hospital by ambulance?	-
Was any other material or property damaged?	Yes
Number of Passengers (Including Driver)	1
Has the driver been approached by unknown person(s) soliciting/offering accident claims assistance?	No

DETAILS OF POLICE ACTION

Was the accident reported to the police?	No
Was notice of intended Prosecution given?	No
If yes, against whom?	-

CIRCUMSTANCES OF ACCIDENT

REFER TO ATTACHED

ATTACHMENT(S)

Are accident photos available for attachment?	Yes
Was there any video captured by Car Camera?	Yes
Reasons for not uploading a video of the accident	WITH OWNER
Was there any audio recorded?	No

DETAILS OF OTHER VEHICLE PROPERTY 1

Vehicle Registration Number	SKW7789K
Vehicle Manufacturer	-
Vehicle Model	-
Vehicle Variant	-
Vehicle Colour	-
Vehicle Category	Private car
Name of Driver	-
Contact Number	(Phone) +65-98007179
Address	-

Address complement -
 Postcode -
 Insurance Company Name -
 Nature Of Damage -
 Details of property damaged in accident -
 No. Of Passenger (Including Driver) -

SKETCH PLAN

IMPORTANT NOTICE

1. Please report correctly the details of the accident to speed up the claims process.
2. This form must be completed by the Policyholder and/or the Authorized Driver.
3. Information provided must be accurate and complete as possible. Any willful misrepresentation or withholding of material facts may allow insurance companies to provoke policy liability.
4. The issue and acceptance of this Form by insurance companies is not an admission of policy liability on the part of the insurance companies.
5. Any false reporting may be referred to the Police for investigation.
6. The report will be forwarded by the insurers of the GIA Reports Management Centre established by the General Insurance Association of Singapore (GIA) for archiving and the copies of this report will for a fee be made available upon application by interested parties.
7. By the lodgment of this report to the insurers, you hereby consent to the archiving of this report at the centre and to copies of the report being made available therein.
8. Consent under the Personal Data Protection Act (PDPA)

I understand, acknowledge, agree and consent that:

- (a) My insurer, my workshop and the General Insurance Association of Singapore ("GIA") may be permitted to collect, use, disclose and/or process my personal data/personal information set out in this form and any other personal information provided by me or generated by my insurer (collectively the "Personal Information") and disclose and transfer such Personal Information to all insurer(s) who have insured vehicle(s) involved in the accident and insurer(s) who have insured vehicle(s) involved in this accident and be collectively referred to as the "Insurers", the Insurance Company/ies (the Monetary Authority of Singapore and any relevant government agency/authorities (such as the police), for the purpose(s) of:
 - (i) processing, handling and/or dealing with my claims including the settlement of the claims and any necessary investigations relating to the claims;
 - (ii) investigating the accident and/or my claims;
 - (iii) carrying out and/or dealing with my instructions or responding to my enquiries by me;
 - (iv) administering my claims (including the mailing of correspondence, statements, invoices, reports or copies to me, which could involve disclosure of certain personal data about me to bring about delivery of the services as well as on the external cover of envelopes/envelope packages); and/or
 - (v) complying with applicable law in administering, processing, handling and/or dealing with my claims (collectively the "Purposes").
- (b) all insurers who have insured vehicle(s) involved in this accident and the insurers' lawyers/lay firms may be permitted to collect, use, disclose and/or process my Personal Information for one or more of the above Purposes and
- (c) my Personal Information may/can be disclosed by any of the Insurers and/or GIA to their third party service providers or agents (including their lawyers/lay firms), which may be used outside of Singapore, for one or more of the above Purposes.
- (d) my Personal Information will also be collected and used to compile claims history for the purpose of fraud detection, investigation and management in present and all future claims.
- (e) the information so collected under (a) above may be shared / disclosed:
 - (i) to all insurers and/or any other third parties that assist in establishing, investigating, controlling or managing fraud, regulatory, law enforcement and government agencies as reasonably required for the purposes stated; or
 - (ii) for complying with requirements under any regulations, laws or court orders.

 Policyholder's Signature
 Date & Time:

 Driver's Signature
 (If driver is not the policyholder)
 Date & Time:

 Reporting Centre Person's Signature
 Name
 NRIC/ID No:

SKETCH PLAN

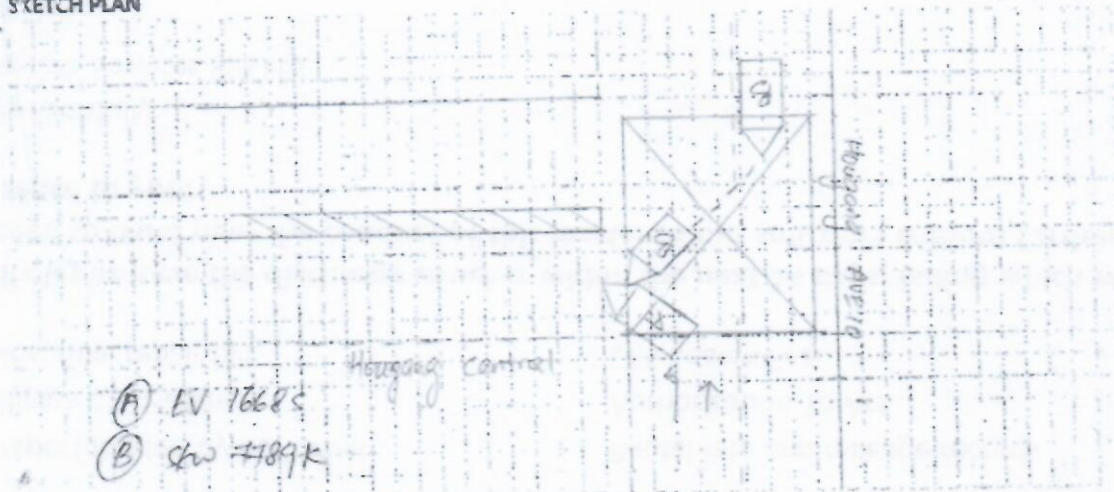

DESCRIBE CIRCUMSTANCES OF THE ACCIDENT

ON 03/04/2021 @ 1145 HRS, WAS DRIVING ALONG HOUGANG AVE 10 TO HOUGANG CENTRAL. WHILE TURNING LEFT, VEHICLE B SUDDENLY TURN RIGHT AND HIT ONTO MY VEHICLE. MY TRAFFIC LIGHT SHOW IS GREEN LIGHT.

DECLARATION

I/We declare the foregoing particulars are true in every respect.

Policyholder's Signature
Date & Time:

Driver's Signature
(If driver is not the policyholder)
Date & Time:

Reporting Centre Personnel's Signature
Name:
NRIC/FIN No.:

> Back to OneMotoring

Enquire PARF/COE Rebate for Registered Vehicle

Vehicle Owner Particulars	
Owner ID Type:	Singapore NRIC
Owner ID:	471A
Vehicle Details	
Vehicle No.:	EV1668S
Vehicle to be Exported:	No
Intended Deregistration Date:	05 Apr 2021
Vehicle Make:	MAZDA
Vehicle Model:	MAZDA3 4-DOOR SEDAN 1.5L SP.6EAT
Primary Colour:	Silver
Manufacturing Year:	2015
Engine No.:	P520337694
Chassis No.:	JM6BM42A8G0328712
Maximum Power Output:	88.0 kW (118 bhp)
Open Market Value:	\$15,720.00
Original Registration Date:	15 Apr 2016
First Registration Date:	15 Apr 2016
Transfer Count:	0
Actual ARF Paid:	\$10,720.00
Intended PARF Rebate Details	
PARF Eligibility:	Yes
PARF Eligibility Expiry Date:	14 Apr 2026
PARF Rebate Amount:	\$8,040.00
Intended COE Rebate Details	
COE Expiry Date:	14 Apr 2026
COE Category:	A - Car up to 1600cc & 97kW (130bhp)
COE Period(Years):	10
QP Paid:	\$46,009.00
COE Rebate Amount:	\$23,119.00
Total Rebate Amount:	\$31,159.00

The information contained herein is correct as at 05 Apr 2021

OK

Lalamove Singapore



Earn Up To \$4000 As A Driver

Mazda 3

Price Range

Depreciation

2016

Vehicle Type

Advanced Search

Used Car Comparison

--- Comparing 4 Vehicles ---

Mazda 3 1.5A Deluxe

Mazda 3 1.5A Sunroof

Mazda 3 1.5A

Mazda 3 1.5A Sunroof



Clear All

Add all to Shortlist

Add to Shortlist

Add to Shortlist

Add to Shortlist

Add to Shortlist

Back to search result

CAR DETAILS

	Mazda 3 1.5A Deluxe	Mazda 3 1.5A Sunroof	Mazda 3 1.5A	Mazda 3 1.5A Sunroof
Price	\$53,800	\$53,800	\$51,800	\$51,800
Instalment	\$705	\$705	\$679	\$679
Registration Date	15-Apr-2016	26-Apr-2016	28-Apr-2016	29-Apr-2016
Manufactured	2016	2016	2015	2016
Mileage	90,000 km	68,000 km	55,000 km	72,000 km
Transmission	Auto	Auto	Auto	Auto
Engine Cap	1,496 cc	1,496 cc	1,496 cc	1,496 cc
Road Tax	\$682 /yr	\$682 /yr	\$682 /yr	\$682 /yr
Power	88.0 kW (118 bhp)	88.0 kW (118 bhp)	88.0 kW (118 bhp)	88.0 kW (118 bhp)
Curb Weight	1,321 kg	1,321 kg	1,321 kg	1,321 kg
Features	1.5L 4 Cylinders DOHC SkyActive-G Engine, 118 BHP, 6 Speed SkyActive-Drive Auto Transmission, ABS, Airbags, Keyless Start/Stop, Knockdown Rear Seats.	Fuel Efficient 4 Cyl DOHC SkyActiv-G Engine, 6 Speed Auto Transmission, TC, SRS, ABS, I-Stop, Push Start, Smart Key, SunRoof.	Powerful And Fuel Efficient 1.5 DOHC SkyActiv-G Engine Producing 118BHP, 150NM Torque At 17.5 Km/L. Reliable And Smooth 6 Speed Auto.	1.5L DOHC SkyActiv-G Engine Producing 118BHP, Transmission, Keyless Start, ABS.
Accessories	Sunroof, Sports Rims, Leather Seats, Factory Fitted Audio System With Maps, Steering Wheel Controls, Reverse Sensors, Retractable Side Mirrors.	Factory Multi Media, Bluetooth, Rev Camera, Day Run Lights, Auto HID Lights, Elect Seat, Premium Leather Interior, Alloy Wheels, Spacious Trunk.	Factory Fitted Radio System With Bluetooth Connectivity And Navigation System, Leather Interior, Multi-Function Steering, Reverse Camera/Sensors, Etc.	Sports Rims, Leather Seats, Fitted Audio System, Control/Bluetooth, Retractable Side Mirrors.
Description	The Mazda 3 Sedan Is One Of The Most Popular, Economical Choices For Daily Drives. A Responsive 1.5L Engine Provides For Punchy Rides While Remaining Fuel-efficient. This Unit Is Presented In Elegant Blue Exterior With Black Interior Upholstery, And Is Maintained In Superb Condition By Previous Owner, Always Serviced At Agent. Call Now To View And Appreciate!	1 Meticulous Owner, Low Mileage, Sporty, Stylish, Modern In Design And Elegant For Single Or Family. Trade In, Loan Quantum Can Be Discussed. Call Or Whatapps For Viewing.	Deluxe Model! Fuel-Efficient! Highest Specs Deluxe Model! Excellent Condition! No Repairs Needed, No Gimmicks. A Practical And Reliable Japanese Sedan With Simple Maintenance And Low Running Cost. STA Welcome! Trade-In Welcome! Flexible Loan Packages To Fit Your Lifestyle! Flexible Loan And Installment Available. Contact Our Any Of Our Sales Person Today!	1 Owner, Beautiful Popular Mazda Sed Spacious And Reliable And Serviced. Beautiful Clean And Neat Interior House Loan Available! Check Availability,
COE	\$46,009	\$47,300	\$47,300	\$49,501
OMV	\$18,865	\$15,841	\$15,843	\$16,468
ARF	\$13,865	\$10,841	\$10,843	\$11,468
Depreciation	\$9,320 /yr	\$9,570 /yr	\$9,160 /yr	\$9,090 /yr
No. of Owners	1	1	2	1
Type of Vehicle	Sedan	Sedan	Sedan	Sedan
Category	PARF Car	PARF Car	PARF Car, Premium Ad Car	PARF Car, Premium