

# SINGAPORE ACCIDENT STATEMENT

## IMPORTANT NOTICE

1. Please report correctly the details of the accident to speed up the claims process.
2. This Form must be completed by the Policyholder and/or the Authorised Driver
3. Information provided must be as truthful and accurate as possible. Any wilful misrepresentation or withholding of material facts may allow insurance companies to repudiate policy liability.
4. The issue and acceptance of this Form by insurance companies is not an admission of policy liability on the part of the insurance companies.
5. **Any false reporting may be referred to the Police for investigation.**
6. This report will be forwarded by the insurers of the GIA Records Management Centre established by the General Insurance Association of Singapore (GIA) for archiving and that copies of this report will, for a fee, be made available upon application by interested parties.
7. By the lodgement of this report to the insurers, you hereby consent to the archiving of this report at the centre and to copies of the report being made available aforesaid.

## ACCIDENT STATEMENT

Date of Submission ..... 29/03/2021 18:29 (SGT)  
Date of Accident ..... 26/03/2021 10:00 (SGT)  
Exact Location of Accident ..... Holland Rd, Singapore  
Additional Location Information ..... -  
Country/State of Loss ..... Singapore

## DETAILS OF OWN VEHICLE

Vehicle Registration Number ..... GBG8425U

### INSURED/POLICYHOLDER

Is company? ..... Yes  
Name Of Registered Owner ..... STARCO GROUP PTE LTD  
Company Reg No ..... 2XXXXX655R  
Email Address ..... sridharselva125@gmail.com  
Mobile Phone No ..... (Phone) +65-87258992  
Alternative Phone No ..... +65-87258992

### VEHICLE PARTICULARS

Manufacturer ..... Toyota  
Model ..... Dyna  
Variant ..... -  
Exact purpose for which vehicle was being used at time of accident ..... Employment  
Are you claiming under your own insurance policy for repair to your vehicle? ..... No - Reporting only  
Vehicle Category ..... Commercial vehicle  
Transmission ..... Manual  
CC ..... 2982

### INSURANCE COMPANY

Name of Insurance Company ..... AIG Asia Pacific Insurance Pte. Ltd.  
Type of Coverage ..... Comprehensive  
Fleet Policy ..... No  
Policy Number ..... 1900230985-01  
Cover Note Number ..... -

### DRIVER

Name of Driver ..... SELVARAJ SRIDHAR  
Passport No/FIN ..... GXXXX515X

Date Of Birth .....	29/09/1993
Occupation .....	Outdoor
Date Of Driving Pass .....	16/11/2017
Driving experience .....	3 YEARS AND 4 MONTHS
Gender .....	Male
Mobile Number .....	(Phone) +65-87258992
Alt. Phone Number .....	-
Email Address .....	sridharselva125@gmail.com
Address .....	8A ADMIRALTY STREET #05-18
Address complement .....	-
Postcode .....	757437
Is the driver the policyholder? .....	No
If No, Relationship of the Driver with the Insured .....	Employee
Does Driver Own Other Vehicles? .....	No
Vehicle Registration Number of Other Vehicle Owned by Driver .....	-
Insurance Company of Other Vehicle Owned by Driver .....	-

#### GENERAL INFORMATION OF THE ACCIDENT

Type of Accident .....	Collision - Major/Minor Rd
Weather Conditions .....	Clear
Road Surface .....	Dry

#### OTHER INFORMATION

Was any foreign vehicle involved in the accident? .....	No
Number of vehicles involved in the accident .....	2
Was anybody injured in the Accident? .....	No
Was any injured conveyed to hospital by ambulance? .....	-
Was any other material or property damaged? .....	Yes
Number of Passengers (Including Driver) .....	1
Has the driver been approached by unknown person(s) soliciting/offering accident claims assistance? .....	No

#### DETAILS OF POLICE ACTION

Was the accident reported to the police? .....	No
Was notice of intended Prosecution given? .....	No
If yes, against whom? .....	-

#### CIRCUMSTANCES OF ACCIDENT

PLEASE REFER TO SKETCH PLAN

#### ATTACHMENT(S)

Are accident photos available for attachment? .....	Yes
Was there any video captured by Car Camera? .....	No
Was there any audio recorded? .....	No

#### DETAILS OF OTHER VEHICLE PROPERTY 1

Vehicle Registration Number .....	GBK9960M
Vehicle Manufacturer .....	-
Vehicle Model .....	-
Vehicle Variant .....	-
Vehicle Colour .....	-
Vehicle Category .....	Commercial vehicle
Name of Driver .....	MOK KAR KIN
Passport No/FIN .....	GXXXX878W
Contact Number .....	-
Address .....	-

Address complement .....	-
Postcode .....	-
Insurance Company Name .....	-
Nature Of Damage .....	-
Details of property damaged in accident .....	-
No. Of Passenger (Including Driver) .....	-

SKETCH PLANIMPORTANT NOTICE

1. Please report correctly the details of the accident to speed up the claims process.
2. This Form must be completed by the Policyholder and/or the Authorised Driver.
3. Information provided must be as truthful and accurate as possible. Any willful misrepresentation or withholding of material facts may allow insurance companies to repudiate policy liability.
4. The issue and acceptance of this Form by insurance companies is not an admission of policy liability on the part of the insurance companies.
5. Any false reporting may be referred to the Police for investigation.
6. The report will be forwarded by the Insurers of the GIA Records Management Centre established by the General Insurance Association of Singapore (GIA) for archiving and that copies of this report will for a fee be made available upon application by interested parties.
7. By the lodgement of this report to the insurers, you hereby consent to the archiving of this report at the centre and to copies of the report being made available aforesaid.
8. **Consent under the Personal Data Protection Act (PDPA)**  
I understand, acknowledge, agree and consent that :  
(a) My insurer, my workshop and the General Insurance Association of Singapore ("GIA") may/are permitted to collect, use, disclose and/or process my personal data/personal information set out in this [form] and any other personal information provided by me or possessed by my insurer (collectively the "Personal Information") and disclose and transfer such Personal Information to all insurer(s) who have insured vehicle(s) involved in this accident (all insurer(s) who have insured vehicle(s) involved in this accident shall be collectively referred to as the "Insurers"), the Insurers' lawyers/law firms, the Monetary Authority of Singapore and any relevant government agency/authority (such as the police), for the purpose(s) of :  
(i) processing, handling and/or dealing with my claims including the settlement of the claims and any necessary investigations relating to the claims;  
(ii) investigating the accident and/or my claims;  
(iii) carrying out and/or dealing with my instructions or responding to any enquiries by me;  
(iv) administering my claims (including the mailing of correspondence, statements, invoices, reports or notices to me, which could involve disclosure of certain personal data about me to bring about delivery of the same as well as on the external cover of envelopes/mail packages); and/or  
(v) complying with applicable law in administering, processing, handling and/or dealing with my claims.  
(collectively the "Purposes")  
(b) all insurer(s) who have insured vehicle(s) involved in this accident and the Insurers' lawyers/law firms, may/are permitted to collect, use, disclose and/or process my Personal Information for one or more of the above Purposes; and  
(c) my Personal Information may/can be disclosed by any of the Insurers and/or GIA to their third party service providers or agents (including their lawyers/law firms), which may be sited outside of Singapore, for one or more of the above Purposes.



Policyholder's Signature / Date &amp; Time

Sketch Plan

Driver's Signature (if driver is not the policyholder) / Date &amp; Time

Witnessed by Reporting Centre Personnel

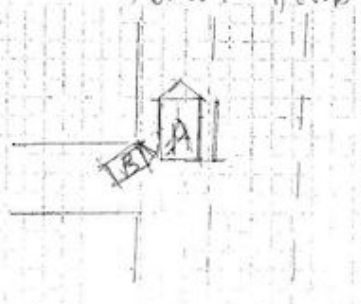

Describe Circumstances of the Accident

AS PER STATED TIME & DATE, I WAS DRIVING ALONG HOLLAND ROAD, AND UPON REACHING NEAR BELMONT, MY VEHICLE A MADE A U-TURN AFTER CHECKING CLEAR THERE IS NO TRAFFIC, ~~STREET~~ AFTER MAKING THE U-TURN AND INTO THE THIRD LANE, ROUGHLY ABOUT 10 SEC VEHICLE B EXIT FROM BELMONT ROAD AND HIT INTO MY VEH A. THE IMPACT LEFT CAUSES DAMAGE TO THE REAR PORTION OF MY VEHICLE, BOTH THE DRIVER B AND I CAME DOWN FROM OUR VEHICLE TO ACCESS THE DAMAGE, AND CHANGE OUR PARTICULARS THEN LEFT THE ACCIDENT SCENE.

Declaration

We declare the foregoing particulars are true in every respect.

  
Policyholder's Signature / Date & Time

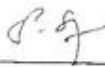

  
Driver's Signature (if driver is not the policyholder) / Date & Time

  
Witnessed by Reporting Centre Personnel









































