

ASS. REC. BY: Sun PinREF: NT4C**ASSIGNMENT**

From: \_\_\_\_\_ Date: \_\_\_\_\_

Estimated Cost: \_\_\_\_\_

OD / TP / WS / TP RES / OD RES / EVA / INV / MV

To Inspect Vehicle No: \_\_\_\_\_

at Workshop m/s \_\_\_\_\_

of \_\_\_\_\_

Insured: \_\_\_\_\_

Policy No. \_\_\_\_\_

Claims No. \_\_\_\_\_

Sum Insured: \_\_\_\_\_ Excess: \_\_\_\_\_

(Client's Record)

Make of Veh: \_\_\_\_\_

(Policy Condition)

Remark: The veh had commenced its  
repair at the time of inspection.

N/S	O/S
	XXX

Bal. or Market Value: \_\_\_\_\_

IDAC Accident Report: \_\_\_\_\_ Consistent? : Yes or No

GIA / PR Seen: \_\_\_\_\_ Consistent? : Yes or No

Est. Repairs: \_\_\_\_\_ days Res.: Yes or No

Lum Sum: \_\_\_\_\_ % 3 Val.: Yes or No

CA / REV / REP. / 24 HRS

Date: \_\_\_\_\_ Person Contacted: \_\_\_\_\_ Vehicle: IN / OUT

Veh No: SHD 6359K. Yr Regn: 28/06/2016.  
Type: M.Car / M.Cycle / Bus / Van / Lorry / (Taxi) Prime Mover /

Truck / Trailer or \_\_\_\_\_

Make: Toyota Prius. C.C. 1745Colour: Maroon. A/C: Insured / Std / NI / NASp. Reading: 413645 T/Radio: Insured / Std / NI / NA

Eng/No: \_\_\_\_\_

C/No: STDKN36U205768241.Gen. Cond: Good / (Fair) / Poor / Burnt

Steering: In order / Jammed / Leaked / Burnt or \_\_\_\_\_

Brake: In order / Jammed / Leaked / Burnt or \_\_\_\_\_

Modi: Nil / (S/Rim) / STD A/Rim or \_\_\_\_\_Tyre Size: F: 195/65 R15R: 195/65 R15

BS / DUN / EXNOVA / GY / FS / LIZA / MIC / OHTSU / PIR / SUMI /

TOYO / YOKO or Sailun.

Front

Rear

R/Bal. 6 mm / R/Bal. 6 mmL/Bal. 6 mm L/Bal. 6 mmD.O.A. 26/02/2021 D.O.I. 01/03/2021Survey held at SMRT.Des. of Damages: Frt / (Rear) / O/S / N/S / U/C / Rooftop or

The U/C / Chassis frame / Body Structure affected due to collision.

Date / Time Action / Instruction

TP  
TAX/02/21/2066  
SMJ1229Y

Date/Time, File Pass to?

1)

Date/Time, File Return to?

2)

☐ : Preli. Report☐ : Final Report

Days Of Repair: \_\_\_\_\_

Resurvey No. of Trip: \_\_\_\_\_

Add Fee:

☐ : Site Insp (\$ ) S + RS. SI☐ : Interview (\$ ) Photos☐ : Tech. Invs (\$ ) Others☐ : Weekend (\$ ) TOTAL

Report Format: \_\_\_\_\_

Lump Sum / I.B.R. (\$) \_\_\_\_\_

Survey Fee:

Transportation:

S + RS. SI

Photos

Others

TOTAL

# SINGAPORE ACCIDENT STATEMENT

## IMPORTANT NOTICE

1. Please report correctly the details of the accident to speed up the claims process.
2. This Form must be completed by the Policyholder and/or the Authorised Driver
3. Information provided must be as truthful and accurate as possible. Any wilful misrepresentation or withholding of material facts may allow insurance companies to repudiate policy liability.
4. The issue and acceptance of this Form by insurance companies is not an admission of policy liability on the part of the insurance companies.
5. Any false reporting may be referred to the Police for investigation.
6. This report will be forwarded by the insurers of the GIA Records Management Centre established by the General Insurance Association of Singapore (GIA) for archiving and that copies of this report will, for a fee, be made available upon application by interested parties.
7. By the lodgement of this report to the insurers, you hereby consent to the archiving of this report at the centre and to copies of the report being made available aforesaid.

## ACCIDENT STATEMENT

Date of Submission	01/03/2021 10:13 (SGT)
Date of Accident	26/02/2021 13:25 (SGT)
Exact Location of Accident	Clementi Ave 6, Singapore
Additional Location Information	CLEMENTI AVE 6
Country/State of Loss	Singapore

## DETAILS OF OWN VEHICLE

Vehicle Registration Number	SHD6359K
INSURED/POLICYHOLDER	
Is company?	Yes
Name Of Registered Owner	SMRT TAXIS PTE LTD
Company Reg No	1XXXXX369K
Email Address	TARC@SMRT.COM.SG
Mobile Phone No	(Phone) +65-68662671
Alternative Phone No	(Office) +65-68662672

## VEHICLE PARTICULARS

Manufacturer	Toyota
Model	Prius.
Variant	-
Exact purpose for which vehicle was being used at time of accident	-
Are you claiming under your own insurance policy for repair to your vehicle?	No - Claiming third party
Vehicle Category	Taxi

## INSURANCE COMPANY

Name of Insurance Company	First Capital
Type of Coverage	ThirdParty
Fleet Policy	Yes
Policy Number	D-20095484MFSH
Cover Note Number	-

## DRIVER

Name of Driver	MOHAMAD NOOR BIN MOHAMAD ARSHAD
NRIC No	SXXXX543I
Date Of Birth	27/01/1955
Occupation	Outdoor



Date Of Driving Pass	25/06/1979
Driving experience	41 YEARS AND 8 MONTHS
Gender	Male
Mobile Number	(Phone) +65-68662672
Alt. Phone Number	-
Email Address	TARC@SMRT.COM.SG
Address	11
Address complement	-
Postcode	-
Is the driver the policyholder?	No
If No, Relationship of the Driver with the Insured	Hirer
Does Driver Own Other Vehicles?	No
Vehicle Registration Number of Other Vehicle Owned by Driver	-
Insurance Company of Other Vehicle Owned by Driver	-

#### GENERAL INFORMATION OF THE ACCIDENT

Type of Accident	Collision - Head to Rear
Weather Conditions	Clear
Road Surface	Dry

#### OTHER INFORMATION

Was any foreign vehicle involved in the accident?	No
Number of vehicles involved in the accident	2
Was anybody injured in the Accident?	No
Was any injured conveyed to hospital by ambulance?	-
Was any other material or property damaged?	Yes
Number of Passengers (Including Driver)	1
Has the driver been approached by unknown person(s) soliciting/offering accident claims assistance?	No

#### DETAILS OF POLICE ACTION

Was the accident reported to the police?	No
Was notice of intended Prosecution given?	No
If yes, against whom?	-

#### CIRCUMSTANCES OF ACCIDENT

I WAS TRAVELLING ALONG CLEMENTI AVENUE 6 TOWARDS PIE. SUDDENLY I FELT AN IMPACT AT THE REAR OF MY TAXI. A VEHICLE SMS1229Y HAD COLLIDED ONTO THE REAR OF MY TAXI.

#### ATTACHMENT(S)

Are accident photos available for attachment?	Yes
Was there any video captured by Car Camera?	No
Was there any audio recorded?	No

#### DETAILS OF OTHER VEHICLE PROPERTY 1

Vehicle Registration Number	SMS1229Y
Vehicle Manufacturer	-
Vehicle Model	-
Vehicle Variant	-
Vehicle Colour	-
Vehicle Category	Private car
Name of Driver	-
Contact Number	-
Address	-
Address complement	-
Postcode	-

- Insurance Company Name	-
Nature Of Damage	-
Details of property damaged in accident	-
No. Of Passenger (Including Driver)	-

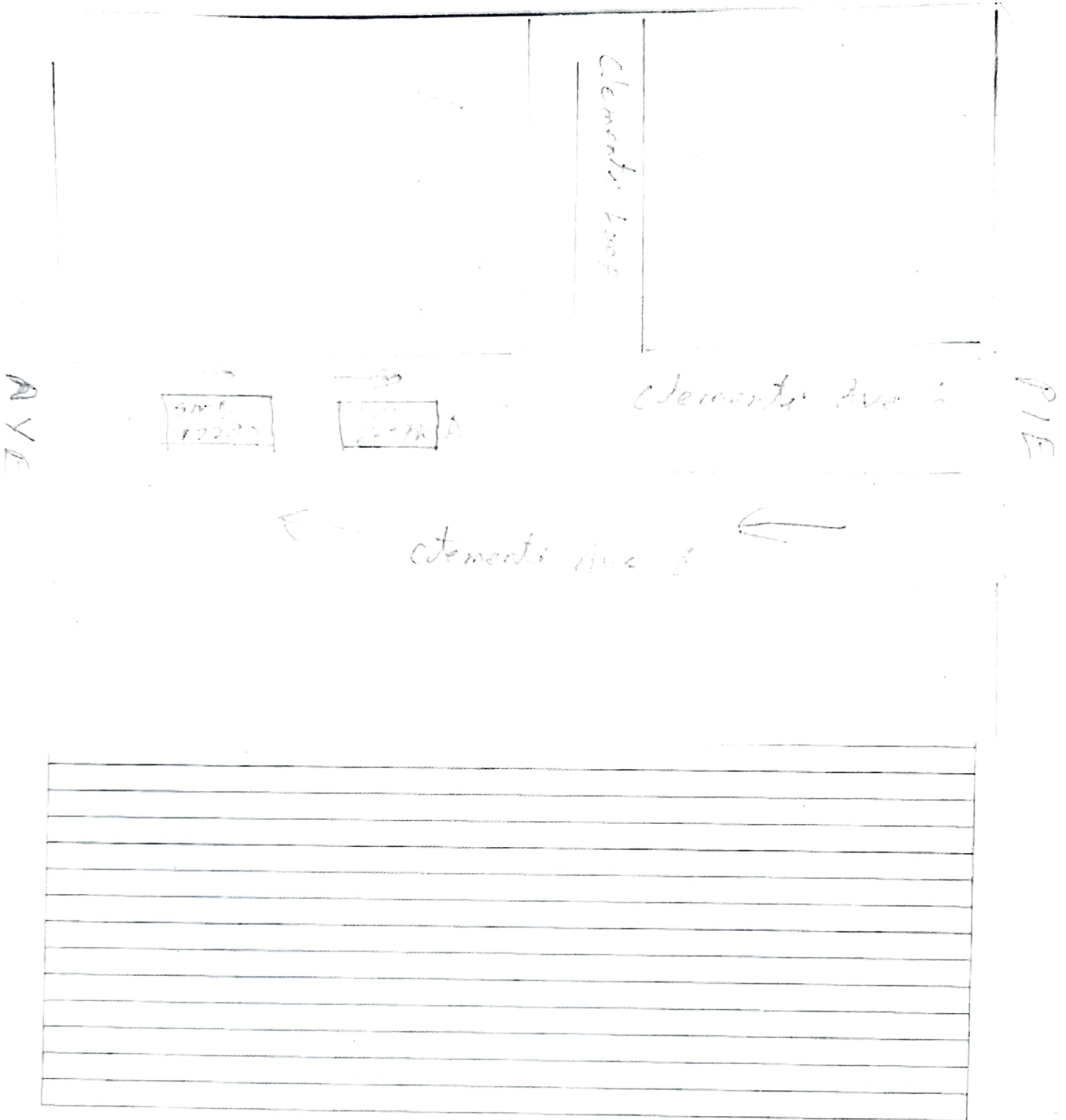

**Declaration**

I/We declare the foregoing particulars are true in every respect

Policyholder's Signature / Date & Time

Driver's Signature (if driver is not the policyholder) / Date & Time

Witnessed by Reporting Centre Personnel



# SKETCH PLAN

## IMPORTANT NOTICE

1. Please report **correctly** the details of the accident to speed up the claims process.
2. This Form must be **completed by the Policyholder and/or the Authorised Driver**.
3. Information provided must be as **truthful and accurate as possible**. Any willful misrepresentation or withholding of material facts may allow insurance companies to **repudiate policy liability**.
4. The issue and acceptance of this Form by insurance companies is not an admission of policy liability on the part of the insurance companies.
5. **Any false reporting may be referred to the Police for investigation.**
6. The report will be forwarded by the insurers of the GIA Records Management Centre established by the General Insurance Association of Singapore (GIA) for archiving and that copies of this report will for a fee be made available upon application by interested parties.
7. By the lodgement of this report to the insurers, you hereby consent to the archiving of this report at the centre and to copies of the report being made available aforesaid.
8. **Consent under the Personal Data Protection Act (PDPA)**  
I understand, acknowledge, agree and consent that:  
(a) My insurer, my workshop and the General Insurance Association of Singapore ("GIA") may/are permitted to collect, use, disclose and/or process my personal data/personal information set out in this (form) and any other personal information provided by me or possessed by my insurer (collectively the "Personal Information") and disclose and transfer such Personal Information to all insurer(s) who have insured vehicle(s) involved in this accident (all insurer(s) who have insured vehicle(s) involved in this accident shall be collectively referred to as the "Insurers"), the Insurers' lawyers/law firms, the Monetary Authority of Singapore and any relevant government agency/authority (such as the police), for the purpose(s) of:  
(i) processing, handling and/or dealing with my claims including the settlement of the claims and any necessary investigations relating to the claims;  
(ii) investigating the accident and/or my claims;  
(iii) carrying out and/or dealing with my instructions or responding to any enquiries by me;  
(iv) administering my claims (including the mailing of correspondence, statements, invoices, reports or notices to me, which could involve disclosure of certain personal data about me to bring about delivery of the same as well as on the external cover of envelopes/mail packages); and/or  
(v) complying with applicable law in administering, processing, handling and/or dealing with my claims (collectively the "Purposes")  
(b) all insurer(s) who have insured vehicle(s) involved in this accident and the Insurers' lawyers/law firms, may/are permitted to collect, use, disclose and/or process my Personal Information for one or more of the above Purposes, and  
(c) my Personal Information may/can be disclosed by any of the Insurers and/or GIA to their third party service providers or agents (including their lawyers/law firms), which may be sited outside of Singapore, for one or more of the above Purposes.

Policyholder's Signature / Date & Time

Driver's Signature (If driver is not the policyholder) / Date & Time

Witnessed by Reporting Centre Personnel

Sketch Plan



## Case Details

Case Reference Number :  
TAX/02/21/2066

Type of Repair : Accident Repair

Vehicle Registration Number :  
SHD6359K

Company Type : SMRT Taxis Pte Ltd

Estimation ID : EST-14083-ID

Assigned By : Taxi Claims Manager  
Team

Insurance Company Name : NTUC Income Insurance Co-operative  
Ltd

Accident Date and Time : 26/02/2021 05:25 AM

Vehicle Age(In Months) : 56

## Documents / Photographs

[View Documents / Photographs](#)

Total Documents: 0

## Estimation Details

### Spare Part's Cost Detail

SMRT Recommendation											Surveyor Approval			
BOM Type	Costing Type	Portion	Material Number	Part Name	Qty	List Price Per Unit(\$)	List Price(\$)	Dis(%)	Final Price(\$)	Repair/ Replace	Surveyor Quantity	Surveyor Final Price(\$)	Repair/Replace	Remarks
One Time Key In	Main			TROUGH, BACK DOOR	1	110.90	110.90	25.00	83.18	Replace	0	0	Not Give	X
One Time Key In	Main			BUMPER REAR	1	458.60	458.60	25.00	343.95	Replace	1	343.9	Replace	/CPM
One Time Key In	Main			BUMPER CLIPS	10	2.10	21.90	25.00	15.75	Replace	10	15.75	Replace	/NEC
One Time Key In	Main			PIXEL STICKER	2	60.00	120.00	0.00	120.00	Replace	2	120.0	Replace	/NR
One Time Key In	Main			BUMPER REINFORCEMENT REAR	1	205.70	205.70	25.00	154.27	Replace	1	154.2	Replace	/BT
One Time Key In	Main			ARM SUB-ASSY. RR BUMPER RH	1	139.60	139.60	25.00	104.70	Replace	1	104.7	Replace	/NT
One Time Key In	Main			ARM SUB-ASSY. RR BUMPER LH	1	139.60	139.60	25.00	104.70	Replace	0	0	Check	X
One Time Key In	Main			ANTENNA,ELECTRICAL LOWER REAR	1	157.40	157.40	10.00	141.66	Replace	0	0	Check	X
One Time Key In	Main			SENSOR REVERSE	1	180.00	180.00	0.00	180.00	Replace	1	180.0	Replace	/Shay

Total Spare Part Cost 15,430.84

Lump Sum Discount (%) 20.00

Final Spare Part Cost 12,344.67

Surveyor Total 5,128.20

Lump Sum Dis (%) 20

Final Sur Total 4,102.56

SMRT Recommendation											Surveyor Approval			
BOM Type	Costing Type	Portion	Material Number	Part Name	Qty	List Price Per Unit(\$)	List Price(\$)	Dis(%)	Final Price(\$)	Repair/ Replace	Surveyor Quantity	Surveyor Final Price(\$)	Repair/Replace	Remarks
One Time Key In	Main			BUMPER SIDE RETAINER RR/LH	1	94.80	94.80	25.00	71.10	Replace	1	71.10	Replace	✓ Bk
One Time Key In	Main			BUMPER SIDE RETAINER RR/RH	1	94.80	94.80	25.00	71.10	Replace	1	71.10	Replace	✓ Bk
One Time Key In	Main			BUMPER SEAL, RR RH	1	65.70	65.70	25.00	49.28	Replace	0	0	Check	✓ X
One Time Key In	Main			BUMPER LIP COVER RR/LH	1	72.20	72.20	25.00	54.15	Replace	0	0	Not Give	✓ X
One Time Key In	Main			BUMPER LIP COVER RR/RH	1	118.10	118.10	25.00	88.57	Replace	1	88.57	Replace	✓ CRY
One Time Key In	Main			BUMPER LIP REAR	1	228.90	228.90	25.00	171.68	Replace	1	171.6	Replace	✓ CRY
One Time Key In	Main			UNDER COVER SUB-ASSY, RR FLOOR	1	514.50	514.50	25.00	385.88	Replace	1	385.8	Replace	✓ CRY
One Time Key In	Main			UNDER COVER RR SHIELD	1	63.90	63.90	25.00	47.92	Replace	0	0	Not Give	✓ X
One Time Key In	Main			END PANEL	1	602.10	602.10	25.00	451.58	Replace	1	451.5	Replace	✓ pb
One Time Key In	Main			END PANEL COVER, DECK TRIM HOLE	1	46.10	46.10	25.00	34.58	Replace	1	34.58	Replace	✓ CRY
One Time Key In	Main			END PANEL COVER, DECK TRIM, RR	1	121.10	121.10	25.00	90.82	Replace	0	0	Not Give	✓ X
One Time Key In	Main			SEALANT SIKAFLEX	1	37.00	37.00	0.00	37.00	Replace	1	37.00	Replace	✓ Ng
One Time Key In	Main			BOX, DECK FLOOR, RR	1	649.70	649.70	25.00	487.28	Replace	0	0	Check	✓ X
One Time Key In	Main			BOX, RR FLOOR, BOARD	1	679.60	679.60	25.00	509.70	Replace	0	0	Check	✓ X
One Time Key In	Main			BOARD ASSY, RR RH	1	379.20	379.20	25.00	284.40	Replace	0	0	Check	✓ X

Total Spare Part Cost

15,430.84

Surveyor Total

5,128.20

Lump Sum Discount (%)

20.00

Lump Sum Dis (%)

20

Final Spare Part Cost

12,344.67

Final Sur Total

4,102.56



SMRT Recommendation											Surveyor Approval			
BOM Type	Costing Type	Portion	Material Number	Part Name	Qty	List Price Per Unit(\$)	List Price(\$)	Dis(%)	Final Price(\$)	Repair/ Replace	Surveyor Quantity	Surveyor Final Price(\$)	Repair/Replace	Remarks
One Time Key In	Main			PANEL ASSY, DECK RH	1	307.00	307.00	25.00	230.25	Replace	0	0	Not Give	X
One Time Key In	Main			PANEL SUB-ASSY, QTR ( RH )	1	588.40	588.40	25.00	441.30	Replace	0	0	Check	X
One Time Key In	Main			DUCT ASSY, QUARTER	1	70.40	70.40	25.00	52.80	Replace	0	0	Check	X
One Time Key In	Main			BATTERY	1	278.00	278.00	10.00	250.20	Replace	0	0	Check	X
One Time Key In	Main			BATTERY TRAY	1	42.80	42.80	25.00	32.10	Replace	0	0	Not Give	X
One Time Key In	Main			EXHAUST TAIL PIPE	1	656.20	656.20	25.00	492.15	Replace	1	492.1	Replace	IBT
One Time Key In	Main			SUPPORT, EXHAUST REAR	1	33.60	33.60	25.00	25.20	Replace	0	0	Not Give	X
One Time Key In	Main			TAILGATE ASY	1	1,007.90	1,007.90	25.00	755.92	Replace	1	755.9	Replace	Chy
One Time Key In	Main			TAILGATE DOOR GLASS MOULDING, RH	1	29.40	29.40	25.00	22.05	Replace	1	22.05	Replace	Nec
One Time Key In	Main			TAILGATE DOOR GLASS MOULDING, LH	1	29.40	29.40	25.00	22.05	Replace	1	22.05	Replace	Nec
One Time Key In	Main			TAILGATE DOOR GLASS	1	1,090.90	1,090.90	25.00	818.18	Replace	0	0	Not Give	X
One Time Key In	Main			MOULDING BACK WINDOW, LOWER NO.1	1	29.40	29.40	25.00	22.05	Replace	1	22.05	Replace	Nec
One Time Key In	Main			MOULDING, BACK WINDOW, LOWER NO.2	1	29.40	29.40	25.00	22.05	Replace	1	22.05	Replace	Nec
One Time Key In	Main			TAILGATE LOWER WINDOW GLASS	1	721.30	721.30	25.00	540.97	Replace	0	0	Not Give	X
One Time Key In	Main			DAM, BACK DOOR GLASS ADHESIVE, NO.1	1	27.30	27.30	25.00	20.48	Replace	1	20.48	Replace	Nec

Total Spare Part Cost 15,430.84

Surveyor Total 5,128.20

Lump Sum Discount (%) 20.00

Lump Sum Dis (%) 20

Final Spare Part Cost 12,344.67

Final Sur Total 4,102.56

SMRT Recommendation											Surveyor Approval			
BOM Type	Costing Type	Portion	Material Number	Part Name	Qty	List Price Per Unit(\$)	List Price(\$)	Dis(%)	Final Price(\$)	Repair/Replace	Surveyor Quantity	Surveyor Final Price(\$)	Repair/Replace	Remarks
One Time Key In	Main			DAM, BACK DOOR GLASS ADHESIVE, NO.2	1	17.40	17.40	25.00	13.05	Replace	1	13.05	Replace	✓ N/A
One Time Key In	Main			SEALANT W/SCREEN	3	37.00	111.00	0.00	111.00	Replace	3	111.00	Replace	✓ N/A
One Time Key In	Main			TAILGATE DOOR HINGE LH/RH	2	58.30	116.60	25.00	87.45	Replace	0	0	Not Give	✓ X
One Time Key In	Main			TAILGATE DOOR LOCK	1	444.10	444.10	10.00	399.69	Replace	1	399.6	Replace	✓ / Jun
One Time Key In	Main			TAILGATE LOCK, COVER	1	15.70	15.70	25.00	11.77	Replace	0	0	Not Give	✓ X
One Time Key In	Main			TAILGATE DOOR WEATHER STRIP	1	353.40	353.40	25.00	265.05	Replace	1	265.0	Replace	✓ / CRY
One Time Key In	Main			TAILGATE TRIM, LH	1	85.90	85.90	25.00	64.43	Replace	0	0	Not Give	✓ X
One Time Key In	Main			TAILGATE TRIM, RH	1	88.30	88.30	25.00	66.22	Replace	0	0	Not Give	✓ X
One Time Key In	Main			TAILGATE TRIM, LOWER	1	180.70	180.70	25.00	135.52	Replace	0	0	Not Give	✓ X
One Time Key In	Main			TAILGATE TRIM, UPPER	1	49.60	49.60	25.00	37.20	Replace	0	0	Not Give	✓ X
One Time Key In	Main			TAILGATE, BAORD ASSY	1	246.90	246.90	25.00	185.18	Replace	0	0	Not Give	✓ X
One Time Key In	Main			TAILGATE OUTSIDE GARNISH	1	504.90	504.90	25.00	378.67	Replace	1	0	Repair	✓ XR
One Time Key In	Main			EMBLEM REAR	1	60.30	60.30	25.00	45.22	Replace	1	45.22	Replace	✓ N/A
One Time Key In	Main			NAME PLATE (HYBRID)	1	51.90	51.90	25.00	38.92	Replace	1	38.92	Replace	✓ N/A
One Time Key In	Main			NAME PLATE (PRUIS)	1	60.80	60.80	25.00	45.60	Replace	1	45.60	Replace	✓ N/A

Total Spare Part Cost 15,430.84

Surveyor Total 5,128.20

Lump Sum Discount (%) 20.00

Lump Sum Dis (%) 20

Final Spare Part Cost 12,344.67

Final Sur Total 4,102.56

BOM Type	Costing Type	Portion	Material Number	SMRT Recommendation							Surveyor Approval			
				Part Name	Qty	List Price Per Unit(\$)	List Price(\$)	Dis(%)	Final Price(\$)	Repair/Replace	Surveyor Quantity	Surveyor Final Price(\$)	Repair/Replace	Remarks
One Time Key In	Main			NAME PLATE (TOYOTA)	1	51.90	51.90	25.00	38.92	Replace	1	38.92	Replace	Na
One Time Key In	Main			NUMBER PLATE	1	15.00	15.00	0.00	15.00	Replace	0	0	Not Give	X
One Time Key In	Main			NUMBER PLATE FRAME	1	12.00	12.00	0.00	12.00	Replace	0	0	Not Give	X
One Time Key In	Main			SMRT LOGO	1	7.80	7.80	0.00	7.80	Replace	1	7.80	Replace	Na
One Time Key In	Main			STICKER DECAL 65558888	1	21.60	21.60	0.00	21.60	Replace	1	21.60	Replace	Na
One Time Key In	Main			SPOILER REAR	1	953.70	953.70	25.00	715.28	Replace	0	0	Not Give	X
One Time Key In	Main			DOOR RR/RH	1	954.50	954.50	25.00	715.88	Replace	1	0	Repair	X R
One Time Key In	Main			DOOR HINGE LOWER RR/RH	1	90.10	90.10	25.00	67.57	Replace	0	0	Not Give	X
One Time Key In	Main			DOOR HINGE UPPER RR/RH	1	90.10	90.10	25.00	67.57	Replace	0	0	Not Give	X
One Time Key In	Main			CHECK ASSY, RR DOOR,	1	150.30	150.30	25.00	112.73	Replace	0	0	Not Give	X
One Time Key In	Main			FENDER RR/RH	1	766.80	766.80	25.00	575.10	Replace	1	0	Repair	X R
One Time Key In	Main			SMRT LOGO	1	7.80	7.80	0.00	7.80	Replace	1	7.80	Replace	Na
One Time Key In	Main			STICKER DECAL 65558888	1	21.60	21.60	0.00	21.60	Replace	1	21.60	Replace	Na
One Time Key In	Main			FENDER LINE RR/RH	1	141.30	141.30	25.00	105.98	Replace	0	0	Check	X
One Time Key In	Main			TAIL LAMP BRACKET, RH	1	30.70	30.70	25.00	23.02	Replace	1	23.02	Replace	BR

Total Spare Part Cost 15,430.84

Surveyor Total 5,128.20

Lump Sum Discount (%) 20.00

Lump Sum Dis (%) 20

Final Spare Part Cost 12,344.67

Final Sur Total 4,102.56

SMRT Recommendation										Surveyor Approval				
BOM Type	Costing Type	Portion	Material Number	Part Name	Qty	List Price Per Unit(\$)	List Price(\$)	Dis(%)	Final Price(\$)	Repair/ Replace	Surveyor Quantity	Surveyor Final Price(\$)	Repair/Replace	Remarks
One Time Key In	Main			TAIL LAMP RH	1	557.80	557.80	10.00	502.02	Replace	1	502.0	Replace	✓ <i>copy</i>
One Time Key In	Main			TAIL LAMP LH	1	548.40	548.40	10.00	493.56	Replace	0	0	Not Give	✓ <i>X</i>
One Time Key In	Main			WHEEL DISC	1	1,484.20	1,484.20	25.00	1,113.15	Replace	0	0	Not Give	✓ <i>X</i>
One Time Key In	Main			TYRE	1	126.74	126.74	0.00	126.74	Replace	0	0	Not Give	✓ <i>X</i>
One Time Key In	Main			WHEEL HUB REAR	1	489.40	489.40	25.00	367.05	Replace	0	0	Not Give	✓ <i>X</i>
One Time Key In	Main			FENDER RR/LH	1	766.80	766.80	25.00	575.10	Replace	0	0	Not Give	✓ <i>X</i>
One Time Key In	Main			SMRT LOGO	1	7.80	7.80	0.00	7.80	Replace	0	0	Not Give	✓ <i>X</i>
One Time Key In	Main			STICKER DECAL 65558888	1	21.60	21.60	0.00	21.60	Replace	0	0	Not Give	✓ <i>X</i>
Total Spare Part Cost									15,430.84	Surveyor Total		5,128.20		
Lump Sum Discount (%)									20.00	Lump Sum Dis (%)		20		
Final Spare Part Cost									12,344.67	Final Sur Total		4,102.56		

Labour's Cost Detail

S.No.	Costing Type	Job Scope	SMRT Recommendation(\$)	Surveyor Adjustment(\$)	Remarks
1	Main	TO REPAIR REAR PORTION	845.00	700	
Total:			845.00	700.00	

Spray Cost Detail

S.No.	Costing Type	Job Scope	SMRT Recommendation(\$)	Surveyor Adjustment(\$)	Remarks
1	Main	TO RESPRAY REAR BUMPER	378.00	200	
2	Main	TO RESPRAY BUMPER BEAM	180.00	180	
3	Main	TO RESPRAY TAIL GATE	378.00	200	
Total:			3,150.00	1,160.00	

S.No.	Costing Type	Job Scope	SMRT Recommendation(\$)	Surveyor Adjustment(\$)	Remarks
4	Main	TO RESPRAY TAILGATE OUTSIDE GARNISH	180.00	80	
5	Main	TO RESPRAY REAR PANEL	180.00	100	
6	Main	TO RESPRAY REAR SPARE TYRE PANEL	180.00	0	
7	Main	TO RESPRAY REAR SPOILER	180.00	0	
8	Main	TO RESPRAY REAR FENDER RH	378.00	200	
9	Main	TO RESPRAY REAR FENDER LH	378.00	0	
10	Main	TO RESPRAY RIM	180.00	0	
11	Main	TO REPSRAY FRONT & REAR DOOR RH	378.00	200	
12	Main	TO RESPRAY REAR FLOOR SIDE PANEL RH	180.00	0	
Total:			3,150.00	1,160.00	

Other Cost Detail

S.No.	Costing Type	Job Scope	SMRT Recommendation(\$)	Surveyor Adjustment(\$)	Remarks
1	Main	TO DO WHEEL ALIGNMENT / TYRE BALANCING	120.00	0	
2	Main	TO TEST AND REFIX REVERSE SENSOR SYSTEM	120.00	20	
3	Main	TO REMOVE AND REFIX REAR WINDSCREEN	120.00	100	
4	Main	TO REMOVE AND REFIX TAILGATE GLASS	120.00	60	
5	Main	TO REMOVE AND REFIT TYRE RIM (SPRAYING PURPOSE)	120.00	0	
6	Main	TO REPLACE SUNDRY PARTS	100.00	0	
7	Main	TO APPLY RUST-PROOFING ON AFFECTED AREA	100.00	30	
8	Main	TO CHECK WIRING AND SYSTEM FUNCTION	80.00	20	
9	Main	TO WASH AND VACUUM	60.00	0	
10	Main	TOWING CHARGE	56.00	0	
11	Main	TO TRANSFER DOOR MECHANISM	120.00	60	
Total:			1,116.00	290.00	

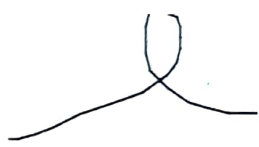

## Summary

	Estimator Assessment(\$)	Surveyor Assessment(\$)
Total Spare Part Detail	12,344.67	4,102.56
Total Labour Cost	845.00	700.00
Total Spray Painting	3,150.00	1,160.00
Other	1,116.00	290.00
Overall Total	17,455.67	6,252.56
Lump Sum Repair Option		<input checked="" type="checkbox"/>
Lump Sum Total	17,450.00	6,250.00
Surveyor Approved Amount		6,250.00
No of Repair Days*	8	6
Remarks	-	L/S, after paint photo.
Surveyor Name		Sun Pin (LKK)
Signature		
		<input type="button" value="Save"/> <input type="button" value="Clear"/>

Survey Date 01/03/2021

LKK Auto Consultants hence notify the Repairer of the following:

- To resurvey before/after spray painting
- To display damaged part(s) during resurvey
- Parts prices are subject to confirmation
- Third party survey is on a "Without Prejudice" basis
- No illegal modification(s) is allowed
- Supplementary item(s) must be resurveyed and is subject to final approval from Insurance Company

Acknowledged by Repairer

Signature:

Date:

[> Back to OneMotoring](#)

## Enquire PARF/COE Rebate for Registered Vehicle

<b>Vehicle Owner Particulars</b>	
Owner ID Type:	Company
Owner ID:	369K
<b>Vehicle Details</b>	
Vehicle No.:	SHD6359K
Vehicle to be Exported:	No
Intended Deregistration Date:	03 Mar 2021
Vehicle Make:	TOYOTA
Vehicle Model:	PRIUS TAXI (SMRT)
Primary Colour:	Maroon
Manufacturing Year:	2015
Engine No.:	2ZR6602275
Chassis No.:	JTDKN36U205768247
Maximum Power Output:	100.0 kW (134 bhp)
Open Market Value:	\$29,508.00
Original Registration Date:	28 Jun 2016
First Registration Date:	28 Jun 2016
Transfer Count:	0
Actual ARF Paid:	\$5,000.00
<b>Intended PARF Rebate Details</b>	
PARF Eligibility:	Yes
PARF Eligibility Expiry Date:	27 Jun 2024
PARF Rebate Amount:	\$3,750.00
<b>Intended COE Rebate Details</b>	
COE Expiry Date:	27 Jun 2024
COE Category:	A - Car up to 1600cc & 97kW (130bhp)
COE Period(Years):	8
PQP Paid:	\$37,164.00
COE Rebate Amount:	\$15,407.00
<b>Total Rebate Amount:</b>	<b>\$19,157.00</b>
<b>Message</b>	
Please note that the 8-year COE for this vehicle cannot be further renewed. The vehicle must be de-registered upon COE expiry or when the vehicle reaches its statutory lifespan (if applicable), whichever is earlier.	

The information contained herein is correct as at 03 Mar 2021

OK