

SINGAPORE ACCIDENT STATEMENT

IMPORTANT NOTICE

1. Please report correctly the details of the accident to speed up the claims process.
2. This Form must be completed by the Policyholder and/or the Authorised Driver
3. Information provided must be as truthful and accurate as possible. Any wilful misrepresentation or withholding of material facts may allow insurance companies to repudiate policy liability.
4. The issue and acceptance of this Form by insurance companies is not an admission of policy liability on the part of the insurance companies.
5. **Any false reporting may be referred to the Police for investigation.**
6. This report will be forwarded by the insurers of the GIA Records Management Centre established by the General Insurance Association of Singapore (GIA) for archiving and that copies of this report will, for a fee, be made available upon application by interested parties.
7. By the lodgement of this report to the insurers, you hereby consent to the archiving of this report at the centre and to copies of the report being made available aforesaid.

ACCIDENT STATEMENT

Date of Submission 18/02/2021 18:00 (SGT)
Date of Accident 17/02/2021 16:15 (SGT)
Exact Location of Accident 209 Yishun Street 21, Singapore 760209
Additional Location Information -
Country/State of Loss Singapore

DETAILS OF OWN VEHICLE

Vehicle Registration Number GY9276Y

INSURED/POLICYHOLDER

Is company? Yes
Name Of Registered Owner OUTBOARD MOTOR SERVICE PTE LTD
Company Reg No 2XXXXX324K
Email Address BLAZEONG@GMAIL.COM
Mobile Phone No (Phone) +65-96493387
Alternative Phone No +65-96493387

VEHICLE PARTICULARS

Manufacturer Toyota
Model Hiace
Variant -
Exact purpose for which vehicle was being used at time of accident Employment
Are you claiming under your own insurance policy for repair to your vehicle? No - Claiming third party
Vehicle Category Commercial vehicle

INSURANCE COMPANY

Name of Insurance Company NTUC
Type of Coverage ThirdPartyFireTheft
Fleet Policy No
Policy Number 5119158856
Cover Note Number -

DRIVER

Name of Driver ONG JENG FONG,DAN(WANG JIANFANG)
NRIC No SXXXX812G
Date Of Birth 28/10/1986
Occupation Outdoor

Date Of Driving Pass	28/06/2007
Driving experience	13 YEARS AND 8 MONTHS
Gender	Male
Mobile Number	(Phone) +65-96493387
Alt. Phone Number	-
Email Address	BLAZEONG@GMAIL.COM
Address	BLK 254 YISHUN RING RD
Address complement	#08-1097
Postcode	760254
Is the driver the policyholder?	No
If No, Relationship of the Driver with the Insured	Employee
Does Driver Own Other Vehicles?	No
Vehicle Registration Number of Other Vehicle Owned by Driver	-
Insurance Company of Other Vehicle Owned by Driver	-

GENERAL INFORMATION OF THE ACCIDENT

Type of Accident	Side Swipe
Weather Conditions	Clear
Road Surface	Dry

OTHER INFORMATION

Was any foreign vehicle involved in the accident?	No
Number of vehicles involved in the accident	2
Was anybody injured in the Accident?	No
Was any injured conveyed to hospital by ambulance?	-
Was any other material or property damaged?	Yes
Number of Passengers (Including Driver)	1
Has the driver been approached by unknown person(s) soliciting/offering accident claims assistance?	No

DETAILS OF POLICE ACTION

Was the accident reported to the police?	No
Was notice of intended Prosecution given?	No
If yes, against whom?	-

CIRCUMSTANCES OF ACCIDENT

PLS REFER TO THE ATTACHED STATEMENT.

ATTACHMENT(S)

Are accident photos available for attachment?	Yes
Was there any video captured by Car Camera?	No
Was there any audio recorded?	No

DETAILS OF OTHER VEHICLE PROPERTY 1

Vehicle Registration Number	SMP6592E
Vehicle Manufacturer	-
Vehicle Model	-
Vehicle Variant	-
Vehicle Colour	-
Vehicle Category	Private car
Name of Driver	-
Contact Number	-
Address	-
Address complement	-
Postcode	-
Insurance Company Name	-

Nature Of Damage	-
Details of property damaged in accident	-
No. Of Passenger (Including Driver)	-

SKETCH PLAN

IMPORTANT NOTICE

1. Please report correctly the details of the accident to speed up the claims process.
2. This form must be completed by the Policyholder and/or the Authorised Driver.
3. Information provided must be as truthful and accurate as possible. Any wilful misrepresentation or withholding of material facts may allow insurance companies to repudiate policy liability.
4. The issue and acceptance of this form by insurance companies is not an admission of policy liability on the part of the insurance companies.
5. Any false reporting may be referred to the Police for investigation.
6. The report will be forwarded by the insurers of the GIA Records Management Centre established by the General Insurance Association of Singapore (GIA) for archiving and that copies of this report will for a fee be made available upon application by interested parties.
7. By the lodgment of this report to the insurers, you hereby consent to the archiving of this report at the centre and to copies of the report being made available aforesaid.
8. **Consent under the Personal Data Protection Act (PDPA)**
I understand, acknowledge, agree and consent that:
 - (a) My insurer, my workshop and the General Insurance Association of Singapore ("GIA") may/are permitted to collect, use, disclose and/or process my personal data/personal information set out in this [form] and any other personal information provided by me or possessed by my insurer (collectively the "Personal Information") and disclose and transfer such Personal Information to all insurer(s) who have insured vehicle(s) involved in this accident (all insurer(s) who have insured vehicle(s) involved in this accident shall be collectively referred to as the "Insurers"), the Insurers' lawyers/law firms, the Monetary Authority of Singapore and any relevant government agency/authority (such as the police), for the purpose(s) of
 - (i) processing, handling and/or dealing with my claims including the settlement of the claims and any necessary investigations relating to the claims;
 - (ii) investigating the accident and/or my claims;
 - (iii) carrying out and/or dealing with my instructions or responding to any enquiries by me;
 - (iv) administering my claims (including the mailing of correspondence, statements, invoices, reports or notices to me, which could involve disclosure of certain personal data about me to bring about delivery of the same as well as on the external cover of envelopes/mail packages); and/or
 - (v) complying with applicable law in administering, processing, handling and/or dealing with my claims (collectively the "Purposes")
 - (b) all insurer(s) who have insured vehicle(s) involved in this accident and the Insurers' lawyers/law firms, may/are permitted to collect, use, disclose and/or process my Personal Information for one or more of the above Purposes; and
 - (c) my Personal Information may/can be disclosed by any of the Insurers and/or GIA to their third party service providers or agents (including their lawyers/law firms), which may be sited outside of Singapore, for one or more of the above Purposes.
 - (d) my Personal Information will also be collected and used to compile claims history for the purpose of fraud detection, investigation and management in present and all future claims.
 - (e) the information so collected under (d) above may be shared / disclosed:
 - (i) to all insurers and/or any other third parties that assist in evaluating, investigating, controlling or managing fraud, regulators, law enforcement and government agencies as reasonably required for the purposes stated, or
 - (ii) for complying with requirements under any regulations, laws or court orders.

**OUTBOARD
MOTOR**
Policyholder's Signature
(Date & Time: _____)

Driver's Signature
(If driver is not the policyholder)
Date & Time: _____

Reporting Centre Personnel's Signature
Name: _____
NRIC/FIN No.: _____

Scanned with CamScanner

SKETCH PLAN

Vehicle A: GY9276Y

Vehicle B: SMP6592E

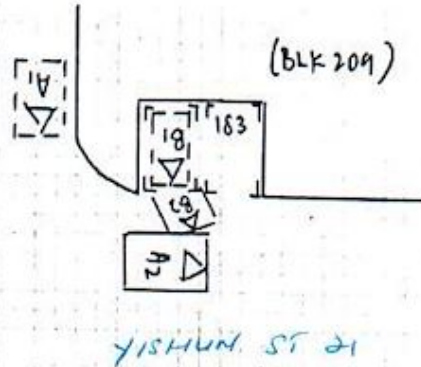

DESCRIBE CIRCUMSTANCES OF THE ACCIDENT

On the stated date & time, I, vehicle A,
 GY9276Y was travelling along the stated vehw.
 Suddenly, vehicle 'B', SMP6592E, exited from
 the carpark lot and collided onto my vehicle's
 left portion.

DECLARATION

I/We declare the foregoing particulars are true in every respect.

OUTBOARD
 MOTOR
 Policyholder's Signature
 Date & Time:

Driver's Signature
 (If driver is not the policyholder)
 Date & Time:

Reporting Centre Personnel's Signature
 Name:
 NRIC/FIN No.:

Scanned with CamScanner

























