



CYCLE & CARRIAGE

CYCLE & CARRIAGE KIA PTE LTD
PANDAN GARDENS CUSTOMER SERVICE CENTRE
 209 Pandan Gardens Singapore 609339 Tel: 65684555 Fax: 65651240



Co Reg No : 199405410K

ESTIMATE

GST Reg No : MR-8500111-X

Invoice Name & Address	Owner Name & Vehicle Info	
AIG Asia Pacific Insurance Pte. Ltd. MOTOR CLAIM DEPARTMENT 78 SHENTON WAY #09-16 AIG BUILDING SINGAPORE 079120 Contact No 64191000	Cust No/Name	/CHUA PENG GEE (CAI BINGYI)
	Reg No/Reg Date	SMT2410C / 02/04/202
	Date In/Mileage	/ 0
	Chassis No	KNAF3416ML5069636
	Engine No	G4FGKH755885
	Make/Model	KIA/CERATO 1.6 A EX G333
	Colour/Trim	CR5 RUNWAY RED / WK SATURN BLACK

Account No	Terms	Date/Time Printed	CSE	Operator	WIP No			
LAX00000	Credit	03/02/2021/ 16:12	BLE	261 / Edwin Caina	28536			
Description of Goods / Services					Qty	Unit Price	Disc%	Amount
E PNT88000								1600.00
RENEW FRT BUMPER								
REPAIR / ALIGN RHF FENDER								
E PNT98000								960.00
RESPRAY FRT BUMPER & RHF FENDER								
E PNT88000								100.00
REMOVE / REFIT AC COND & RADIATOR								
M SUNDRY								80.00
TOP UP AC GAS								
A 54900099								30.00
CHECK WIRING ELECTRICAL SYSTEM								
A 10028901								120.00
TO CARRY OUT DIAGNOSTIC CHECK USING HI-SCAN PRD TEST								
USING HI-SCAN PRO TEST								
M SUNDRY								30.00
RENEW RHF SPORT RIM , TRANSFER TYRE & WHEEL BALANCING								
M SUNDRY								480.00
SUPPLY RHF SPORT RIM -16" S8004								
M SUNDRY								20.00
Sundries								
M COVER-FR BUMPER					1.00	633.00	20.00	506.40
M GRILLE-FRONT BUMPER					1.00	262.00	20.00	209.60
M BRACKET-FR BUMPER UPR SIDE MTG					1.00	22.00	20.00	17.60
M MOULDING-FRONT BUMPER,RH					1.00	36.00	20.00	28.80
M LAMP ASSY-SIDE REPEATER,RH					1.00	143.00	20.00	114.40
M AIR DUCT-FR BUMPER,RH					1.00	14.00	20.00	11.20
M ORNAMENT-KIA NO.115					1.00	32.00	20.00	25.60
M GUARD ASSY-FRONT WHEEL,RH					1.00	95.00	20.00	76.00
M LAMP ASSY-HEAD,RH					1.00	1219.00	20.00	975.20
M CARRIER ASSY-FRONT END MODULE					1.00	675.00	20.00	540.00

Confirm & accepted by

7% GST on	Nett 5924.80	5,924.80 414.74
Total Payable		6,339.54

Authorized signatory and company stamp

Validity of this estimate is 14 days from date of quote. This is a computer generated document, no signature is required. Estimated costs quoted are excluding GST. We would mention that the above estimate is based on our initial inspection and does not include any additional parts or labour which may be required after repair work has commenced. Occasionally worn or damaged parts are discovered after work has started and needed for repairs or replacement. However, should this occur, we would advise you. Please be informed that a deposit of 50% of the above estimate is payable before commencement of the work. Payment for this may be made in cash, credit card or cheque. You must also agree to pay full amount for renewal of the windscreen in the event of inadvertent breakage in the course of renewing the rubber seal or other repair requiring the removal of the windscreen.

SINGAPORE ACCIDENT STATEMENT

IMPORTANT NOTICE

1. Please report correctly the details of the accident to speed up the claims process.
2. This Form must be completed by the Policyholder and/or the Authorised Driver
3. Information provided must be as truthful and accurate as possible. Any wilful misrepresentation or withholding of material facts may allow insurance companies to repudiate policy liability.
4. The issue and acceptance of this Form by insurance companies is not an admission of policy liability on the part of the insurance companies.
5. Any false reporting may be referred to the Police for investigation.
6. This report will be forwarded by the insurers of the GIA Records Management Centre established by the General Insurance Association of Singapore (GIA) for archiving and that copies of this report will, for a fee, be made available upon application by interested parties.
7. By the lodgement of this report to the insurers, you hereby consent to the archiving of this report at the centre and to copies of the report being made available aforesaid.

ACCIDENT STATEMENT

Date of Submission	03/02/2021 16:06 (SGT)
Date of Accident	03/02/2021 12:00 (SGT)
Exact Location of Accident	1 Raffles Place, Singapore 048616
Additional Location Information	TOPIARY CONDO ENTRANCE-SENGKANG
Country/State of Loss	Singapore

DETAILS OF OWN VEHICLE

Vehicle Registration Number	SMT2410C
-----------------------------	----------

INSURED/POLICYHOLDER

Is company?	No
Name Of Registered Owner	CHUA PENG GEE
NRIC No	SXXXX242H
Email Address	TCHUA100168@YAHOO.COM.SG
Mobile Phone No	(Phone) +65-96625088
Alternative Phone No	+65-96625088

VEHICLE PARTICULARS

Manufacturer	Kia
Model	Cerato
Variant	-
Exact purpose for which vehicle was being used at time of accident	-
Are you claiming under your own insurance policy for repair to your vehicle?	Yes
Vehicle Category	Private car

INSURANCE COMPANY

Name of Insurance Company	AIG
Type of Coverage	Comprehensive
Fleet Policy	No
Policy Number	2070060616
Cover Note Number	-

DRIVER

Name of Driver	CHUA PENG GEE
NRIC No	SXXXX242H
Date Of Birth	19/06/1978
Occupation	Indoor

Date Of Driving Pass	06/01/1999
Driving experience	22 YEARS AND 1 MONTH
Gender	Male
Mobile Number	(Phone) +65-96625088
Alt. Phone Number	+65-96625088
Email Address	TCHUA100168@YAHOO.COM.SG
Address	BLK 435A FERNVALE ROAD #15-198
Address complement	-
Postcode	791435
Is the driver the policyholder?	Yes
If No, Relationship of the Driver with the Insured	-
Does Driver Own Other Vehicles?	No
Vehicle Registration Number of Other Vehicle Owned by Driver	-
Insurance Company of Other Vehicle Owned by Driver	-

GENERAL INFORMATION OF THE ACCIDENT

Type of Accident	Collided into Property
Weather Conditions	Clear
Road Surface	Dry

OTHER INFORMATION

Was any foreign vehicle involved in the accident?	No
Number of vehicles involved in the accident	1
Was anybody injured in the Accident?	No
Was any injured conveyed to hospital by ambulance?	-
Was any other material or property damaged?	No
Number of Passengers (Including Driver)	2
Has the driver been approached by unknown person(s) soliciting/offering accident claims assistance?	No

PASSENGER 1

Name	LEE LIXUE CANDICE
Gender	Female

DETAILS OF POLICE ACTION

Was the accident reported to the police?	No
Was notice of intended Prosecution given?	No
If yes, against whom?	-

CIRCUMSTANCES OF ACCIDENT

REFER TO ATTACHMENT

ATTACHMENT(S)

Are accident photos available for attachment?	Yes
Was there any video captured by Car Camera?	Yes
Was there any audio recorded?	No

SKETCH PLAN

IMPORTANT NOTICE

1. Please report **correctly** the details of the accident to speed up the claims process.
2. This Form must be **completed by the Policyholder and/or the Authorised Driver**.
3. Information provided must be as **truthful and accurate as possible**. Any wilful misrepresentation or withholding of material facts may allow insurance companies to **repudiate policy liability**.
4. The issue and acceptance of this Form by insurance companies is not an admission of policy liability on the part of the insurance companies.
5. **Any false reporting may be referred to the Police for investigation**.
6. The report will be forwarded by the insurers of the GIA Records Management Centre established by the General Insurance Association of Singapore (GIA) for archiving and that copies of this report will for a fee be made available upon application by interested parties.
7. By the lodgement of this report to the insurers, you hereby consent to the archiving of this report at the centre and to copies of the report being made available aforesaid.

8. Consent under the Personal Data Protection Act (PDPA)

I understand, acknowledge, agree and consent that :

(a) My insurer, my workshop and the General Insurance Association of Singapore ("GIA") may/are permitted to collect, use, disclose and/or process my personal data/personal information set out in this [form] and any other personal information provided by me or possessed by my insurer (collectively the "Personal Information") and disclose and transfer such Personal Information to all insurer(s) who have insured vehicle(s) involved in this accident (all insurer(s) who have insured vehicle(s) involved in this accident shall be collectively referred to as the "Insurers"), the Insurers' lawyers/law firms, the Monetary Authority of Singapore and any relevant government agency/authority (such as the police), for the purpose(s) of :

(i) processing, handling and/or dealing with my claims including the settlement of the claims and any necessary investigations relating to the claims;

(ii) investigating the accident and/or my claims;

(iii) carrying out and/or dealing with my instructions or responding to any enquiries by me;

(iv) administering my claims (including the mailing of correspondence, statements, invoices, reports or notices to me, which could involve disclosure of certain personal data about me to bring about delivery of the same as well as on the external cover of envelopes/mail packages); and/or

(v) complying with applicable law in administering, processing, handling and/or dealing with my claims.

(collectively the "Purposes")

(b) all insurer(s) who have insured vehicle(s) involved in this accident and the Insurers' lawyers/law firms, may/are permitted to collect, use, disclose and/or process my Personal Information for one or more of the above Purposes; and

(c) my Personal Information may/can be disclosed by any of the Insurers and/or GIA to their third party service providers or agents (including their lawyers/law firms), which may be sited outside of Singapore, for one or more of the above Purposes.

Policyholder's Signature / Date &
Time 3/2/2021
1:55pm

Driver's Signature (If driver is not the policyholder) / Date
& Time 3/2/2021
1:55pm

Witnessed by Reporting Centre
Personnel

Sketch Plan

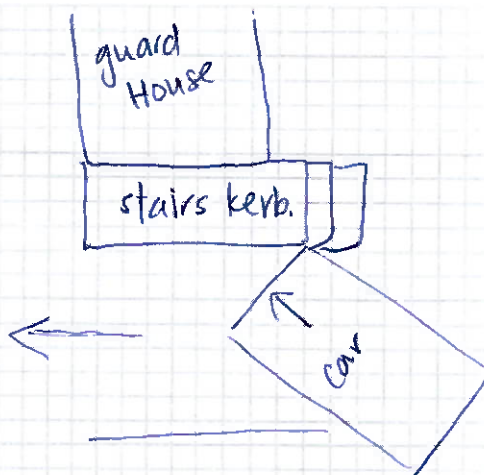

Describe Circumstances of the Accident

Visit to condo (Topiary), car turned left from main road at guardhouse.

There was a ~~blind spot~~ stairs without railings in front of the elevated guard house. It was a blind spot from driver's view. Car hit the staircase kerb upon turning left and bumper detached.

Declaration

We declare the foregoing particulars are true in every respect.

 3/2/2021
1:55pm

Policyholder's Signature / Date & Time

 3/2/2021
1:55pm

Driver's Signature (If driver is not the policyholder) / Date & Time



Witnessed by Reporting Centre Personnel



CERTIFICATE OF INSURANCE

KIA AUTO PROTECTOR PRIVATE VEHICLE

Name of Policyholder : CHUA PENG GEE (CAI BINGYI)
Period of Insurance : 02 Apr 2020 To 01 Apr 2022
Engine No. : G4FGKH755885
Chassis No. : KNAF3416ML5069636

Vehicle No. : SMT2410C
Policy No. : 2070060616
Endorsement No. :
Issued Date : 07 Apr 2020

ABOUT THE COVER

Make/Model : KIA Cerato
Engine Capacity/Tonnage : 1,591.00 CC
Driver Restriction : NA
Sum Insured : Market Value
Off Peak Car : No
First Year of Registration : 2020
Insuring with COE/PAF : Yes

Person or Classes of Persons Entitled to Drive* :

- a) The Policyholder
b) Any other person who is driving on the Policyholder's order or with his/her permission.
This Policy will indemnify the Policyholder or any authorised driver only if he/she meets the specified age condition.

You have to pay an additional sum of \$3,000 as "Young and/or Inexperienced Driver Excess" ("YIDR") if You are or Your Authorised Driver (named or unnamed) is under the age of 23 and/or has less than 2 years' driving experience.

Age Condition : All Age Condition

Limitation as to use* :

Use only for social, domestic and pleasure purposes and for the Policyholder's business.
This Policy does not cover use for hire or reward, driving tuition, driving test, racing, pace-making, reliability trial or speed-testing, the carriage of goods other than samples in connection with any trade or business or use for any purpose in connection with Motor Trade

Loss of Use 1500cc - 1600cc

* Limitations rendered inoperative by Section 8 of the Motor Vehicles (Third-Party Risks and Compensation) Act (Cap. 189), Section 95 of the Road Transport Act, 1987 (Malaysia) and Road Transport (Amendment) Act 2019, are not to be included under these headings

EXCESS

Section 1

Fire - \$0 Own Damage - \$600 Theft - \$0 Flood Cover - \$600

Section 2

Property Damage - \$0

Windscreen : \$100

Named Driver and Excess (where applicable)

CHUA PENG GEE (CAI BINGYI) - \$600 (Own Damage), \$600 (Flood Cover)

APPROVED REPORTING CENTRES/AUTHORISED REPAIRERS (FOR CLAIMS RELATED REPAIRS)

- 1 Cycle & Carriage Body & Paint Centre Add: 209 Pandan Gardens Singapore 609339 65684501
2 Cycle & Carriage Authorised Service Centre (For accident reporting & windscreen claim only) Add: 330 Ubi Rd 3 Singapore 408650 67461000
3 Cycle & Carriage Authorised Service Centre (For accident reporting & windscreen claim only) Add: 241 Alexandra Road Singapore 159931 64278800
4 Cycle & Carriage Authorised Service Centre (For accident reporting & windscreen claim only) Add: 600 Sin Ming Ave Singapore 575733 69328000

For other Approved Reporting Centres/AIG Authorised Repairers, please contact our 24-hour accident emergency hotline at +65 6338 6200. Alternatively, you may refer to AIG website www.aig.sg or AIG SG Mobile App. Simply search and download "AIG SG" from iTunes or Google Play.

IMPORTANT NOTES

Hire Purchase Company/Employer's Loan: United Overseas Bank Limited

We hereby certify that the policy to which this Certificate of Insurance relates is issued in accordance with the provisions of the Motor Vehicles (Third Party Risks and Compensation) Act (Cap. 189), Part IV of the Road Transport Act, 1987 (Malaysia), Road Transport (Amendment) Act 2019 and Motor Vehicles (Third Party Risks) Rules, 1959 (Malaysia).

0504671227

CYCLE & CARRIAGE - ALVIN

239 ALEXANDRA ROAD

SINGAPORE 159930

Underwritten by AIG Asia Pacific Insurance Pte. Ltd.

AIG Asia Pacific Insurance Pte. Ltd.

This computer generated document does not require a signature.

SSCNMD

UNDERTAKING

I, CHUA PENG GEE, (NRIC No. _____), hereby confirm that the Singapore Accident Statement lodged by me on 3/2/2021 at 1300 hours pertaining to the accident involving motor car Reg. No: SMT 2410 in which I was the driver are true and accurate to the best of my knowledge, information and belief.

I acknowledge that my insurers are not liable under the contract of insurance if there is a breach of policy terms and conditions.

In the event that an unrelated/unreported third party property or injury claim arises or there is evidence emerges that there is a breach of policy terms and conditions, I irrevocably undertake to absolve my insurer from all liability under the contract of insurance and I undertake to re-pay any sums paid by my insurers pursuant to the contract of insurance upon receipt of written demand by my insurers.

Signature

:



Name of Insured / Driver

:

CHUA PENG GEE

Nric No.

:

Date

:

3/2/2021

Signature

:



Name of Policyholder

:

CHUA PENG GEE

Nric No.

:

Date

:

3/2/2021



AIG Asia Pacific Insurance Pte. Ltd
AIG Building
78 Shenton Way
#07-16

MOTOR ACCIDENT INTERVIEW FORM

NAME : CHUA PENG GEE
VEHICLE NUMBER : SMT 2410C
DATE/ TIME OF ACCIDENT : 03 FEB 2021
PLACE OF ACCIDENT : TOPAIRY CONDO ENTRANCE - SENG KANG
THIRD PARTY VEHICLE (IF ANY) : H

WHERE DID YOU START YOUR JOURNEY AND WHERE WAS THE INTENDED DESTINATION BEFORE THE ACCIDENT?

Home to Condo (Topiary).

DID YOU DRINK ANY ALCOHOLIC DRINKS BEFORE YOU DRIVE ON THE DAY OF THE ACCIDENT? IF YES, DID THE TRAFFIC POLICE CONDUCT ANY BREATHE-ANALYSER TEST ON YOU? IF YES, WHAT WAS THE RESULTS?

No

WHAT IS THE TYPE OF COLLISION AND THE EXTENSIVENESS OF THE DAMAGES TO ALL VEHICLES INVOLVED?

Self accident.

WERE YOU OR YOUR PASSENGER/S INJURED? IF INJURED, WHICH HOSPITAL? WERE YOU TAKEN TO THE TRAFFIC POLICE FOR INVESTIGATION?

No

NAME:

I AFFIRMED THE ABOVE INFORMATION IS GIVEN TO MY BEST KNOWLEDGE