

ASS. REC. BY:

Stew

REF:

ASSIGNMENT

From:

Date:

Estimated Cost:

☒ OD / ☐ TP / ☐ WS / ☐ TP RES / ☐ OD RES / ☐ EVA / ☐ INV / ☐ MV

To Inspect Vehicle No:

at Workshop m/s

of

Insured:

Policy No.

Claims No.

Sum Insured:

Excess:

(Client's Record)

Make of Veh:

(Policy Condition)

 Remark: The veh had commenced its
repair at the time of inspection.

N/S	O/S

Bal. or Market Value:

IDAC Accident Report:

Consistent? : Yes or No

GIA / PR Seen:

Consistent? : Yes or No

Est. Repairs:

days

Res.: Yes or No

Cum Sum:

%

3 Val.: Yes or No

CA / REV / REP. / 24 HRS

Vehicle: IN / OUT

Date: Person Contacted:

Veh No:

SMT 2419C

Yr Regn:

2/4/22

Type: ☒ M.Car / ☐ M.Cycle / ☐ Bus / ☐ Van / ☐ Lorry / ☐ Taxi / ☐ Prime Mover /

Truck / Trailer or

Make:

KIA Cerato

c.c. 1591

Colour:

Red

A/C: Insured / Std / Nil / N

Sp. Reading

8377

T/Radio: Insured / Std / Nil / N

Eng/No:

C/No:

KNAF3416 ML 5069636

Gen. Cond: Good / Fair / Poor / Burnt

Steering: In order / Jammed / Leaked / Burnt or

Brake: In order / Jammed / Leaked / Burnt or

Modl: Nil / S/Rim / STD A/Rim or

Tyre Size:

F:

205/55 R16

R:

11

 BS / DUN / EXNOVA / GY / FS / LIZA / MIC / OHTSU / PIR / SUMI /
TOYO / YOKO or NEXEN

Front

Rear

R/Bal.

5

mm

R/Bal.

5

mm

L/Bal.

5

mm

L/Bal.

5

mm

D.O.A.

3/2/21

D.O.I.

3/2/21

Survey held at

Cycle & carage

Des. of Damages: Frt / Rear / O/S / N/S / U/C / Rooftop or

Frt RH

The U/C / Chassis frame / Body Structure affected due to collision

Date / Time

Action / Instruction

MV- 79K

Date/Time, File Pass to?

☐

Prell. Report

☐

Final Report

Date/Time, File Return to?

Days Of Repair:

Resurvey No. of Trip:

Survey Fee:

Transportation:

Add Fee:

☐

Site Insp (\$

☐

Interview (\$

☐

Tech. Invs (\$

☐

Weekend (\$

S + RS \$

Photos

Others

TOTAL

Rep. Format:

Comp. Sum / L.B. / C.



CYCLE & CARRIAGE

CYCLE & CARRIAGE KIA PTE LTD
PANDAN GARDENS CUSTOMER SERVICE CENTRE

209 Pandan Gardens Singapore 609339 Tel 65684555 Fax 65651240

**ESTIMATE**

Co Reg No : 199405410K

GST Reg No : MR-8500111-X

Invoice Name & Address	Owner Name & Vehicle Info
AIG Asia Pacific Insurance Pte. Ltd. MOTOR CLAIM DEPARTMENT 78 SHENTON WAY #09-16 AIG BUILDING SINGAPORE 079120 Contact No 64191000	Cust No/Name /CHUA PENG GEE (CAI BINGYI) Reg No/Reg Date SMT2410C / 02/04/202 Date In/Mileage / 0 Chassis No KNAF3416ML5069636 Engine No G4FGKH755885 Make/Model KIA/CERATO 1.6 A EX G333 Colour/Trim CR5 RUNWAY RED / WK SATURN BLACK

Account No	Terms	Date/Time Printed	CSE	Operator	WIP No			
LAX00000	Credit	03/02/2021/ 15:46	BLE	261 / Edwin Caina	28536			
Description of Goods / Services					Qty	Unit Price	Disc%	Amount
E PNT88000 RENEW FRT ¹ BUMPER REPAIR / ALIGN RHF FENDER								1600.00
E PNT98000 RESPRAY FRT ¹ BUMPER & RHF ¹ FENDER (CCRS colour)								960.00
E PNT88000 REMOVE / REFIT AC COND & RADIATOR								100.00
M SUNDRY TOP UP AC GAS								80.00
A 54900099 CHECK WIRING ELECTRICAL SYSTEM								30.00
A 10028901 TO CARRY OUT DIAGNOSTIC CHECK USING HI-SCAN PRO TEST USING HI-SCAN PRO TEST								120.00
M SUNDRY RENEW RHF SPORT RIM , TRANSFER TYRE & WHEEL BALANCING								30.00
M SUNDRY SUPPLY RHF SPORT RIM -16" S8004								480.00
M SUNDRY Sundries								20.00
M COVER-FR BUMPER					1.00	633.00	20.00	506.40
M GRILLE-FRONT BUMPER					1.00	262.00	20.00	209.60
M BRACKET-FR BUMPER UPR SIDE MTG					1.00	22.00	20.00	17.60
M MOULDING-FRONT BUMPER,RH					1.00	36.00	20.00	28.80
M LAMP ASSY-SIDE REPEATER,RH					1.00	143.00	20.00	114.40
M AIR DUCT-FR BUMPER,RH					1.00	14.00	20.00	11.20
M ORNAMENT-KIA NO.115					1.00	32.00	20.00	25.60
M GUARD ASSY-FRONT WHEEL,RH					1.00	95.00	20.00	76.00
M LAMP ASSY-HEAD,RH					1.00	1219.00	20.00	975.20
M CARRIER ASSY-FRONT END MODULE					1.00	675.00	20.00	540.00

Estimate

400

Stev CLKK 3/2/21, 4.10pm

DD- AM AL

SURVEYOR NAME:

SURVEYOR NAME :

SURVEYOR SIGNATURE :

Confirm & accepted by

the Repairer of the following:

- To resurvey before/after spray painting
- To display damaged part(s) during resurvey
- Parts prices are subject to confirmation
- Third party survey is on a "Without Prejudice" basis

Authorized signatory and company stamp

DATE :

REMARKS :

7% GST on

Nett

5924.80

5,924.80

414.74

Total Payable

6,339.54

Validity of this estimate is 14 days from date of quote. This is a computer generated document, no signature is required. Estimated costs quoted are excluding GST. We would mention that the above estimate is based on our initial inspection and does not include any additional parts or labour which may be required after repair work has commenced. Occasionally worn or damaged parts are discovered after work has started and needed for repairs or replacement. However, should this occur, we would advise you. Please be informed that a deposit of 50% of the above estimate is payable before commencement of the work. Payment for this may be made in cash, credit card or cheque. You must also agree to pay full amount for renewal of the windscreen in the event of inadvertent breakage in the course of renewing the rubber seal or other repair requiring the removal of the windscreen.

SINGAPORE ACCIDENT STATEMENT

IMPORTANT NOTICE

1. Please report correctly the details of the accident to speed up the claims process.
2. This Form must be completed by the Policyholder and/or the Authorised Driver
3. Information provided must be as truthful and accurate as possible. Any wilful misrepresentation or withholding of material facts may allow insurance companies to repudiate policy liability.
4. The issue and acceptance of this Form by insurance companies is not an admission of policy liability on the part of the insurance companies.
5. Any false reporting may be referred to the Police for investigation.
6. This report will be forwarded by the insurers of the GIA Records Management Centre established by the General Insurance Association of Singapore (GIA) for archiving and that copies of this report will, for a fee, be made available upon application by interested parties.
7. By the lodgement of this report to the insurers, you hereby consent to the archiving of this report at the centre and to copies of the report being made available aforesaid.

ACCIDENT STATEMENT

Date of Submission 03/02/2021 16:06 (SGT)
Date of Accident 03/02/2021 12:00 (SGT)
Exact Location of Accident 1 Raffles Place, Singapore 048616
Additional Location Information TOPIARY CONDO ENTRANCE-SENGKANG
Country/State of Loss Singapore

DETAILS OF OWN VEHICLE

Vehicle Registration Number SMT2410C

INSURED/POLICYHOLDER

Is company? No
Name Of Registered Owner CHUA PENG GEE
NRIC No SXXXX242H
Email Address TCHUA100168@YAHOO.COM.SG
Mobile Phone No (Phone) +65-96625088
Alternative Phone No +65-96625088

VEHICLE PARTICULARS

Manufacturer Kia
Model Cerato
Variant -
Exact purpose for which vehicle was being used at time of accident -
Are you claiming under your own insurance policy for repair to your vehicle? Yes
Vehicle Category Private car

INSURANCE COMPANY

Name of Insurance Company AIG
Type of Coverage Comprehensive
Fleet Policy No
Policy Number 2070060616
Cover Note Number -

DRIVER

Name of Driver CHUA PENG GEE
NRIC No SXXXX242H
Date Of Birth 19/06/1978
Occupation Indoor

Driving Pass
experience
Mobile Number
Phone Number
Email Address
Address
Address complement
Postcode
Is the driver the policyholder?
If No, Relationship of the Driver with the Insured
Does Driver Own Other Vehicles?
Vehicle Registration Number of Other Vehicle Owned by Driver
Insurance Company of Other Vehicle Owned by Driver

06/01/1999
22 YEARS AND 1 MONTH
Male
(Phone) +65-96625088
+65-96625088
TCHUA100168@YAHOO.COM.SG
BLK 435A FERNVALE ROAD #15-198
-
791435
Yes
-
No
-
-

GENERAL INFORMATION OF THE ACCIDENT

Type of Accident
Weather Conditions
Road Surface

Collided into Property
Clear
Dry

OTHER INFORMATION

Was any foreign vehicle involved in the accident?
Number of vehicles involved in the accident
Was anybody injured in the Accident?
Was any injured conveyed to hospital by ambulance?
Was any other material or property damaged?
Number of Passengers (Including Driver)
Has the driver been approached by unknown person(s)
soliciting offering accident claims assistance?

No
1
No
-
No
2
No

PASSENGER 1

Name
Gender

LEE LIXUE CANDICE
Female

DETAILS OF POLICE ACTION

Was the accident reported to the police?
Was notice of intended Prosecution given?
If yes, against whom?

No
No
-

CIRCUMSTANCES OF ACCIDENT

REFER TO ATTACHMENT

ATTACHMENT(S)

Are accident photos available for attachment?
Was there any video captured by Car Camera?
Was there any audio recorded?

Yes
Yes
No

SKETCH PLAN

IMPORTANT NOTICE

1. Please report correctly the details of the accident to speed up the claims process.
2. This Form must be completed by the Policyholder and/or the Authorised Driver.
3. Information provided must be as truthful and accurate as possible. Any wilful misrepresentation or withholding of material facts may allow insurance companies to repudiate policy liability.
4. The issue and acceptance of this Form by insurance companies is not an admission of policy liability on the part of the insurance companies.
5. Any false reporting may be referred to the Police for investigation.
6. The report will be forwarded by the insurers of the GIA Records Management Centre established by the General Insurance Association of Singapore (GIA) for archiving and that copies of this report will for a fee be made available upon application by interested parties.
7. By the lodgement of this report to the insurers, you hereby consent to the archiving of this report at the centre and to copies of the report being made available aforesaid.
8. **Consent under the Personal Data Protection Act (PDPA)**
I understand, acknowledge, agree and consent that:
 - (a) My insurer, my workshop and the General Insurance Association of Singapore ("GIA") may/are permitted to collect, use, disclose and/or process my personal data/personal information set out in this [form] and any other personal information provided by me or possessed by my insurer (collectively the "Personal Information") and disclose and transfer such Personal Information to all insurer(s) who have insured vehicle(s) involved in this accident (all insurer(s) who have insured vehicle(s) involved in this accident shall be collectively referred to as the "Insurers"), the Insurers' lawyers/law firms, the Monetary Authority of Singapore and any relevant government agency/authority (such as the police), for the purpose(s) of:
 - (i) processing, handling and/or dealing with my claims including the settlement of the claims and any necessary investigations relating to the claims;
 - (ii) investigating the accident and/or my claims;
 - (iii) carrying out and/or dealing with my instructions or responding to any enquiries by me;
 - (iv) administering my claims (including the mailing of correspondence, statements, invoices, reports or notices to me, which could involve disclosure of certain personal data about me to bring about delivery of the same as well as on the external cover of envelopes/mail packages); and/or
 - (v) complying with applicable law in administering, processing, handling and/or dealing with my claims.
 - (b) all insurer(s) who have insured vehicle(s) involved in this accident and the Insurers' lawyers/law firms, may/are permitted to collect, use, disclose and/or process my Personal Information for one or more of the above Purposes; and
 - (c) my Personal Information may/can be disclosed by any of the Insurers and/or GIA to their third party service providers or agents (including their lawyers/law firms), which may be sited outside of Singapore, for one or more of the above Purposes.

3/2/2021
1:55pm
Policyholder's Signature / Date & Time

3/2/2021
1:55pm
Driver's Signature (If driver is not the policyholder) / Date & Time

Witnessed by Reporting Centre Personnel

Sketch Plan

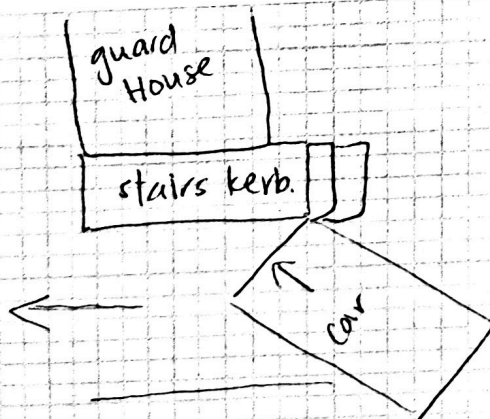

Describe Circumstances of the Accident

Visit to condo (Topiary), car turned left from main road at guardhouse.

There was a ~~blind spot~~ stairs without railings in front of the elevated guard house. It was a blind spot from driver's view. Car hit the staircase kerb upon turning left and bumper detached.

Declaration

We declare the foregoing particulars are true in every respect.

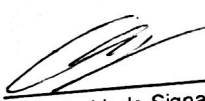
3/2/2021
1:55pm
Policyholder's Signature / Date & Time

3/2/2021
1:55pm
Driver's Signature (If driver is not the policyholder) / Date & Time

Witnessed by Reporting Centre Personnel

CERTIFICATE OF INSURANCE

KIA AUTO PROTECTOR PRIVATE VEHICLE

Name of Policyholder : CHUA PENG GEE (CAI BINGYI)
Period of Insurance : 02 Apr 2020 To 01 Apr 2022
Engine No. : G4FGKH755885
Chassis No. : KNAF3416ML5069636

Vehicle No. : SMT2410C
Policy No. : 2070060616
Endorsement No. :
Issued Date : 07 Apr 2020

ABOUT THE COVER

Make/Model : KIA Cerato
Engine Capacity/Tonnage : 1,591.00 CC
Driver Restriction : NA
Person or Classes of Persons Entitled to Drive* :

Sum Insured : Market Value
Off Peak Car : No

First Year of Registration : 2020
Insuring with COE/PARF : Yes

a) The Policyholder
b) Any other person who is driving on the Policyholder's order or with his/her permission
This Policy will indemnify the Policyholder or any authorised driver only if he/she meets the specified age condition.

You have to pay an additional sum of \$3,000 as "Young and/or Inexperienced Driver Excess" ("YIDR") if You are or Your Authorised Driver (named or unnamed) is under the age of 23 and/or has less than 2 years' driving experience.

Age Condition : All Age Condition

Limitation as to use* :

Use only for social, domestic and pleasure purposes and for the Policyholder's business.
This Policy does not cover use for hire or reward, driving tuition, driving test, racing, pace-making, reliability trial or speed-testing, the carriage of goods other than samples in connection with any trade or business or use for any purpose in connection with Motor Trade.

Loss of Use 1500cc - 1600cc

* Limitations rendered inoperative by Section 8 of the Motor Vehicles (Third-Party Risks and Compensation) Act (Cap. 189), Section 95 of the Road Transport Act, 1987 (Malaysia) and Road Transport (Amendment) Act 2019, are not to be included under these headings.

EXCESS

Section 1
Fire - \$0 Own Damage - \$600 Theft - \$0 Flood Cover - \$600

Section 2
Property Damage - \$0

Windscreen : \$100

Named Driver and Excess (where applicable)

CHUA PENG GEE (CAI BINGYI) - \$600 (Own Damage), \$600 (Flood Cover)

APPROVED REPORTING CENTRES/AUTHORISED REPAIRERS (FOR CLAIMS RELATED REPAIRS)

- 1 Cycle & Carriage Body & Paint Centre Add: 209 Pandan Gardens Singapore 609339 65684501
- 2 Cycle & Carriage Authorised Service Centre (For accident reporting & windscreen claim only) Add: 330 Ubi Rd 3 Singapore 408650 67461000
- 3 Cycle & Carriage Authorised Service Centre (For accident reporting & windscreen claim only) Add: 241 Alexandra Road Singapore 159931 64278800
- 4 Cycle & Carriage Authorised Service Centre (For accident reporting & windscreen claim only) Add: 600 Sin Ming Ave Singapore 575733 69328000

For other Approved Reporting Centres/AIG Authorised Repairers, please contact our 24-hour accident emergency hotline at +65 6338 6200. Alternatively, you may refer to AIG website www.aig.sg or AIG SG Mobile App. Simply search and download "AIG SG" from iTunes or Google Play.

IMPORTANT NOTES

Hire Purchase Company/Employer's Loan: United Overseas Bank Limited

We hereby certify that the policy to which this Certificate of Insurance relates is issued in accordance with the provisions of the Motor Vehicles (Third Party Risks and Compensation) Act (Cap. 189), Part IV of the Road Transport Act, 1987 (Malaysia), Road Transport (Amendment) Act 2019 and Motor Vehicles (Third Party Risks) Rules, 1959 (Malaysia).

0504671227

CYCLE & CARRIAGE - ALVIN

239 ALEXANDRA ROAD
SINGAPORE 159930

Underwritten by AIG Asia Pacific Insurance Pte. Ltd.

AIG Asia Pacific Insurance Pte. Ltd.

This computer generated document does not require a signature.

SSCNMD