



CYCLE & CARRIAGE

CYCLE & CARRIAGE KIA PTE LTD

PANDAN GARDENS CUSTOMER SERVICE CENTRE

209 Pandan Gardens Singapore 609339 Tel: 65684555 Fax: 65651240



Co Reg No : 199405410K

ESTIMATE

GST Reg No : MR-8500111-X

Invoice Name & Address	Owner Name & Vehicle Info
AIG Asia Pacific Insurance Pte. Ltd. MOTOR CLAIM DEPARTMENT 78 SHENTON WAY #09-16 AIG BUILDING SINGAPORE 079120 Contact No 64191000	Cust No/Name LCV10936/LEE YAN JIE Reg No/Reg Date SMN6008L / 20/08/201 Date In/Mileage / 23162 Chassis No KNAF5416MK5050977 Engine No G4FGKH746535 Make/Model KIA/CERATO 1.6 A GT LINE H171 Colour/Trim <u>CR5 RUNWAY RED</u> / WK SATURN BLACK

Account No	Terms	Date/Time Printed	CSE	Operator	WIP No		
LAX00000	Credit	16/01/2021/ 09:26	QUD	247 / DonBong	27485		
Description of Goods / Services				Qty	Unit Price	Disc%	Amount
E PNT88000							2000.00
RENEW ACCIDENT DAMAGED PARTS ON LH REAR DOOR, LH FRONT DOOR,				41112			800
MOULDING ASSY-SIDE SILL, LH, REPAIR LH REAR FENDER, REPAIR REAR BUMPER FACE, REPLACE COVER-RR BUMPER LWR							120.00
E PNT88000							120.00
LABOUR TRANSFER LH REAR DOOR GLASS, DOOR MECHANISM, DOOR TRIM AND OTHERS ATTACHMENT TO NEW PANEL							120.00
E PNT88000							60.00
LABOUR TRANSFER LH FRONT DOOR GLASS, DOOR MECHANISM, DOOR TRIM AND OTHERS ATTACHMENT TO NEW PANEL							2880.00
E PNT98000							2499
PAINT WORK SPRAY LH FRONT DOOR, LH REAR DOOR, MOULDING ASSY-SIDE SILL, LH REAR, FENDER, REAR, BUMPER AND AFFECTED PORTION				480x5			40
M SUNDRY							120.00
APPLY BODY SEALANT							30.00
A 54900099							80.00
CHECK WIRING AND CHASSIS ELECTRICAL SYSTEM							120.00
M SUNDRY							380.00
PERFORM RUST PREVENTION							30.00
A WHEELALIGNMENTBP							400.00
To Conduct Computerize Full Wheel Alignment							120.00
M SUNDRY							30.00
SUPPLY AND RENEW LH REAR TIRE -BURST DUE TO ACCIDENT							400.00
M SUNDRY							120.00
LABOUR RENEW LH REAR SPORT RIM INCLUDING BALANCING							1101.60
A 34900099							
TO RENEW REAR U/CARRIAGE DAMAGES							
A 10028901							
TO CARRY OUT DIAGNOSTIC CHECK USING HI-SCAN PRO TEST USING HI-SCAN PRO TEST				1.00	1377.00	20.00	
M PANEL ASSY-REAR DOOR, LH							

Confirm & accepted by

Authorized signatory and company stamp

Validity of this estimate is 14 days from date of quote. This is a computer generated document, no signature is required. Estimated costs quoted are excluding GST. We would mention that the above estimate is based on our initial inspection and does not include any additional parts or labour which may be required after repair work has commenced. Occasionally worn or damaged parts are discovered after work has started and needed for repairs or replacement. However, should this occur, we would advise you. Please be informed that a deposit of 50% of the above estimate is payable before commencement of the work. Payment for this may be made in cash, credit card or cheque. You must also agree to pay full amount for renewal of the windscreen in the event of inadvertent breakage in the course of renewing the rubber seal or other repair requiring the removal of the windscreen.



CYCLE & CARRIAGE

CYCLE & CARRIAGE KIA PTE LTD

PANDAN GARDENS CUSTOMER SERVICE CENTRE

209 Pandan Gardens Singapore 609339 Tel: 65684555 Fax: 65651240



ESTIMATE

GST Reg No : MR-8500111-X

Co Reg No : 199405410K

Invoice Name & Address	Owner Name & Vehicle Info
AIG Asia Pacific Insurance Pte. Ltd. MOTOR CLAIM DEPARTMENT 78 SHENTON WAY #09-16 AIG BUILDING SINGAPORE 079120 Contact No 64191000	Cust No/Name LCV10936/LEE YAN JIE Reg No/Reg Date SMN600BL / 20/08/201 Date In/Mileage / 23162 Chassis No KNAF5416MK5050977 Engine No G4FGKH746535 Make/Model KIA/CERATO 1.6 A GT LINE H171 Colour/Trim CR5 RUNWAY RED / WK SATURN BLACK

Account No	Terms	Date/Time Printed	CSE	Operator	WIP No			
LAX00000	Credit	16/01/2021/ 09:26	QUD	247 / DonBong	27485			
Description of Goods / Services					Qty	Unit Price	Disc%	Amount
M	HINGE ASSY-REAR DOOR UPPER, LH				1.00	33.00	20.00	26.40
M	HINGE ASSY-DOOR UPPER, LH				1.00	26.00	20.00	20.80
M	MOULDING ASSY-RR DR DELTA, LH	X			1.00	19.00	20.00	15.20
M	MOULDING ASSY-RR DR FRAME, LH				1.00	50.00	20.00	40.00
M	W/STRIP ASSY-RR DR BELT O/S LH				1.00	75.00	20.00	60.00
M	W/STRIP ASSY-RR DR SIDE LH				1.00	102.00	20.00	81.60
M	W/STRIP-RR DR BODY SIDE LH				1.00	112.00	20.00	89.60
M	PANEL ASSY-REAR DOOR MODULE, LH				1.00	215.00	20.00	172.00
M	MOTOR ASSY-POWER WDO REG RR, LH				1.00	111.00	20.00	88.80
M	GLASS ASSY-REAR DOOR, LH	X			1.00	181.00	20.00	144.80
M	RUN-RR DR WINDOW GLASS, LH				1.00	135.00	20.00	108.00
M	MOULDING ASSY-SIDE SILL, LH				1.00	279.00	20.00	223.20
M	PANEL ASSY-FRONT DOOR, LH	X			1.00	1277.00	20.00	1021.60
M	MOULDING ASSY-FRT DR FRAME, LH	X			1.00	72.00	20.00	57.60
M	W/STRIP ASSY-FR DR BELT O/S LH	X			1.00	80.00	20.00	64.00
M	W/STRIP ASSY-FR DR SIDE LH	X			1.00	102.00	20.00	81.60
M	WHEEL ASSY-ALUMINIUM	CUT			1.00	926.00	20.00	740.80
M	TORSION AXLE COMPLETE				1.00	1031.00	20.00	824.80
M	BLACK TAPE-FR DR RR, LH				1.00	13.00	20.00	10.40
M	BLACK TAPE-RR DR FR, LH	X			1.00	13.00	20.00	10.40
M	BLACK TAPE-RR DR FRAME RR OTR,				1.00	8.00	20.00	6.40
M	COVER-RR BUMPER LWR				1.00	241.00	20.00	192.80

SURVEYOR NAME: Steve (LKK)

SURVEYOR SIGNATURE: OD- N/A AL

DATE: EXPS - ?

REMARKS: P/P

By B.L. SM

8 days

KK Auto Consultants hereby notify the Repairer of the following:

- To resurvey before/after spray painting
- To display damaged part(s) during resurvey
- Parts prices are subject to confirmation
- Third party survey is on a "Without Prejudice" basis
- No illegal modification(s) is allowed

Authorized signatory and company stamp

18/1/21, 11.00am

Nett 11,642.40
7% GST on 11642.40 814.97

Total Payable 12,457.37

Validity of this estimate is 14 days from date of quote. This is a computer generated document, no signature is required. Estimated costs quoted are excluding GST. We would mention that the above estimate is based on our initial inspection and does not include any additional parts or labour which may be required after repair work has commenced. Occasionally worn or damaged parts are discovered after work has started and needed for repairs or replacement. However, should this occur, we would advise you. Please be informed that a deposit of 50% of the above estimate is payable before commencement of the work. Payment for this may be made in cash, credit card or cheque. You must also agree to pay full amount for renewal of the windscreen in the event of inadvertent breakage in the course of renewing the rubber seal or other repair requiring the removal of the windscreen.



SINGAPORE ACCIDENT STATEMENT

IMPORTANT NOTICE

1. Please report correctly the details of the accident to speed up the claims process.
2. This Form must be completed by the Policyholder and/or the Authorised Driver.
3. Information provided must be as truthful and accurate as possible. Any wilful misrepresentation or withholding of material facts may allow insurance companies to repudiate policy liability.
4. The issue and acceptance of this Form by insurance companies is not an admission of policy liability on the part of the insurance companies.
5. Any false reporting may be referred to the Police for investigation.
6. This report will be forwarded by the insurers of the GIA Records Management Centre established by the General Insurance Association of Singapore (GIA) for archiving and that copies of this report will, for a fee, be made available upon application by interested parties.
7. By the lodgement of this report to the insurers, you hereby consent to the archiving of this report at the centre and to copies of the report being made available aforesaid.

ACCIDENT STATEMENT

Date of Submission	15/01/2021 17:11 (SGT)
Date of Accident	15/01/2021 13:00 (SGT)
Exact Location of Accident	251 Upper E Coast Rd, Singapore 466404
Additional Location Information	UPPER EAST COAST RD OUTSIDE CRESCENDO BUILDING
Country/State of Loss	Singapore

DETAILS OF OWN VEHICLE

Vehicle Registration Number SMN6008L

INSURED/POLICYHOLDER

Is company?	No
Name Of Registered Owner	LEE YAN JIE
NRIC No	SXXXX069A
Email Address	LEEYANJIE@HOTMAIL.COM
Mobile Phone No	(Phone) +65-97568382
Alternative Phone No	+65-97568382

VEHICLE PARTICULARS

Manufacturer	Kia
Model	Cerato
Variant	-
Exact purpose for which vehicle was being used at time of accident	-
Are you claiming under your own insurance policy for repair to your vehicle?	Yes
Vehicle Category	Private car

INSURANCE COMPANY

Name of Insurance Company	AIG
Type of Coverage	Comprehensive
Fleet Policy	No
Policy Number	1900150447
Cover Note Number	-

DRIVER

Name of Driver	LEE YAN JIE
NRIC No	SXXXX069A
Date Of Birth	24/10/1988
Occupation	Indoor

Date Of Driving Pass 10/10/2016
 Driving experience 4 YEARS AND 3 MONTHS
 Gender Male
 Mobile Number (Phone) +65-97568382
 Alt. Phone Number +65-97568382
 Email Address LEEYANJIE@HOTMAIL.COM
 Address BLK 658B PUNGGOL EAST #05-717
 Address complement -
 Postcode 822658
 Is the driver the policyholder? Yes
 If No, Relationship of the Driver with the Insured -
 Does Driver Own Other Vehicles? No
 Vehicle Registration Number of Other Vehicle Owned by Driver -
 Insurance Company of Other Vehicle Owned by Driver -

GENERAL INFORMATION OF THE ACCIDENT

Type of Accident Collision - Head to Rear
 Weather Conditions Clear
 Road Surface Dry

OTHER INFORMATION

Was any foreign vehicle involved in the accident? No
 Number of vehicles involved in the accident 2
 Was anybody injured in the Accident? No
 Was any injured conveyed to hospital by ambulance? -
 Was any other material or property damaged? Yes
 Number of Passengers (Including Driver) 1
 Has the driver been approached by unknown person(s) soliciting/offering accident claims assistance? No

DETAILS OF POLICE ACTION

Was the accident reported to the police? No
 Was notice of intended Prosecution given? No
 If yes, against whom? -

CIRCUMSTANCES OF ACCIDENT

REFER TO ATTACHMENT
 COLLISION-HEAD TO SIDE

ATTACHMENT(S)

Are accident photos available for attachment? Yes
 Was there any video captured by Car Camera? Yes
 Was there any audio recorded? No

DETAILS OF OTHER VEHICLE PROPERTY

Vehicle Registration Number EH812Y
 Vehicle Manufacturer Porsche
 Vehicle Model -
 Vehicle Variant -
 Vehicle Colour -
 Vehicle Category Private car
 Name of Driver HUANG JIANWEI EUGENE
 Contact Number (Phone) +65-93399973
 Address -
 Address complement -
 Postcode -

Insurance Company Name Aviva
Nature Of Damage
Details of property damaged in accident
No. Of Passenger (Including Driver)

SKETCH PLAN

IMPORTANT NOTICE

1. Please report correctly the details of the accident to speed up the claims process.
2. This Form must be completed by the Policyholder and/or the Authorised Driver.
3. Information provided must be as truthful and accurate as possible. Any willful misrepresentation or withholding of material facts may allow insurance companies to repudiate policy liability.
4. The issue and acceptance of this Form by insurance companies is not an admission of policy liability on the part of the insurance companies.
5. Any false reporting may be referred to the Police for investigation.
6. The report will be forwarded by the insurers of the GIA Records Management Centre established by the General Insurance Association of Singapore (GIA) for archiving and that copies of this report will for a fee be made available upon application by interested parties.
7. By the lodgement of this report to the insurers, you hereby consent to the archiving of this report at the centre and to copies of the report being made available aforesaid.

8. Consent under the Personal Data Protection Act (PDPA)

I understand, acknowledge, agree and consent that:

- (a) My insurer, my workshop and the General Insurance Association of Singapore ("GIA") may/are permitted to collect, use, disclose and/or process my personal data/personal information set out in this [form] and any other personal information provided by me or possessed by my insurer (collectively the "Personal Information") and disclose and transfer such Personal Information to all insurer(s) who have insured vehicle(s) involved in this accident (all insurer(s) who have insured vehicle(s) involved in this accident shall be collectively referred to as the "Insurers"), the Insurers' lawyers/law firms, the Monetary Authority of Singapore and any relevant government agency/authority (such as the police), for the purpose(s) of:
- (i) processing, handling and/or dealing with my claims including the settlement of the claims and any necessary investigations relating to the claims;
 - (ii) investigating the accident and/or my claims;
 - (iii) carrying out and/or dealing with my instructions or responding to any enquiries by me;
 - (iv) administering my claims (including the mailing of correspondence, statements, invoices, reports or notices to me, which could involve disclosure of certain personal data about me to bring about delivery of the same as well as on the external cover of envelopes/mail packages); and/or
 - (v) complying with applicable law in administering, processing, handling and/or dealing with my claims.
- (collectively the "Purposes")
- (b) all insurer(s) who have insured vehicle(s) involved in this accident and the Insurers' lawyers/law firms, may/are permitted to collect, use, disclose and/or process my Personal Information for one or more of the above Purposes; and
- (c) my Personal Information may/can be disclosed by any of the Insurers and/or GIA to their third party service providers or agents (including their lawyers/law firms), which may be sited outside of Singapore, for one or more of the above Purposes.

Yan 15/01/2024 2:00pm
Policyholder's Signature / Date & Time

Driver's Signature (If driver is not the policyholder) / Date & Time

[Signature]
Witnessed by Reporting Centre Personnel

Sketch Plan

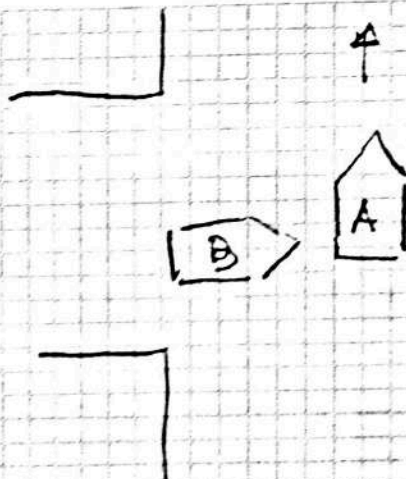

Describe Circumstances of the Accident

Was travelling along Upper East Coast Road. ~~Along~~^{Opposite} Concordia Building. Vehicle dived out of the road and crashed into my car with great force. My car spun 180°.

Declaration

We declare the foregoing particulars are true in every respect.

Yes 15/01/21 4:08pm
Policyholder's Signature / Date & Time

Driver's Signature (If driver is not the policyholder) / Date & Time

Witnessed by Reporting Centre Personnel

CERTIFICATE OF INSURANCE

KIA AUTO PROTECTOR PRIVATE VEHICLE

Name of Policyholder : Lee Yan Jie
 Period of Insurance : 20 Aug 2019 To 19 Aug 2021
 Engine No. : G4FGKH746535
 Chassis No. : KNAF5416MK5050977

Vehicle No. : SMN6008L
 Policy No. : 1900150447
 Endorsement No. :
 Issued Date : 26 Aug 2019

ABOUT THE COVER

Make/Model : KIA Cerato
 Engine Capacity/Tonnage : 1,591.00 CC
 Driver Restriction : NA

Sum Insured : Market Value
 Off Peak Car : No

First Year of Registration : 2019
 Insuring with COE/PARF : Yes

Person or Classes of Persons Entitled to Drive* :

- a) The Policyholder
 - b) Any other person who is driving on the Policyholder's order or with his/her permission.
- This Policy will indemnify the Policyholder or any authorised driver only if he/she meets the specified age condition.

You have to pay an additional sum of \$3,000 as "Young and/or Inexperienced Driver Excess" ("YIDR") if You are or Your Authorised Driver (named or unnamed) is under the age of 23 and/or has less than 2 years' driving experience.

Age Condition : All Age Condition

Limitation as to use* :

Use only for social, domestic and pleasure purposes and for the Policyholder's business.
 This Policy does not cover use for hire or reward, driving tuition, driving test, racing, pace-making, reliability trial or speed-testing, the carriage of goods other than samples in connection with any trade or business or use for any purpose in connection with Motor Trade.

Loss of Use 1500cc - 1600cc
 * Limitations rendered inoperative by Section 8 of the Motor Vehicles (Third-Party Risks and Compensation) Act (Cap. 189), Section 95 of the Road Transport Act, 1987 (Malaysia) and Road Transport (Amendment) Act 2019, are not to be included under these headings.

EXCESS

Section 1
 Fire - \$0 Own Damage - \$600 Theft - \$0 Flood Cover - \$0

Section 2
 Property Damage - \$0

Windscreen : \$100

Named Driver and Excess (where applicable)

Lee Yan Jie - \$600 (Own Damage)

APPROVED REPORTING CENTRES/AUTHORISED REPAIRERS (FOR CLAIMS RELATED REPAIRS)

1. Cycle & Carriage Authorised Service Centre (For accident reporting & windscreen claim only) Add: 600 Sin Ming Ave Singapore 575733 69328000
2. Cycle & Carriage Body & Paint Centre Add: 209 Pandan Gardens Singapore 609339 65684501
3. Cycle & Carriage Authorised Service Centre (For accident reporting & windscreen claim only) Add: 241 Alexandra Road Singapore 159931 64278800
4. Cycle & Carriage Authorised Service Centre (For accident reporting & windscreen claim only) Add: 330 Ubi Rd 3 Singapore 408650 67461000

For other Approved Reporting Centres/AIG Authorised Repairers, please contact our 24-hour accident emergency hotline at +65 6338 6200. Alternatively, you may refer to AIG website www.aig.com.sg or AIG SG Mobile App. Simply search and download "AIG SG" from iTunes or Google Play.

IMPORTANT NOTES

Hire Purchase Company/Employer's Loan: MayBank

We hereby certify that the policy to which this Certificate of Insurance relates is issued in accordance with the provisions of the Motor Vehicles (Third Party Risks and Compensation) Act (Cap. 189), Part IV of the Road Transport Act, 1987 (Malaysia), Road Transport (Amendment) Act 2019 and Motor Vehicles (Third Party Risks) Rules, 1959 (Malaysia).

0504624201

FULCOKICP2 - BO

22 UBI ROAD 4 FULCO BUILDING

SINGAPORE 408817

Underwritten by AIG Asia Pacific Insurance Pte. Ltd.

AIG Asia Pacific Insurance Pte. Ltd.
 AUTHORISED REPRESENTATIVE