

SMG 803J

Dealer

Performance Motors Limited

A Sime Darby Motors Company
Co. Reg. No. 197401559W GST Reg. No M2-0020061-X
Toll-Free Number (1800-2255269)

303, Alexandra Road
Sime Darby Performance Centre
Singapore 159941
Fax. 64747770

280, Kampong Arang Road
East Coast Centre
Singapore 438160
Fax. 63449713

315, Alexandra Road
Sime Darby Business Centre
Singapore 159944
Fax. 64796601 (AfterSales)
64796624 (Motorrad)



GST REG. NO : M2 - 0020081 - X

23 DEC 2020

E S T I M A T E

Estimate No. : b1 56965
Date Estimated : 21/12/2020
Prepared By : Han Kwan Yong

Page No. : 1 of 5

- ESTIMATE REPAIR FOR -

Chou Siaw Liang
7 One-North Gateway
#03-24

Singapore 138642

- ACCOUNT - 40000

Cash Sales - Service
Singapore

REGN. NO.	CHASSIS NO.	REGN. DATE	MODEL	MILEAGE
SMG803J	WBA2X92080VD11460	21/11/2018	216i AT	0

DESCRIPTION	VALUE
To replace rear bumper, boot lid including to knock out tail panel and to make good front bumper	2550 4,250.00
To respray front bumper, rear bumper, boot lid and tail panel	2665 3,704.00
To carry out body cavity preservation. (Per panel).	100 118.00
To remove and install rear windscreen glass to transfer from old to new boot lid	676.00
To conduct water leak tests.	75.00
To remove and install boot compartment carpet and garnish to facilitate repair.	? 231 271.00
To transfer lock mechanism from old to new bootlid including conduct check on new bootlid central locking system for proper function.	451 531.00
To remove old PDC assembly, replace damaged parts and reconnect to new bumper including conduct check for proper function.	150 177.00
To check electrical wiring system at the front and rear sections for proper function including adjustment of headlights.	250 295.00
Sundries	? 150.00
CUSTOMER COMMENT: After the accident, brake lights warning sign 'ON'.	X 0.00
To check and rectify brake lights warning sign 'ON'	X 177.00

Performance Motors Limited

A Sime Darby Motors Company
Co. Reg. No. 197401559W GST Reg. No M2-0020081-x
Toll-Free Number (1800-2255269)

303, Alexandra Road
Sime Darby Performance Centre
Singapore 159941
Fax. 64747770

280, Kampong Arang Road
East Coast Centre
Singapore 438180
Fax. 63449773

315, Alexandra Road
Sime Darby Business Centre
Singapore 159944
Fax. 64796601 (AfterSales)
64796624 (Motorrad)



GST REG. NO : M2 - 0020081 - X

ESTIMATE

Estimate No. : b1 56965
Date Estimated : 21/12/2020
Prepared By : Han Kwan Yong

Page No. : 2 of 5

REGN. NO.	CHASSIS NO.	REGN. DATE	MODEL	MILEAGE
SMG803J	WBA2X92080VD11460	21/11/2018	216i AT	0

Total Labour 1: 10,424.00

DESCRIPTION	QTY	PRIC	VALUE
TRUNK LID <i>h</i>	1	1,210.35	1,210.35
# RR BUMPER LH SIDE GUIDE <i>?</i>	1	61.35	61.35
RR BUMPER RH SIDE GUIDE <i>?</i>	1	61.35	61.35
REAR BUMPER CARRIER <i>h</i>	1	460.40	460.40
SUPPORT <i>?</i>	1	45.55	45.55
RR BUMPER LH INNER SIDE GUIDE <i>?</i>	1	61.35	61.35
RR BUMPER RH INNER SIDE GUIDE <i>?</i>	1	61.35	61.35
# REAR BUMPER TRIM STRIP (BLAC <i>ch</i>	1	88.20	88.20
REAR BUMPER PANEL PRIMED (LINES PDC <i>de</i>	1	1,045.45	1,045.45
GROMMET <i>re</i>	4	0.80	3.20
PLAQUE 74MM <i>re</i>	1	71.60	71.60
# REAR FLAP TOWING EYE PRIMED <i>X</i>	1	43.05	43.05
PLAQUE 82MM <i>re</i>	1	71.60	71.60
(DG) CLEANER R1 (100ML) <i>re</i>	1	26.15	26.15
# (DG/SL) W/SCREEN SEALANT (CO <i>re</i>	2	131.55	263.10
(DG/SL)ADHESIVE PRIMER VP 206 (30ML <i>re</i>	1	27.85	27.85

Total Parts : 3,601.90

Claims OD / 3rd Party / Uninsured losses / Direct Settlement

Regn No. _____ Claim No. _____
Date & Time 18/01/2021 @ 12:00 Excess S\$ _____
Surveyor's Name Rajan Sign _____
Surveyor's Tel 90010068 Authorised Yes / No
Authorised Date _____ Time _____
RESURVEY PARTS PHOTO BY SURVEYOR Yes / No Yes PML Yes / No No
Surveyor's E-mail _____
No. of Working Days Recommend 6 days

LKK Auto Consultants hence notify the Repairer of the following:

- To resurvey before/after spray painting
- To display damaged part(s) during resurvey
- Parts prices are subject to confirmation
- Third party survey is on a "Without Prejudice" basis
- No illegal modification(s) is allowed
- Supplementary item(s) must be resurveyed and is subject to final approval from Insurance Company

Acknowledged by Repairer

Signature:

Date:



Labour 1	:	10,424.00
Parts	:	3,601.90
Labour 2	:	0.00
Excess	:	0.00
Total GST @ 7%	:	981.81
Grand Total	:	15,007.71

** THIS ESTIMATE IS VALID FOR A PERIOD OF 30 DAYS ONLY**

SINGAPORE ACCIDENT STATEMENT

IMPORTANT NOTICE

1. Please report **correctly** the details of the accident to speed up the claims process.
2. This Form must be **completed by the Policyholder and/or the Authorised Insurer**.
3. Information provided must be as truthful and accurate as possible and, without representation or withholding of material facts may allow insurance companies to repudiate policy liability.
4. The issue and acceptance of this Form by insurance companies is not an admission of policy liability on the part of the insurance companies.
5. **Any false reporting may be referred to the Police for investigation.**
6. This report will be forwarded by the insurers of the GIA Records Management Centre established by the General Insurance Association of Singapore (GIA) for archiving and that copies of this report will, for a fee, be made available upon application by interested parties.
7. By the lodgement of this report to the insurers, you hereby consent to the archiving of this report at the centre and to copies of the report being made available aforesaid.

ACCIDENT STATEMENT

Date of Submission	21/12/2020 16:14 (SGT)
Date of Accident	18/12/2020 19:00 (SGT)
Exact Location of Accident	Chin Swee Rd, Singapore
Additional Location Information	TOWARDS AYE TO CTE (BEFORE MERCHANT ROAD / CLEMENCEAU)
Country/State of Loss	Singapore

DETAILS OF OWN VEHICLE

Vehicle Registration Number	SMG803J
INSURED/POLICYHOLDER	
Is company?	No
Name Of Registered Owner	CHOU SIAW LIANG
NRIC No	SXXXX903I
Email Address	CHOU.JIMMYSL@GMAIL.COM
Mobile Phone No	(Phone) +65-96185939
Alternative Phone No	+65-96185939

VEHICLE PARTICULARS

Manufacturer	BMW
Model	216i
Variant	-
Exact purpose for which vehicle was being used at time of accident	Private use
Are you claiming under your own insurance policy for repair to your vehicle?	No - Claiming third party
Vehicle Category	Private car

INSURANCE COMPANY

Name of Insurance Company	Axa
Type of Coverage	Comprehensive
Fleet Policy	No
Policy Number	GA419902/1
Cover Note Number	-

DRIVER

Name of Driver	CHOU SIAW LIANG
NRIC No	SXXXX903I
Date Of Birth	23/04/1966

Date of Birth
 Date of Driving Pass
 Driving experience
 Gender
 Mobile Number
 Alt. Phone Number
 Email Address
 Address
 Address complement
 Postcode
 Is the driver the policyholder?
 If No, Relationship of the Driver with the Insured
 Does Driver Own Other Vehicles?
 Vehicle Registration Number of Other Vehicle Owned by Driver
 Insurance Company of Other Vehicle Owned by Driver

Indoor
 19/06/1986
 34 YEARS AND 6 MONTHS
 Male
 (Phone) +65-96185939
 +65-96185939
 CHOU.JIMMYSL@GMAIL.COM
 7 ONE - NORTH GATEWAY #03-24
 -
 138642
 Yes
 -
 No
 -
 -

GENERAL INFORMATION OF THE ACCIDENT

Type of Accident
 Weather Conditions
 Road Surface

Chain Collision
 Clear
 Dry

OTHER INFORMATION

Was any foreign vehicle involved in the accident?
 Number of vehicles involved in the accident
 Was anybody injured in the Accident?
 Was any injured conveyed to hospital by ambulance?
 Was any other material or property damaged?
 Number of Passengers (Including Driver)
 Has the driver been approached by unknown person(s) soliciting/offering accident claims assistance?

No
 3
 No
 -
 Yes
 2
 No

PASSENGER 1

Name
 Gender

CHEE HUI LIN
 Female

DETAILS OF POLICE ACTION

Was the accident reported to the police?
 Was notice of intended Prosecution given?
 If yes, against whom?

No
 No
 -

CIRCUMSTANCES OF ACCIDENT

REFER TO ATTACH.

ATTACHMENT(S)

Are accident photos available for attachment?
 Was there any video captured by Car Camera?
 Was there any audio recorded?

Yes
 Yes
 No

DETAILS OF OTHER VEHICLE PROPERTY

Vehicle Registration Number
 Vehicle Manufacturer
 Vehicle Model
 Vehicle Variant
 Vehicle Colour
 Vehicle Category
 Name of Driver

SHC2458P
 Hyundai
 Ioniq
 -
 -
 Taxi
 SIM HOCK SOON

..... No	SXXXX065J
Contact Number	-
Address	699C HOUGANG ST 52 #15-45
Address complement	-
Postcode	533699
Insurance Company Name	First Capital
Nature Of Damage	-
Details of property damaged in accident	-
No. Of Passenger (Including Driver)	-

DETAILS OF OTHER VEHICLE PROPERTY 2

Vehicle Registration Number	SMQ3854P
Vehicle Manufacturer	Honda
Vehicle Model	-
Vehicle Variant	-
Vehicle Colour	-
Vehicle Category	Private car
Name of Driver	-
Contact Number	-
Address	-
Address complement	-
Postcode	-
Insurance Company Name	-
Nature Of Damage	-
Details of property damaged in accident	-
No. Of Passenger (Including Driver)	-

SKETCH PLAN

IMPORTANT NOTICE

1. Please report correctly the details of the accident to speed up the claims process.
2. This Form must be completed by the Policyholder and/or the Authorised Driver.
3. Information provided must be as truthful and accurate as possible. Any wilful misrepresentation or withholding of material facts may allow insurance companies to repudiate policy liability.
4. The issue and acceptance of this Form by insurance companies is not an admission of policy liability on the part of the Insurance companies.
5. Any false reporting may be referred to the Police for investigation.
6. The report will be forwarded by the insurers of the GIA Records Management Centre established by the General Insurance Association of Singapore (GIA) for archiving and that copies of this report will for a fee be made available upon application by Interested parties.
7. By the lodgment of this report to the insurers, you hereby consent to the archiving of this report at the centre and to copies of the report being made available aforesaid.
8. **Consent under the Personal Data Protection Act (PDPA)**

I understand, acknowledge, agree and consent that:

- (a) My insurer, my workshop and the General Insurance Association of Singapore ("GIA") may/are permitted to collect, use, disclose and/or process my personal data/personal information set out in this [form] and any other personal information provided by me or possessed by my insurer (collectively the "Personal Information") and disclose and transfer such Personal Information to all insurer(s) who have insured vehicle(s) involved in this accident (all insurer(s) who have insured vehicle(s) involved in this accident shall be collectively referred to as the "Insurers"), the Insurers' lawyers/law firms, the Monetary Authority of Singapore and any relevant government agency/authority (such as the police), for the purpose(s) of:
 - (i) processing, handling and/or dealing with my claims including the settlement of the claims and any necessary investigations relating to the claims;
 - (ii) investigating the accident and/or my claims;
 - (iii) carrying out and/or dealing with my instructions or responding to any enquiries by me;
 - (iv) administering my claims (including the mailing of correspondence, statements, invoices, reports or notices to me, which could involve disclosure of certain personal data about me to bring about delivery of the same as well as on the external cover of envelopes/mail packages); and/or
 - (v) complying with applicable law in administering, processing, handling and/or dealing with my claims. (collectively the "Purposes")
- (b) all insurer(s) who have insured vehicle(s) involved in this accident and the Insurers' lawyers/law firms, may/are permitted to collect, use, disclose and/or process my Personal Information for one or more of the above Purposes; and
- (c) my Personal Information may/can be disclosed by any of the Insurers and/or GIA to their third party service providers or agents (including their lawyers/law firms), which may be sited outside of Singapore, for one or more of the above Purposes.
- (d) my Personal Information will also be collected and used to compile claims history for the purpose of fraud detection, investigation and management in present and all future claims.
- (e) the information so collected under (d) above may be shared / disclosed:
 - (i) to all insurers and/or any other third parties that assist in evaluating, investigating, controlling or managing fraud, regulators, law enforcement and government agencies as reasonably required for the purposes stated, or
 - (ii) for complying with requirements under any regulations, laws or court orders.



Policyholder's Signature
Date & Time:

21/12/2020
(10.52am)



Driver's Signature
(If driver is not the policyholder)
Date & Time:



Reporting Centre Personnel's Signature
Name:
NRIC/FIN No.:

SKETCH PLAN

S0023
Chew Chee Keng
S7134379J



SM G 803 J

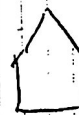

S0023065J
Sim Ho UC Soon

CTE \nearrow

Chin Swee Keng

Turnoff to
Merchant Rd
Chomencu

DESCRIBE CIRCUMSTANCES OF THE ACCIDENT

Time : 6.48 pm.

Was driving from AYE towards CTE turn off at
Market / Clemence turn off in Chin Sue Tunnel
There were a ~~lot of cars~~ ^{lot of cars in front of me} braking.

I bailed and slipped in front of SMO 3854 P.

Suddenly I hear a bang & ~~feel~~^{strong} jolt of my car.
My car moved forward and hit the car in front.

Came down to investigate. Was rear ended by SHC2458P. Taxi front bumper is badly damaged.

There were 3 passengers in the FMC; 2 male 1 female
Female complained of neck pain after alighting.

DECLARATION

I/We declare the foregoing particulars are true in every respect.

Policyholder's Signature _____

Date & Time:

21/12/2020

(10.52am)

Driver's Signature

(If driver is not the policyholder)

Date & Time:

Reporting Centre Personnel's Signature

Name:

NRIC/FIN No.:

> Back to OneMotoring

Enquire PARF/COE Rebate for Registered Vehicle

Owner ID Type:	Singapore NRIC
Owner ID:	903I

Vehicle No.:	SMGB03J
Vehicle to be Exported:	No
Intended Deregistration Date:	18 Jan 2021
Vehicle Make:	B.M.W.
Vehicle Model:	216I ACTIVE TOURER
Primary Colour:	Blue
Manufacturing Year:	2018
Engine No.:	41585469B38A15A
Chassis No.:	WBA2X92080VD11460
Maximum Power Output:	80.0 kW (107 bhp)
Open Market Value:	\$29,536.00
Original Registration Date:	21 Nov 2018
First Registration Date:	21 Nov 2018
Transfer Count:	0
Actual ARF Paid:	\$33,351.00

Intended PARF Rebate Details	
PARF Eligibility:	Yes
PARF Eligibility Expiry Date:	20 Nov 2028
PARF Rebate Amount:	\$25,013.00

Intended COE Rebate Details	
COE Expiry Date:	20 Nov 2028
COE Category:	A - Car up to 1600cc & 97kW (130bhp)
COE Period(Years):	10
QP Paid:	\$28,199.00
COE Rebate Amount:	\$22,104.00
Total Rebate Amount:	\$47,117.00

The information contained herein is correct as at 18 Jan 2021

OK

Blue



Merimen e-Claims



Used 2018 BMW 2 Series 216i Active Tourer



PARF/COE R

art.com/used_cars/info.php?ID=958576&DL=2428

BMW 2 Series 216i Active Tourer

Overview

Financial

Accessories

Similar

Research

Photos

Map

Price	\$95,200		
Depreciation ⓘ	\$9,880 /yr View models with similar depre	Reg Date	28-Dec-2018 (7yrs 11mths 9days COE left)
Mileage	43,000 km (20.9k /yr)	Manufactured ⓘ	2018
Road Tax ⓘ	\$684 /yr	Transmission	Auto
Dereg Value ⓘ	\$45,274 as of today (change)	OMV ⓘ	\$29,536
COE ⓘ	\$25,501	ARF ⓘ	\$33,351
Engine Cap	1,499 cc	Power	80.0 kW (107 bhp)
Curb Weight ⓘ	1,380 kg	No. of Owners ⓘ	1
Type of Vehicle	Hatchback		

Features

BMW TwinPower Turbo 3 Cylinders Engine At 107Bhp, 190Nm Of Torque. High Fuel Efficient At 15.8Km/L, 7 Speed DCT Gear. View specs of the BMW 2 Series Active Tourer (2014)

Accessories

Sports Rims, Leather Seats, Factor Audio Player, Reverse Camera, Bluetooth, Electric Front Seats With Driver's Memory, Auto Tailgate Etc.

D

