

SINGAPORE ACCIDENT STATEMENT

IMPORTANT NOTICE

1. Please report correctly the details of the accident to speed up the claims process.
2. This Form must be completed by the Policyholder and/or the Authorised Driver.
3. Information provided must be as truthful and accurate as possible. Any wilful misrepresentation or withholding of material facts may allow insurance companies to repudiate policy liability.
4. The issue and acceptance of this Form by insurance companies is not an admission of policy liability on the part of the insurance companies.
5. **Any false reporting may be referred to the Police for investigation.**
6. This report will be forwarded by the insurers of the GIA Records Management Centre established by the General Insurance Association of Singapore (GIA) for archiving and that copies of this report will, for a fee, be made available upon application by interested parties.
7. By the lodgement of this report to the insurers, you hereby consent to the archiving of this report at the centre and to copies of the report being made available aforesaid.

ACCIDENT STATEMENT

Date Of Report	13/11/2020 12:00
Date Of Accident	12/11/2020 16:00
Exact Location Of Accident	JLN AHMAD IBRAHIM TWDS JLN BOON LAY
Country/State of Loss	SINGAPORE

DETAILS OF OWN VEHICLE

Vehicle Registration Number	SKV7894U
-----------------------------	----------

Insured/Policyholder

Name Of Registered Owner	JASS JUMA'AT BIN SATIN
NRIC No	SXXXX581D
Email Address	NOEMAIL
Mobile Phone No	(LOCAL) +65-90681309
Alternative Phone No	OFFICE-90681309

Vehicle Particulars

Manufacturer	BMW
Model	520I AUTO ABS AIRBAG 2WD XENON HEADLAMP
Exact Purpose for which vehicle was being used at time of accident	PRIVATE USE
Are you claiming under your own insurance policy for repair to your vehicle?	NO
If No, Please state action to be taken	THIRD PARTY
Vehicle Category	PRIVATE CAR

Insurance Company

Name of Insurance Company	FWD SINGAPORE PTE. LTD.
Type Of Coverage	COMPREHENSIVE
Fleet Policy	NO
Policy Number	PNPV2020-00004095
Cover Note Number	

Driver

Name of Driver	JASS JUMA'AT BIN SATIN
NRIC No	SXXXX581D
Date Of Birth	14/02/1963
Occupation	INDOOR
Date Of Driving Pass	29/01/1993
Driving Experience	27 YEARS AND 9 MONTHS
Gender	MALE
Mobile Number	(LOCAL) +65-90681309
Fax Number	
Contact Number	OFFICE-90681309
Email Address	NOEMAIL

Address	BLK 868 WOODLANDS STREET 83 #02-341
Postcode	730868
Was driver an employee of the Insured's Company	NO
If No, Relationship of the Driver with the Insured	OWNER
Vehicle Registration Number of Driver's Own Vehicle	-
	-
	-
Insurance Company of Driver's Own Vehicle	-
	-
	-

General Information of the Accident

Type Of Accident	SIDE SWIPE
Weather Conditions	CLEAR
Road Surface	DRY

Other Information

Was any foreign vehicle involved in this accident?	NO
Number of vehicles (including own vehicle) involved in the accident	2
Was any body injured in the Accident?	YES
Was any injured conveyed to hospital by ambulance?	NO
Was any other material or property damaged?	YES
I have been approached by unknown person(s) soliciting/offering accident claims assistance.	NO
Number of Passengers (Including Driver)	1

Details of Police Action

Was the accident reported to the police?	NO
If Yes, Please state which Police Station	
Was notice of intended Prosecution given?	NO
If Yes, against whom?	

Circumstances of Accident

REFER TO STATEMENT.

Attachment(s)

Are accident photos available for attachment?	YES
Was there any video captured by Car Camera?	YES
Remarks/ Reasons:	VIDEO FOOTAGE WITH DRIVER
Was there any audio recorded?	NO

Details of Witness 1

Name	GERALD LAI JIAN HAO
Phone Number	
Email Address	

DETAILS OF OTHER VEHICLE PROPERTY 1

Vehicle Registration Number	XE2828E
Vehicle Make/Model/Colour	
Details Of Properties	
Vehicle Category	COMMERCIAL VEHICLE
Name of Driver	LU HUANPENG
NRIC/Passport Number	GXXXX124K
Contact Number	
Address	
Postcode	

Insurance Company Name
Nature Of Damage
No. Of Passenger (Including Driver)

DETAILS OF INJURED PERSON 1	
Name	JASS JUMA'AT BIN SATIN
Approximate Age	
Injuries Sustain	BODY
Injured person in which vehicle?	SKV7894U
Were seat belts worn?	YES
Was this injured conveyed to hospital by ambulance?	NO
Address	
Postcode	

Accident Sketch Plan

SKETCH PLAN

IMPORTANT NOTICE

1. Please report correctly the details of the accident to speed up the claims process.
2. This Form must be completed by the Policyholder and/or the Authorised Driver.
3. Information provided must be as truthful and accurate as possible. Any wilful misrepresentation or withholding of material facts may allow insurance companies to repudiate policy liability.
4. The issue and acceptance of this Form by insurance companies is not an admission of policy liability on the part of the insurance companies.
5. Any false reporting may be referred to the Police for investigation.
6. The report will be forwarded by the Insurers of the GIA Records Management Centre established by the General Insurance Association of Singapore (GIA) for archiving and that copies of this report will for a fee be made available upon application by interested parties.
7. By the lodgment of this report to the Insurers, you hereby consent to the archiving of this report at the centre and to copies of the report being made available aforesaid.
8. **Consent under the Personal Data Protection Act (PDPA)**

I understand, acknowledge, agree and consent that:

- (a) My insurer, my workshop and the General Insurance Association of Singapore ("GIA") may/are permitted to collect, use, disclose and/or process my personal data/personal information set out in this [form] and any other personal information provided by me or possessed by my insurer (collectively the "Personal Information") and disclose and transfer such Personal Information to all insurer(s) who have insured vehicle(s) involved in this accident (all insurer(s) who have insured vehicle(s) involved in this accident shall be collectively referred to as the "Insurers"), the Insurers' lawyers/law firms, the Monetary Authority of Singapore and any relevant government agency/authority (such as the police), for the purpose(s) of:
 - (i) processing, handling and/or dealing with my claims including the settlement of the claims and any necessary investigations relating to the claims;
 - (ii) investigating the accident and/or my claims;
 - (iii) carrying out and/or dealing with my instructions or responding to any enquiries by me;
 - (iv) administering my claims (including the mailing of correspondence, statements, invoices, reports or notices to me, which could involve disclosure of certain personal data about me to bring about delivery of the same as well as on the external cover of envelopes/mail packages); and/or
 - (v) complying with applicable law in administering, processing, handling and/or dealing with my claims, (collectively the "Purposes")
- (b) all insurer(s) who have insured vehicle(s) involved in this accident and the Insurers' lawyers/law firms, may/are permitted to collect, use, disclose and/or process my Personal Information for one or more of the above Purposes; and
- (c) my Personal Information may/can be disclosed by any of the Insurers and/or GIA to their third party service providers or agents (including their lawyers/law firms), which may be sited outside of Singapore, for one or more of the above Purposes.
- (d) my Personal Information will also be collected and used to compile claims history for the purpose of fraud detection, investigation and management in present and all future claims.
- (e) the information so collected under (d) above may be shared / disclosed:
 - (i) to all insurers and/or any other third parties that assist in evaluating, investigating, controlling or managing fraud, regulators, law enforcement and government agencies as reasonably required for the purposes stated, or
 - (ii) for complying with requirements under any regulations, laws or court orders.

Policyholder's Signature
Date & Time:

Driver's Signature
(if driver is not the policyholder)
Date & Time:

Reporting Centre Personnel's Signature
Name:
NRIC/FIN No.:

Accident Sketch Plan

SKETCH PLAN

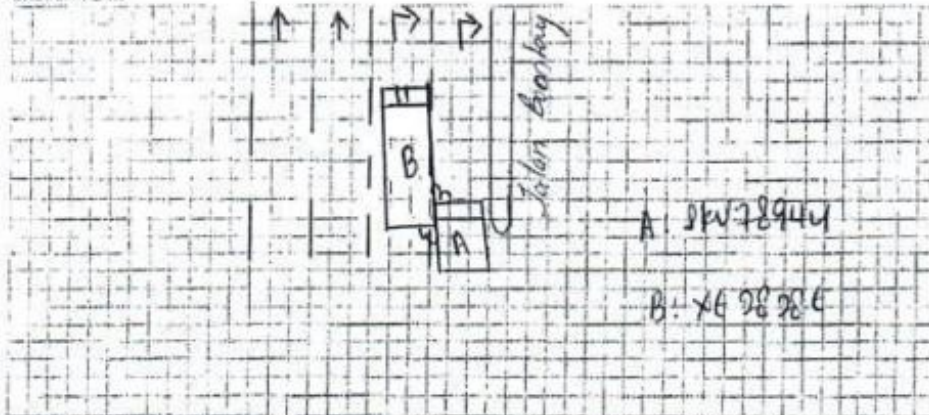

DESCRIBE CIRCUMSTANCES OF THE ACCIDENT

I was making a turn to Jalan Boontang at Jalan
 Ahmad Ibrahim together with vehicle (B) travelling on
 my left. When we are about to complete the turn,
 vehicle (A) cut into my lane and collided onto my
 vehicle front left portion.

DECLARATION

I/We declare the foregoing particulars are true in every respect.

Policyholder's Signature

Date & Time:

Driver's Signature

(If driver is not the policyholder)

Date & Time:

Reporting Centre Personnel's Signature

Name:

NRIC/FIN No.:

Signature of Reporting Centre Personnel

Accident Photo



Accident Photo



Accident Photo



Accident Photo



Accident Photo



Accident Photo



Accident Photo



Accident Photo



Accident Photo



Accident Photo



Accident Photo



Accident Photo

