

NATIONAL Assessment Centre Services

[part 1 Jan 2003]

MMA 120095562

| | | | |
|----------------------------|--|-----------------------|---------|
| Date In: 30/10/20 16:06 | Job description | Date & Time Completed | Done by |
| Ref No: MA/PWD 20011853144 | SAS e-filing | | |
| Veh No: SMD 7081 U | E-mail (within 3hrs, AIC 2hrs) | | |
| ICIA: 28/10/20 19:35 | I-Motor Claim Form | | |
| (11) (11) Reporting Only | I-Motor W/O (within: OD 2hrs, TP 4hrs) | | |
| TP Insurer: | I-Photo Uploaded | | |
| | Assessment/Survey Report | | |
| | Ass't Report by Fax / Hand to Owner/Wksp | | |

| | | |
|--|--|-----------------------|
| Preferred Wksp / INC Assign Wksp / OW: (| Tel: (| Fax: (|
| TP Particulars: | Veh No: SLF 8348X | INC () / Non-INC () |
| Owner / Driver: (| Tel: (| |
| Policy No: (| Period: (| Cover Type: (|
| Confirmed by: (| Date: (| Time: (|
| Insured/Driver Liability: (| %) [Note-Est. Status (WO): N: 0-20%; P: 21-79% P: 80-100%] | |
| Year of Registration: (| Warranty: YES () / NO () | |
| Excess: (\$ | Loading: \$1,000 () / \$2,000 () | |

| |
|---|
| General Remarks: |
| () Walk-In Customer: Customer's Information strictly Confidential & Strictly NO refer of repairer. |
| () Total Loss Case: to e-mail Insurer URGENTLY. |
| Drive-In () / Towed-In () ; Invoice: YES () / NO () ; Towing Co: () |

| | | | |
|---|-----------------------|-----------------------|---------|
| Remarks: | INC () / Non-INC () | Date & Time Completed | Done by |
| 1) Apply for Transport Allowance () / Courtesy Car () | | | |
| 2) QC Check / Post Repair Inspection () | | | |
| 3) Upload Resurvey Photo [Repair Cost > \$3000] () | | | |

Injury: _____

| Date/Time | Action |
|-----------|--------|
| | |
| | |
| | |
| | |
| | |
| | |
| | |
| | |
| | |

MA2005702

| | | | |
|---------------------------------|---|-------------|---------|
| Claimant's Particulars: | Invoice/Registration Checklist | Amount (\$) | Remarks |
| Driver/Owner: | 1) AR: Accident Reporting (\$30); | 20.00 | |
| Contact No: | 2) DA: Damage Assessment (\$100); INC (\$30) | | |
| Damaged Portion: | 3) TP: Towing Fee \$40/\$45 | | |
| QC Checked by (Engr-In-Charge): | 4) PT: Follow-Through Survey \$120 | | |
| | 5) PT: Follow-Through Survey (Resurvey) \$30 | | |
| | For claiming against INC Only (wef 19 Jan 2003) | | |
| | 6) TR: Re-Inspection \$75 | | |
| | 7) N1: Idao DA + SMRT Survey \$160 | | |
| | 8) NTUC Additional Services:- | | |
| | ON: | | |
| | *N5: Courtesy Car / Tpt Allowance \$5 | | |
| | *N6: Repair Co-ordination \$10 | | |
| | *N7: Post Repair Inspection \$25 | | |
| | *N8: DV / Collect Excess Coordination \$5 | | |
| | TP (N11): TP (N-on INC) against INC \$20 | | |
| | 9) N12: Idao Mobile \$0 | | |
| | Invoice dated | Fee Charged | |
| | Invoice dated | Fee Charged | |

SINGAPORE ACCIDENT STATEMENT

IMPORTANT NOTICE

1. Please report correctly the details of the accident to speed up the claims process.
2. This Form must be completed by the Policyholder and/or the Authorised Driver.
3. Information provided must be as truthful and accurate as possible. Any wilful misrepresentation or withholding of material facts may allow insurance companies to repudiate policy liability.
4. The issue and acceptance of this Form by insurance companies is not an admission of policy liability on the part of the insurance companies.
5. **Any false reporting may be referred to the Police for investigation.**
6. This report will be forwarded by the insurers of the GIA Records Management Centre established by the General Insurance Association of Singapore (GIA) for archiving and that copies of this report will, for a fee, be made available upon application by interested parties.
7. By the lodgement of this report to the insurers, you hereby consent to the archiving of this report at the centre and to copies of the report being made available aforesaid.

ACCIDENT STATEMENT

| | |
|----------------------------|--------------------------------------|
| Date Of Report | 30/10/2020 16:06 |
| Date Of Accident | 28/10/2020 19:35 |
| Exact Location Of Accident | PIE TUAS JURONG EAST/WEST AVE 1 EXIT |
| Country/State of Loss | SINGAPORE |

DETAILS OF OWN VEHICLE

| | |
|-----------------------------|----------------------|
| Vehicle Registration Number | SMD7081U |
| Insured/Policyholder | |
| Name Of Registered Owner | LEE YUN XUAN |
| NRIC No | SXXXX683G |
| Email Address | NOEMAIL |
| Mobile Phone No | (LOCAL) +65-90912961 |
| Alternative Phone No | OFFICE-90912961 |

Vehicle Particulars

| | |
|--|-------------|
| Manufacturer | VOLKSWAGEN |
| Model | GOLF R |
| Exact Purpose for which vehicle was being used at time of accident | PRIVATE USE |
| Are you claiming under your own insurance policy for repair to your vehicle? | NO |
| If No, Please state action to be taken | THIRD PARTY |
| Vehicle Category | PRIVATE CAR |

Insurance Company

| | |
|---------------------------|-------------------------|
| Name of Insurance Company | FWD SINGAPORE PTE. LTD. |
| Type Of Coverage | COMPREHENSIVE |
| Fleet Policy | NO |
| Policy Number | PNPV2020-00002585 |
| Cover Note Number | |

Driver

| | |
|----------------------|----------------------|
| Name of Driver | REUBEN NG |
| NRIC No | SXXXX670G |
| Date Of Birth | 26/01/1999 |
| Occupation | INDOOR |
| Date Of Driving Pass | 18/08/2017 |
| Driving Experience | 3 YEARS AND 2 MONTHS |
| Gender | MALE |
| Mobile Number | (LOCAL) +65-90912961 |
| Fax Number | |
| Contact Number | |
| EMail Address | NOEMAIL |

| | |
|---|----------------------------------|
| Address | BLK 489 JURONG WEST AVE 1 #12-33 |
| Postcode | 640489 |
| Was driver an employee of the Insured's Company | NO |
| If No, Relationship of the Driver with the Insured | FRIEND |
| Vehicle Registration Number of Driver's Own Vehicle | - |
| | - |
| | - |
| Insurance Company of Driver's Own Vehicle | - |
| | - |
| | - |

General Information of the Accident

| | |
|--------------------|-----------------|
| Type Of Accident | CHAIN COLLISION |
| Weather Conditions | CLEAR |
| Road Surface | DRY |

Other Information

| | |
|---|--|
| Was any foreign vehicle involved in this accident? | NO |
| Number of vehicles (including own vehicle) involved in the accident | 2 |
| Was any body injured in the Accident? | YES |
| Was any injured conveyed to hospital by ambulance? | NO |
| Was any other material or property damaged? | YES |
| I have been approached by unknown person(s) soliciting/offering accident claims assistance. | NO |
| Number of Passengers (Including Driver) | 2 |
| Passenger 1 | NAME: : MOHAMED NUR IKHWAN BIN MOHD JAFI GENDER: : MALE |

Details of Police Action

| | |
|---|----|
| Was the accident reported to the police? | NO |
| If Yes, Please state which Police Station | |
| Was notice of intended Prosecution given? | NO |
| If Yes, against whom? | |

Circumstances of Accident

REFER TO STATEMENT.

Attachment(s)

| | |
|---|-------------|
| Are accident photos available for attachment? | YES |
| Was there any video captured by Car Camera? | YES |
| Remarks/ Reasons: | WITH DRIVER |
| Was there any audio recorded? | NO |

DETAILS OF OTHER VEHICLE PROPERTY 1

| | |
|-----------------------------|-------------|
| Vehicle Registration Number | SLF8348X |
| Vehicle Make/Model/Colour | |
| Details Of Properties | |
| Vehicle Category | PRIVATE CAR |
| Name of Driver | |
| NRIC/Passport Number | |
| Contact Number | |
| Address | |
| Postcode | |
| Insurance Company Name | |
| Nature Of Damage | |

No. Of Passenger (Including Driver)

DETAILS OF OTHER VEHICLE PROPERTY 2

Vehicle Registration Number PC363Y

Vehicle Make/Model/Colour

Details Of Properties

Vehicle Category BUS

Name of Driver

NRIC/Passport Number

Contact Number

Address

Postcode

Insurance Company Name

Nature Of Damage

No. Of Passenger (Including Driver)

DETAILS OF INJURED PERSON 1

Name REUBEN NG

Approximate Age

Injuries Sustain BODY

Injured person in which vehicle? SMD7081U

Were seat belts worn? YES

Was this injured conveyed to hospital by ambulance? NO

Address

Postcode

DETAILS OF INJURED PERSON 2

Name MOHAMED NUR IKHWAN BIN MOHD JAFI

Approximate Age

Injuries Sustain BODY

Injured person in which vehicle? SMD7081U

Were seat belts worn? YES

Was this injured conveyed to hospital by ambulance? NO

Address

Postcode

SKETCH PLAN

IMPORTANT NOTICE

1. Please report correctly the details of the accident to speed up the claims process.
2. This Form must be completed by the Policyholder and/or the Authorised Driver.
3. Information provided must be as truthful and accurate as possible. Any wilful misrepresentation or withholding of material facts may allow insurance companies to repudiate policy liability.
4. The issue and acceptance of this Form by insurance companies is not an admission of policy liability on the part of the insurance companies.
5. Any false reporting may be referred to the Police for investigation.
6. The report will be forwarded by the Insurers of the GIA Records Management Centre established by the General Insurance Association of Singapore (GIA) for archiving and that copies of this report will for a fee be made available upon application by interested parties.
7. By the lodgment of this report to the insurers, you hereby consent to the archiving of this report at the centre and to copies of the report being made available aforesaid.
8. **Consent under the Personal Data Protection Act (PDPA)**

I understand, acknowledge, agree and consent that:

- (a) My insurer, my workshop and the General Insurance Association of Singapore ("GIA") may/are permitted to collect, use, disclose and/or process my personal data/personal information set out in this (form) and any other personal information provided by me or possessed by my insurer (collectively the "Personal Information") and disclose and transfer such Personal Information to all insurer(s) who have insured vehicle(s) involved in this accident (all insurer(s) who have insured vehicle(s) involved in this accident shall be collectively referred to as the "Insurers"), the Insurers' lawyers/law firms, the Monetary Authority of Singapore and any relevant government agency/authority (such as the police), for the purpose(s) of:
 - (i) processing, handling and/or dealing with my claims including the settlement of the claims and any necessary investigations relating to the claims;
 - (ii) investigating the accident and/or my claims;
 - (iii) carrying out and/or dealing with my instructions or responding to any enquiries by me;
 - (iv) administering my claims (including the mailing of correspondence, statements, invoices, reports or notices to me, which could involve disclosure of certain personal data about me to bring about delivery of the same as well as on the external cover of envelopes/mail packages); and/or
 - (v) complying with applicable law in administering, processing, handling and/or dealing with my claims, (collectively the "Purposes")
- (b) all insurer(s) who have insured vehicle(s) involved in this accident and the insurers' lawyers/law firms, may/are permitted to collect, use, disclose and/or process my Personal Information for one or more of the above Purposes; and
- (c) my Personal Information may/can be disclosed by any of the insurers and/or GIA to their third party service providers or agents (including their lawyers/law firms), which may be sited outside of Singapore, for one or more of the above Purposes.
- (d) my Personal Information will also be collected and used to compile claims history for the purpose of fraud detection, investigation and management in present and all future claims.
- (e) the information so collected under (d) above may be shared / disclosed:
 - (i) to all insurers and/or any other third parties that assist in evaluating, investigating, controlling or managing fraud, regulators, law enforcement and government agencies as reasonably required for the purposes stated, or
 - (ii) for complying with requirements under any regulations, laws or court orders.

Policyholder's Signature
Date & Time:

Driver's Signature
(If driver is not the policyholder)
Date & Time:

Reporting Centre Personnel's Signature
Name:
NRIC/FIN No.:

SKETCH PLAN

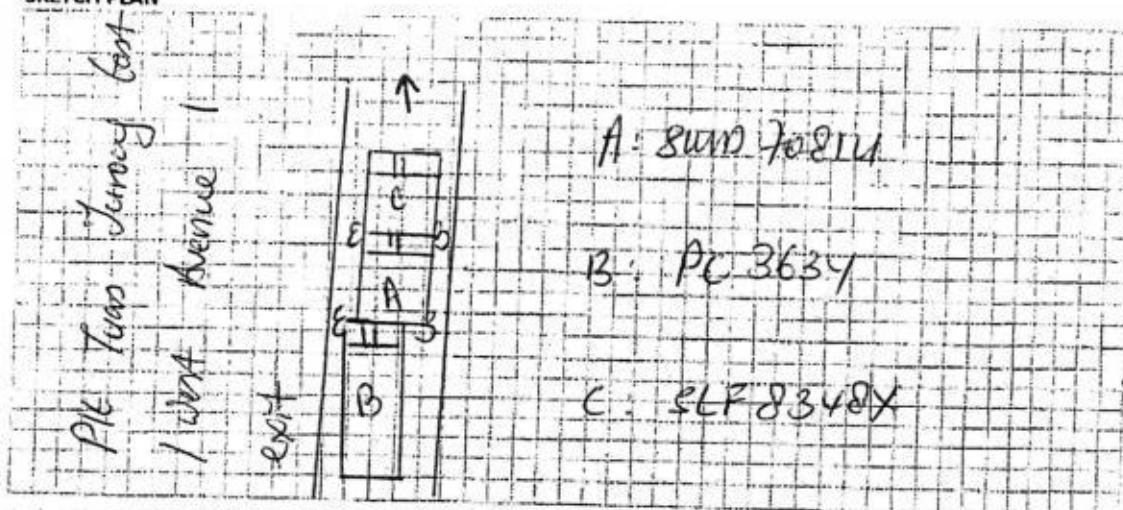

DESCRIBE CIRCUMSTANCES OF THE ACCIDENT

I was travelling straight along PKE Tuas Jorong East / West Avenue 1 exit. The vehicle in front of me stop, hence I follow suit to stop without any contact. Out of sudden, I felt a great impact from my vehicle rear portion. The impact pushes me forward. When I got down, I saw that I was involved in a 3 car chain collision.

DECLARATION

I/We declare the foregoing particulars are true in every respect.

Policyholder's Signature
Date & Time:

Driver's Signature
(If driver is not the policyholder)
Date & Time:

Reporting Centre Personnel's Signature
Name:
NRIC/FIN No.:



CERTIFICATE OF INSURANCE

Please call +65-6322-2072 for FWD Emergency Assistance
if Your Car breaks down or is involved in an accident.

All accidents must be reported within 24 hours of the incident regardless of whether it will lead to a claim.

POLICY NUMBER: PNPV2020-00002585 (Comprehensive - Classic Plan)

Car plate number: SMD7081U

Car chassis number: WVWZZZ1KZAW301975

Engine number: CDL025371

Your name (As the policyholder): LEE YUN XUAN

Coverage start date: 17/02/2020

Coverage end date: 14/04/2021

Covered geographical area: Singapore, West Malaysia and Southern Thailand

Who is insured to drive :

(a) You; and

(b) Anyone with a valid driving license who You give permission to drive Your Car.

Important things to know:

Your Policy comprises this Certificate of Insurance, the Contract, the Car Insurance Summary and any Endorsements attached by Us. These documents should be read together as one. You must make sure that any person You give permission to drive Your Car understands Your duties under this Policy and complies with its conditions.

Your Policy is only valid if Your Car is being used for non-commercial activities in accordance with Your contract.

Finance company: AMS motors pte ltd

We confirm that this Policy complies with the Motor Vehicles (Third-Party Risks and Compensation) Act (Chapter 189).

Issued on: 13/10/2020

Khor Kee Eng
Chief Executive Officer
FWD Singapore Pte Ltd

Please immediately inform us at +65-6820-8888
or email us at contact.sg@fwd.com if any details
in this Certificate of Insurance need to be changed.

SINGAPORE ACCIDENT STATEMENT

IMPORTANT NOTICE

- ❖ Complete and submit this form to the individual insurance authorised reporting centre.
- ❖ Please report correctly on the details of the accident to speed up the claim process.
- ❖ This form must be filled up by the policy holder and/or authorised driver.
- ❖ Information provided must be as fruitful and accurate as possible. Any wilful misrepresentation or withholding of material facts may allow insurance companies to repudiate policy liability.
- ❖ The issue and acceptance of this form by insurance companies is not an admission of policy liability on the part of the insurance companies.
- ❖ Any false reporting may be referred to the traffic police department for investigation.

Accident details

| | |
|----------------------------|---|
| Date and time of accident | Date: 28/10/20 (DD/MM/YY) Time: 19:35 (HH:MM) |
| Exact location of accident | PIE Tuaru Jurong East/West Ave 1 exit |

Details of vehicle

| | |
|--|--|
| Vehicle registration number | SMD 7081U |
| Vehicle make and model | Volkswagen Golf R |
| Type of vehicle | Saloon <input checked="" type="checkbox"/> MPV <input type="checkbox"/> CRV <input type="checkbox"/> Van <input type="checkbox"/> Lorry <input type="checkbox"/> Bus <input type="checkbox"/> Motorcycle <input type="checkbox"/> Others: _____ |
| Vehicle category | Private <input checked="" type="checkbox"/> Commercial <input type="checkbox"/> Motorcycle <input type="checkbox"/> |
| Purpose of using at said time | Private |
| Are you claiming under your own insurance company? | Yes <input type="checkbox"/> No <input type="checkbox"/> if no, please select: Third part claim <input checked="" type="checkbox"/> Reporting only <input type="checkbox"/> |

Insurance information

| | |
|-------------------|--|
| Insurance company | FWD |
| Policy number | PNPV2020 - 00 00 2585 |
| Type of policy | Comprehensive <input checked="" type="checkbox"/> Third party fire & theft <input type="checkbox"/> TP only <input type="checkbox"/> |

Insured / Policy holder

| | | |
|------------------------------|--------------|--|
| Name | Lee Yun Xuan | Male <input checked="" type="checkbox"/> Female <input type="checkbox"/> |
| NRIC / Fin / Passport number | S94496836 | |
| Contact | | |
| Address | | |

Driver

Same as insured above ☐ (skip to D.O.B)

| | | |
|------------------------------|---|--|
| Name | Reuben Ng | Male <input checked="" type="checkbox"/> Female <input type="checkbox"/> |
| NRIC / Fin / Passport number | S94026706 | |
| Contact | 9091 2961 | |
| Address | 489 Jurong West Ave. 1 #12-33 | |
| Email address | | |
| Date of birth | 26 Jun 1999 | |
| Occupation | Indoor <input checked="" type="checkbox"/> Outdoor <input type="checkbox"/> | |
| Driving date pass | 18 Aug 2017 | |

General information of the accident

| | |
|--|--|
| Was driver an employee of the insured's company? | Yes <input type="checkbox"/> No <input checked="" type="checkbox"/> |
| Accident captured by camera? | Yes <input checked="" type="checkbox"/> No <input type="checkbox"/> |
| Weather condition | Clear <input checked="" type="checkbox"/> Raining <input type="checkbox"/> Others: _____ |
| Road surface | Dry <input checked="" type="checkbox"/> Wet <input type="checkbox"/> |
| No of passenger | 2 (Inclusive of driver) |

Passenger 1

| | |
|--------|--|
| Name | Nur Izzah |
| Gender | Male <input checked="" type="checkbox"/> Female <input type="checkbox"/> |

Passenger 2

| | |
|--------|---|
| Name | Mohamed Nur Ikhsan Bin Mohd Jafri |
| Gender | Male <input type="checkbox"/> Female <input type="checkbox"/> |

Passenger 3

| | |
|--------|---|
| Name | |
| Gender | Male <input type="checkbox"/> Female <input type="checkbox"/> |

Passenger 4

| | |
|--------|---|
| Name | |
| Gender | Male <input type="checkbox"/> Female <input type="checkbox"/> |

Passenger 5

| | |
|--------|---|
| Name | |
| Gender | Male <input type="checkbox"/> Female <input type="checkbox"/> |

Passenger 6

| | |
|--------|---|
| Name | |
| Gender | Male <input type="checkbox"/> Female <input type="checkbox"/> |

Other information

| | |
|----------------------------|---|
| Was anybody injured? | Yes <input checked="" type="checkbox"/> No <input type="checkbox"/> |
| Was other vehicle damaged? | Yes <input checked="" type="checkbox"/> No <input type="checkbox"/> |

Details of police action

| | |
|---------------------|--|
| Reported to police? | Yes <input checked="" type="checkbox"/> No <input type="checkbox"/> If yes, please state which police station. |
| Police station name | |

Third party vehicle 1 (c)

| | |
|------------------------------|-----------|
| Name | |
| Contact number | |
| NRIC / Fin / Passport number | |
| Vehicle registration number | SLF 8348X |
| Vehicle make model | |

Third party vehicle 2 (b)

| | |
|------------------------------|---------|
| Name | |
| Contact number | |
| NRIC / Fin / Passport number | |
| Vehicle registration number | PC 3634 |
| Vehicle make model | |

Third party vehicle 3

| | |
|------------------------------|--|
| Name | |
| Contact number | |
| NRIC / Fin / Passport number | |
| Vehicle registration number | |
| Vehicle make model | |

Third party vehicle 4

| | |
|------------------------------|--|
| Name | |
| Contact number | |
| NRIC / Fin / Passport number | |
| Vehicle registration number | |
| Vehicle make model | |

Third party vehicle 5

| | |
|------------------------------|--|
| Name | |
| Contact number | |
| NRIC / Fin / Passport number | |
| Vehicle registration number | |
| Vehicle make model | |

Third party vehicle 6

| | |
|------------------------------|--|
| Name | |
| Contact number | |
| NRIC / Fin / Passport number | |
| Vehicle registration number | |
| Vehicle make model | |

Witness 1

| | |
|------|--|
| Name | |
|------|--|

Witness 2

| | |
|------|--|
| Name | |
|------|--|

Injured person 1

| | |
|--|---|
| Name | Reuben Ng |
| Injuries sustained | Body |
| Which vehicle person in? | SMD 7081 U |
| Were seat belts worn? | Yes <input checked="" type="checkbox"/> No <input type="checkbox"/> |
| Was injured conveyed to hospital by ambulance? | Yes <input type="checkbox"/> No <input checked="" type="checkbox"/> |

Injured person 2

| | |
|--|---|
| Name | Mohd Nur Ikhsan bin Mohd Jufi |
| Injuries sustained | Body |
| Which vehicle person in? | SMD 7081 U |
| Were seat belts worn? | Yes <input checked="" type="checkbox"/> No <input type="checkbox"/> |
| Was injured conveyed to hospital by ambulance? | Yes <input type="checkbox"/> No <input checked="" type="checkbox"/> |

Injured person 3

| | |
|--|--|
| Name | |
| Injuries sustained | |
| Which vehicle person in? | |
| Were seat belts worn? | Yes <input type="checkbox"/> No <input type="checkbox"/> |
| Was injured conveyed to hospital by ambulance? | Yes <input type="checkbox"/> No <input type="checkbox"/> |

Injured person 4

| | |
|--|--|
| Name | |
| Injuries sustained | |
| Which vehicle person in? | |
| Were seat belts worn? | Yes <input type="checkbox"/> No <input type="checkbox"/> |
| Was injured conveyed to hospital by ambulance? | Yes <input type="checkbox"/> No <input type="checkbox"/> |