

ASSIGNMENT

From:

Date:

Veh No:

SLM48321

Yr Regn:

31/3 17

Estimated Cost:

Type: M.Car / M.Cycle / Bus / Van / Lorry / Taxi / Prime Mover /

OD / TP / WS / TP RES / OD RES / EVA / INV / MV

Truck / Trailer or

To Inspect Vehicle No:

SLM48321

Make:

Mif Lancer EX c.c 1590

at Workshop m/s

Colour:

Black

A/C: Insured / Std / NI / NA

of

Sp. Reading

57440

T/Radio: Insured / Std / NI / NA

Insured:

SLG64631

Eng/No:

Policy No.

29141713 MIF

C/No:

JMYSRCY1A64006402

Claims No.

629737

Gen. Cond: Good / Fair / Poor / Burnt

Sum Insured:

Excess:

Steering: In order / Jammed / Leaked / Burnt or

(Client's Record)

Brake: In order / Jammed / Leaked / Burnt or

Make of Veh:

Modi: Nil / S/Rim / STD A/Rim or

(Policy Condition)

Remark: The veh had commenced its repair at the time of inspection.

N/S	O/S

Tyre Size:

F:

R:

225/40Z R18

BS / DUN / EXNOVA / GY / FS / LIZA / MIC / OHTSU / PIR / SUMI /

TOYO / YOKO or

Front

6

Rear

6

R/Bal.

mm

R/Bal.

mm

L/Bal.

6

mm

L/Bal.

6

mm

D.O.A.

10/10/20

D.O.I.

13/10/20

Survey held at

Des. of Damages: Frt / Rear / O/S / N/S / U/C / Rooftop or

Rear, N/S Rpt. b

The U/C / Chassis frame / Body Structure affected due to collision.

Bal. or Market Value:

85k.

IDAC Accident Rpt:

Consistent? : Yes or No

GIA / PR Seen:

Consistent? : Yes or No

Est. Repairs:

4

days

Res.:

Yes or No

Lum Sum:

20

%

3 Val.:

Yes or No

CA / REV / REP. / 24 HRS

LA42615

Vehicle: IN / OUT

Date:

Person Contacted:

ap 7500

Date / Time

Action / Instruction

MSG Rear portion - N/S Frt CT1

30/10/20 N/S 4000 confirmed with AH ping cred to 8875.15, 69%.)

Date/Time, File Pass to?

☐

: Preli. Report

1) 30/10/20

☐

: Final Report

Date/Time, File Return to?

Days Of Repair:

4

Resurvey No. of Trip:

2

Survey Fee:

Transportation:

) \$ + RS \$ SI

) Photos

) Others

TOTAL

Add Fee:

☐

: Site Insp (\$

☐

: Interview (\$

☐

: Tech. Invs (\$

☐

: Weekend (\$

Report Format :

MER-TP

Lump Sum / I.B.t. (\$

4000

PING MOTOR PTE LTD

1 Kaki Bukit Ave 6 #01-25 (Auto Bay @Kaki Bukit) Singapore 417883

Mobile no: 93419033

Email : ping.motor0125@gmail.com

MSIG

13 October 2020

QUOTATION FOR ACCIDENT REPAIR OF SLM4832D M.LANCER EX

THIRD PARTY INSURER: MSIG

S/No.	Parts	Qty	Amount
01.	Rear bumper centre beam	1	\$ 138.00
02.	Rear bumper reinforcement beam	1	\$ 254.00
03.	Rear bumper side retainer L/R	2	\$ 64.00
04.	Rear no plate lamp L/R	2	\$ 90.00
05.	Rear no plate lamp bracket L/R	2	\$ 80.00
06.	Rear boot lid keyless smart	1	\$ 158.00
07.	Rear boot lid weather strip	1	\$ 186.00
08.	Rear end panel	1	\$ 689.00
09.	Rear end panel inner garnish	1	\$ 241.00
10.	Rear end panel inner garnish clip	4	\$ 22.00
11.	Rear fender inner trim LH	1	\$ 508.00
12.	Rear fender inner trim clip LH	5	\$ 27.50
13.	Rear fender inner shield LH	1	\$ 83.00
14.	Rear fender inner shield clip LH	4	\$ 22.00
15.	Rear taillamp LH	1	\$ 897.00
16.	Rear taillamp panel LH	1	\$ 179.00
17.	Rear spare tyre top board	1	\$ 245.00
Subtotal before discount			\$ 3883.50
Discount 10%			\$ 388.35
Subtotal 1			\$ 3495.15

S/Nett.	Parts	Qty	Amount (\$)
1.	Rear customised bumper	1	\$ 2300
2.	Rear carbon fibre boot lid	1	\$ 2800
2.	Rear no plate (Chrome)	1	\$ 120
3.	Rear carbon fibre frame	1	\$ 50
4.	Rear bumper LED Light	1	\$ 150
5.	Rear bumper side reflector lamp assy	1	\$ 250
6.	Rear bumper reverse sensor	1	\$ 350
7.	Rear bumper clip	1	\$ 50
Subtotal 2			\$ 6070

Front Labour

To check wirings.	\$ 80
To remove and replace and reinstall rear reverse sensor	\$ 120
To remove and reinstall rear interior trims, garnishes, seats, etc. for necessary repairs	\$ 160
To dismantle, replace for rear bumper bodykit.	\$ 150
To straighten, repair, realign on rear affected area and replace damaged parts	\$ 1000
To spray painting on affected area	\$ 1000
Total Labour Cost	\$ 3260

Total Cost Of Repairs (Total cost of parts + Total labour cost)

\$12,825.15

P-188K 5046.50
102 202
P-1696.50 4037.2
S.N-1890
L-1460

New Cars

Used Cars

Rental Cars

Sell My Car

Directory

Products

Insurance

Articles



Make a bold
investment

XVGT

Learn More

Post an Advertisement
Sell it yourself! Advertise it at just
\$58 until it's SOLD!

Post an Ad

Advertiser Login

Ways of Selling

New 5 Years Renewal COE Kia Cerato Forte 1.6A



VGVW 2.5% P.A. \$428 Monthly
By Gv Financing. \$5 Admin \$5
Down 7 years warranty
GV Credit Pte Ltd



Browse by Category

Sort by Date Posted

9 vehicles

Mitsubishi Lancer

Image	Model	Price	Depreciation	Eng Cap	Mileage	V
Search Selection	Mitsubishi Lancer	Any	Any	2017	Any	Any
	Mitsubishi Lancer EX 1.6A	\$56,888	\$7,890 /yr	18-Apr-2017	1,590 cc	35,500 km
Only 1 Owner And One Of The Lowest Mileage Unit In The Market! Fully Maintained By Agent C&C With 5+5 Years Warranty! Spacious Interior And Boot Space! Beautiful Interior Like Brand New! Up To 100% Loan Available! Bank Interest Promo From 1.88%! Call For App						
Posted: 12-Oct-2020 Tags: 2017 Mitsubishi Lancer, Mitsubishi Lancer, Mitsubishi, Lancer						
	Mitsubishi Lancer EX 1.6A	\$56,800	\$7,940 /yr	31-Mar-2017	1,590 cc	67,700 km
Cycle & Carriage Unit. One Owner. Metallic Grey Exterior With Black Interior. Low Depreciation To Go With. Fully Stock Condition With N Modification Done. Most Popular Mitsubishi Sedan. Fuel Eco With Spacious Boot Space. Attractive Low Rate Of 2.48%. Please Call Our S						
Inchape Pre-Owned						
Posted: 12-Oct-2020 Tags: 2017 Mitsubishi Lancer, Mitsubishi Lancer, Mitsubishi, Lancer						
	Mitsubishi Lancer EX 1.6A	\$98,800	\$13,640 /yr	17-Aug-2017	1,590 cc	-
Full Loan Available At Monthly \$900 Plus! Low Mileage! Bank Or In House Loan Is Available. We Provide Lowest Interest Rate. Loan And High Trade In Are Available. Ex-Bankruptcy Or Bad Credit Can Apply. Grab And Gojek Are Most Welcomed. Meet Our Friendly Consultant						
Posted: 11-Oct-2020 Tags: 2017 Mitsubishi Lancer, Mitsubishi Lancer, Mitsubishi, Lancer						
	Mitsubishi Lancer EX 1.6A	\$56,888	\$7,950 /yr	09-Feb-2017	1,590 cc	-
Facelifted Lancer Ex! Well Taken Care Of By One Fussy Owner, 90% Loan Of The Car Price Available With High Trade In Value. A Company With Professional Sales Serviced Assured. Call Us Now To Arrange For Viewing.						
Yes Motoring						
Posted: 10-Oct-2020 Tags: 2017 Mitsubishi Lancer, Mitsubishi Lancer, Mitsubishi, Lancer						
	Original Front Bumper With Front Lip & Fog Light For Mitsubishi Lancer CS3 '03					
Mitsubishi Lancer CS3 '03 original front bumper.						
More info about this product						
	Mitsubishi Lancer EX 1.6A	\$57,800	\$7,660 /yr	16-Aug-2017	1,590 cc	29,389 km
Still Have The New Car Smell. Very Low Mileage Unit! Full Agent Serviced! Very Well Maintained Unit, Come Down To View It Today						
Gone Now! Bank / In-house Loan Available! Trade-in Welcome Too! No Dealer Please, Thanks!						
ad: 09-Oct-2020 Tags: 2017 Mitsubishi Lancer, Mitsubishi Lancer, Mitsubishi, Lancer						

Compare

> Back to OneMotoring

Enquire PARF/COE Rebate for Registered Vehicle

Vehicle Owner Particulars

Owner ID Type: Singapore NRIC
Owner ID: 492G

Vehicle Details

Vehicle No.: SLM4832D
Vehicle to be Exported: No
Intended Deregistration Date: 14 Oct 2020
Vehicle Make: MITSUBISHI
Vehicle Model: LANCER EX 1.6 AT LED TAIL LAMP
Primary Colour: Black
Manufacturing Year: 2016
Engine No.: 4A92CN2338
Chassis No.: JMYSRCY1AGU006402
Maximum Power Output: 86.0 kW (115 bhp)
Open Market Value: \$13,077.00
Original Registration Date: 31 Mar 2017
First Registration Date: 31 Mar 2017
Transfer Count: 0
Actual ARF Paid: \$13,077.00 6538

Intended PARF Rebate Details

PARF Eligibility: Yes
PARF Eligibility Expiry Date: 30 Mar 2027
PARF Rebate Amount: \$9,807.00

Intended COE Rebate Details

COE Expiry Date: 30 Mar 2027
COE Category: A - Car up to 1600cc & 97kW (130bhp)
COE Period(Years): 10
QP Paid: \$50,789.00
COE Rebate Amount: \$32,808.00
Total Rebate Amount: \$42,615.00

The information contained herein is correct as at 14 Oct 2020

OK

SINGAPORE ACCIDENT STATEMENT

IMPORTANT NOTICE

1. Please report correctly the details of the accident to speed up the claims process.
2. This Form must be completed by the Policyholder and/or the Authorised Driver.
3. Information provided must be as truthful and accurate as possible. Any wilful misrepresentation or withholding of material facts may allow insurance companies to repudiate policy liability.
4. The issue and acceptance of this Form by insurance companies is not an admission of policy liability on the part of the insurance companies.
5. **Any false reporting may be referred to the Police for investigation.**
6. This report will be forwarded by the insurers of the GIA Records Management Centre established by the General Insurance Association of Singapore (GIA) for archiving and that copies of this report will, for a fee, be made available upon application by interested parties.
7. By the lodgement of this report to the insurers, you hereby consent to the archiving of this report at the centre and to copies of the report being made available aforesaid.

ACCIDENT STATEMENT

Date Of Report	12/10/2020 10:45
Date Of Accident	10/10/2020 07:30
Exact Location Of Accident	AYER RAJAH EXPRESSWAY
Country/State of Loss	SINGAPORE

DETAILS OF OWN VEHICLE

Vehicle Registration Number	SLM4832D
Insured/Policyholder	
Name Of Registered Owner	TAN KAH WAH
NRIC No	SXXXX492G
Email Address	Y3KAHWAH@HOTMAIL.COM
Mobile Phone No	(LOCAL) +65-93228146
Alternative Phone No	OTHERS-93228146
Vehicle Particulars	
Manufacturer	MITSUBISHI
Model	LANCER-1.6 EX AT LED TAIL LAMP (A)
Exact Purpose for which vehicle was being used at time of accident	LEISURE
Are you claiming under your own insurance policy for repair to your vehicle?	NO
If No, Please state action to be taken	THIRD PARTY
Vehicle Category	PRIVATE CAR

Insurance Company

Name of Insurance Company	DIRECT ASIA INSURANCE (SINGAPORE) PTE LTD
Type Of Coverage	THIRD PARTY FIRE AND/OR THEFT
Fleet Policy	NO
Policy Number	MT/00778672
Cover Note Number	

Driver

Name of Driver	TAN KAH WAH
NRIC No	SXXXX492G
Date Of Birth	21/07/1986
Occupation	OUTDOOR
Date Of Driving Pass	05/09/2005
Driving Experience	15 YEARS AND 1 MONTH
Gender	MALE
Mobile Number	(LOCAL) +65-93228146
Fax Number	
Contact Number	OTHERS-93228146
EMail Address	Y3KAHWAH@HOTMAIL.COM

Address	BLK 871C TAMPINES ST 86 #08-46
Postcode	523871
Was driver an employee of the Insured's Company	NO
If No, Relationship of the Driver with the Insured	OWNER
Vehicle Registration Number of Driver's Own Vehicle	FBL1237R
	-
	-
Insurance Company of Driver's Own Vehicle	DIRECT ASIA INSURANCE (SINGAPORE) PTE LTD
	-
	-

General Information of the Accident

Type Of Accident	CHAIN COLLISION
Weather Conditions	RAINING
Road Surface	WET

Other Information

Was any foreign vehicle involved in this accident?	NO
Number of vehicles (including own vehicle) involved in the accident	4
Was any body injured in the Accident?	YES
Was any injured conveyed to hospital by ambulance?	NO
Was any other material or property damaged?	YES
I have been approached by unknown person(s) soliciting/offering accident claims assistance.	NO
Number of Passengers (Including Driver)	1

Details of Police Action

Was the accident reported to the police?	YES
If Yes, Please state which Police Station	
Police Station Name	TRAFFIC POLICE DIVISION HQ - SINGAPORE CITY
Police Station Address	ROAD: 10 UBI AVENUE 3 , POSTCODE: 408865 , COUNTRY: SINGAPORE
Police Station Contact	TEL NO: 65470000 - FAX NO:
Was notice of intended Prosecution given?	NO
If Yes, against whom?	

Circumstances of Accident

AS PER POLICE REPORT NO: T/20201011/7003.

Attachment(s)

Are accident photos available for attachment?	YES
Was there any video captured by Car Camera?	YES
Was there any audio recorded?	NO

DETAILS OF OTHER VEHICLE PROPERTY 1

Vehicle Registration Number	GBE242T
Vehicle Make/Model/Colour	
Details Of Properties	
Vehicle Category	GOODS VEHICLE
Name of Driver	CHEE CHOON FA
NRIC/Passport Number	SXXXX836E
Contact Number	94591992
Address	
Postcode	
Insurance Company Name	
Nature Of Damage	

No. Of Passenger (Including Driver)

DETAILS OF OTHER VEHICLE PROPERTY 2

Vehicle Registration Number SLG6463D
Vehicle Make/Model/Colour
Details Of Properties
Vehicle Category PRIVATE CAR
Name of Driver
NRIC/Passport Number
Contact Number
Address
Postcode
Insurance Company Name
Nature Of Damage
No. Of Passenger (Including Driver)

DETAILS OF INJURED PERSON 1

Name TAN KAH WAH
Approximate Age
Injuries Sustain
Injured person in which vehicle? SLM4832D
Were seat belts worn?
Was this injured conveyed to hospital by ambulance?
Address
Postcode

Sketch Plan

SKETCH PLAN

IMPORTANT NOTICE

1. Please report correctly the details of the accident to speed up the claims process.
2. This Form must be completed by the Policyholder and/or the Authorised Driver.
3. Information provided must be as truthful and accurate as possible. Any wilful misrepresentation or withholding of material facts may allow insurance companies to repudiate policy liability.
4. The issue and acceptance of this Form by insurance companies is not an admission of policy liability on the part of the insurance companies.
5. Any false reporting may be referred to the Police for investigation.
6. The report will be forwarded by the insurers of the GIA Records Management Centre established by the General Insurance Association of Singapore (GIA) for archiving and that copies of this report will for a fee be made available upon application by interested parties.
7. By the lodgment of this report to the insurers, you hereby consent to the archiving of this report at the centre and to copies of the report being made available aforesaid.
8. **Consent under the Personal Data Protection Act (PDPA)**

I understand, acknowledge, agree and consent that:

- (a) My insurer, my workshop and the General Insurance Association of Singapore ("GIA") may/are permitted to collect, use, disclose and/or process my personal data/personal information set out in this [form] and any other personal information provided by me or possessed by my insurer (collectively the "Personal Information") and disclose and transfer such Personal Information to all insurer(s) who have insured vehicle(s) involved in this accident (all insurer(s) who have insured vehicle(s) involved in this accident shall be collectively referred to as the "Insurers"), the Insurers' lawyers/law firms, the Monetary Authority of Singapore and any relevant government agency/authority (such as the police), for the purpose(s) of:
 - (i) processing, handling and/or dealing with my claims including the settlement of the claims and any necessary investigations relating to the claims;
 - (ii) investigating the accident and/or my claims;
 - (iii) carrying out and/or dealing with my instructions or responding to any enquiries by me;
 - (iv) administering my claims (including the mailing of correspondence, statements, invoices, reports or notices to me, which could involve disclosure of certain personal data about me to bring about delivery of the same as well as on the external cover of envelopes/mail packages); and/or
 - (v) complying with applicable law in administering, processing, handling and/or dealing with my claims (collectively the "Purposes");
- (b) all insurer(s) who have insured vehicle(s) involved in this accident and the Insurers' lawyers/law firms, may/are permitted to collect, use, disclose and/or process my Personal Information for one or more of the above Purposes; and
- (c) my Personal Information may/can be disclosed by any of the Insurers and/or GIA to their third party service providers or agents (including their lawyers/law firms), which may be sited outside of Singapore, for one or more of the above Purposes.
- (d) my Personal Information will also be collected and used to compile claims history for the purpose of fraud detection, investigation and management in present and all future claims.
- (e) the information so collected under (d) above may be shared / disclosed:
 - (i) to all insurers and/or any other third parties that assist in evaluating, investigating, controlling or managing fraud, regulators, law enforcement and government agencies as reasonably required for the purposes stated; or
 - (ii) for complying with requirements under any regulations, laws or court orders.

Policyholder's Signature
Date & Time:

Driver's Signature
(If driver is not the policyholder)
Date & Time:

Reporting Centre's Signature
Name:
NRIC/PIN No.:



Sketch Plan #2

SKETCH PLAN

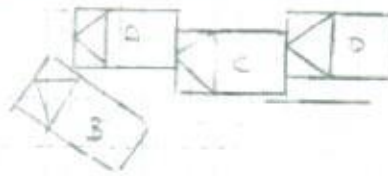

DESCRIBE CIRCUMSTANCES OF THE ACCIDENT

As per police report
Report no: T1202010117003

DECLARATION

I/We declare the foregoing particulars are true in every respect.

Policyholder's Signature
Date & Time:

Driver's Signature
(if driver is not the policyholder)
Date & Time:

Reporting Centre
Name:
NRIC/FIN No.:



Police Report



**SINGAPORE
POLICE FORCE**



T/20201011/7003

1 of 3

Police Station Of Origin:
Traffic Police
10 Ubi Avenue 3 SINGAPORE 408865
Tel No: 65470000

Report No: T/20201011/7003

REPORT OF A TRAFFIC ACCIDENT

Date/Time Report Made: 11/10/2020 09:13		Vide Report No.:		Station Diary No.:	
Informant's Particulars					
Name of Informant: TAN KAH WAH			Address: 871C TAMPINES STREET 86 #08-46 SINGAPORE 523871		
ID Type / ID No.: NRIC NO / S8670492G			Contact No.: Home/Office: Mobile: 93228146		
Nationality: SINGAPORE CITIZEN			Email: y3kahwah@hotmail.com		
Sex: Male	Age: 34	Date of Birth: 21/07/1986	Type of Informant: Driver		
Race: Chinese			Language: English		Institution / School Name:
Occupation: Chemistry technician			Driving Licence Information: Class: 3		Date of Expiry:

General information of the Accident

Type of Accident:	Injury Others	Drink Drive: No	Date/Time of Accident: 10/10/2020 08:00	Type of Location: AYE
Location: AYER RAJAH EXPRESSWAY				
Weather: Raining		Road Surface: Wet		Road Speed Limit: 60 Km/h
Traffic Flow: One Way		Traffic Control:		Traffic Volume:
Type of Collision: Between Moving Vehicles - Side Swipe - Same Direction				Anyone conveyed by ambulance: No

Details of Vehicle Involved

Vehicle No.	Type	Make	Model	Color	Condition	No of
SLM4832D	Car	MITSUBISHI	LANCER+E X+1.6+AT+L ED+TAIL+LA MP	Black		0

Details of Vehicle Insurance

Vehicle No.	Insurance Company	Insurance No	Effective	Expiry Date
-------------	-------------------	--------------	-----------	-------------

Police Report



**SINGAPORE
POLICE FORCE**



T/20201011/7003

2 of 3

Police Station Of Origin:
Traffic Police
10 Ubi Avenue 3 SINGAPORE 408865
Tel No: 65470000

Report No: T/20201011/7003

CONTINUATION OF REPORT

Details of Vehicle Insurance				
Vehicle No.	Insurance Company	Insurance No	Effective	Expiry Date
SLM4832D	DIRECT ASIA INSURANCE (SINGAPORE) PTE. LTD.	MT/00778672	31/03/2020	30/03/2021

Details of Person Involved			
Any Pedestrian Involved: No			
No. of Pedestrians Injured: NIL		Use of Pedestrian Crossing: NA	
Driver			
Name	TAN KAH WAH		ID No. S8670492G
Related Vehicle	SLM4832D (Car)		Contact No. 93228146
Hospital/Clinic	CENTRAL 24-HR CLINIC (BEDOK)		Class of Driving Licence & Expiry Class: 3 Date of Expiry: NIL
Date	10/10/2020		Date NIL
No. of Days granted Medical Leave	02	Degree of	Slight

Brief Details.

On AYE towards Tuas before portdown exit, i was side swiped by a lorry and also rear ended by a private car (toyota prius). At the same time, toyota prius was rear ended by a comfort taxi. There are a total of 4 vehicles involved: 3 cars & 1 lorry.

I have videos & photos of accident mentioned above.

Police Report



**SINGAPORE
POLICE FORCE**

Police Station Of Origin:
Traffic Police
10 Ubi Avenue 3 SINGAPORE 408865
Tel No: 65470000



T/20201011/7003

3 of 3

Report No: T/20201011/7003

CONTINUATION OF REPORT

Sketch Plan

Informant is not able to provide sketch

Signature Of Officer Recording The Report:
Not applicable

Signature Of Interpreter:
Not applicable

Officer In Charge Of Case:
TP / TPHQ /
WONG SIEU LUI
Contact No.: 65476151

Authentication Stamp
NP168

Signature Of Informant:
The identity of the person making this report has
been authenticated by SingPass. No signature is
required

Date/Time:
11/10/2020 09:13

Classification Of Case: