

FASTECH AUTO PTE LTD

1 Kaki Bukit Ave 6 #01-48 Autobay

Singapore 417883

Tel No: 67452063 / 67467158 Fax No: 67458520

Tax Reg No: 200006262D

Date : 27.10.2020

AIG Asia Pacific Insurance Pte Ltd

Chartis Building

78 Shenton Way #07-16

Singapore 079120

Attn: Motor Claim Department

Dear Sir/Madam,

ACCIDENT INVOLVING VEHICLES : SGS 2134B / SJV 400U ON 03.10.2020

We are the authorized repair workshop for the owner of motor vehicle no: **SGS 2134B** , which was involved in the captioned accident with your insured vehicle no: **SJV 400U** . The vehicle owner has requested and authorized us to assist him in presenting his/her claim against the party responsible for the damage to the vehicle.

As the accident was caused by the negligent act of your insured driving, we are submitting these claims for your consideration on behalf of the owner/claimant.

1) Cost of Repair (inclusive of GST)	\$ 3,424.00
2) Loss of Rental	\$ 360.00
3) GIA Search Fee	\$ 2.00
	<u>\$ 3,786.00</u>

We enclosed herewith the following documents to support the claims:

- | | |
|--------------------------|------------------------------------|
| a) Final Repair Invoice | b) Car Rental Invoice / Agreement |
| c) GIA Search Result | d) Letter of Authorisation, etc... |
| e) GIA Report | f) I/C & Driving Licence |
| g) Insurance Certificate | h) Vehicle Registration Log Card |

Kindly look into the matter and let us hear from you on the settlement of our customer's claims as soon as possible.

Please note that it is a condition of any settlement reached that it shall be without prejudice to any personal injury claim (if any) of the owner/claimant.

Thank you.

Yours faithfully,



Jason Tang (jason@fastechauto.com.sg)

For FASTECH AUTO PTE LTD

TAX INVOICE

FASTECH AUTO PTE LTD

1 Kaki Bukit Ave 6 #01-48 Autobay

Singapore 417883

Tel No: 67452063 / 67467158 Fax No: 67458520

Tax Reg No: 200006262D

AIG Asia Pacific Insurance Pte Ltd

Chartis Building

78 Shenton Way #07-16

Singapore 079120

Attn : Motor Claim Department

Tax Invoice : 22027

Date : 27.10.2020

Vehicle No : SGS 2134B

Make/Model : HONDA STREAM 1.8A

Chassis/Eng# :

Accident Date : 03.10.2020

Claim No :

Reference : 1020 -22027

Policy No :

	Amount
To proceed on lump sum repair	S\$ 3200.00

E. & O. E.

Total : S\$ 3200.00

GST @ 7% : S\$ 224.00

Amount Due : **S\$ 3424.00**



for FASTECH AUTO PTE LTD

DYNAMIC CAR RENTAL

1 Kaki Bukit Ave 6 #01-46 Autobay

Singapore 417883

Tel No: 6741 7244 / 6746 5405 Fax No: 6745 8520 / 6746 5786

Co. Reg No: 52928467K

To: LIM SIEW BEE

Invoice : DCR-2020-10-11

Date : 09.10.2020

Agreement No : 21458

Payment Terms : LOD

DESCRIPTION	AMOUNT
Rental charges for vehicle : <u>SCG 9897Y</u> (0920-22004)	\$ 360.00
Rental Period from <u>07.10.2020</u> to <u>09.10.2020</u> .	

E. & O. E.	Total \$ <u><u>360.00</u></u>
------------	-------------------------------

SHI YING
for Dynamic Car Rental

Dynamic Car Rental

1 KAKI BUKIT AVENUE 6, #01-46/48/50 AUTOBAY, SINGAPORE 417883.

TEL: (+65) 6741 7244, 6746 5405 FAX: (+65) 6745 8520, 6746 5786

Co. Reg. No. 52928467K

RENTAL TERMS AND CONDITIONS

No. **21458**

Name Lim Siew Bee			REG. No. SCG 9897Y		MAKE MODEL:	
ADDRESS 271 Joo Chiat Place					DIESEL PETROL E 1/4 1/2 3/4 F	
Singapore 427952.			KM IN		DATE & TIME IN 09.10.2020 @ 16:09pm	
			KM OUT		DATE & TIME OUT 07.10.2020 @ 16:15pm	
			KM DRIVEN		TIME USED	
NAMED DRIVER						
DRIVING LICENCE NO S6805461C	DATE OF EXPIRY	PLACE OF ISSUE	HOURS		@S\$	
PASSPORT NO	DATE OF ISSUE	PLACE OF ISSUE	2 DAYS		@S\$ 180.00	\$360.00
ADD NAMED DRIVER			WEEKS		@S\$	
DRIVING LICENCE NO	DATE OF EXPIRY	PLACE OF ISSUE	MONTHS		@S\$	
PASSPORT NO	DATE OF ISSUE	PLACE OF ISSUE	BY INITIALLING, RENTER AGREES TO PAY ADD FEE FOR COLLISION DAMAGES WAIVER (C.D.W.)		SUB-TOTAL	
IMPORTANT NOTES: This vehicle is licenced to carry 04 passengers only. No refund will be given for vehicle returns early. No refund will be given for period left in vehicle. Hirer is liable to pay first \$4000 under section I & II in any accident plus loss of earnings while damaged vehicle is under repair. Hirer is liable to pay all parking fee and traffic summonses. Vehicle return during office hour only. No Service on Public Holiday and Sunday. EXCESS: *Sec I - Used in S'pore Only :SGD2000 *Sec II - Used in S'pore Only :SGD2000 *Sec I - Used Outside S'pore Only :SGD4000 *Sec II - Used Outside S'pore Only :SGD4000 W/screen Excess In S'pore: SGD100 W/screen Excess Outside S'pore: SGD200 ADDITIONAL CONDITIONS: * Geographical areas: Singapore & West Malaysia. * Driver must be: a) 18 years old and above; b) holding a valid relevant class of driving license. * Additional Own Damage Excess of \$51,000 is applicable for any named/unnamed drivers who: a) age 22 to 23 years old; b) age 66 to 70 years old; c) with driving experience of 1 year to less than 2 years in Singapore on the relevant classes of driving license. * Additional All Claims excess of \$52,000 is applicable for any named/unnamed drivers who: a) is 18 years old to 21 years old and/or b) is 71 years old and above and/or c) with driving experience of less than 1 year on the relevant classes of driving license. * Upon returning the replacement vehicle, you must ensure that all expensive and important items to be removed away from this replacement vehicle. We/I will not be responsible for any reporting of such losses. * Hirer is liable to pay first \$4000 under section I & II in any accident plus loss of earning while damage vehicle is under repair. Hirer is responsible for Additional \$4,000.00 Excess to the THIRD PARTY DAMAGE / INJURY claims.			TOTAL RENTAL		\$360.00	
			DELIVERY FEE			
			COLLECTION FEE			
			PER DAY \$ PER WEEK \$ PER MONTH \$			
BY INITIALLING, RENTER AGREES TO PAY ADD FEE FOR PERSONAL ACCIDENT INSURANCE (P.A.I.) X PER DAY \$ PER WEEK \$ PER MONTH \$			PREPAYMENT		TOTAL CHARGE	
			CHECK		DEPOSIT	
			CASH			
			RECEIPT NO.		NETT CHARGE	
AMOUNT DUE / REFUND						

I HAVE READ THE TERMS AND CONDITIONS ON BOTH SIDES OF THIS RENTAL AGREEMENT AND AGREE THEREOF.

SIGNED BY THE PARTIES HERETO ON THE DAY OF

X

DYNAMIC CAR RENTAL

X

RENTER'S/DRIVER'S SIGNATURE

**GENERAL INSURANCE ASSOCIATION OF SINGAPORE
RECORDS MANAGEMENT CENTRE**

6 Raffles Quay #18-00, Singapore 048580
Phone: +65 6224 0010 Fax: +65 6224 0030
Operating Hours: Monday to Friday 9am to 5pm
GST Registration No: M400017735

Third Party Insurer Enquiry

Our Ref No: GR-20-121467
Date of Request: 07/10/2020

Your Ref No: Online Purchase

Kim Chwee Auto Pte Ltd
1 Kaki Bukit Avenue 6 #01-48
AutoBay@Kaki Bukit
Singapore 417883

Dear Sir/Madam,

Enquiry Date 07/10/2020
Enquiry By Tang Kok Wee, Allan
Vehicle No. SJV400U
Accident Date 07/10/2020

Enquiry Result

TP Vehicle No.	Insurer	Period of Insurance	Insurer Tel. No.
SJV400U	AIG Asia Pacific Insurance Pte. Ltd.	06/02/2020-05/02/2021	65-6419-3000

Thank You.

The images provided to you are taken from the original reports forwarded to the centre by the members of the General Insurance Association of Singapore and we take no responsibility for their accuracy or contents and shall be under no liability whatsoever for any loss or damage arising out of or in connection with the reports or their images.

This is a computer generated document and requires no signature.

**GENERAL INSURANCE ASSOCIATION OF SINGAPORE
RECORDS MANAGEMENT CENTRE**

6 Raffles Quay #18-00, Singapore 048580
Phone: +65 6224 0010 Fax: +65 6224 0030
Operating Hours: Monday to Friday 9am to 5pm
GST Registration No: M400017735

TAX INVOICE

Our Ref No: GR-20-121467

Date of Request: 07/10/2020

Your Ref No: Online Purchase

Kim Chwee Auto Pte Ltd
1 Kaki Bukit Avenue 6 #01-48
AutoBay@Kaki Bukit
Singapore 417883

Dear Sir/Madam,

Enquiry Date 07/10/2020
Enquiry By Tang Kok Wee, Allan
☐ Vehicle No. SJV400U
Accident Date 07/10/2020

DESCRIPTION	AMOUNT (S\$)
TP Insurer Enquiry	1.87
GST Amount	0.13
Total Amount Due (GST Inclusive)	2.00

Thank You.

This is a computer generated document and requires no signature.

For GIARMC Official use:

Date:

☒ [X] GIRO ☐ [] Cash ☐ [] Cheque



AUTHORIZATION TO ACT
(AIG Asia Pacific – EXPRESS THIRD PARTY CLAIM)

I, Lim Siew Bee ("the third party claimant")
of 271 Joo Chiat Place Singapore 427952. (address),
owner of SGS 2134B (vehicle no.) hereby authorize
FasTech Auto Pte Ltd.
("the workshop") to act for me with respect to my claim for repair costs and/or
rental and/or loss of use ("claim") for my vehicle no. SGS 2134B that was
damaged pursuant to the accident which occurred on 03.10.2020 (date) along
Along Service Rd of Carpark 161 Bedok South Ave 3 (location)
involving vehicle no/s SJV 400U ("the accident").

I further authorize the workshop to settle the above mentioned claim in a
manner that they deem fit and the workshop is further authorized to receive
payment further to settlement of my claim with payment cheque/s being made in
favour of the workshop.

I further acknowledge that any settlement the workshop may reach on my
behalf is on a without prejudice and without admission of liability basis insofar
as the driver/owner/insurers of the other vehicle/s is concerned.

Date this 07 day of Oct (month) 20 20 (year)

Lim Siew Bee

Signed by "the third party claimant"

[Signature]



Signed by "the workshop"

SINGAPORE ACCIDENT STATEMENT

IMPORTANT NOTICE

1. Please report correctly the details of the accident to speed up the claims process.
2. This Form must be completed by the Policyholder and/or the Authorised Driver.
3. Information provided must be as truthful and accurate as possible. Any wilful misrepresentation or withholding of material facts may allow insurance companies to repudiate policy liability.
4. The issue and acceptance of this Form by insurance companies is not an admission of policy liability on the part of the insurance companies.
5. **Any false reporting may be referred to the Police for investigation.**
6. This report will be forwarded by the insurers of the GIA Records Management Centre established by the General Insurance Association of Singapore (GIA) for archiving and that copies of this report will, for a fee, be made available upon application by interested parties.
7. By the lodgement of this report to the insurers, you hereby consent to the archiving of this report at the centre and to copies of the report being made available aforesaid.

ACCIDENT STATEMENT

Date Of Report	03/10/2020 14:24
Date Of Accident	03/10/2020 10:55
Exact Location Of Accident	ALONG SERVICE RD OF CARPARK 161 BEDOK SOUTH AVE 3.
Country/State of Loss	SINGAPORE

DETAILS OF OWN VEHICLE

Vehicle Registration Number	SGS2134B
Insured/Policyholder	
Name Of Registered Owner	LIM SIEW BEE
NRIC No	SXXXX461C
Email Address	FELICIA.LIM123@GMAIL.COM
Mobile Phone No	(LOCAL) +65-91788167
Alternative Phone No	OFFICE-91788167

Vehicle Particulars

Manufacturer	HONDA
Model	STREAM 1.8 A

Exact Purpose for which vehicle was being used at time of accident

Are you claiming under your own insurance policy for repair to your vehicle? NO

If No, Please state action to be taken THIRD PARTY

Vehicle Category PRIVATE CAR

Insurance Company

Name of Insurance Company	DIRECT ASIA INSURANCE (SINGAPORE) PTE LTD
Type Of Coverage	COMPREHENSIVE
Fleet Policy	NO
Policy Number	MT/00754443
Cover Note Number	

Driver

Name of Driver	LIM SIEW BEE
NRIC No	SXXXX461C
Date Of Birth	07/02/1968
Occupation	INDOOR
Date Of Driving Pass	19/07/2004
Driving Experience	16 YEARS AND 2 MONTHS
Gender	FEMALE
Mobile Number	(LOCAL) +65-91788167
Fax Number	
Contact Number	OFFICE-91788167
EMail Address	FELICIA.LIM123@GMAIL.COM

Address	271 JOO CHIAT PLACE
Postcode	427952
Was driver an employee of the Insured's Company	NO
If No, Relationship of the Driver with the Insured	OWNER
Vehicle Registration Number of Driver's Own Vehicle	-
	-
	-
Insurance Company of Driver's Own Vehicle	-
	-
	-

General Information of the Accident

Type Of Accident	SIDE SWIPE
Weather Conditions	CLEAR
Road Surface	DRY

Other Information

Was any foreign vehicle involved in this accident?	NO
Number of vehicles (including own vehicle) involved in the accident	2
Was any body injured in the Accident?	NO
Was any injured conveyed to hospital by ambulance?	
Was any other material or property damaged?	YES
I have been approached by unknown person(s) soliciting/offering accident claims assistance.	NO
Number of Passengers (Including Driver)	1

Details of Police Action

Was the accident reported to the police?	NO
If Yes, Please state which Police Station	
Was notice of intended Prosecution given?	NO
If Yes, against whom?	

Circumstances of Accident

Please refer attached. Please note that due to the driver's driving licence had faded, unable to read the Licence Pass Date, as such, the issue date of the licence is use in this report.

Attachment(s)

Are accident photos available for attachment?	YES
Was there any video captured by Car Camera?	NO
Was there any audio recorded?	NO

DETAILS OF OTHER VEHICLE PROPERTY 1

Vehicle Registration Number	SJV400U
Vehicle Make/Model/Colour	
Details Of Properties	
Vehicle Category	PRIVATE CAR
Name of Driver	
NRIC/Passport Number	
Contact Number	
Address	
Postcode	
Insurance Company Name	
Nature Of Damage	
No. Of Passenger (Including Driver)	

Sketch Plan

SKETCH PLAN

IMPORTANT NOTICE

1. Please report correctly the details of the accident to speed up the claims process.
2. This Form must be completed by the Policyholder and/or the Authorised Driver.
3. Information provided must be as truthful and accurate as possible. Any wilful misrepresentation or withholding of material facts may allow insurance companies to repudiate policy liability.
4. The issue and acceptance of this Form by insurance companies is not an admission of policy liability on the part of the insurance companies.
5. Any false reporting may be referred to the Police for investigation.
6. The report will be forwarded by the insurers of the GIA Records Management Centre established by the General Insurance Association of Singapore (GIA) for archiving and that copies of this report will for a fee be made available upon application by interested parties.
7. By the lodgment of this report to the insurers, you hereby consent to the archiving of this report at the centre and to copies of the report being made available aforesaid.
8. **Consent under the Personal Data Protection Act (PDPA)**

I understand, acknowledge, agree and consent that:

- (a) My insurer, my workshop and the General Insurance Association of Singapore ("GIA") may/are permitted to collect, use, disclose and/or process my personal data/personal information set out in this [form] and any other personal information provided by me or possessed by my insurer (collectively the "Personal Information") and disclose and transfer such Personal Information to all insurer(s) who have insured vehicle(s) involved in this accident (all insurer(s) who have insured vehicle(s) involved in this accident shall be collectively referred to as the "Insurers"), the Insurers' lawyers/law firms, the Monetary Authority of Singapore and any relevant government agency/authority (such as the police), for the purpose(s) of:
 - (i) processing, handling and/or dealing with my claims including the settlement of the claims and any necessary investigations relating to the claims;
 - (ii) investigating the accident and/or my claims;
 - (iii) carrying out and/or dealing with my instructions or responding to any enquiries by me;
 - (iv) administering my claims (including the mailing of correspondence, statements, invoices, reports or notices to me, which could involve disclosure of certain personal data about me to bring about delivery of the same as well as on the external cover of envelopes/mail packages); and/or
 - (v) complying with applicable law in administering, processing, handling and/or dealing with my claims (collectively the "Purposes")
- (b) all insurer(s) who have insured vehicle(s) involved in this accident and the Insurers' lawyers/law firms, may/are permitted to collect, use, disclose and/or process my Personal Information for one or more of the above Purposes; and
- (c) my Personal Information may/can be disclosed by any of the Insurers and/or GIA to their third party service providers or agents (including their lawyers/law firms), which may be sited outside of Singapore, for one or more of the above Purposes.
- (d) my Personal Information will also be collected and used to compile claims history for the purpose of fraud detection, investigation and management in present and all future claims.
- (e) the information so collected under (d) above may be shared / disclosed:
 - (i) to all insurers and/or any other third parties that assist in evaluating, investigating, controlling or managing fraud, regulators, law enforcement and government agencies as reasonably required for the purposes stated, or
 - (ii) for complying with requirements under any regulations, laws or court orders.

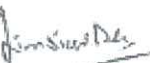

Policyholder's Signature

Date & Time: 03/12/2020

12:17 pm

Driver's Signature

(If driver is not the policyholder)

Date & Time:

Reporting Centre Personnel's Signature

Name:

NRIC/FIN No.:

Sketch Plan #2

Accident Toolkit

Sketch plan

Sketch of accident scene:

Please illustrate the layout of roads with arrows showing the direction and position of vehicles at the time of impact. Also please note the road names, road signs and vehicle registration numbers.

If safe, please take photos or videos from all angles.

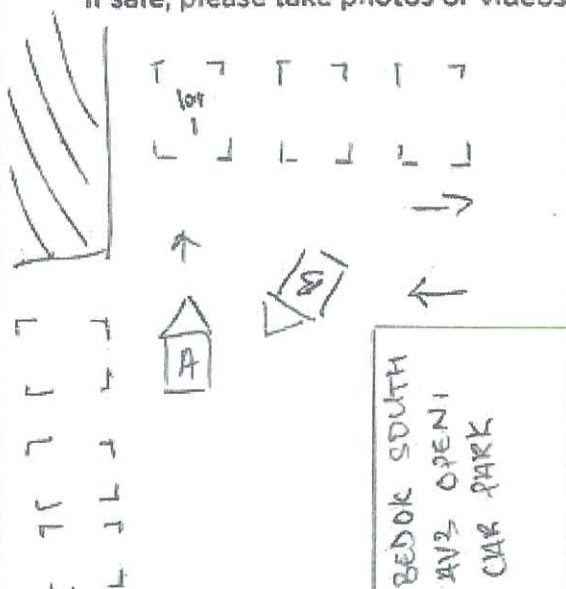

On 3rd October 2020 at around 10.56 am, I drove my car to park at lot space lot 1 (see picture). Whilst approaching the lot, there was car B turning her direction towards me. The driver of car B did not show moments of stopping the car at the turning junction, although I've signalled to her couple of times. Her car collided into mine thereafter. There are denting / scratches on the driver's side of my car.

Please indicate on vehicle A (your vehicle) and, vehicle B (third party vehicle), the point of impact and area(s) of visible damage with an arrow.

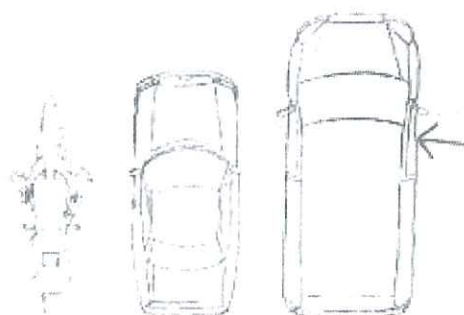

Vehicle A
(SGS 2134B)

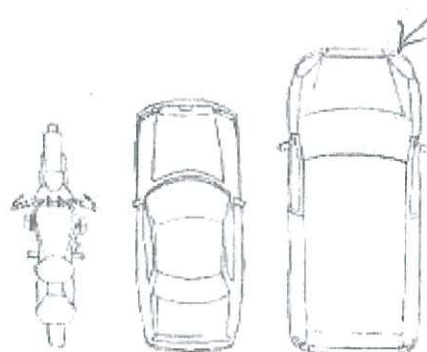

Vehicle B
(8JV 400U)

direct
asia
insurance

Kim Siew

03/10/2020

12:17 pm

Call us direct

Customer Care

6665 5555

Claims Support 24/7 Hotline

6532 1818

*05 6663 3630 (from overseas)

REPUBLIC OF SINGAPORE
IDENTITY CARD NO. S6805461C



Name
LIM SIEW BEE
林秀美
Race
CHINESE
Date of Birth
07-02-1968
Country of Birth
SINGAPORE

Sex
F

S6805461C

REPUBLIC OF SINGAPORE DRIVING LICENCE



Licence Number: **S6805461C**
Name:
LIM SIEW BEE
Birth Date: **07 Feb 1968**
Issue Date: **19 Jul 2004**

001260088E

For Insurance Reporting And
Claim Purposes Only

Lim Siew Bee

For Insurance Reporting And
Claim Purposes Only



NRIC No: **S6805461C**



Blood Group
O+
Date of issue
12-12-1992

271 JOO CHIAT PLACE
SINGAPORE 427952

NRIC No: **S6805461C** Date: **03/07/2008** No: **5962526**

YOU ARE LICENSED TO DRIVE VEHICLES IN THE FOLLOWING CLASS(S)

Class 3 Motor Cars of unladen weight not exceeding 3000 kg with not more than 7 passengers, exclusive of the driver; and Motor Tractors and other Motor Vehicles of unladen weight not exceeding 2500 kg

PASS DATE

NP 428A

Licence No: **S6805461C**

Lim Siew Bee



Contact us at
Hotline: (65) 6532 2888
E-mail: CustomerService@DirectAsia.com

CERTIFICATE OF INSURANCE

Motor Vehicles (Third-Party Risks and Compensation) Act (Chapter 189) (Singapore) (the "Act")
Motor Vehicles (Third-Party Risks and Compensation) Rules, 1960 (Singapore)
Road Transport Act, 1987 (Malaysia)
Motor Vehicles (Third-Party Risks) Rules, 1959 (Malaysia)

This document forms part of your contract with us and should be read together with your Policy Schedule and your Policy Details. Do let us know if any of the details shown here need to be amended or updated.

Certificate No.	: MT/00754443
Type of Coverage / Driver Plan	: Car Comprehensive (Flexible Plan)
1) Vehicle Registration No.	: SGS2134B
Chassis No.	: RN61021149
2) Name of Policy Holder	: Lim, Siew Bee
3) Effective Date / Time of Commencement of Insurance for the Purpose of the Act	: 07/03/2020 00:00
4) Date/Time of Expiry of Insurance	: 06/03/2021 23:59
5) Persons or Classes of Persons Entitled to Drive	
(a) Any other person who is driving on the Policyholder's permission.	
The person driving must have a valid driving licence to drive in Singapore and must not be under suspension or disqualification from driving.	
6) Limitations as to use	
Use only for private purposes, in accordance with the declared car usage stated on your Policy Schedule. The policy does not cover use for hire or reward, tuition, driving test, racing, pace-making, reliability trials, speed tests, the carriage of goods for payment or for any purpose in connection with the motor trade business. Private car-pooling arrangements where you commute with passengers and split the fuel expense is covered under the standard policy. Grab Hitch will only be covered if this is the declared usage stated on your Policy Schedule. Only two rides are permitted a day. Other forms of commercial car-pooling or any ride hailing services (e.g. Grab, Go-Jek etc.) are not allowed.	
*Limitations rendered inoperative by Section 8 of the Act and Section 95 of the Road Transport Act, 1987 (Malaysia), are not to be included under this heading.	
Sum Insured	: Market Value
Your Excess	
Own Damage Excess	: S\$ 800.00 (before any applicable GST)
YIED Excess	: S\$ 2,500.00 (before any applicable GST)
Windscreen Excess	: S\$ 100.00 (before any applicable GST)
Choice of workshop	: DirectAsia approved workshops
Finance company / Hire Purchase	: Hong Leong Finance
Main driver	: Wang, Chwee Seng
Named driver	: None
Important Note: This policy covers any authorised drivers. If you authorise a Young or Inexperienced Driver (YIED) then please note the increased excess above. YIED refers to any driver who is below the age of 30 or has held a driving license for less than 2 years.	

I/We hereby certify that the Policy to which this Certificate relates is issued in accordance with the provisions of the Motor Vehicles (Third-Party Risks and Compensation) Act (Chapter 189) and the Road Transport Act, 1987 (Malaysia).

Issued on: 20/01/2020

Direct Asia Insurance (Singapore) Pte. Ltd.

Direct Asia Insurance (Singapore) Pte Ltd
20 Anson Road #08-01 Twenty Anson Singapore 079912
www.DirectAsia.com

Company Registration: 2008241010



Contact us at
Hotline: (65) 6532 2888
E-mail: CustomerService@DirectAsia.com

Edip Okur (Chief Underwriting Officer)



> Back to OneMotoring

Enquire PARF/COE Rebate for Registered Vehicle

Vehicle Owner Particulars

Owner ID Type:	Singapore NRIC
Owner ID:	461C

Vehicle Details

Vehicle No.:	SGS2134B
Vehicle to be Exported:	No
Intended Deregistration Date:	08 Oct 2020
Vehicle Make:	HONDA
Vehicle Model:	STREAM 1.8 A
Primary Colour:	Silver
Manufacturing Year:	2007
Engine No.:	R18A1724099
Chassis No.:	RN61021149
Maximum Power Output:	103.0 kW (138 bhp)
Open Market Value:	\$18,485.00
Original Registration Date:	07 Mar 2007
First Registration Date:	07 Mar 2007
Transfer Count:	1
Actual ARF Paid:	\$20,334.00

Intended PARF Rebate Details

PARF Eligibility:	Forfeited
PARF Eligibility Expiry Date:	-
PARF Rebate Amount:	\$0.00

Intended COE Rebate Details

COE Expiry Date:	06 Mar 2027
COE Category:	B - Car (1601cc & above)
COE Period(Years):	10
PQP Paid:	\$50,347.00
COE Rebate Amount:	\$32,267.00
Total Rebate Amount:	\$32,267.00

The information contained herein is correct as at 08 Oct 2020

OK