

SINGAPORE ACCIDENT STATEMENT

IMPORTANT NOTICE

1. Please report correctly the details of the accident to speed up the claims process.
2. This Form must be completed by the Policyholder and/or the Authorised Driver.
3. Information provided must be as truthful and accurate as possible. Any wilful misrepresentation or withholding of material facts may allow insurance companies to repudiate policy liability.
4. The issue and acceptance of this Form by insurance companies is not an admission of policy liability on the part of the insurance companies.
5. **Any false reporting may be referred to the Police for investigation.**
6. This report will be forwarded by the insurers of the GIA Records Management Centre established by the General Insurance Association of Singapore (GIA) for archiving and that copies of this report will, for a fee, be made available upon application by interested parties.
7. By the lodgement of this report to the insurers, you hereby consent to the archiving of this report at the centre and to copies of the report being made available aforesaid.

ACCIDENT STATEMENT	
Date Of Report	16/09/2020 16:49
Date Of Accident	15/09/2020 18:25
Exact Location Of Accident	ALONG UPPER BUKIT TIMAH ROAD
Country/State of Loss	SINGAPORE
DETAILS OF OWN VEHICLE	
Vehicle Registration Number	SGH8214Y
Insured/Policyholder	
Name Of Registered Owner	CHUA TZE SHERN (CAI ZHISHEN)
NRIC No	SXXXX849E
Email Address	ARENZIN@YAHOO.COM
Mobile Phone No	(LOCAL) +65-96663987
Alternative Phone No	OFFICE-97756530
Vehicle Particulars	
Manufacturer	TOYOTA
Model	CAMRY
Exact Purpose for which vehicle was being used at time of accident	DRIVING HOME
Are you claiming under your own insurance policy for repair to your vehicle?	NO
If No, Please state action to be taken	REPORTING ONLY
Vehicle Category	PRIVATE CAR
Insurance Company	
Name of Insurance Company	NTUC INCOME INSURANCE CO-OPERATIVE LTD
Type Of Coverage	COMPREHENSIVE
Fleet Policy	NO
Policy Number	5110362569-01
Cover Note Number	
Driver	
Name of Driver	CHUA SIM KIONG
NRIC No	SXXXX385I
Date Of Birth	27/04/1949
Occupation	INDOOR
Date Of Driving Pass	18/06/1970
Driving Experience	50 YEARS AND 2 MONTHS
Gender	MALE
Mobile Number	(LOCAL) +65-96663987
Fax Number	
Contact Number	OFFICE-97756530
EEmail Address	ARENZIN@YAHOO.COM

Address	BLK 17 DOVER CRESCENT #20-52
Postcode	130017
Was driver an employee of the Insured's Company	NO
If No, Relationship of the Driver with the Insured	PARENT
Vehicle Registration Number of Driver's Own Vehicle	- - -
Insurance Company of Driver's Own Vehicle	- - -

General Information of the Accident

Type Of Accident	SIDE SWIPE
Weather Conditions	CLEAR
Road Surface	DRY

Other Information

Was any foreign vehicle involved in this accident?	NO
Number of vehicles (including own vehicle) involved in the accident	2
Was any body injured in the Accident?	NO
Was any injured conveyed to hospital by ambulance?	NO
Was any other material or property damaged?	YES
I have been approached by unknown person(s) soliciting/offering accident claims assistance.	NO
Number of Passengers (Including Driver)	2
Passenger 1	NAME: : GRAND DAUGHTER GENDER: : FEMALE

Details of Police Action

Was the accident reported to the police?	NO
If Yes, Please state which Police Station	
Was notice of intended Prosecution given?	NO
If Yes, against whom?	

Circumstances of Accident

PLEASE REFER TO SKETCH PLAN

Attachment(s)

Are accident photos available for attachment?	YES
Was there any video captured by Car Camera?	YES
Was there any audio recorded?	NO

DETAILS OF OTHER VEHICLE PROPERTY 1

Vehicle Registration Number	SMB3083B
Vehicle Make/Model/Colour	SBS BUS
Details Of Properties	
Vehicle Category	BUS
Name of Driver	
NRIC/Passport Number	
Contact Number	
Address	
Postcode	
Insurance Company Name	
Nature Of Damage	

No. Of Passenger (Including Driver)

Sketch Plan

SKETCH PLAN

IMPORTANT NOTICE

1. Please report correctly the details of the accident to speed up the claims process.
2. This Form must be completed by the Policyholder and/or the Authorised Driver.
3. Information provided must be as truthful and accurate as possible. Any wilful misrepresentation or withholding of material facts may allow insurance companies to repudiate policy liability.
4. The issue and acceptance of this Form by insurance companies is not an admission of policy liability on the part of the insurance companies.
5. Any false reporting may be referred to the Police for investigation.
6. The report will be forwarded by the insurers of the GIA Records Management Centre established by the General Insurance Association of Singapore (GIA) for archiving and that copies of this report will for a fee be made available upon application by interested parties.
7. By the lodgment of this report to the insurers, you hereby consent to the archiving of this report at the centre and to copies of the report being made available aforesaid.
8. **Consent under the Personal Data Protection Act (PDPA)**

I understand, acknowledge, agree and consent that:

- (a) My insurer, my workshop and the General Insurance Association of Singapore ("GIA") may/are permitted to collect, use, disclose and/or process my personal data/personal information set out in this [form] and any other personal information provided by me or possessed by my insurer (collectively the "Personal Information") and disclose and transfer such Personal Information to all insurer(s) who have insured vehicle(s) involved in this accident (all insurer(s) who have insured vehicle(s) involved in this accident shall be collectively referred to as the "Insurers"), the Insurers' lawyers/law firms, the Monetary Authority of Singapore and any relevant government agency/authority (such as the police), for the purpose(s) of:
 - (i) processing, handling and/or dealing with my claims including the settlement of the claims and any necessary investigations relating to the claims;
 - (ii) investigating the accident and/or my claims;
 - (iii) carrying out and/or dealing with my instructions or responding to any enquiries by me;
 - (iv) administering my claims (including the mailing of correspondence, statements, invoices, reports or notices to me, which could involve disclosure of certain personal data about me to bring about delivery of the same as well as on the external cover of envelopes/mail packages); and/or
 - (v) complying with applicable law in administering, processing, handling and/or dealing with my claims. (collectively the "Purposes")
- (b) all insurer(s) who have insured vehicle(s) involved in this accident and the Insurers' lawyers/law firms, may/are permitted to collect, use, disclose and/or process my Personal Information for one or more of the above Purposes; and
- (c) my Personal Information may/can be disclosed by any of the Insurers and/or GIA to their third party service providers or agents (including their lawyers/law firms), which may be sited outside of Singapore, for one or more of the above Purposes.
- (d) my Personal Information will also be collected and used to compile claims history for the purpose of fraud detection, investigation and management in present and all future claims.
- (e) the information so collected under (d) above may be shared / disclosed:
 - (i) to all insurers and/or any other third parties that assist in evaluating, investigating, controlling or managing fraud, regulators, law enforcement and government agencies as reasonably required for the purposes stated, or
 - (ii) for complying with requirements under any regulations, laws or court orders.



Policyholder's Signature
Date & Time:

Driver's Signature
(If driver is not the policyholder)
Date & Time:

Reporting Centre Personnel's Signature
Name:
NRIC/FIN No.:

Sketch Plan #2

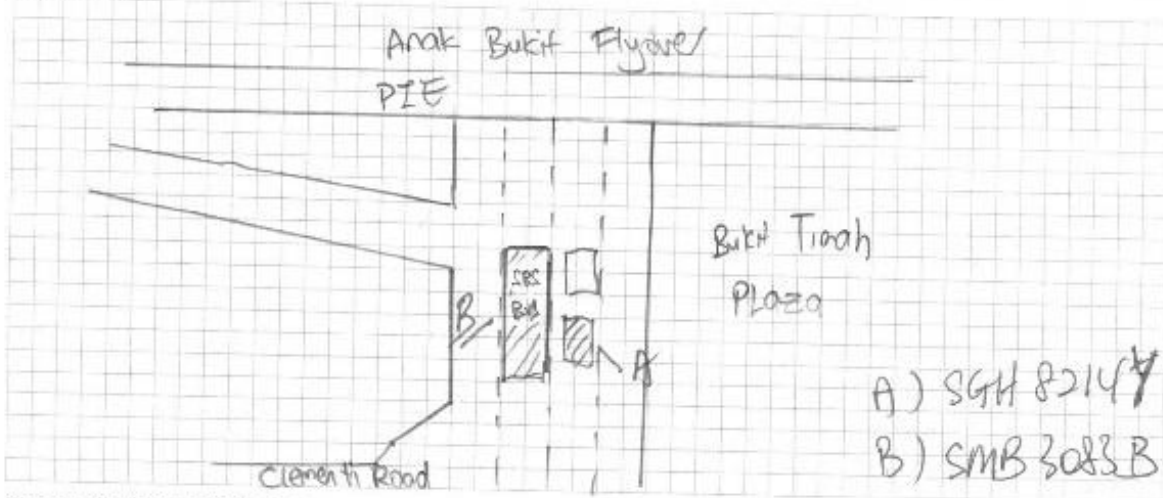
SKETCH PLAN



DESCRIBE CIRCUMSTANCES OF THE ACCIDENT

On 15 Sep 2020, at about 1824H, I was fetching the ^{Grand daughter} and on my way home along upper bukit timah road. There was a jam and the road was packed. As we were inching along upper bukit timah road the bus PS2 (SMB 3083B) turned slightly and the back of the bus pivoted and scratch the side mirror of my car (left side mirror) when my car was in my own lane.

DECLARATION

I/We declare the foregoing particulars are true in every respect.

Policyholder's Signature
Date & Time:

Driver's Signature
(If driver is not the policyholder)
Date & Time:

Reporting Centre Personnel's Signature
Name: 
NRIC/FIN No.: 

Accident Photo



Accident Photo



Accident Photo



Accident Photo



Accident Photo



Accident Photo



Accident Photo

