

Mei Kwan (LKKAuto)

From: Mei Kwan (LKKAuto)
Sent: Friday, 4 September, 2020 11:13 AM
To: June Phua (Cheng Hoe Motor); Khanchna (LKK Auto)
Cc: Admin A
Subject: RE: ENQIRY OF LIABILIYT - GBD1025C *** LKK REF: CC4/AIG20009221/ka3

Categories: HMK

Dear Sir / Madam,

We refer to the above matter.

Please be informed that OI has reported. Please refer to the below OI's sketch plan and statement.

SKETCH PLAN

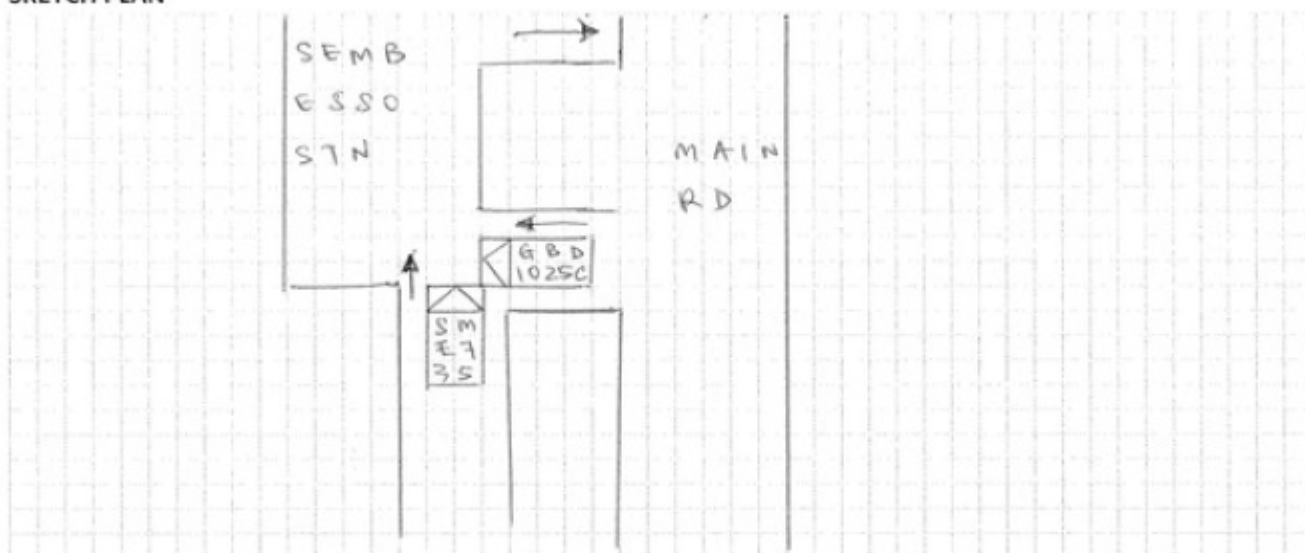

DESCRIBE CIRCUMSTANCES OF THE ACCIDENT

At 0915H, I was slowly cruising into Sembawang ESSO station to pump petrol. I stopped for a car reversing to park at the side, checked my front and right before entering into ESSO.
Suddenly, a lorry (GBD 1025C) dashed in from my right and hit the front right of my car.
The driver refused to exchange his particulars, shouted and scolded me.

Please note that for liability, claim negotiation and settlement, please contact **Khanchna**.

To check availability of the case handler, you may contact the undersigned.

Thank you.

Best Regards,

Mei Kwan | Admin

LKK Auto Consultants Pte Ltd

Phone: 6366 0055 | email: MeiKwan@lkkauto.com | fax: 67414108

Blk 51, Paya Ubi Industrial Park, Ubi Avenue 1, #02-25 | S(408933)

Note: We are on work from home arrangement. All correspondence should be made via email. Submission of claim related documents will be in softcopy. Any inconvenience caused is much regretted

From: June Phua (Cheng Hoe Motor) <chmotor@singnet.com.sg>

Sent: Friday, 4 September, 2020 10:51 AM

To: Mei Kwan (LKKAuto) <Meikwan@lkkauto.com>

Subject: ENQIRY OF LIABILIYT - GBD1025C

Hi,

OUR CLIENT – GBD1025C

DOA - [17.8.2020@9.30am](#)

AIG

INSURED - SME735H

Attached our client report.

Pls let us have a copy of your insured statement and sketch plan if you have it.

Also kindly advise OIC.

Thank you.

Regards

June

Cheng Hoe Motor Pte Ltd

Tel :67556142

Fax : 67557719