

SINGAPORE ACCIDENT STATEMENT

IMPORTANT NOTICE

1. Please report correctly the details of the accident to speed up the claims process.
2. This Form must be completed by the Policyholder and/or the Authorised Driver.
3. Information provided must be as truthful and accurate as possible. Any wilful misrepresentation or withholding of material facts may allow insurance companies to repudiate policy liability.
4. The issue and acceptance of this Form by insurance companies is not an admission of policy liability on the part of the insurance companies.
5. **Any false reporting may be referred to the Police for investigation.**
6. This report will be forwarded by the insurers of the GIA Records Management Centre established by the General Insurance Association of Singapore (GIA) for archiving and that copies of this report will, for a fee, be made available upon application by interested parties.
7. By the lodgement of this report to the insurers, you hereby consent to the archiving of this report at the centre and to copies of the report being made available aforesaid.

ACCIDENT STATEMENT

Date Of Report	20/08/2020 17:45
Date Of Accident	04/08/2020 08:30
Exact Location Of Accident	SINGPOST CENTRE
Country/State of Loss	SINGAPORE

DETAILS OF OWN VEHICLE

Vehicle Registration Number	GBK2633D
-----------------------------	----------

Insured/Policyholder

Name Of Registered Owner	HONG PO ENGINEERING PTE LTD
Co Reg No	2XXXXX023E
Email Address	NOEMAIL
Mobile Phone No	
Alternative Phone No	OFFICE-89999999

Vehicle Particulars

Manufacturer	KIA
Model	K2500 6MT
Exact Purpose for which vehicle was being used at time of accident	COMMERCIAL USE
Are you claiming under your own insurance policy for repair to your vehicle?	NO
If No, Please state action to be taken	REPORTING ONLY
Vehicle Category	COMMERCIAL VEHICLE

Insurance Company

Name of Insurance Company	CHINA TAIPING INSURANCE (SINGAPORE) PTE. LTD.
Type Of Coverage	COMPREHENSIVE
Fleet Policy	NO
Policy Number	DMCVSNW00013282000
Cover Note Number	

Driver

Name of Driver	CHAN ENG HONG
NRIC No	SXXXX788H
Date Of Birth	25/06/1966
Occupation	OUTDOOR
Date Of Driving Pass	15/06/1989
Driving Experience	31 YEARS AND 1 MONTH
Gender	MALE
Mobile Number	(LOCAL) +65-91992718
Fax Number	
Contact Number	OFFICE-91992718
Email Address	NOEMAIL

Address	501 CANBERRA DRIVE #05-03 CANBERRA RESIDENCES
Postcode	768124
Was driver an employee of the Insured's Company	YES
If No, Relationship of the Driver with the Insured	
Vehicle Registration Number of Driver's Own Vehicle	-
	-
	-
Insurance Company of Driver's Own Vehicle	-
	-
	-

General Information of the Accident

Type Of Accident	COLLISION - HEAD TO REAR
Weather Conditions	CLEAR
Road Surface	DRY

Other Information

Was any foreign vehicle involved in this accident?	NO
Number of vehicles (including own vehicle) involved in the accident	2
Was any body injured in the Accident?	NO
Was any injured conveyed to hospital by ambulance?	
Was any other material or property damaged?	YES
I have been approached by unknown person(s) soliciting/offering accident claims assistance.	NO
Number of Passengers (Including Driver)	1

Details of Police Action

Was the accident reported to the police?	NO
If Yes, Please state which Police Station	
Was notice of intended Prosecution given?	NO
If Yes, against whom?	

Circumstances of Accident

REFER TO STATEMENT.

Attachment(s)

Are accident photos available for attachment?	YES
Was there any video captured by Car Camera?	NO
Was there any audio recorded?	NO

DETAILS OF OTHER VEHICLE PROPERTY 1

Vehicle Registration Number	FBP9733B
Vehicle Make/Model/Colour	
Details Of Properties	
Vehicle Category	MOTORCYCLE
Name of Driver	
NRIC/Passport Number	
Contact Number	
Address	
Postcode	
Insurance Company Name	
Nature Of Damage	
No. Of Passenger (Including Driver)	

Accident Sketch Plan

SKETCH PLAN

IMPORTANT NOTICE

63429216

- 1) Please report **correctly** on the details of the accident to speed up the claims process.
- 2) This form must be **completed by the policy holder and/or the authorised driver**.
- 3) Information provided must be as **truthful and accurate as possible**. Any wilful misrepresentation or withholding of material facts may allow insurance companies to **repudiate policy liability**.
- 4) The issue and acceptance of this form by insurance companies is not an admission of policy liability on the part of the insurance companies.
- 5) **Any false reporting may be referred to the police for investigation**.
- 6) The report will be forwarded by the insurers of the GIA Records Management Centre established by the General Insurance Association of Singapore (GIA) for archiving and that copies of this report will for a fee be made available upon application by interested parties.
- 7) By the lodgement of this report to the insurers, you hereby consent to the archiving of this report at the centre and to copies of the report being made available aforesaid.
- 8) **Consent under the Personal Data Protection Act (PDPA)**

I understand, acknowledge, agree and consent that:

- (a) My insurer, my workshop and the General Insurance Association of Singapore ("GIA") may/are permitted to collect, use, disclose and/or process my personal data/personal information set out in the [form] and any other personal information provided by me or possessed by my insurer (collectively the "Personal Information") and disclose and transfer such personal information to all insurer(s) who have insured vehicle(s) involved in this accident (all insurer(s) who have insured vehicle(s) involved in this accident shall be collectively referred to as the "insurers"), the insurers' lawyers/law firm, the Monetary Authority of Singapore and any relevant government agency/authority (such as police), for the purpose(s) of:
 - (i) Processing, handling and/or dealing with my claims including the settlement of the claims and any necessary investigations relating to the claims;
 - (ii) Investigations the accident and/or my claims;
 - (iii) Carrying out and/or dealing with my instructions or responding to any enquiries by me;
 - (iv) Administering my claims (including the mailing of correspondence, statement, invoices, reports or notices to me, which could involve disclosure of certain personal data about me to bring about delivery of the same as well as on the external cover of envelopes/mail packages); and/or
 - (v) Complying with applicable law in administering, processing, handling and/or dealing with my claims (collectively the "purposes")
- (b) All insurer(s) who have insured vehicle(s) involved in this accident and the insurers' lawyer/law firms, may/are permitted to collect, use, disclose and/or process my personal information for one or more of the above purposes; and
- (c) My personal information may/can be disclosed by any of the insurer and/or GIA to their third party service providers or agents (including their lawyer/law firms), which may be sited outside of Singapore, for one or more of the above purposes.
- (d) My personal information will also be collected and used to compile claims history for the purpose of fraud detection, investigation and management in present and all future claims.
- (e) The information so collected under (d) above may be shared / disclosed:
 - (i) To all insurers and/or any other third parties that assist in evaluating, investigation, controlling or managing fraud, regulators, law enforcement and government agencies as reasonably required for the purposed stated, or
 - (ii) For complying with requirements under my regulations, laws or court orders.



Policy holder's signature
Date / time:

Driver's signature
(if driver is not policy holder)
Date / time:

reporting centre personnel's Signature
Date / time:

Accident Sketch Plan

SKETCH PLAN

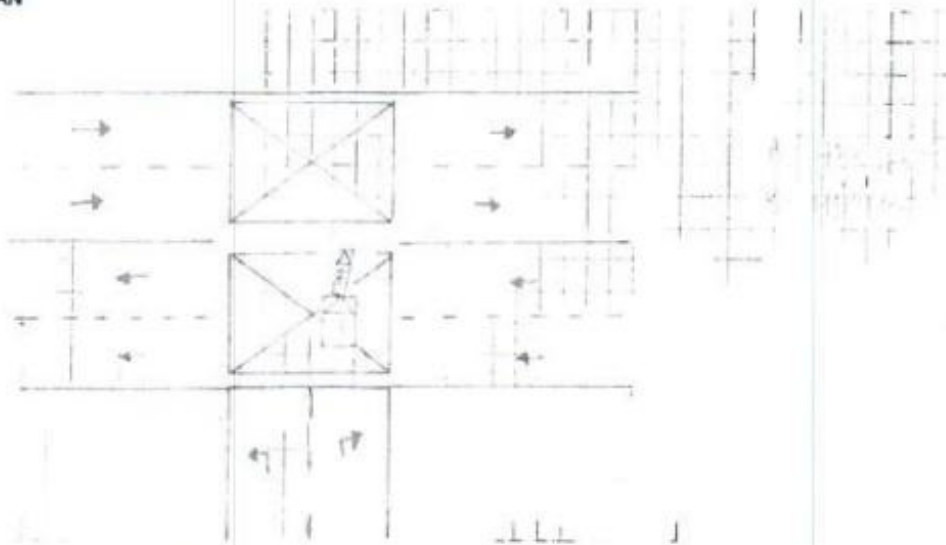

DESCRIBE CIRCUMSTANCES OF THE ACCIDENT

My vehicle is stationary behind vehicle B as we were making sure that there was not any vehicles in front before proceeding. After making sure that the road is clear, vehicle B started moving off and I also proceeded to move. Suddenly out of no reason, vehicle B jammed brake for no reason even though there was not any car in front causing me to not be able to stop in time and collided onto the rear portion of vehicle B. Hence, I told vehicle B to do a private settlement with me and he said he would contact me. Till date, I received a phone call saying that a claim was made against my insurance which is the reason for my late reporting.

DECLARATION

I/We declare the foregoing particulars are true in every respect.

Policy holder's signature
Date & time:

Driver's signature
(if driver is not policy holder)
Date & time:

reporting centre personnel's Signature
NRIC/FIN No.:

Accident Photo



Accident Photo



Accident Photo



Accident Photo



Accident Photo



Accident Photo



Accident Photo



Accident Photo



Accident Photo





Accident Photo

