

## Jia Le (LKK Auto)

---

**From:** Jia Le (LKK Auto)  
**Sent:** Thursday, 20 August 2020 5:36 PM  
**To:** Enny; Mei Kwan (LKKAuto)  
**Cc:** 'Jia Yu'; 'Suann'  
**Subject:** RE: TP Claim - SLD48A - DOA : 11/08/2020 \*\*\* LKK REF; CC4/FCI20008474/R1da3

### WITHOUT PREJUDICE

Dear Enny,

Kindly let us have the Purchase Order and Delivery Order to justify the number of days for LOU/LOR.

\*\*Please note that the settlement amount is subject to our principal approval.

Thank you.

**Note: We are on work from home arrangement. All correspondence should be made via email. Submission of claim related documents will be in softcopy. Any inconvenience caused is much regretted.**

Best Regards,

**Chan Jia Le** | Case Handler

**LKK Auto Consultants Pte Ltd**

Phone: 6841 2157 | email: [Jiale@lkkauto.com](mailto:Jiale@lkkauto.com) | fax: 6741-4108

Blk 51, Paya Ubi Industrial Park, Ubi Avenue 1, #02-25 | S(408933)

---

**From:** Enny [mailto:[enny@nova.com.sg](mailto:enny@nova.com.sg)]  
**Sent:** Thursday, 20 August 2020 4:20 PM  
**To:** Mei Kwan (LKKAuto); Jia Le (LKK Auto); 'Rachel Wu'  
**Cc:** 'Jia Yu'; 'Suann'  
**Subject:** FW: TP Claim - SLD48A - DOA : 11/08/2020 \*\*\* LKK REF; CC4/FCI20008474/R1da3

Dear Sir/Madam,

Thank you for your email.

Regarding the LOU/LOR, as the parts are unavailable locally, we would need to indent the parts from overseas which will take an estimated of 3 -4 weeks to arrive.

Do note that our client wishes to claim for the downtime of the parts waiting period as well.

Thank you

Best Regards,

*Enny Lee*

Claims Executive  
Mova Automotive Pte Ltd  
Blk 1008 Bukit Merah Lane 3  
#01-04/06/08  
Singapore 159722  
Tel: 6272 3892 Fax: 6270 8314

This message is confidential and is for the use of the intended recipient only. If you have received this message in error, please do not copy, disclose or use its content. We would be grateful if you would notify us by email and delete the original transmission and any attachment from your system. Any attachment to this e-mail may contain software viruses that could damage your computer system. Although we will take reasonable precaution to minimize this risk, we do not accept any liability resulting from software viruses. Please carry out your own virus checks before opening any attachment.

---

**From:** Jia Le (LKK Auto) [<mailto:JiaLe@lkkauto.com>]  
**Sent:** Wednesday, 19 August 2020 10:40 AM  
**To:** Enny; Mei Kwan (LKKAuto); 'Nabilah'  
**Cc:** 'Alan Chng'; 'Nitha'; Admin A  
**Subject:** RE: TP Claim - SLD48A - DOA : 11/08/2020 \*\*\* LKK REF; CC4/FCI20008474/R1da3

Without Prejudice

Dear Sirs/Madam,

**ACCIDENT INVOLVING SHC 1088E AND SLD 48A ON 11/08/2020**

We refer to the above matter.

Please be informed that basing on the accident statements submitted by both parties, the liability is clear and shall proceed with direct settlement for the above mentioned case.

Please note that this e-mail is on without prejudice basis which does not amount to an authorisation of repair to your client's vehicle.

The final repair cost is subjected to the consistency of the damages according to the nature of the accident.

And the days of LOU/ LOR will be based on the number of days of repair as recommended by our surveyor.

Please note that all finalisation subject insurer's approval.

**"Kindly note that this negotiation between parties on this matter is purely on a without prejudice basis with the sole intention of resolving the matter amicably without parties resorting to legal proceedings. No admission of liability, whatsoever, should be deemed / inferred from this negotiation of terms/settlement.**

**In the event of new evidence being discovered or subsequently produced by either party that will materially affect/influence on the issues of liability/damages, either party is not bound, thereafter, by the negotiation terms/settlement."**

**Note: We are on work from home arrangement. All correspondence should be made via email. Submission of claim related documents will be in softcopy. Any inconvenience caused is much regretted.**

Best Regards,

**Chan Jia Le** | Case Handler

LKK Auto Consultants Pte Ltd

Phone: 6841 2157 | email: [Jiale@lkkauto.com](mailto:Jiale@lkkauto.com) | fax: 6741-4108

Blk 51, Paya Ubi Industrial Park, Ubi Avenue 1, #02-25 | S(408933)

---

**From:** Enny [<mailto:enny@nova.com.sg>]  
**Sent:** Wednesday, 19 August 2020 10:46 AM  
**To:** Mei Kwan (LKKAuto); 'Nabilah'; Jia Le (LKK Auto)  
**Cc:** 'Alan Chng'; 'Nitha'; Admin A  
**Subject:** RE: TP Claim - SLD48A - DOA : 11/08/2020 \*\*\* LKK REF; CC4/FCI20008474/R1da3

Dear Mei Kwan,

Please kindly revert the liability for this case soonest possible.

Thank you

Best Regards,

*Enny Lee*

Claims Executive  
Mova Automotive Pte Ltd  
Blk 1008 Bukit Merah Lane 3  
#01-04/06/08  
Singapore 159722  
Tel: 6272 3892 Fax: 6270 8314



This message is confidential and is for the use of the intended recipient only. If you have received this message in error, please do not copy, disclose or use its content. We would be grateful if you would notify us by email and delete the original transmission and any attachment from your system. Any attachment to this e-mail may contain software viruses that could damage your computer system. Although we will take reasonable precaution to minimize this risk, we do not accept any liability resulting from software viruses. Please carry out your own virus checks before opening any attachment.

---

**From:** Enny [<mailto:enny@moval.com.sg>]  
**Sent:** Friday, 14 August 2020 5:59 PM  
**To:** 'Mei Kwan (LKKAuto)'; 'Nabilah'; 'Jia Le (LKK Auto)'  
**Cc:** 'Alan Chng'; 'Nitha'; 'Admin A'  
**Subject:** RE: TP Claim - SLD48A - DOA : 11/08/2020 \*\*\* LKK REF; CC4/FCI20008474/R1da3

Dear Mei Kwan,

Kindly refer to attachments.

Thank you

Best Regards,

Enny Lee

Claims Executive  
Mova Automotive Pte Ltd  
Blk 1008 Bukit Merah Lane 3  
#01-04/06/08  
Singapore 159722  
Tel: 6272 3892 Fax: 6270 8314



This message is confidential and is for the use of the intended recipient only. If you have received this message in error, please do not copy, disclose or use its content. We would be grateful if you would notify us by email and delete the original transmission and any attachment from your system. Any attachment to this e-mail may contain software viruses that could damage your computer system. Although we will take reasonable precaution to minimize this risk, we do not accept any liability resulting from software viruses. Please carry out your own virus checks before opening any attachment.

---

**From:** Mei Kwan (LKKAuto) [<mailto:Meikwan@lkkauto.com>]  
**Sent:** Friday, 14 August 2020 4:53 PM  
**To:** 'Nabilah'; Jia Le (LKK Auto)  
**Cc:** 'Alan Chng'; Enny; Nitha; Admin A  
**Subject:** RE: TP Claim - SLD48A - DOA : 11/08/2020 \*\*\* LKK REF; CC4/FCI20008474/R1da3

Dear Sir / Madam,

We refer to the above matter.

Please be informed that OI has reported. Please refer to the below OI's sketch plan and statement.

**Sketch Plan**

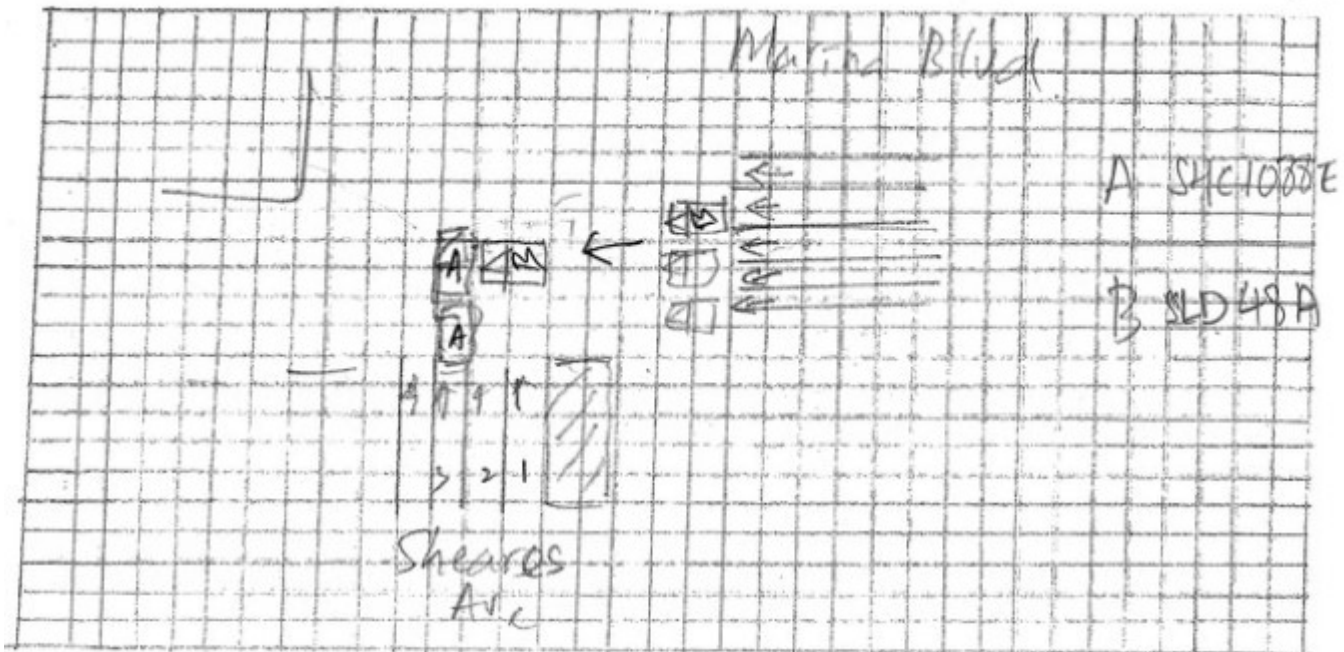

**DESCRIBE CIRCUMSTANCES OF THE ACCIDENT**

On 11 Aug 2020, at about 2315 hrs I was travelling along Shears Ave toward the Direction of Shenton Way, At the above junction my vehicle A - SHC1088E after crossing the junction, B vehicle SLD48A from my right go straight and collided onto my vehicle right side portion. After the accident ambulance had been called. But no one conveyed. my vehicle was badly damage so I called Tow Truck to tow back to workshop. And my SD card taken by traffic police, the impact caused my taxi left side hit the traffic light.

Please provide us evidence i.e. video/ scene photo.

Kindly note that for liability, claim negotiation and settlement, please contact **Jia Le via email**.

Our respective case handler will look into the matter and get back to you in due course.

To check availability of the case handler, you may contact the undersigned.

Thank you.

Best Regards,

**Mei Kwan** | Admin

LKK Auto Consultants Pte Ltd

Phone: 6366 0055 | email: [MeiKwan@lkkauto.com](mailto:MeiKwan@lkkauto.com) | fax: 67414108

**From:** Nabilah <[nabilah@moval.com.sg](mailto:nabilah@moval.com.sg)>

**Sent:** Thursday, August 13, 2020 11:29 AM

**To:** Motor Claims <[MotorClaims@msfirstcapital.com.sg](mailto:MotorClaims@msfirstcapital.com.sg)>

**Cc:** 'ALAN' <[TUCKMENG@MOVA.COM.SG](mailto:TUCKMENG@MOVA.COM.SG)>; 'Enny' <[enny@moval.com.sg](mailto:enny@moval.com.sg)>; 'Nitha' <[nitha@moval.com.sg](mailto:nitha@moval.com.sg)>

**Subject:** TP Claim - SLD48A - DOA : 11/08/2020

Your Ref : SHC1088E

Dear Sir/Mdm,

Kindly assist to arrange survey for SLD48A at Mova (Fan Yoong).  
Vehicle is in since 12/08/2020.

Kindly assist to advise on OIC and revert on the liability of accident.

Thank you.

Best Regards,  
Nabilah Senin  
MOVA Automotive Pte Ltd  
15 Fan Yoong Road  
Singapore 629792  
Tel: +65 6262 3377  
Fax: +65 6264 3151



Connect with us on 