

# NATIONAL Assessment Centre Services. [ver 1 Jan 05] MMA 1200 68676

Date In: 13/8/20 16:05	Job description	Date & Time Completed	Done by
Ref No: MA1MSG 2000 8397144	SAS e-filing		
Veh No: GBE 6428K	E-mail (within 3hrs, ATC 2hrs)		
TPA: 718120 10:25	1-Motor Claim Form		
DD - TP Reporting Only	1-Motor W/O (within: OD 2hrs, TP 4hrs)		
TP Insurer:	1-Photo Uploaded		
	Assessment/Survey Report		
	Ass't Report by Fax / Hand to Owner/Wksp		

Preferred Wksp / INC Assign Wksp / QW: (	Tel: (	Fax: (
TP Particulars:	Veh No: SLN 707 8P.	INC ( ) / Non-INC ( )
Owner / Driver: (	Tel: (	
Policy No: (	Period: (	Cover Type: (
Confirmed by: (	Date: (	Time: (
Insured/Driver Liability: (	[Note-Est. Status (WO): N: 0-20%; P: 21-79% P: 80-100%]	
Year of Registration: (	Warranty: YES ( ) / NO ( )	
Excess: (\$	Loading: \$1,000 ( ) / \$2,000 ( )	

General Remarks:
( ) Walk-In Customer: Customer's Information strictly Confidential & Strictly NO refer of repolier.
( ) Total Loss Case: to e-mail Insurer URGENTLY.
Drive-In ( ) / Towed-In ( ) ; Invoice: YES ( ) / NO ( ) ; Towing Co: ( )

Remarks:	INC ( ) / Non-INC ( )	Date & Time Completed	Done by
1) Apply for Transport Allowance ( ) / Courtesy Car ( )			
2) QC Check / Post Repair Inspection ( )			
3) Upload Resurvey Photo [Repair Cost > \$3000] ( )			

Injury: \_\_\_\_\_

Damage:	Actions:

NA2004149		Invoice Information	Invoice No: 3000
Customer Particulars:	Driver/Owner:	1) AR: Accident Reporting (\$30);	
Contact No:	Damaged Portion:	2) DA: Damage Assessment (\$100); INC (\$50)	
QC Checked by (Bugi-In-Charge):		3) TP: Towing Fee \$40/\$45	
Auditors Comments:		4) PT: Follow-Through Survey \$120	
		5) PT: Follow-Through Survey (Resurvey) \$30	
		6) TR: Re-inspection \$75	
		7) NI: Idas DA + SMRT Survey \$160	
		8) NTUC Additional Services:	
		9) NI: Idas Mobile \$30	
		10) NI: Idas Mobile \$30	
		11) NI: Idas Mobile \$30	
		12) NI: Idas Mobile \$30	
		13) NI: Idas Mobile \$30	
		14) NI: Idas Mobile \$30	
		15) NI: Idas Mobile \$30	
		16) NI: Idas Mobile \$30	
		17) NI: Idas Mobile \$30	
		18) NI: Idas Mobile \$30	
		19) NI: Idas Mobile \$30	
		20) NI: Idas Mobile \$30	
		21) NI: Idas Mobile \$30	
		22) NI: Idas Mobile \$30	
		23) NI: Idas Mobile \$30	
		24) NI: Idas Mobile \$30	
		25) NI: Idas Mobile \$30	
		26) NI: Idas Mobile \$30	
		27) NI: Idas Mobile \$30	
		28) NI: Idas Mobile \$30	
		29) NI: Idas Mobile \$30	
		30) NI: Idas Mobile \$30	
		31) NI: Idas Mobile \$30	
		32) NI: Idas Mobile \$30	
		33) NI: Idas Mobile \$30	
		34) NI: Idas Mobile \$30	
		35) NI: Idas Mobile \$30	
		36) NI: Idas Mobile \$30	
		37) NI: Idas Mobile \$30	
		38) NI: Idas Mobile \$30	
		39) NI: Idas Mobile \$30	
		40) NI: Idas Mobile \$30	
		41) NI: Idas Mobile \$30	
		42) NI: Idas Mobile \$30	
		43) NI: Idas Mobile \$30	
		44) NI: Idas Mobile \$30	
		45) NI: Idas Mobile \$30	
		46) NI: Idas Mobile \$30	
		47) NI: Idas Mobile \$30	
		48) NI: Idas Mobile \$30	
		49) NI: Idas Mobile \$30	
		50) NI: Idas Mobile \$30	
		51) NI: Idas Mobile \$30	
		52) NI: Idas Mobile \$30	
		53) NI: Idas Mobile \$30	
		54) NI: Idas Mobile \$30	
		55) NI: Idas Mobile \$30	
		56) NI: Idas Mobile \$30	
		57) NI: Idas Mobile \$30	
		58) NI: Idas Mobile \$30	
		59) NI: Idas Mobile \$30	
		60) NI: Idas Mobile \$30	
		61) NI: Idas Mobile \$30	
		62) NI: Idas Mobile \$30	
		63) NI: Idas Mobile \$30	
		64) NI: Idas Mobile \$30	
		65) NI: Idas Mobile \$30	
		66) NI: Idas Mobile \$30	
		67) NI: Idas Mobile \$30	
		68) NI: Idas Mobile \$30	
		69) NI: Idas Mobile \$30	
		70) NI: Idas Mobile \$30	
		71) NI: Idas Mobile \$30	
		72) NI: Idas Mobile \$30	
		73) NI: Idas Mobile \$30	
		74) NI: Idas Mobile \$30	
		75) NI: Idas Mobile \$30	
		76) NI: Idas Mobile \$30	
		77) NI: Idas Mobile \$30	
		78) NI: Idas Mobile \$30	
		79) NI: Idas Mobile \$30	
		80) NI: Idas Mobile \$30	
		81) NI: Idas Mobile \$30	
		82) NI: Idas Mobile \$30	
		83) NI: Idas Mobile \$30	
		84) NI: Idas Mobile \$30	
		85) NI: Idas Mobile \$30	
		86) NI: Idas Mobile \$30	
		87) NI: Idas Mobile \$30	
		88) NI: Idas Mobile \$30	
		89) NI: Idas Mobile \$30	
		90) NI: Idas Mobile \$30	
		91) NI: Idas Mobile \$30	
		92) NI: Idas Mobile \$30	
		93) NI: Idas Mobile \$30	
		94) NI: Idas Mobile \$30	
		95) NI: Idas Mobile \$30	
		96) NI: Idas Mobile \$30	
		97) NI: Idas Mobile \$30	
		98) NI: Idas Mobile \$30	
		99) NI: Idas Mobile \$30	
		100) NI: Idas Mobile \$30	



## SINGAPORE ACCIDENT STATEMENT

### IMPORTANT NOTICE

1. Please report correctly the details of the accident to speed up the claims process.
2. This Form must be completed by the Policyholder and/or the Authorised Driver.
3. Information provided must be as truthful and accurate as possible. Any wilful misrepresentation or withholding of material facts may allow insurance companies to repudiate policy liability.
4. The issue and acceptance of this Form by insurance companies is not an admission of policy liability on the part of the insurance companies.
5. Any false reporting may be referred to the Police for investigation.
6. This report will be forwarded by the insurers of the GIA Records Management Centre established by the General Insurance Association of Singapore (GIA) for archiving and that copies of this report will, for a fee, be made available upon application by interested parties.
7. By the lodgement of this report to the insurers, you hereby consent to the archiving of this report at the centre and to copies of the report being made available aforesaid.

### ACCIDENT STATEMENT

Date Of Report	13/08/2020 16:05
Date Of Accident	07/08/2020 10:25
Exact Location Of Accident	191 BISHAN ST 13 OPEN CARPARK
Country/State of Loss	SINGAPORE

### DETAILS OF OWN VEHICLE

Vehicle Registration Number	GBE6428K
<b>Insured/Policyholder</b>	
Name Of Registered Owner	HONG HUAT ELECTRICAL PTE LTD
Co Reg No	-
Email Address	NOEMAIL
Mobile Phone No	
Alternative Phone No	OFFICE-67413900
<b>Vehicle Particulars</b>	
Manufacturer	NISSAN
Model	CABSTAR
Exact Purpose for which vehicle was being used at time of accident	WORKING
Are you claiming under your own insurance policy for repair to your vehicle?	NO
If No, Please state action to be taken	REPORTING ONLY
Vehicle Category	COMMERCIAL VEHICLE
<b>Insurance Company</b>	
Name of Insurance Company	MSIG INSURANCE (SINGAPORE) PTE. LTD.
Type Of Coverage	COMPREHENSIVE
Fleet Policy	NO
Policy Number	A 300262530 MKC
Cover Note Number	
<b>Driver</b>	
Name of Driver	WONG SIEW SENG
NRIC No	SXXXX811D
Date Of Birth	16/12/1944
Occupation	OUTDOOR
Date Of Driving Pass	01/01/1964
Driving Experience	56 YEARS AND 7 MONTHS
Gender	MALE
Mobile Number	(LOCAL) +65-97817166
Fax Number	
Contact Number	
Email Address	NOEMAIL

Address	BLK 151 SIMEI ST 1 #09-27
Postcode	520151
Was driver an employee of the Insured's Company	YES
If No, Relationship of the Driver with the Insured	
Vehicle Registration Number of Driver's Own Vehicle	-
	-
	-
Insurance Company of Driver's Own Vehicle	-
	-
	-

#### General Information of the Accident

Type Of Accident	COLLIDED INTO PARKED VEHICLE
Weather Conditions	CLEAR
Road Surface	DRY

#### Other Information

Was any foreign vehicle involved in this accident?	NO
Number of vehicles (including own vehicle) involved in the accident	2
Was any body injured in the Accident?	NO
Was any injured conveyed to hospital by ambulance?	
Was any other material or property damaged?	YES
I have been approached by unknown person(s) soliciting/offering accident claims assistance.	NO
Number of Passengers (Including Driver)	2
Passenger 1	NAME: : UNKNOWN GENDER: : MALE

#### Details of Police Action

Was the accident reported to the police?	NO
If Yes, Please state which Police Station	
Was notice of intended Prosecution given?	NO
If Yes, against whom?	

#### Circumstances of Accident

REFER TO STATEMENT.

#### Attachment(s)

Are accident photos available for attachment?	YES
Was there any video captured by Car Camera?	NO
Was there any audio recorded?	NO

#### DETAILS OF OTHER VEHICLE PROPERTY 1

Vehicle Registration Number	SLN7078P
Vehicle Make/Model/Colour	
Details Of Properties	
Vehicle Category	PRIVATE CAR
Name of Driver	
NRIC/Passport Number	
Contact Number	
Address	
Postcode	
Insurance Company Name	
Nature Of Damage	
No. Of Passenger (Including Driver)	



## SKETCH PLAN

### IMPORTANT NOTICE

1. Please report **correctly** the details of the accident to speed up the claims process.
2. This Form must be **completed by the Policyholder and/or the Authorised Driver**.
3. Information provided must be as **truthful and accurate as possible**. Any wilful misrepresentation or withholding of material facts may allow insurance companies to **repudiate policy liability**.
4. The issue and acceptance of this Form by insurance companies is not an admission of policy liability on the part of the insurance companies.
5. **Any false reporting may be referred to the Police for investigation.**
6. The report will be forwarded by the insurers of the GIA Records Management Centre established by the General Insurance Association of Singapore (GIA) for archiving and that copies of this report will for a fee be made available upon application by interested parties.
7. By the lodgment of this report to the insurers, you hereby consent to the archiving of this report at the centre and to copies of the report being made available aforesaid.
8. **Consent under the Personal Data Protection Act (PDPA)**

I understand, acknowledge, agree and consent that:

- (a) My insurer, my workshop and the General Insurance Association of Singapore ("GIA") may/are permitted to collect, use, disclose and/or process my personal data/personal information set out in this [form] and any other personal information provided by me or possessed by my insurer (collectively the "Personal Information") and disclose and transfer such Personal Information to all insurer(s) who have insured vehicle(s) involved in this accident (all insurer(s) who have insured vehicle(s) involved in this accident shall be collectively referred to as the "Insurers"), the Insurers' lawyers/law firms, the Monetary Authority of Singapore and any relevant government agency/authority (such as the police), for the purpose(s) of:
  - (i) processing, handling and/or dealing with my claims including the settlement of the claims and any necessary investigations relating to the claims;
  - (ii) investigating the accident and/or my claims;
  - (iii) carrying out and/or dealing with my instructions or responding to any enquiries by me;
  - (iv) administering my claims (including the mailing of correspondence, statements, invoices, reports or notices to me, which could involve disclosure of certain personal data about me to bring about delivery of the same as well as on the external cover of envelopes/mail packages); and/or
  - (v) complying with applicable law in administering, processing, handling and/or dealing with my claims. (collectively the "Purposes")
- (b) all insurer(s) who have insured vehicle(s) involved in this accident and the Insurers' lawyers/law firms, may/are permitted to collect, use, disclose and/or process my Personal Information for one or more of the above Purposes; and
- (c) my Personal Information may/can be disclosed by any of the Insurers and/or GIA to their third party service providers or agents (including their lawyers/law firms), which may be sited outside of Singapore, for one or more of the above Purposes.
- (d) my Personal Information will also be collected and used to compile claims history for the purpose of fraud detection, investigation and management in present and all future claims.
- (e) the information so collected under (d) above may be shared / disclosed:
  - (i) to all insurers and/or any other third parties that assist in evaluating, investigating, controlling or managing fraud, regulators, law enforcement and government agencies as reasonably required for the purposes stated, or
  - (ii) for complying with requirements under any regulations, laws or court orders.

烽發電器私人有限公司  
HONG HUAT ELECTRICAL PTE LTD  
NO. 1 Eunos Ave 8A  
SINGAPORE 610007

Policyholder's Signature  
Date & Time:

Driver's Signature  
(If driver is not the policyholder)  
Date & Time:

Reporting Centre Personnel's Signature  
Name:  
NRIC/FIN No.:

SKETCH PLAN

191 Bishan St 13 open carpark

A = GBE 6428 K

B = SLN 7078 P.

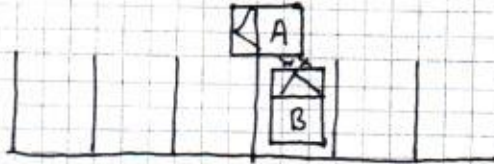

DESCRIBE CIRCUMSTANCES OF THE ACCIDENT

I was Driving at 191 Bishan St 13 open carpark,

I Reversing to check the correct block number.

But I never felt hit onto any Veh when that time.

then I left the scene. After finish delivery then I

left the scene. Today my company received a call

regarding I had hit onto another Veh. and I am unsure

the I got hit the car or not.

DECLARATION

I/We declare the foregoing particulars are true in every respect.

Policyholder's Signature

Date & Time:

Driver's Signature

(If driver is not the policyholder)

Date & Time:

Reporting Centre Personnel's Signature

Name:

NRIC/FIN No.:



**MSIG**

MSIG Insurance (Singapore) Pte. Ltd.  
 4 Shenton Way, #21-01, SGX Centre 2, Singapore 068807  
 Tel +65 6827 7888, Fax +65 6827 7800  
 Co.Reg No. 200412212G GST Reg. No. 20-0412212G  
 A Member of **MS&AD** INSURANCE GROUP

**CERTIFICATE OF INSURANCE**

ROAD TRANSPORT ACT 1987 (MALAYSIA), ROAD TRANSPORT (AMENDMENT) ACT 2019 (MALAYSIA)  
 THE MOTOR VEHICLES (THIRD-PARTY RISKS) RULES, 1959 (MALAYSIA)  
 THE MOTOR VEHICLES (THIRD-PARTY RISKS AND COMPENSATION) ACT (CAP. 189 OF THE REVISED EDITION)  
 (REPUBLIC OF SINGAPORE)  
 THE MOTOR VEHICLES (THIRD-PARTY RISKS AND COMPENSATION) RULES, 1996 EDITION (REPUBLIC OF SINGAPORE)  
 OR ANY AMENDMENT, ACT OR ACTS PASSED IN SUBSTITUTION THEREOF.

**COMMERCIAL VEHICLE**  
**Comprehensive**
**Certificate No.** A 300262530 MKC

**Excess :** SGD1,000

**Windscreen Excess :** SGD100

**1. Index Mark and Registration Number of Vehicle**  
 GBE6428K

**2. Name of Policyholder**  
 Hong Huat Electrical Pte Ltd

**3. Effective Date of the Commencement of Insurance for the purposes of the Act**  
 30/01/2020

**4. Date of Expiry of Insurance**  
 29/01/2021

**5. Persons or Classes of Persons entitled to drive\***  
 Any other person provided he is driving on the Policyholder's order or with the Policyholder's permission.

\*Provided that the person driving is permitted in accordance with the licensing or other laws or laws or regulations to drive the Motor Vehicle or has been so permitted and is not disqualified by order of a Court of Law or by reason of any enactment or regulation in that behalf from driving the Motor Vehicle.

**6. Limitations as to Use \***  
 Use in connection with the Policyholder's business. Use for the carriage of passengers (other than for hire or reward) in connection with the Policyholder's business. Use for social domestic and pleasure purposes. The Policy does not cover  
 (1) Use for hire or reward or for racing pace-making reliability trial or speed-testing.  
 (2) Use whilst drawing a trailer except the towing of any one disabled mechanically propelled vehicle.

\* Limitations rendered inoperative by Section 8 of the Motor Vehicles (Third-Party Risk and Compensation) Act (Chapter 189) and Chapter 95 of the Road Transport Act, 1987 (Malaysia), are not to be included under these headings.

This Certificate is not transferable to a new owner of the vehicle. If for any reason the Policy is terminated during its currency, the Certificate must be returned to the insurer within 7 days of the termination or if the Certificate has been lost or destroyed, a Statutory Declaration to that effect must be made. Failure to comply with this obligation is an offense under the Motor Vehicles (Third Party Risks and Compensation) Act (Cap. 189).

I/WE HEREBY CERTIFY that the Policy to which this Certificate relates is issued in accordance with the provisions of the Motor Vehicles (Third-Party Risks and Compensation) Act (Chapter 189) and Part IV of the Road Transport Act, 1987 (Malaysia) or any Amendment, Act or Acts passed in substitution thereof.

**MSIG Insurance (Singapore) Pte. Ltd.**

Approved Insurers

 Craig Ellis  
 Chief Executive Officer

# ACCIDENT STATEMENT

ACCIDENT DATE: ( 7 / 8 / 20 ) (DD/MM/YYYY), TIME: ( 10 : 26 ) (HH:MM)

LOCATION: 191 Bishan St 13 open carpark

## 1. DETAILS OF VEHICLE

- a) VEHICLE NUMBER: GBE 6428K  
b) INSURANCE COMPANY: MSG  
c) POLICY NUMBER: \_\_\_\_\_  
d) POLICY TYPE: (COMPREHENSIVE / THIRD PARTY / THIRD PARTY FIRE & THEFT)  
e) MAKE & MODEL: \_\_\_\_\_  
f) TYPE: (SALOON / COUPE / MPV / VAN / LORRY / MOTORCYCLE / OTHERS)  
g) VEHICLE CATEGORY: (PRIVATE / COMMERCIAL / MOTORCYCLE)  
h) PURPOSE OF USING AT ACCIDENT TIME: Working  
i) ARE YOU CLAIMING UNDER YOUR OWN INSURANCE (YES/NO)  
IF NO, PLEASE STATE (THIRD PARTY CLAIM / REPORTING ONLY)

## 2. INSURED / POLICY HOLDER

- A) NAME: Hong Huat Electrical Pte Ltd (MALE / FEMALE)  
b) NRIC/FIN/PASSPORT: \_\_\_\_\_ CONTACT: 67413900  
c) ADDRESS: \_\_\_\_\_

\* CONTINUE TO 3.d IF DRIVER ALSO POLICY HOLDER

## DRIVER

- a) NAME: \_\_\_\_\_ (MALE / FEMALE)  
b) NRIC/FIN/PASSPORT: \_\_\_\_\_ CONTACT: 97817166  
c) ADDRESS: \_\_\_\_\_

\*d) DATE OF BIRTH: (\_\_\_\_/\_\_\_\_/\_\_\_\_) (DD/MM/YYYY)

e) OCCUPATION: (INDOOR / OUTDOOR)

f) YEARS OF DRIVING EXPERIENCE: \_\_\_\_\_

4. WAS DRIVER AN EMPLOYEE OF THE INSURED'S COMPANY? (YES / NO)  
IF NO, RELATIONSHIP OF THE DRIVER WITH INSURED: \_\_\_\_\_

5. a) WEATHER CONDITION: (CLEAR / RAINING / OTHERS \_\_\_\_\_)

b) ROAD SURFACE: (DRY / WET / OTHERS \_\_\_\_\_)

6. WAS ANYBODY INJURED (YES / NO)

7. a) REPORTED TO POLICE (YES / NO)

IF YES, PLEASE STATE WHICH POLICE STATION: \_\_\_\_\_

## 8. THIRD PARTY VEHICLE

- a) VEHICLE NUMBER: SLN 7078P MODEL: \_\_\_\_\_  
b) DRIVER'S NAME: \_\_\_\_\_  
c) NRIC/FIN/PASSPORT: \_\_\_\_\_ CONTACT: \_\_\_\_\_

## 9. THIRD PARTY VEHICLE

- d) VEHICLE NUMBER: \_\_\_\_\_ MODEL: \_\_\_\_\_  
e) DRIVER'S NAME: \_\_\_\_\_  
f) NRIC/FIN/PASSPORT: \_\_\_\_\_ CONTACT: \_\_\_\_\_

Email =

fax =

VIDEO = No.

\*No of passengers  
(including driver)  
( 2 )

/  
M

\*No of passengers  
(including driver)  
(    )

\*No of passengers  
(including driver)  
(    )