

SINGAPORE ACCIDENT STATEMENT

IMPORTANT NOTICE

1. Please report correctly the details of the accident to speed up the claims process.
2. This Form must be completed by the Policyholder and/or the Authorised Driver.
3. Information provided must be as truthful and accurate as possible. Any wilful misrepresentation or withholding of material facts may allow insurance companies to repudiate policy liability.
4. The issue and acceptance of this Form by insurance companies is not an admission of policy liability on the part of the insurance companies.
5. Any false reporting may be referred to the Police for investigation.
6. This report will be forwarded by the insurers of the GIA Records Management Centre established by the General Insurance Association of Singapore (GIA) for archiving and that copies of this report will, for a fee, be made available upon application by interested parties.
7. By the lodgement of this report to the insurers, you hereby consent to the archiving of this report at the centre and to copies of the report being made available aforesaid.

ACCIDENT STATEMENT

Date Of Report	11/05/2020 12:48
Date Of Accident	05/05/2020 17:05
Exact Location Of Accident	BLK 140 BEDOK NORTH STREET 2
Country/State of Loss	SINGAPORE

DETAILS OF OWN VEHICLE

Vehicle Registration Number	GBJ9040Z
Insured/Policyholder	
Name Of Registered Owner	PAN PACIFIC VAN & TRUCK LEASING PTE LTD
Co Reg No	2XXXXX635R
Email Address	NOEMAIL
Mobile Phone No	(LOCAL) +65-90166559
Alternative Phone No	OFFICE-62840827

Vehicle Particulars

Manufacturer	TOYOTA
Model	HIACE-3.0 D TURBO 5 DR (M)

Exact Purpose for which vehicle was being used at time of accident

Are you claiming under your own insurance policy for repair to your vehicle? NO

If No, Please state action to be taken THIRD PARTY

Vehicle Category COMMERCIAL VEHICLE

Insurance Company

Name of Insurance Company	INDIA INTERNATIONAL INSURANCE PTE LTD
Type Of Coverage	COMPREHENSIVE
Fleet Policy	YES
Policy Number	D19MFL0005549
Cover Note Number	

Driver

Name of Driver	MUHAMAD FAIZAL BIN IBRAHIM
NRIC No	SXXXX410D
Date Of Birth	22/01/1984
Occupation	OUTDOOR
Date Of Driving Pass	06/04/2017
Driving Experience	3 YEARS AND 0 MONTHS
Gender	MALE
Mobile Number	(LOCAL) +65-90166559
Fax Number	
Contact Number	
Email Address	NOEMAIL

Address	BLK 1 HOLLAND CLOSE #05-97
Postcode	271001
Was driver an employee of the Insured's Company	NO
If No, Relationship of the Driver with the Insured	OTHER - HIRER
Vehicle Registration Number of Driver's Own Vehicle	-
	-
Insurance Company of Driver's Own Vehicle	-
	-
	-

General Information of the Accident

Type Of Accident	COLLISION - HEAD TO REAR
Weather Conditions	RAINING
Road Surface	WET

Other Information

Was any foreign vehicle involved in this accident?	NO
Number of vehicles (including own vehicle) involved in the accident	2
Was any body injured in the Accident?	YES
Was any injured conveyed to hospital by ambulance?	NO
Was any other material or property damaged?	YES
I have been approached by unknown person(s) soliciting/offering accident claims assistance.	NO
Number of Passengers (Including Driver)	1

Details of Police Action

Was the accident reported to the police?	YES
If Yes, Please state which Police Station	
Police Station Name	BEDOK DIVISION HQ
Police Station Address	ROAD: 30 BEDOK NORTH ROAD , POSTCODE: 469676 , COUNTRY: SINGAPORE
Police Station Contact	TEL NO: - FAX NO:
Was notice of intended Prosecution given?	NO
If Yes, against whom?	

Circumstances of Accident

REFER TO POLICE REPORT.

Attachment(s)

Are accident photos available for attachment?	YES
Was there any video captured by Car Camera?	NO
Was there any audio recorded?	NO

DETAILS OF OTHER VEHICLE PROPERTY 1

Vehicle Registration Number	SMJ2586G
Vehicle Make/Model/Colour	KIA
Details Of Properties	
Vehicle Category	PRIVATE CAR
Name of Driver	LIM WEI JIE, SHAYN
NRIC/Passport Number	SXXXX358D
Contact Number	97548841
Address	
Postcode	
Insurance Company Name	
Nature Of Damage	

Of Passenger (Including Driver)

DETAILS OF INJURED PERSON 1

Name

MUHAMAD FAIZAL BIN IBRAHIM

Approximate Age

Injuries Sustain

LEFT ELBOW, LEFT KNEE, BACK PAIN

Injured person in which vehicle?

GBJ9040Z

Were seat belts worn?

Was this injured conveyed to hospital by ambulance?

NO

Address

Postcode

SKETCH PLAN

IMPORTANT NOTICE

1. Please report correctly the details of the accident to speed up the claims process.
2. This form must be completed by the Policyholder and/or the Authorized Driver.
3. Information provided must be as truthful and accurate as possible. Any willful misrepresentation or withholding of material facts may allow insurance companies to invalidate policy liability.
4. The issue and acceptance of this form by insurance companies is not an admission of policy liability on the part of the insurance companies.
5. Any false reporting may be referred to the Police for investigation.
6. The report will be forwarded by the insurers of the GIA Records Management Centre established by the General Insurance Association of Singapore (GIA) for archiving and that copies of this report will for a fee be made available upon application by interested parties.
7. By the lodgment of this report to the insurers, you hereby consent to the archiving of this report at the centre and to copies of the report being made available aforesaid.
8. **Consent under the Personal Data Protection Act (PDPA)**

I understand, acknowledge, agree and consent that

- (a) My insurer, my workshop and the General Insurance Association of Singapore ("GIA") may/are permitted to collect, use, disclose and/or process my personal data/personal information set out in this form and any other personal information provided by me or possessed by my insurer (collectively the "Personal Information") and disclose and transfer such Personal Information to all insurer(s) who have insured vehicle(s) involved in this accident (all insurer(s) who have insured vehicle(s) involved in this accident shall be collectively referred to as the "Insurers"), the Insurers, lawyers/law firms, the Monetary Authority of Singapore and any relevant government agency/authority (such as the police) for the purpose(s) of:
 - (i) processing, handling and/or dealing with my claims including the settlement of the claims and any necessary investigations relating to the claims,
 - (ii) investigating the accident and/or my claims,
 - (iii) carrying out and/or dealing with my instructions or responding to any enquiries by me,
 - (iv) administering my claims (including the mailing of correspondence, statements, invoices, reports or notices to me, which could involve disclosure of certain personal data about me to bring about delivery of the same as well as on the external cover of envelopes/mail packages); and/or
 - (v) complying with applicable law in administering, processing, handling and/or dealing with my claims (collectively the "Purposes").
- (b) all insurer(s) who have insured vehicle(s) involved in this accident and the Insurers, lawyers/law firms, may/are permitted to collect, use, disclose and/or process my Personal Information for one or more of the above Purposes, and
- (c) my Personal Information may/can be disclosed by any of the Insurers and/or GIA to their third party service providers or agents (including their lawyers/law firms), which may be sited outside of Singapore, for one or more of the above Purposes.
- (d) my Personal Information will also be collected and used to compile claims history for the purpose of fraud detection investigation and management in present and all future claims.
- (e) the information so collected under (d) above may be shared / disclosed:
 - (i) to all insurers and/or any other third parties that assist in evaluating, investigating, controlling or managing fraud, regulators, law enforcement and government agencies as reasonably required for the purposes stated; or
 - (ii) for complying with requirements under any regulations, laws or court orders.

Policyholder's Signature
Date & Time

Driver's Signature
(If driver is not the policyholder)
Date & Time 11/3/2019 11:45 AM

Reporting Centre Person's Signature
Name Khairul
NRIC/FIN No

Sketch Plan #2

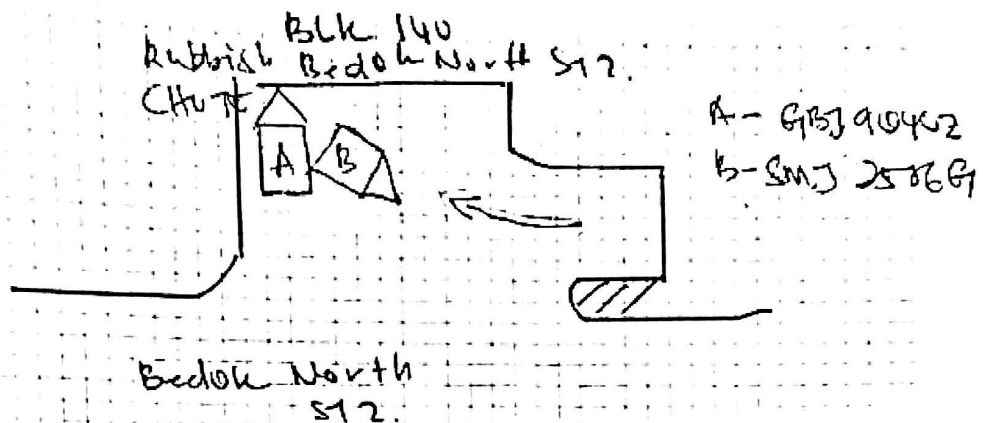

- Refer to police report.

DECLARATION
I/We declare the foregoing particulars are true in every respect.

Driver's Signature
(If driver is not the policyholder)
Date & Time 11/5/20 @ 10:45 AM

Reporting Centre Personnel's Signature
Name Manoj
NRIC/FIN No